

5.28.20 E.J.

10:14:20	1:32:22
1:41:21	8:30:22
File 70TH ST	1:20:23
8:25:21	8:19:23

CELL 7003E  
0 - 50 ft

8/21 > 8ft trans crks outside  
Fog line.

11+00

11+50

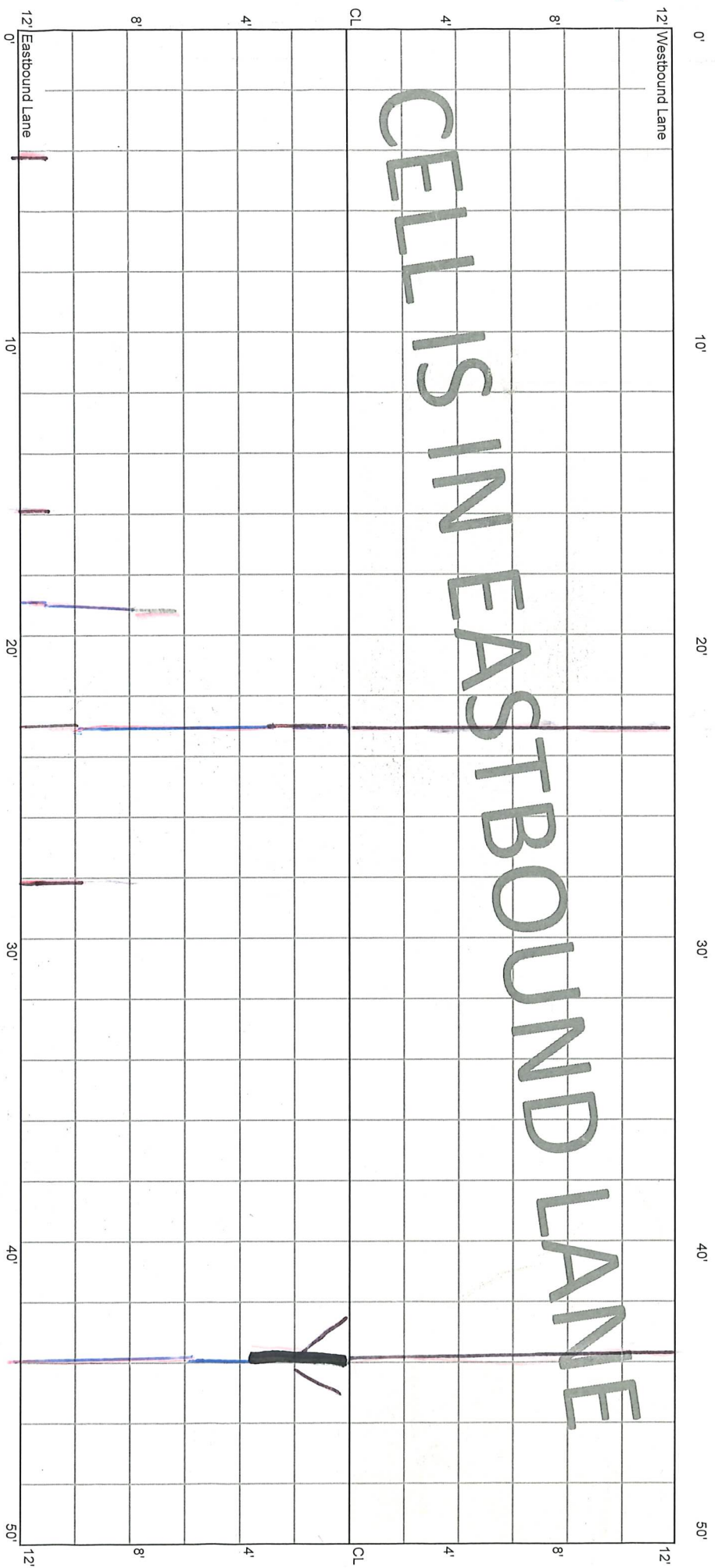

\* Route 2 Seal

CELL 7003E  
50 - 100 ft

11+50

12+00

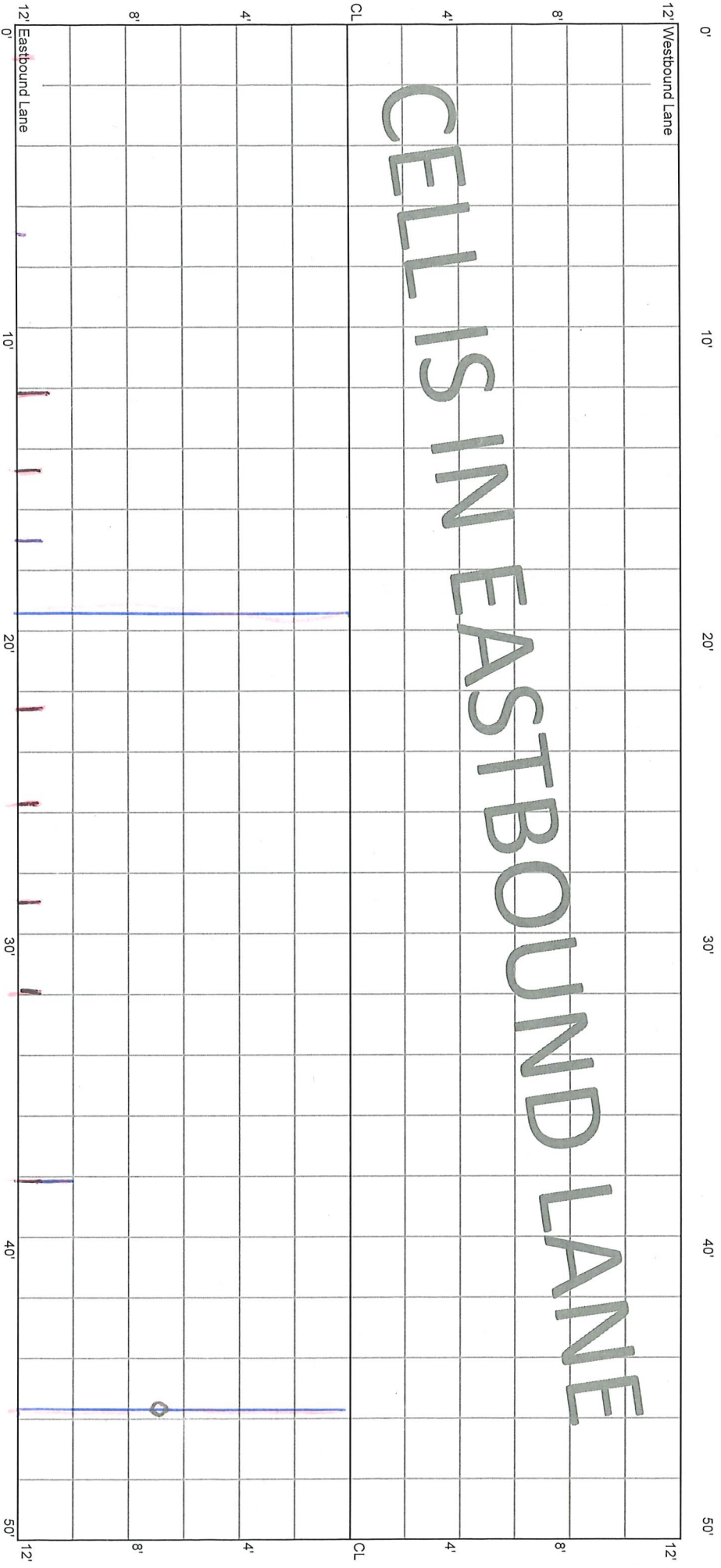

CELL 7003E  
100 - 150 ft

12+00

12+50

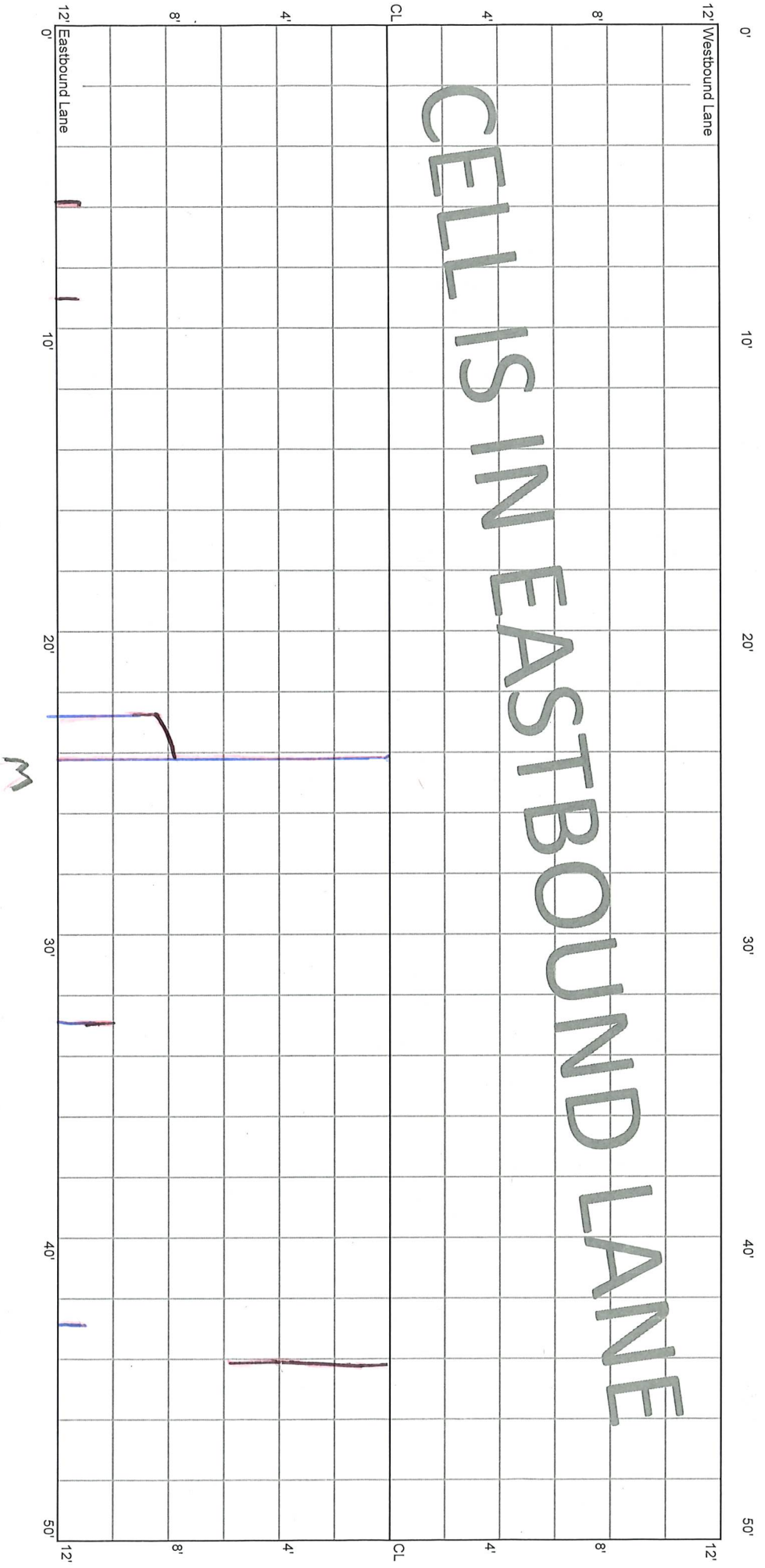

0' 10' 20' 30' 40' 50'

12' Westbound Lane  
0' 10' 20' 30' 40' 50'  
12' Eastbound Lane

CL  
4'  
8'  
4'  
8'  
4'  
8'  
CL  
4'  
8'  
4'  
8'

CELLS IN EASTBOUND LANE

M

CELL 7003E  
150 - 200 ft

12+50

13+00

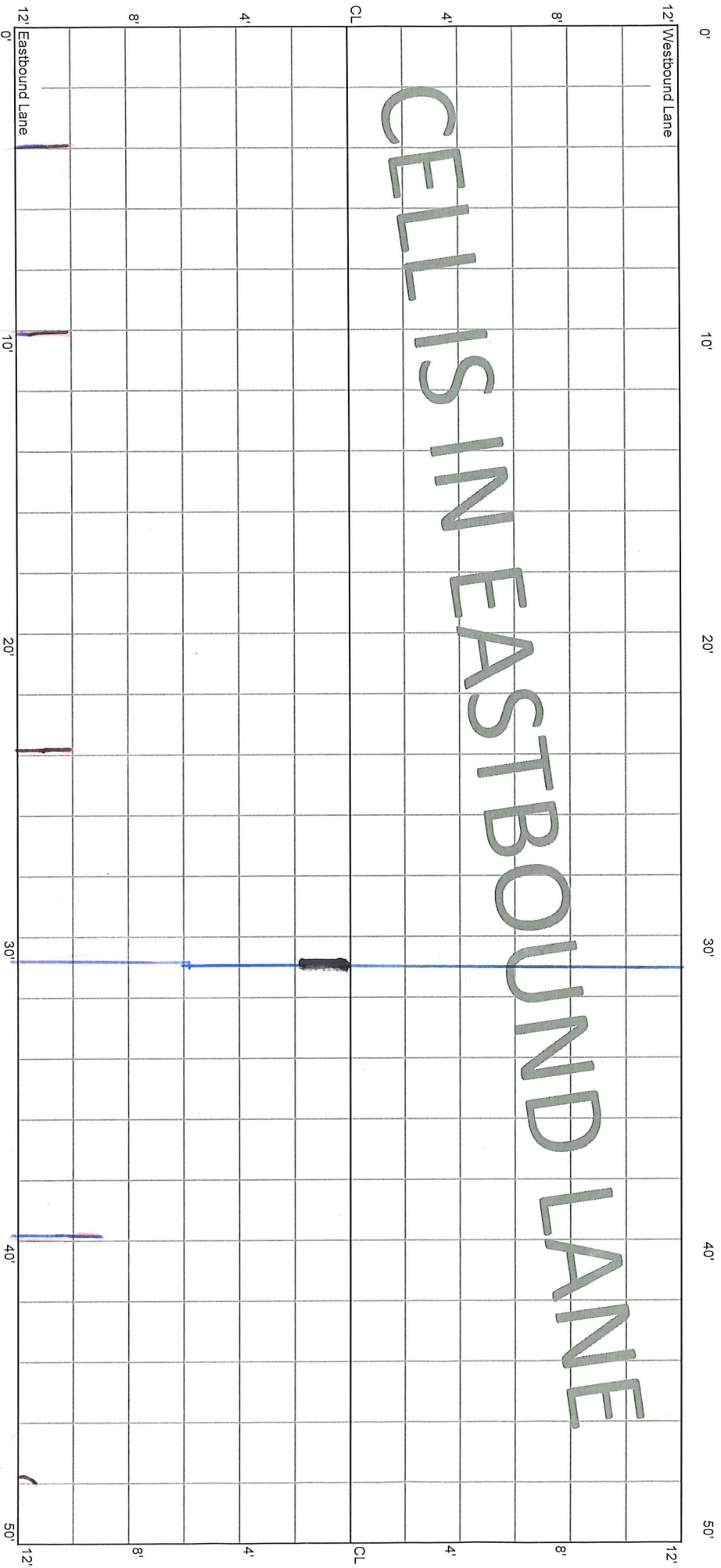

\*  
M

CELL 7003E  
200 - 250 ft

13+00

13+50

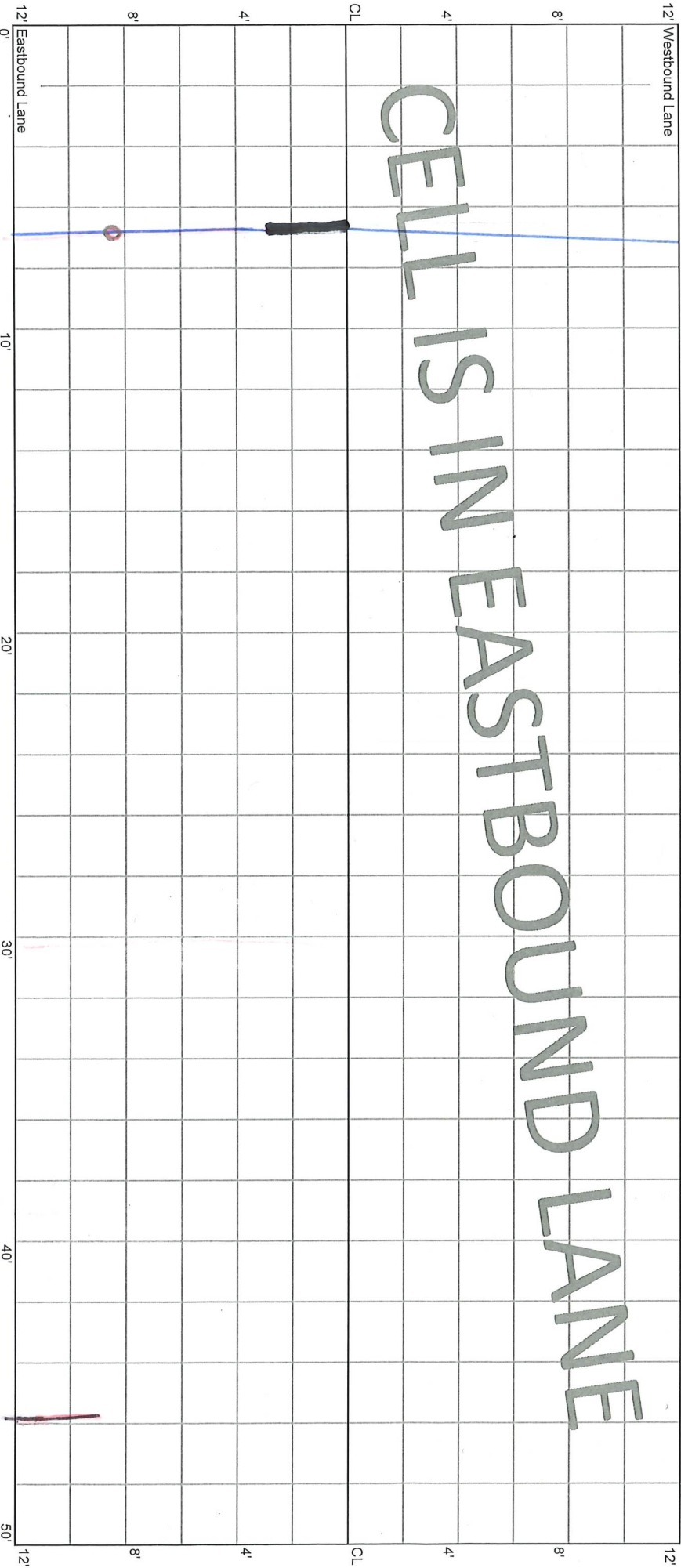

M

A

CELL 7003E  
250 - 300 ft

13+50

14+00

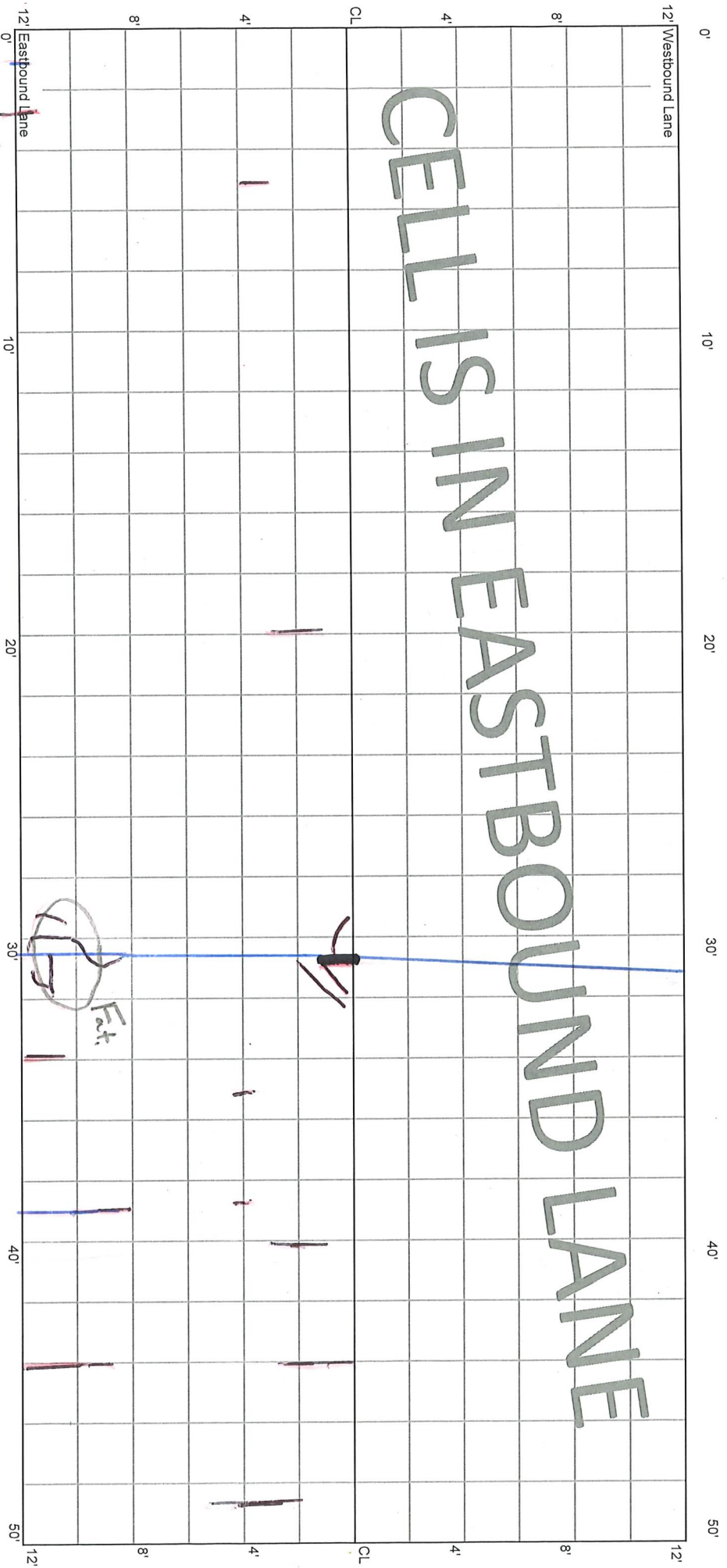

CELL IS IN EASTBOUND LANE

\* M

291

CELL 7003E  
300 - 350 ft

14+00

14+50

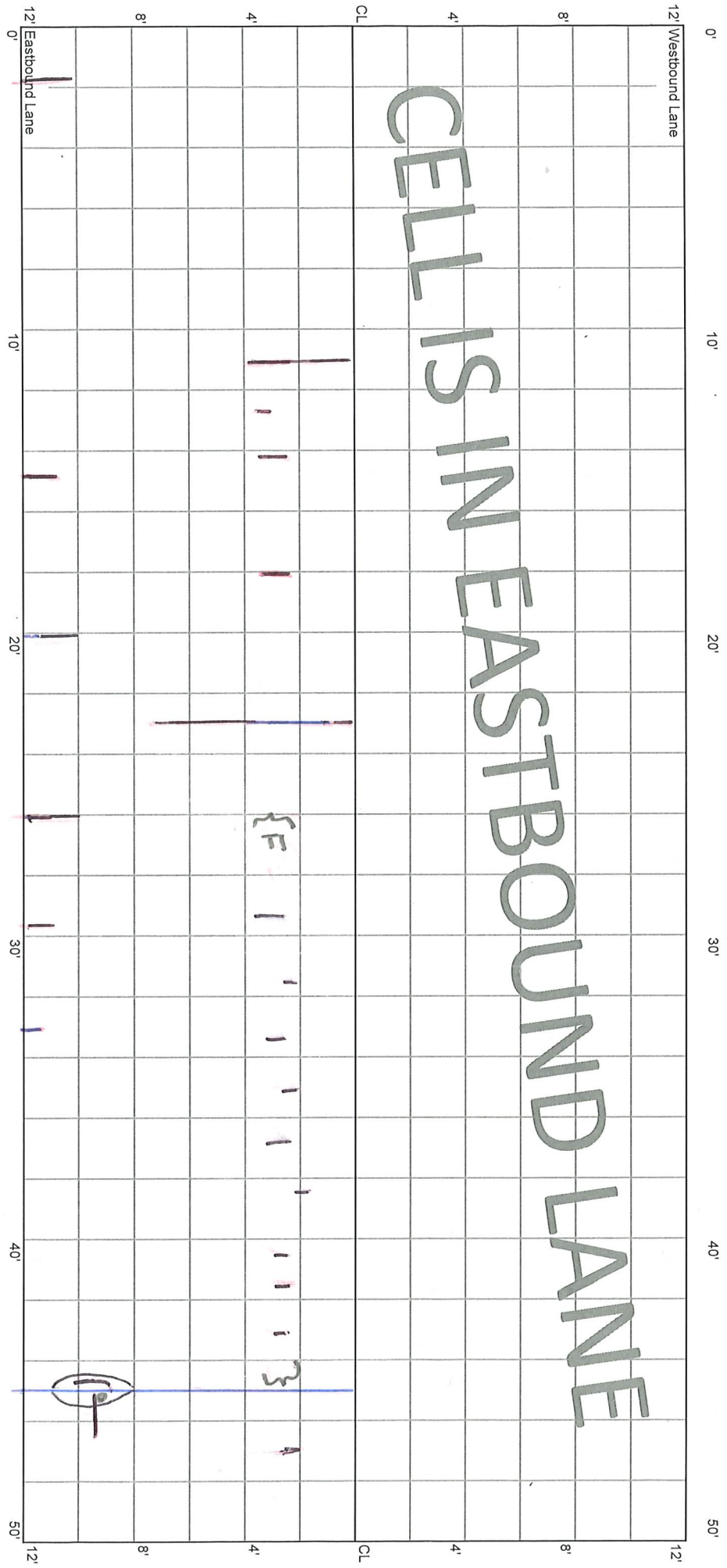

M

CELL 7003E  
350 - 400 ft

14+50

15+00

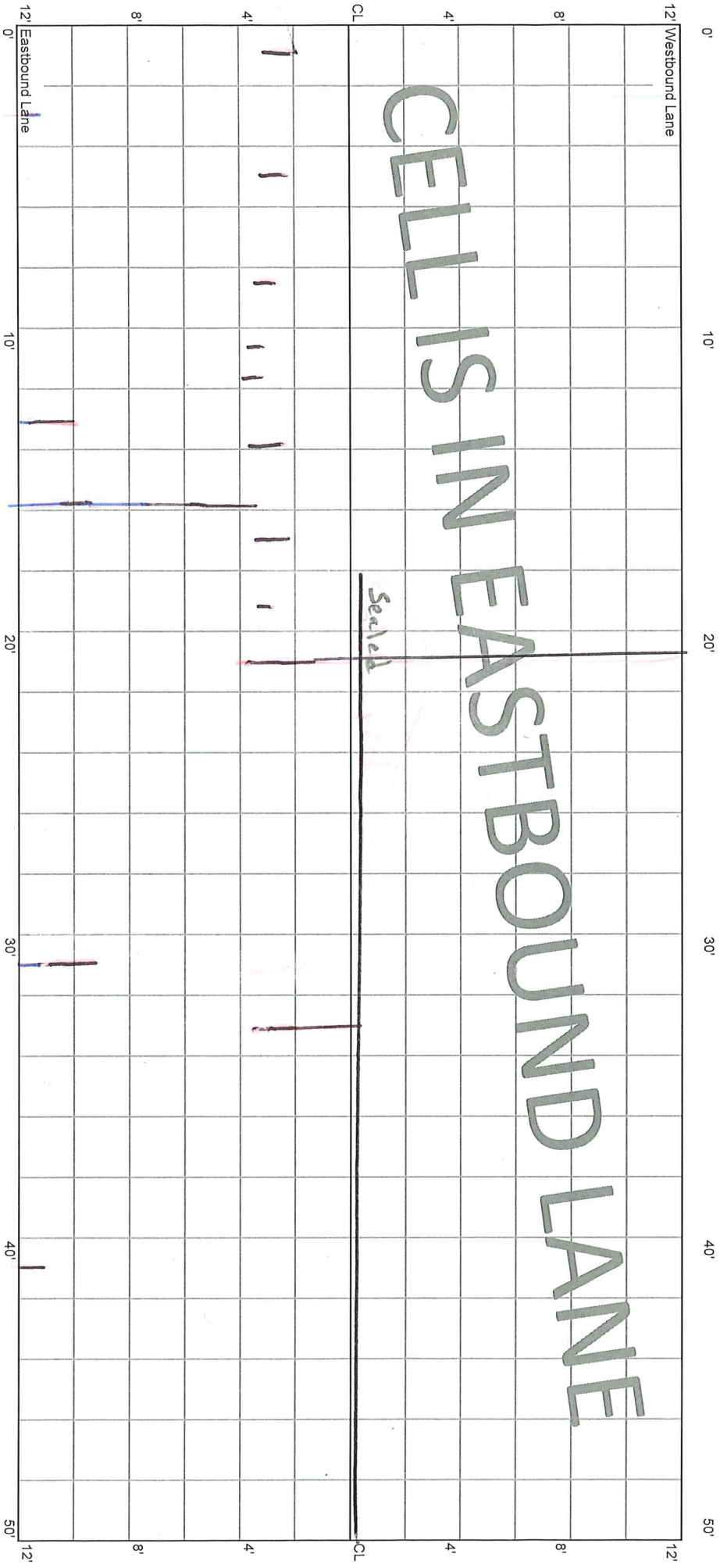

Jan '23 - CL St capped



CELL 7003E  
400 - 450 ft

15+00

15+50

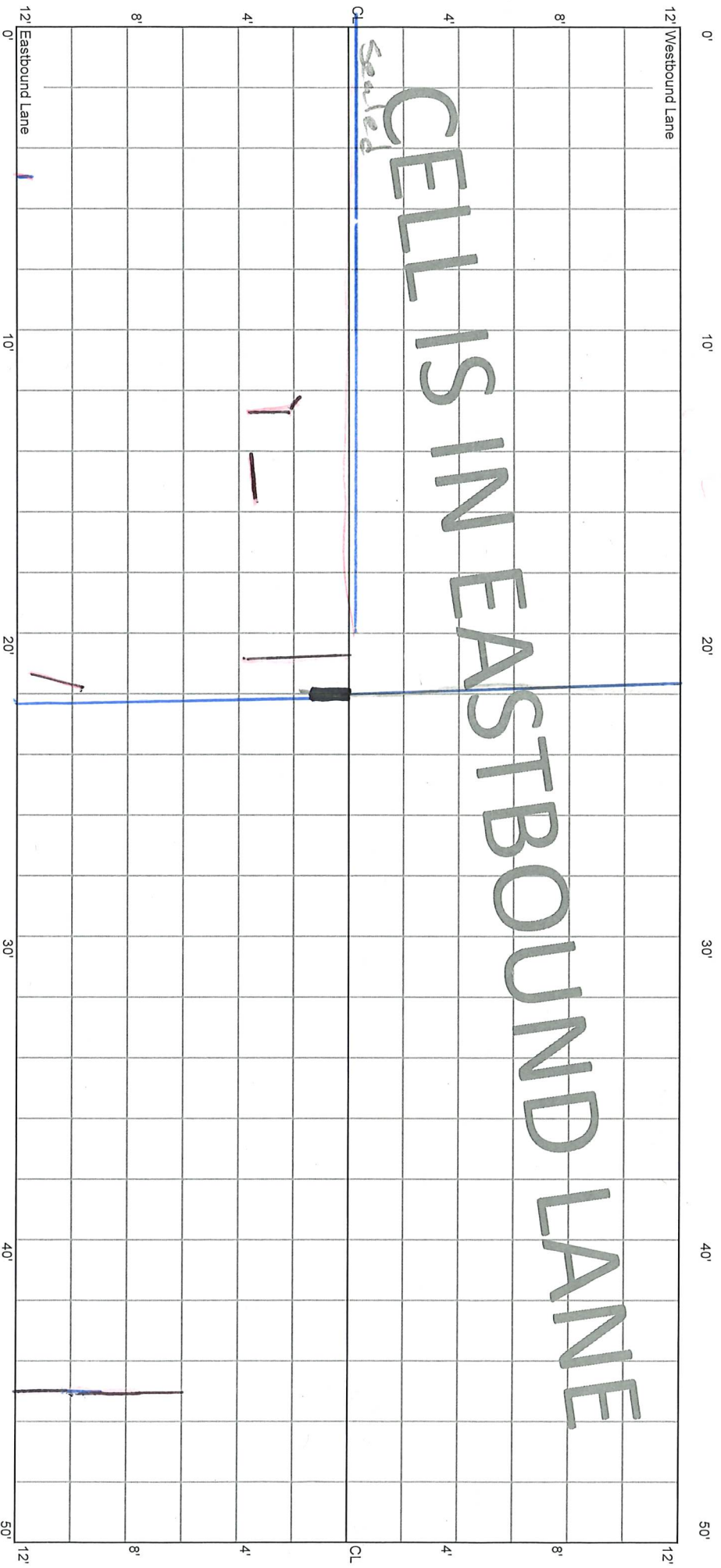

CELLS IN EASTBOUND LANE

\*M

Jan '23 - CL JT capped

CELL 7003E  
450 - 500 ft

15+50

16+00

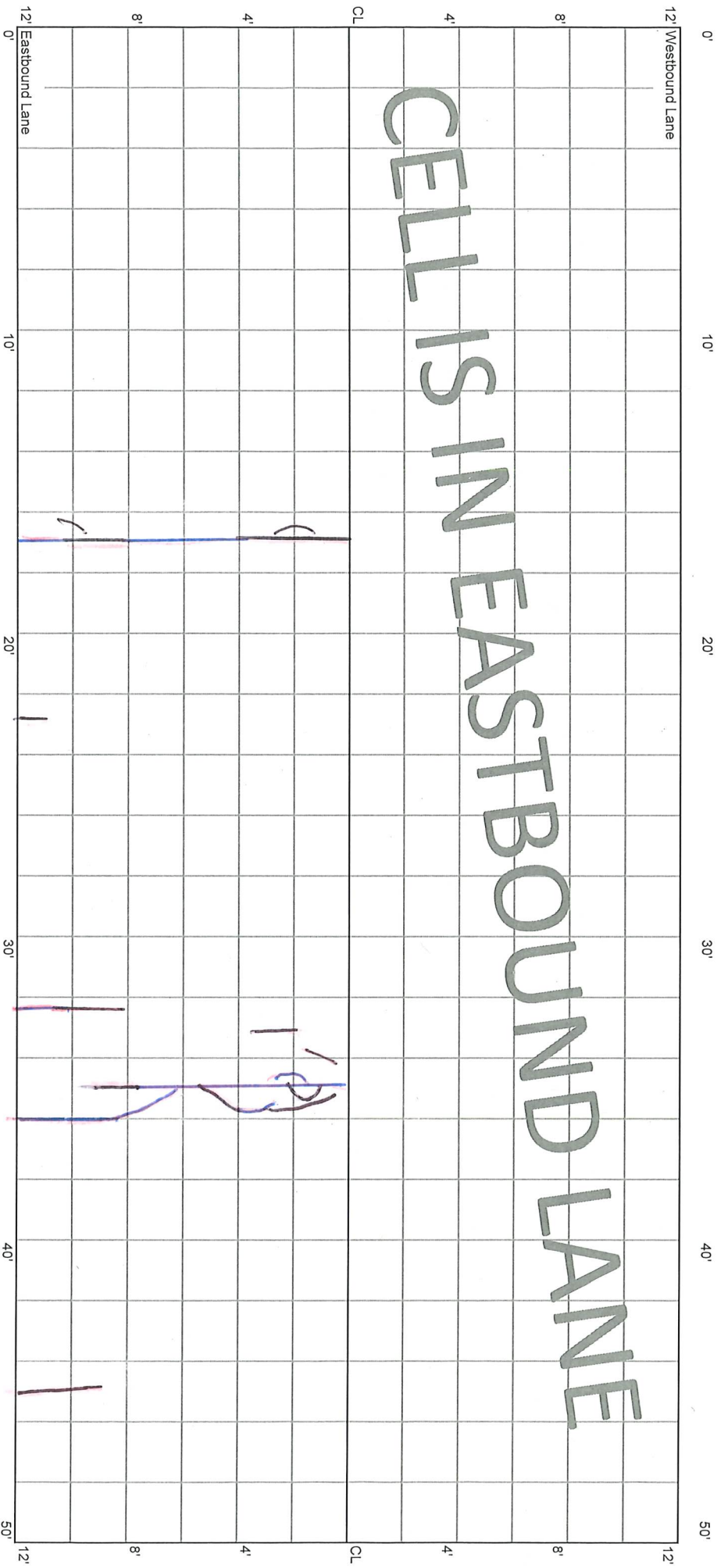

CELL 7003E  
500 - 550 ft

16+00

16+25

16+50

12' Westbound Lane

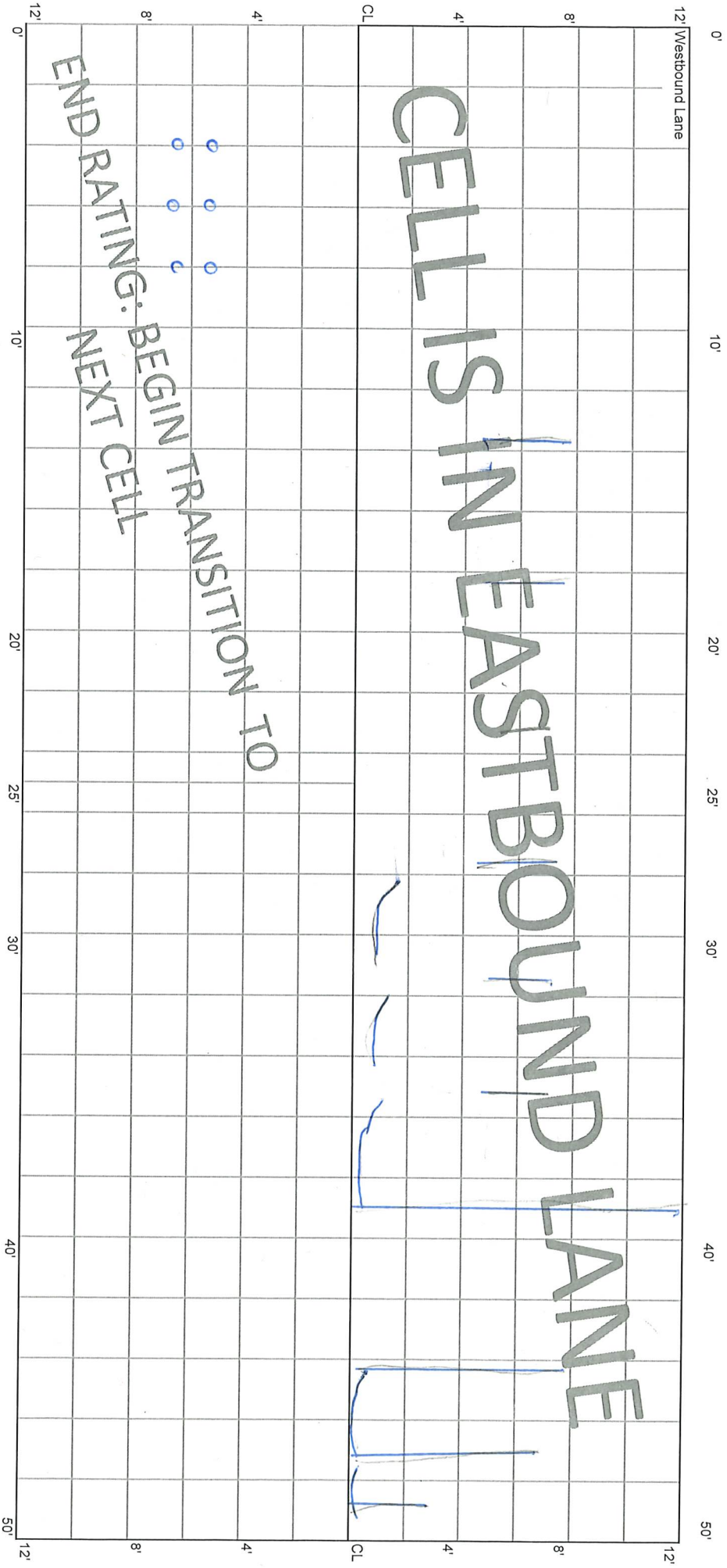

(03 Oct '20)  
Lares