

YOKE

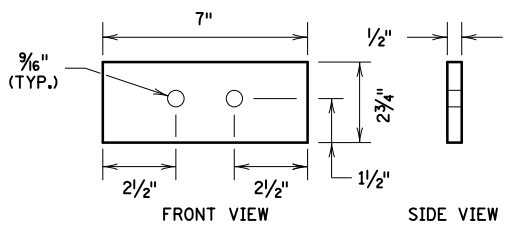

YOKE SPACER

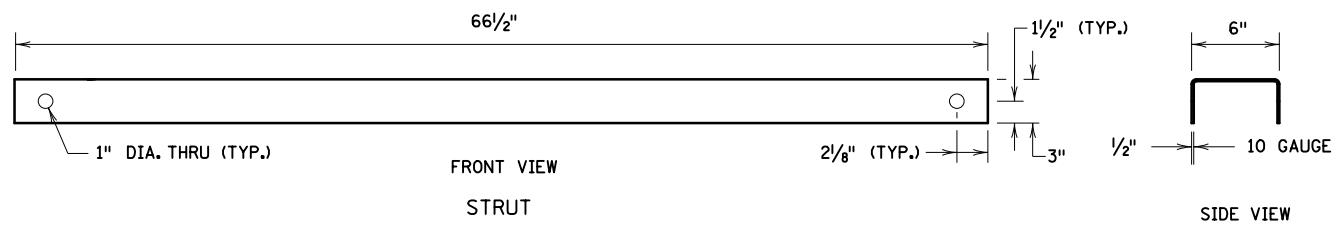

STRUT

SIDE VIEW

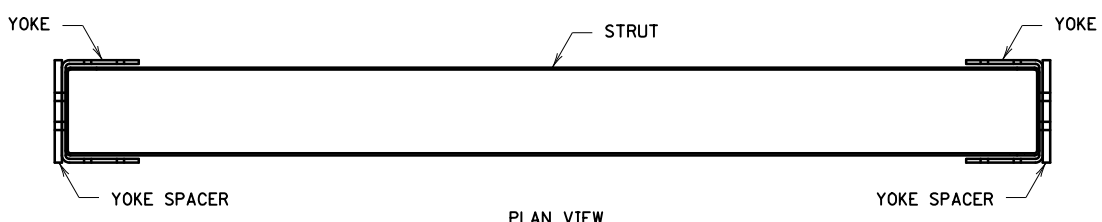

STRUT/YOKE/YOKE SPACER

NOTE:
STRUT AND YOKE COMPONENTS IN ACCORDANCE WITH
ASTM A36 AND ASTM A123.

APPROVED 02-09-2023
Ron S...
STATE DESIGN ENGINEER

STATE OF MINNESOTA
DEPARTMENT OF TRANSPORTATION
**TRAILING END ANCHOR
STRUT AND YOKE**

SPECIFICATION
REFERENCE
3306
3394

STANDARD
PLATE
NO.
8380A