

12' 6" THRIE-BEAM RAIL
(STANDARD POST SPACING SLOTS SHOWN)

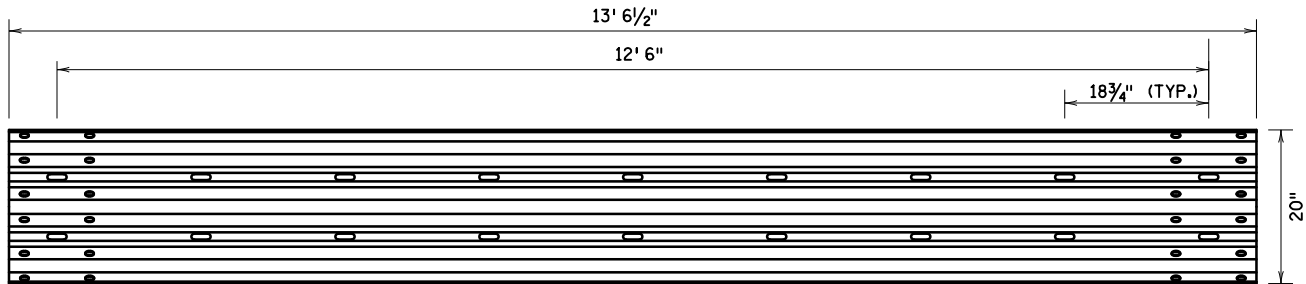

12' 6" THRIE-BEAM RAIL
(1/4" POST SPACING SLOTS SHOWN)

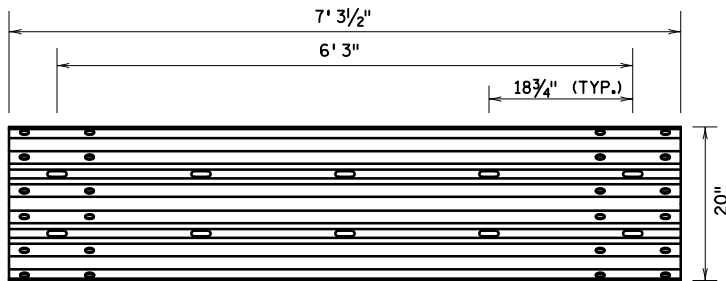

6' 3" THRIE-BEAM RAIL
(1/4" POST SPACING SLOTS SHOWN)

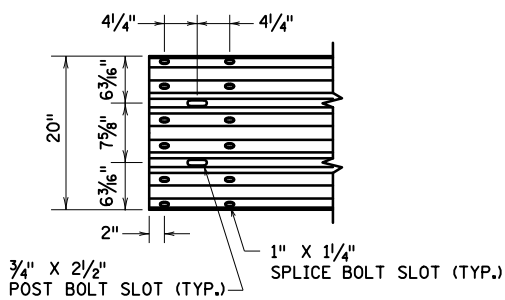

SPLICE BOLT/POST BOLT DETAIL

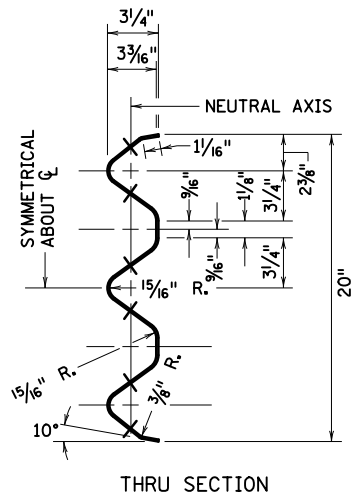

THRU SECTION

APPROVED JULY 1, 2019

 STATE DESIGN ENGINEER

STATE OF MINNESOTA
 DEPARTMENT OF TRANSPORTATION
THRIE-BEAM GUARDRAIL

SPECIFICATION
 REFERENCE
 3382

STANDARD
 PLATE
 NO.
8357A