

PLOTTED/REVISED: 12-APR-2023

DISTRICT \*: Metro  
PLOT NAME: T\_2413865\_sgl\_SHEET 1  
FILENAME: Projects\DM\_FOS\012\0000\Traffic\Signal\56.59\_20275\_CARLSON PKWY-12 OAKS-2413865\T\_2413865\_sgl.dgn

**DETECTOR CHART**

DETECTOR	CAMERA	LOCATION
CAMERA (V-1)	D1-1,D1-2	5 & 35
CAMERA (V-3)	D2-1,D2-2	250
CAMERA (V-2)	D3-1,D3-2	5, 120
CAMERA (V-4)	D4-1,D4-2	5, 120
CAMERA (V-3)	D5-1,D5-2	5 & 35
CAMERA (V-1)	D6-1,D6-2	250
CAMERA (V-4)	D7-1,D7-2	5, 120
CAMERA (V-2)	D8-1,D8-2	5, 120

-LOCATION: DISTANCE FROM STOP BAR IN FEET

**SIGNAL HEAD CHART**

FACE	R	Y	FYA	G
1-1, 1-2	←	←	←	←
2-1, 2-2, 2-3	●	●	●	●
3-1, 3-2	←	←	←	←
4-1, 4-2	●	●	●	●
5-1, 5-2	←	←	←	←
6-1, 6-2, 6-3	●	●	●	●
7-1, 7-2	←	←	←	←
8-1, 8-2	●	●	●	●

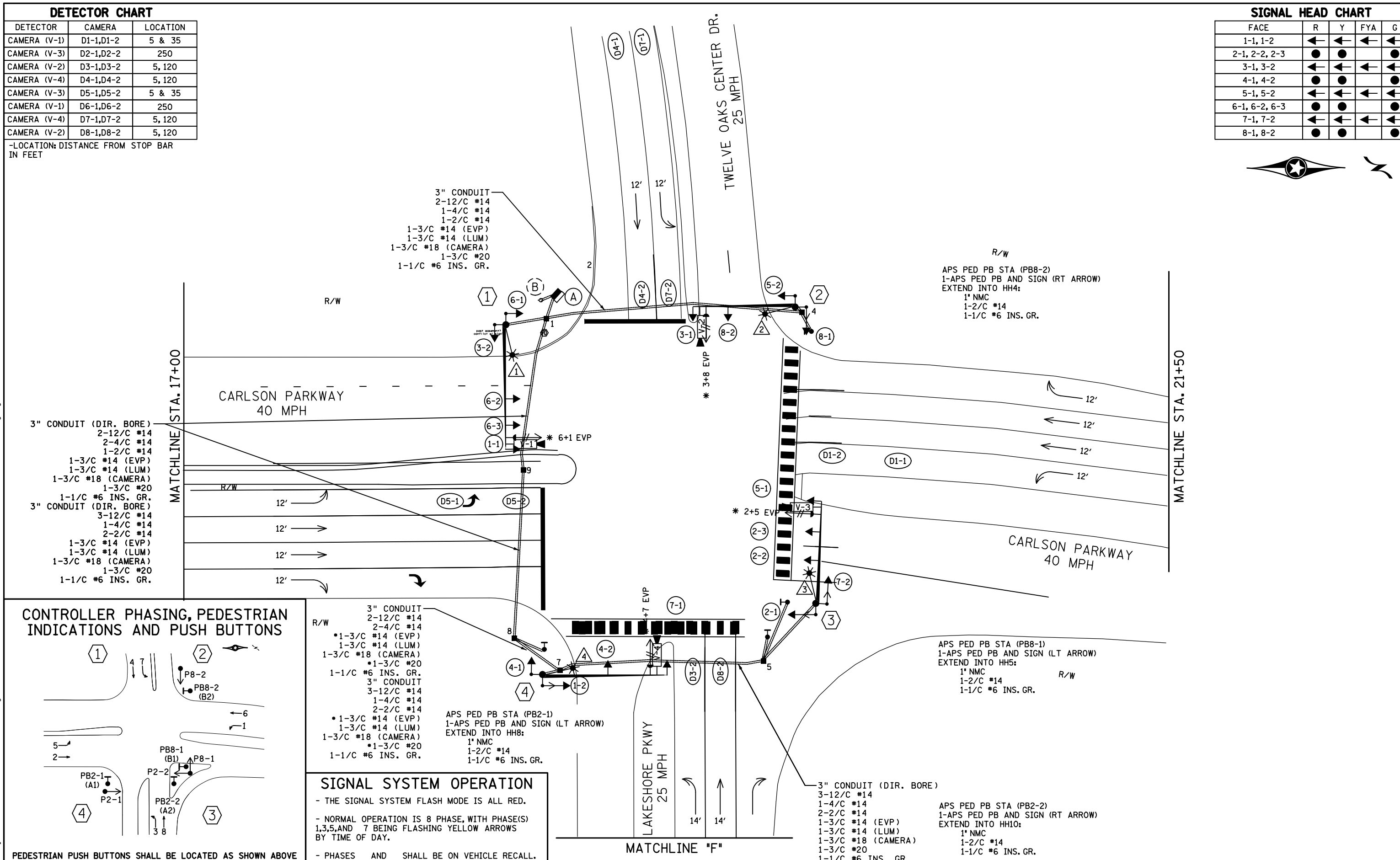

**CONTROLLER PHASING, PEDESTRIAN INDICATIONS AND PUSH BUTTONS**

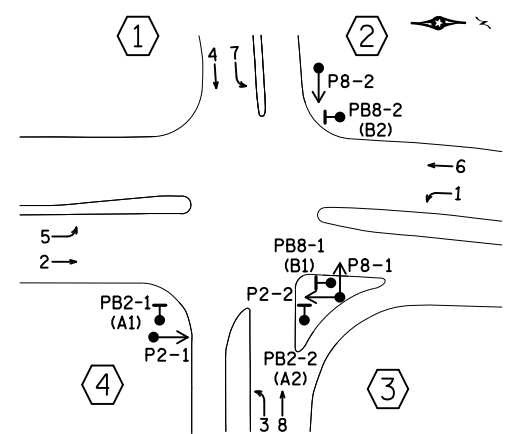

PEDESTRIAN PUSH BUTTONS SHALL BE LOCATED AS SHOWN ABOVE

3" CONDUIT  
2-12/C #14  
2-4/C #14  
\*1-3/C #14 (EVP)  
1-3/C #14 (LUM)  
1-3/C #18 (CAMERA)  
\*1-3/C #20  
1-1/C #6 INS. GR.

3" CONDUIT (DIR. BORE)  
3-12/C #14  
1-4/C #14  
2-2/C #14  
1-3/C #14 (EVP)  
1-3/C #14 (LUM)  
1-3/C #18 (CAMERA)  
1-3/C #20  
1-1/C #6 INS. GR.

3" CONDUIT  
2-12/C #14  
2-4/C #14  
\*1-3/C #14 (EVP)  
1-3/C #14 (LUM)  
1-3/C #18 (CAMERA)  
\*1-3/C #20  
1-1/C #6 INS. GR.

3" CONDUIT (DIR. BORE)  
3-12/C #14  
1-4/C #14  
2-2/C #14  
1-3/C #14 (EVP)  
1-3/C #14 (LUM)  
1-3/C #18 (CAMERA)  
1-3/C #20  
1-1/C #6 INS. GR.

APS PED PB STA (PB2-1)  
1-APS PED PB AND SIGN (LT ARROW)  
EXTEND INTO HH8:  
1' NMC  
1-2/C #14  
1-1/C #6 INS. GR.

**SIGNAL SYSTEM OPERATION**

- THE SIGNAL SYSTEM FLASH MODE IS ALL RED.

- NORMAL OPERATION IS 8 PHASE, WITH PHASE(S) 1,3,5, AND 7 BEING FLASHING YELLOW ARROWS BY TIME OF DAY.

- PHASES AND SHALL BE ON VEHICLE RECALL.

BY	DATE	REVISIONS
HRL	2/9/22	RECORD PLAN

SYSTEM ID: 2413865 T.E. 8387  
METER ADDRESS:  
OLD SYSTEM ID: 20275

**TRAFFIC CONTROL SIGNAL SYSTEM INTERSECTION LAYOUT**  
T.H. 12 AT 12 OAK IN WAYZATA , HENNEP COUNTY

S.A.P. NO.	DRAWN BY:HRL	CKD BY:CDB	DATE:

CERTIFIED BY \_\_\_\_\_ LIC. NO. \_\_\_\_\_ DATE: \_\_\_\_\_  
STATE PROJ.NO. 2714-144 (T.H.12) SHEET NO. 1 OF 5 SHEETS

PLOTTED/REVISED: 12-APR-2023

DISTRICT \*: Metro  
 IPLOT NAME: T\_2413865\_sgl\_SHEET 2  
 FILENAME: Projects\DM\_FROSV02\0000\Traffic\Signals\56.59\_20275\_CARLSON PKWY-12 OAKS-2413865\T\_2413865\_sgl.dgn

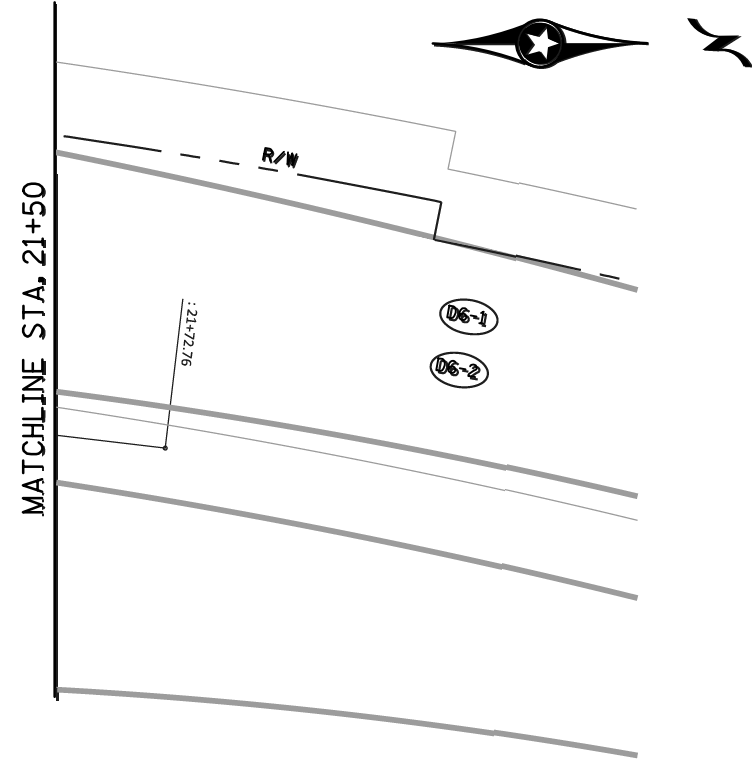
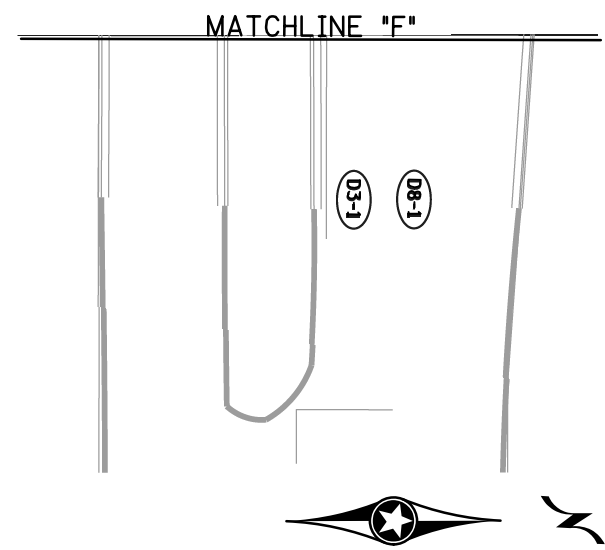
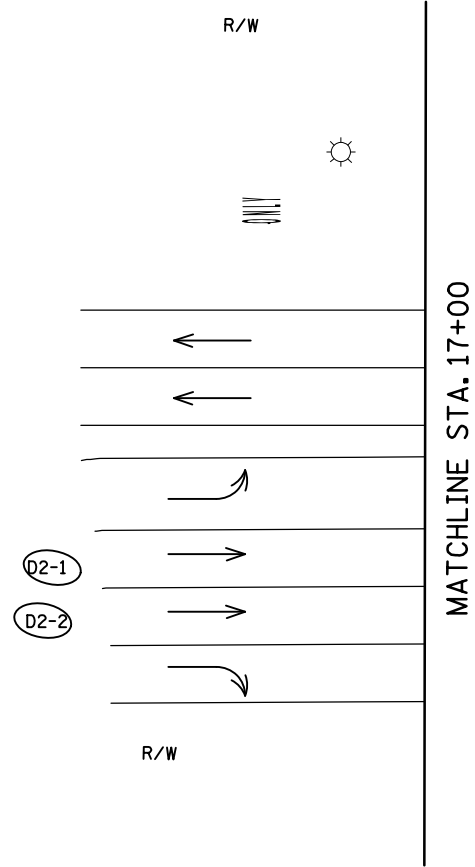

BY	DATE	REVISIONS
HR	2/9/22	RECORD PLAN

SYSTEM ID: 2413865 T.E. 8387  
 METER ADDRESS:  
 OLD SYSTEM ID: 20275

**TRAFFIC CONTROL SIGNAL SYSTEM  
 MATCHLINE LAYOUT**  
 T.H. 12 AT 12 OAK IN WAYZATA , HENN COUNTY

S.A.P. NO.	DRAWN BY: HRL	CKD BY: CDB	DATE:
CERTIFIED BY _____	LIC. NO. _____	DATE: _____	
STATE PROJ. NO. 2714-144 (T.H.12)		SHEET NO. 2 OF	5 SHEETS



PLOTTED/REVISED: 12-APR-2023

DISTRICT \*: Metro  
 IPLOT NAME: T\_2413865\_sgl\_SHEET 4  
 FILENAME: Projects\DM\_PROS\012\0000\Traffic\Signal\56.59\_20275\_CARLSON\_PKWY-12\_OAKS-2413865\T\_2413865\_sgl.dgn

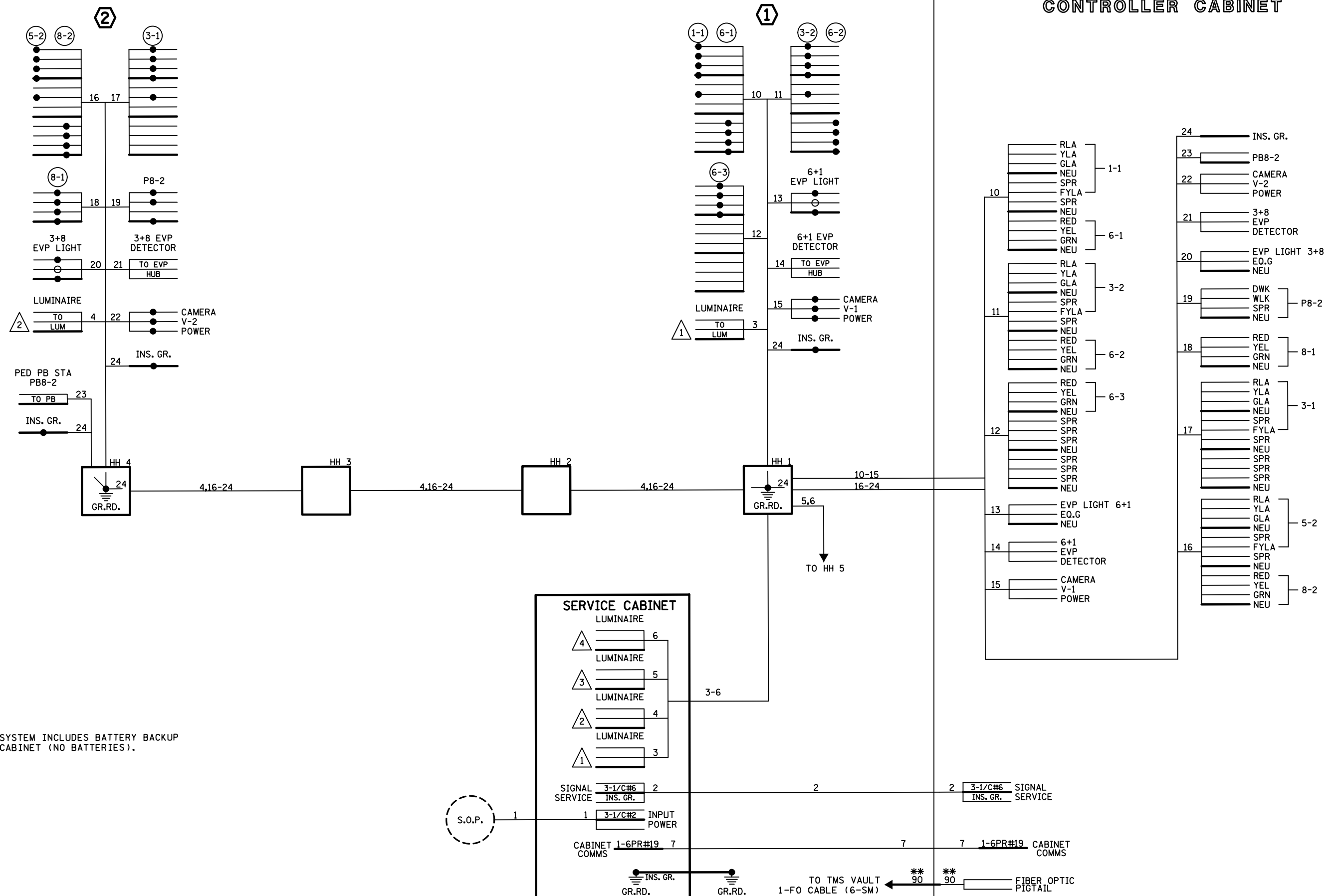

NOTES:  
 1. SIGNAL SYSTEM INCLUDES BATTERY BACKUP SERVICE CABINET (NO BATTERIES).

BY	DATE	REVISIONS	SYSTEM ID: 2413865	T.E. 8387	S.A.P. NO.	DRAWN BY: HRL	CKD BY: CDB	DATE:
HRL	2/9/22	RECORD PLAN	METER ADDRESS:		CERTIFIED BY _____			LIC. NO. _____ DATE: _____
			OLD SYSTEM ID: 20275		STATE PROJ. NO. 2714-144 (T.H.12) SHEET NO. 4 OF 5 SHEETS			

**TRAFFIC CONTROL SIGNAL SYSTEM  
 FIELD WIRING DIAGRAM  
 T.H. 12 AT 12 OAK IN WAYZATA, HENN COUNTY**

# CONTROLLER CABINET

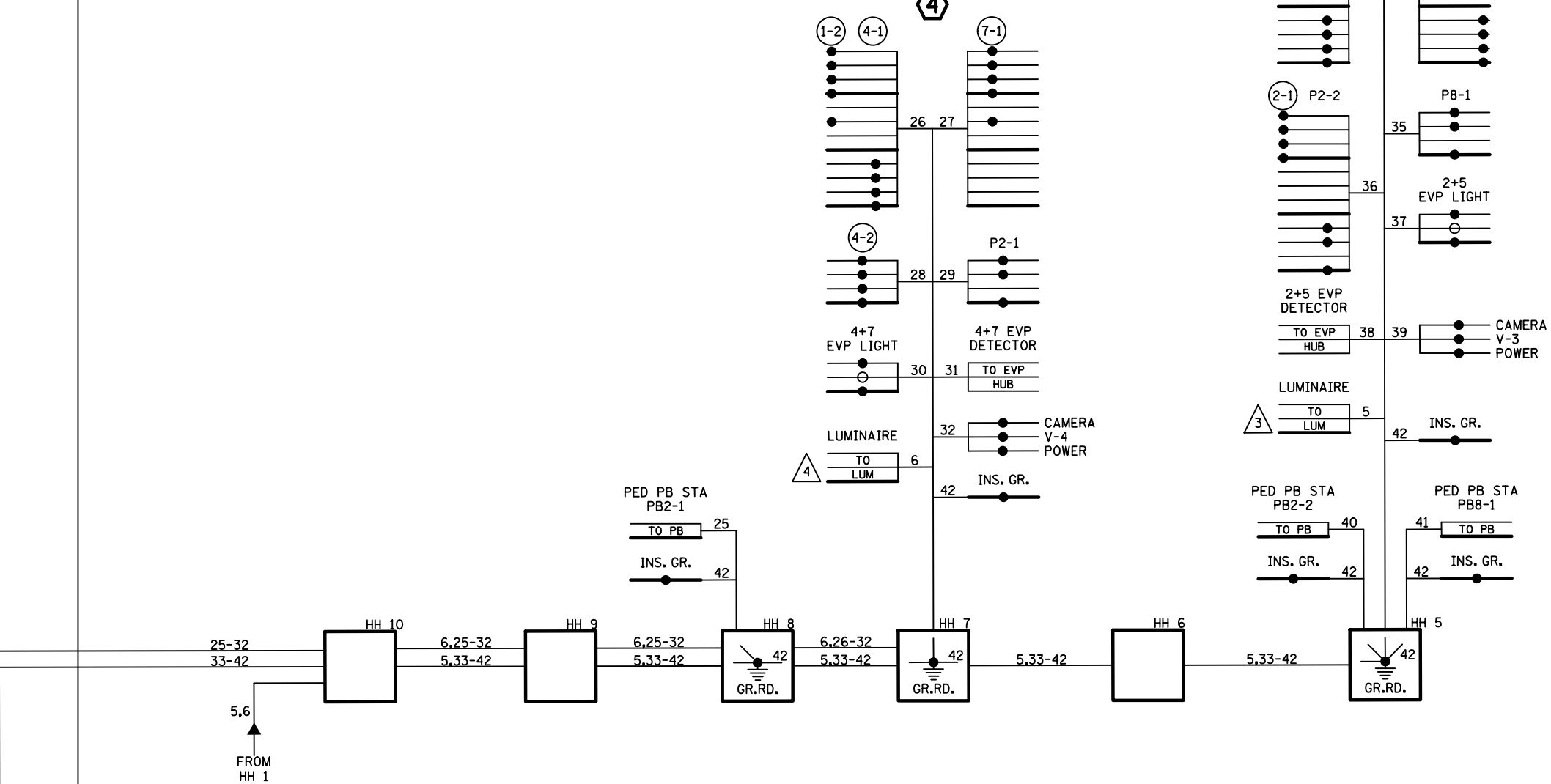
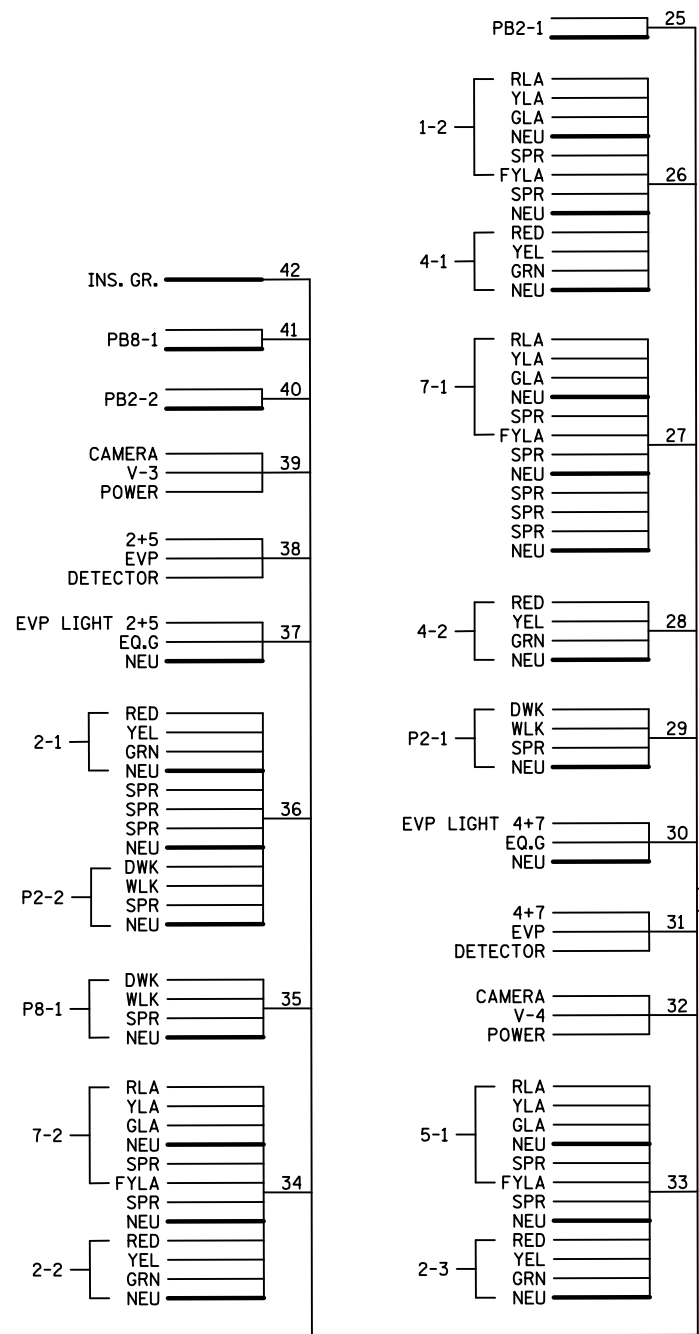

NOTES:  
1. SIGNAL SYSTEM INCLUDES BATTERY BACKUP SERVICE CABINET (NO BATTERIES).

PLOTTED/REVISED: 12-APR-2023

DISTRICT \*: Metro  
PLOT NAME: T\_2413865\_sgl\_SHEET 5  
FILENAME: Projects\DM\_FOS\012\0000\Traffic\Signal\56.59\_20275\_CARLSON PKWY-12 OAKS-2413865\T\_2413865\_sgl.dgn

BY	DATE	REVISIONS
HRL	2/9/22	RECORD PLAN

SYSTEM ID: 2413865 T.E. 8387  
METER ADDRESS:  
OLD SYSTEM ID: 20275

**TRAFFIC CONTROL SIGNAL SYSTEM  
FIELD WIRING DIAGRAM  
T.H. 12 AT 12 OAK IN WAYZATA , HENN COUNTY**

S.A.P. NO.	DRAWN BY:HRL	CKD BY:CDB	DATE:
CERTIFIED BY _____	LIC. NO. _____	DATE: _____	
STATE PROJ.NO. 2714-144 (T.H.12)		SHEET NO. 5 OF	5 SHEETS

# FIBER OPTIC SCHEMATIC (FOR SIGNAL COMMUNICATIONS)

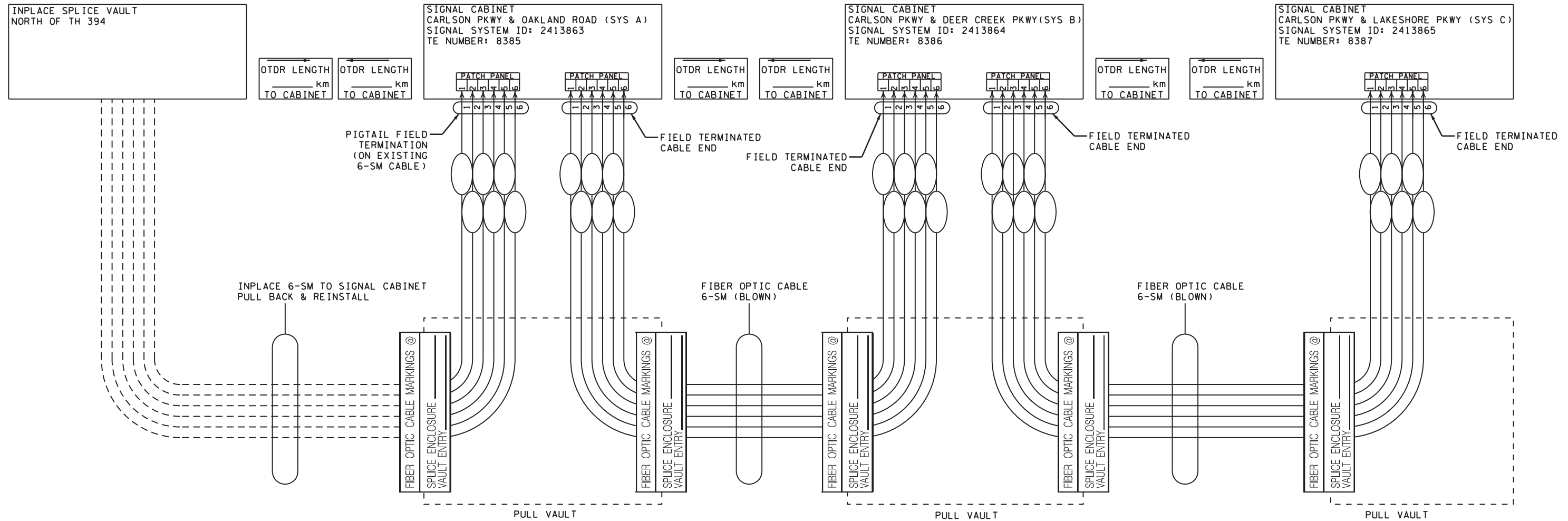

**NOTE:**  
SEE SPECIAL PROVISIONS FOR DETAILS  
ON CONNECTING, TESTING, AND SPLICING.

TRAFFIC CONTROL INTERCONNECT DETAILS

bmi.tbi

pdf-B and W.pltcfq  
1/18/2019 12:55:51 PM

zachary.pd  
1/18/2019

H:\MTKA\T19116771\CAD\MS\plans\Signal\cd2714144\_ipd\_005.dgn

I HEREBY CERTIFY THAT THIS PLAN, SPECIFICATION, OR REPORT WAS PREPARED BY ME OR UNDER MY DIRECT SUPERVISION AND THAT I AM A DULY LICENSED PROFESSIONAL ENGINEER UNDER THE LAWS OF THE STATE OF MINNESOTA.

*Bryan T. Nemeth*  
BRYAN T. NEMETH  
LIC. NO. 43354 DATE 12-20-2018



12224 NICOLLET AVENUE  
BURNSVILLE, MINNESOTA 55337  
Phone: (952) 890-0509  
Email: Burnsville@bolton-menk.com  
www.bolton-menk.com



DESIGNED ZAP	REV.	BY	DATE
DRAWN ZAP			
CHECKED BTN			

**CARLSON PARKWAY IMPROVEMENTS**  
S.P. 2714-144 (TH 12), S.A.P. 142-152-009  
**SIGNAL INTERCONNECT PLAN**

SHEET  
88  
OF  
90