

**ELEVATION**  
CONCRETE NOT SHOWN

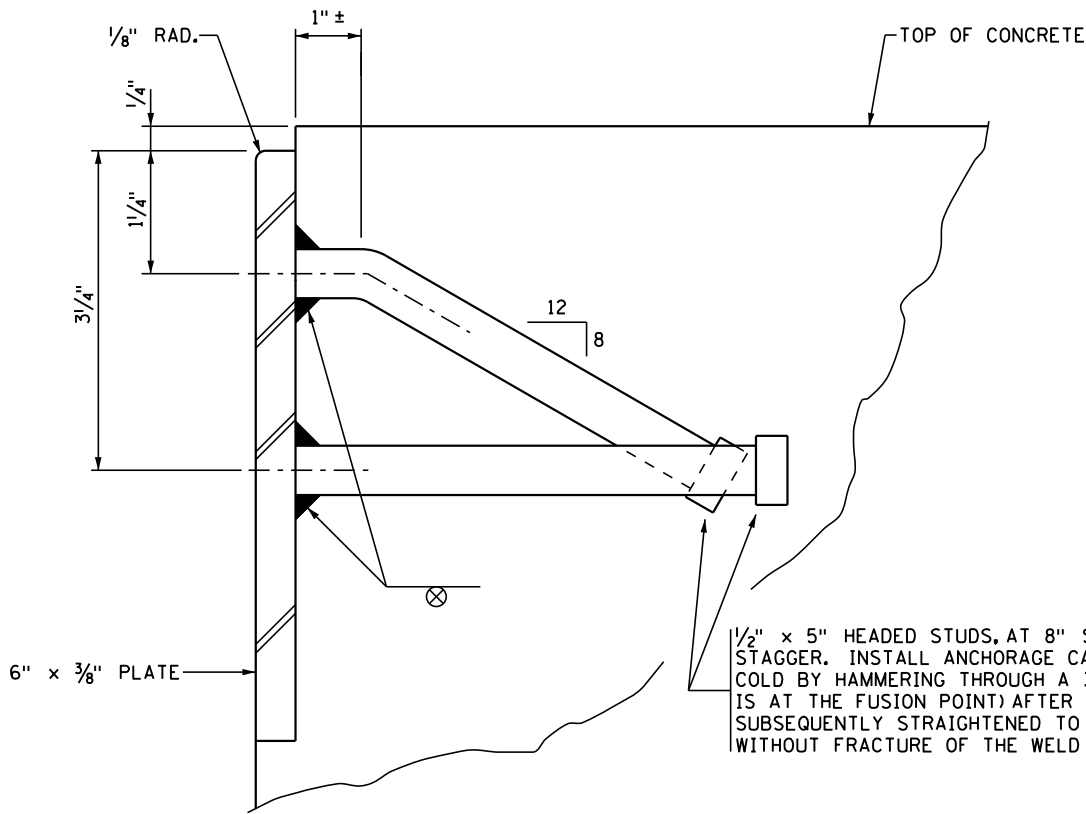

**SECTION A-A**

1/2" x 5" HEADED STUDS, AT 8" SPACING WITH ALTERNATE STAGGER. INSTALL ANCHORAGE CAPABLE OF BEING BENT COLD BY HAMMERING THROUGH A 30° ANGLE (THE APEX OF WHICH IS AT THE FUSION POINT) AFTER WELDING AND SUBSEQUENTLY STRAIGHTENED TO ITS ORIGINAL POSITION WITHOUT FRACTURE OF THE WELD OR ANCHORAGE.

**NOTES:**

EXTEND PLATES FULL WIDTH OF ROADWAY BETWEEN GUTTER LINES WITH A 1/2" OPEN JOINT AT EACH BREAK IN CROWN PROFILE. MAX. LENGTH 22 FT.

PROVIDE STRUCTURAL STEEL IN ACCORDANCE WITH SPEC. 3306. GALVANIZE AFTER FABRICATION IN ACCORDANCE WITH SPEC. 3394.

SET PLATE TO PROPER GRADE AND CROWN.

APPROVED: NOVEMBER 22, 2002  
*Daniel J. Morgan*  
STATE BRIDGE ENGINEER

STATE OF MINNESOTA  
DEPARTMENT OF TRANSPORTATION  
**PROTECTION PLATE**  
(FOR END OF SLAB)

REVISION  
01-05-2017  
11-29-2023

DETAIL NO.  
**B553**