



CONSTRUCTION PROJECT LOG

Prepared by

Office of Transportation System Management

Last updated on: 10-7-2022

Control Section 7307

TRUNK HIGHWAY: MN28

COUNTY: Stearns

DISTRICT: 3 (Brainerd)

LIMITS:
JCT US-71 to Pope-Stearns County Line
Ref. Pt. 092+00.591 - 101+00.722

NOTES: CONTROL SECTION NOTES FROM SDW

Symbology:

Stick Map Legend				
Highway	State-Aid	Non State-Aid	City Limit	Bridge
			■ ■ ■ ■ ■ ■ ■ ■	◆

DISCLAIMER: If you encounter broken hyperlinks, please fill out Data Practice Form:

<http://www.dot.state.mn.us/information/datapractices/index.html>

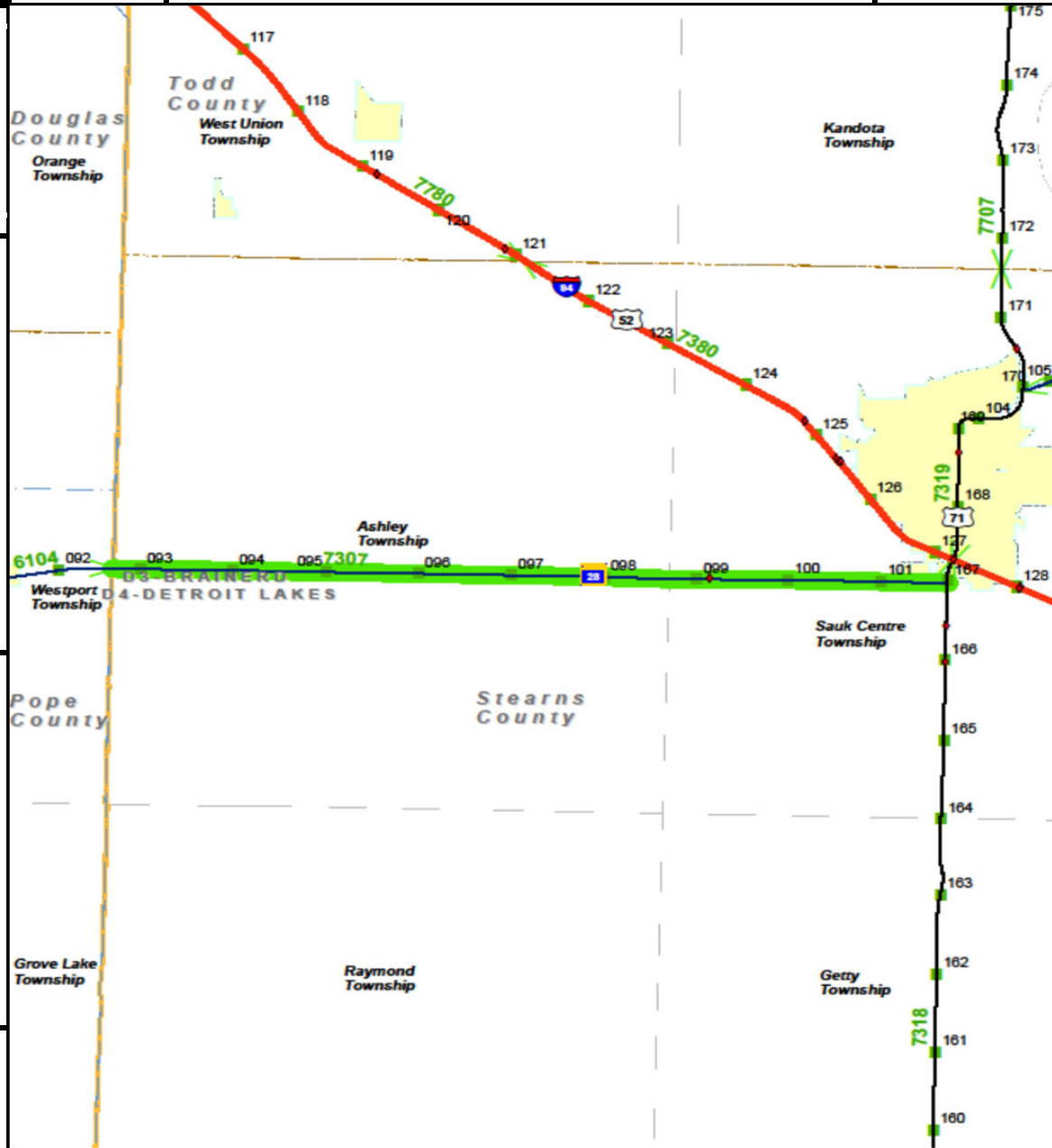

PREPARED BY
HIGHWAY PLANNING SURVEY
IN COOPERATION WITH
U.S. PUBLIC ROADS ADMINISTRATION

STATE OF MINNESOTA
DEPARTMENT OF HIGHWAYS
ROAD LIFE STUDIES
CONSTRUCTION PROJECT LOG RECORD

CONTROL SECTION 7307
TRUNK HIGHWAY 76
COUNTY Stearns
DISTRICT 35

LIMITS: W. Co. Line - S. Jct. T.H. 71

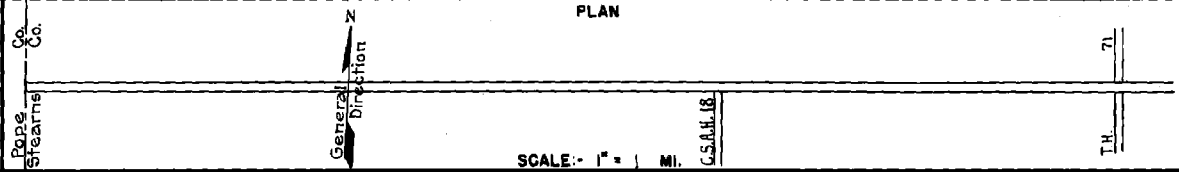

YEAR BUILT	PROJECT N ^o	DESCRIPTION			CODE N ^o	PLAN
		TYPE	WIDTH	THICKNESS		
1923	26-26-23B	Grading Gravel	30 24	4 1/4"		1 9.52
	(1)					
1931	26-26-23B	Oil Tr. Gravel	26	1"	12454 Gal./Mile. Maint. Dept.	2 9.52 0.91 8.61
1938	A.F.E. 33	Stab. Gravel	30	4"	Maint. Dept.	3 8.61
1939	A.F.E. 17	Mixed Bitum.	26	1"	Maint. Dept.	4 8.61
M	1941 A.F.E. 50	Spot Treat. Bit. Surf. Repair	26		SC3 R0.920 Gal./Mi. Grav. 67 C.Y./Mi. Maint. Dept.	5 9.52
M	1942 A.F.E. 4	Spot Treat. Bit. Surf. Repair	26		SC3b RT-6.3724 Gal./Mi. Grav. 182 C.Y./Mi. Maint. Dept.	6 9.52
M	1943 A.F.E. 4	Spot Treat. Bit. Surf. Repair	26		MG3.1857 Gal./Mi. Grav. 79 C.Y./Mi. Maint. Dept.	7 9.52
M	1944 A.F.E. 4	Spot Treat. Bit. Surf. Repair	26		MG3.3797 Gal./Mi. Grav. 156 C.Y./Mi. Maint. Div.	8 9.52
M	1945 A.F.E. 4	Spot Treat. Bit. Surf. Repair	26		SC-3.1793 Gal./Mi. Grav. 89 C.Y./Mi. Maint. Div.	9 9.52
M	1946 A.F.E. 4	Spot Treat. Bit. Surf. Repair	24		RT-A. 1900 Gal. Agg. 147 C.Y.	10 9.52 (Net 0.37)
M	1947 A.F.E. 4	Spot Treat. Bit. Surf. Repair			SC-3.29395 Gal. Agg. 1977 C.Y.	11 9.52 (Net 2.75)
M	1948 A.F.E. 4	Spot Treat. Bit. Surf. Repair	24		SC3.22227 Gal. Agg. 1645 Tons	12 9.52 (Net 2.35)
M	1949 A.F.E. 4	Spot Treat. Bit. Surf. Repair	24		SC3.18416 Gal. Agg. 1421 Tons	13 9.52 (Net 2.02)
M	1950 A.F.E. 4	Spot Treat. Bit. Surf. Repair	24		SC-3.36769 Gal. Agg. 2266 C.Y.	14 9.52 (Net 4.45)

YEARS FROM	TO	TOTAL MILES	UNINCORPORATED		INCORPORATED		RURAL		URBAN	
			RDWY. MI.	BR. MI.	RDWY. MI.	BR. MI.	RDWY. MI.	BR. MI.	RDWY. MI.	BR. MI.
1923	1952	9.52	8.51	0.00	1.01	0.00	8.51	0.00	1.01	0.00
1953	1955	9.52	8.96	0.00	0.56	0.00	8.96	0.00	0.56	0.00
1956		9.01	9.01	0.00	0.00	0.00	9.01	0.00	0.00	0.00

REMARKS: Layout is to scale as of 1923

(1) This work not done under this project number but lies within the limits of this project.

PREPARED BY
HIGHWAY PLANNING SURVEY
IN COOPERATION WITH
U.S. PUBLIC ROADS ADMINISTRATION

STATE OF MINNESOTA
DEPARTMENT OF HIGHWAYS
ROAD LIFE STUDIES
CONSTRUCTION PROJECT LOG RECORD

CONTROL SECTION 7307
TRUNK HIGHWAY 28
COUNTY Stearns
DISTRICT 3B

LIMITS: W. Co. Line - S. Jct. T.H. 71
Ref. Pt. 092+00.592 - 101+00.723

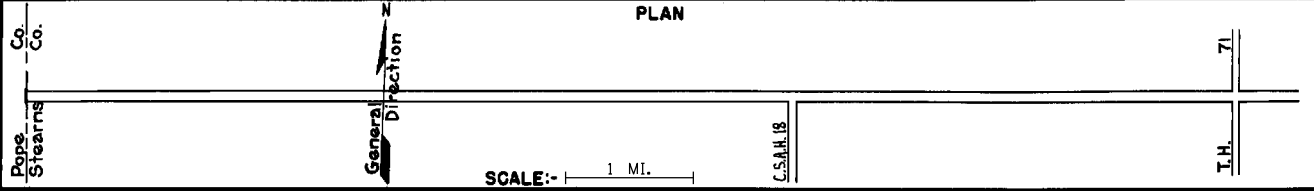

YEAR BUILT	PROJECT N ^o	DESCRIPTION			CODE N ^o
		TYPE	WIDTH	THICKNESS	
M 1951	A.F.E. 4	Spot Treat. Bit. Surf. Repair	24'		
M 1952	A.F.E. 4	Spot Treat. Bit. Surf. Repair	24'		
M 1953	A.F.E. 604	Spot Treat. Bit. Surf. Repair	24'		
C 1956	7307-05 7307-06	Grading Bit. Stab. base Plant Mix Bit.	36' 36' 24'	6" 2"	
M 1959	A.F.E. 605	Bit. Seal Coat	25'		
C 1976	7307-08	Bit. RESURF. & TURN LANES	24'	1 1/2"	
C 1979	7307-09	Bit. SURFACE AGG. SHOULDERS	24'	1 1/2" 8' VAR.	
C 1983	7300-05	Guardrail Improvements			
M 1984	7307 SF	Chip Seal Coat	24'		
C 1990	7307-11	Bit. Overlay	24'	2" 1 1/2"	
M 1993	M93146	Bit. Sealing			
M 2000	8823-13	Bit. Seal Coat			
S 2005	8823-65	Bit. Seal Coat			
2016	8823-310	Micro-Surfacing Bit. Seal Coat	24' 24'		

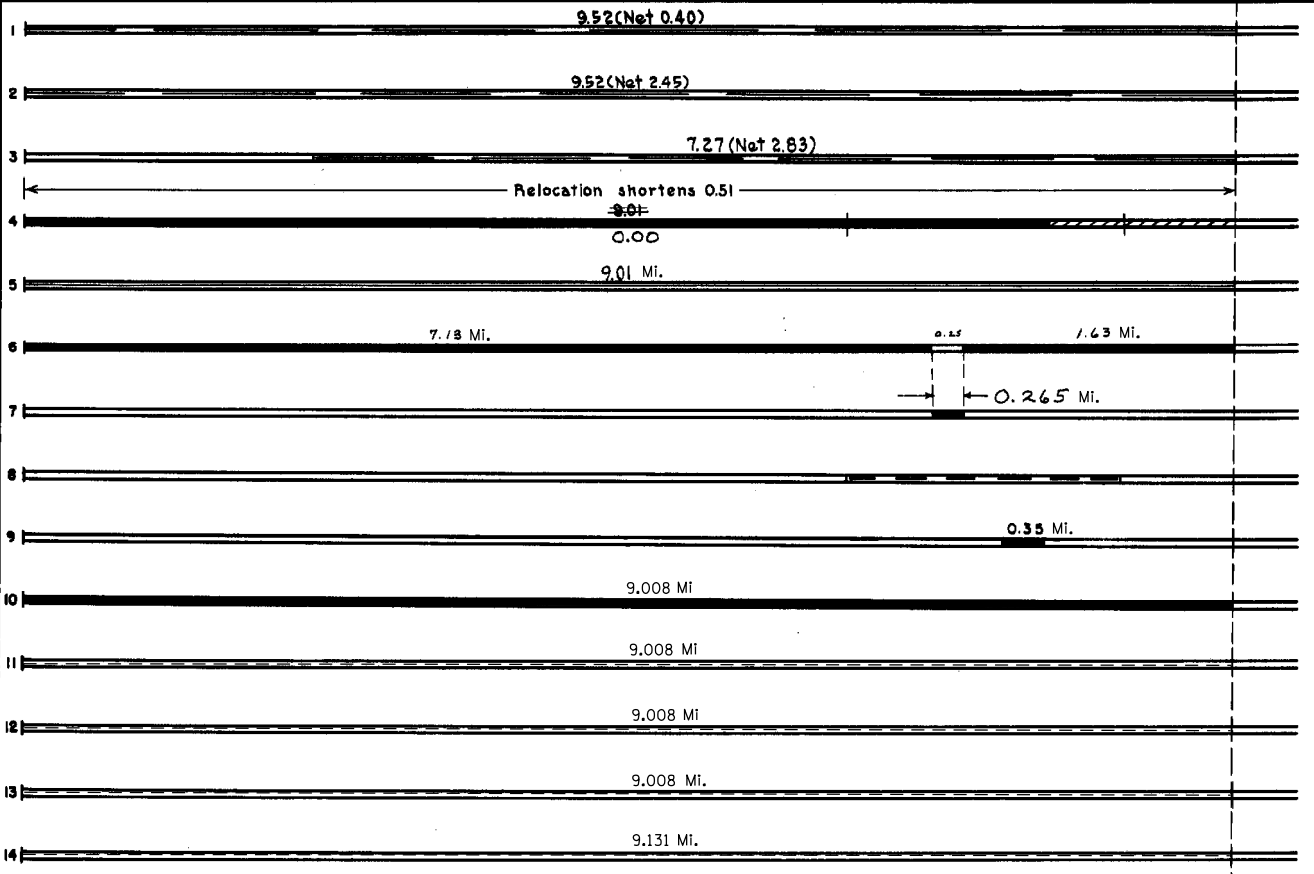

YEARS		TOTAL MILES	UNINCORPORATED		INCORPORATED		RURAL		URBAN	
FROM	TO		RDWY. MI.	BR. MI.	RDWY. MI.	BR. MI.	RDWY. MI.	BR. MI.	RDWY. MI.	BR. MI.

REMARKS: See Sheet No. 1