



**Map of CS# LIMITS:**

0 1/2 1 2  
Mile

**CONSTRUCTION PROJECT LOG**  
Prepared by  
**Office of Transportation System Management**  
Last updated on: 10-7-2022

**Control Section** 3309  
**TRUNK HIGHWAY:** MN27  
**COUNTY:** Kanabec  
**DISTRICT:** 3 (Brainerd)  
**LIMITS:**  
JCT MN-47 to JCT MN-65  
Ref. Pt. 190+00.615 - 197+00.826

**NOTES:** CONTROL SECTION NOTES FROM SDW

**Symbology:**

Stick Map Legend				
Highway	State-Aid	Non State-Aid	City Limit	Bridge
			■	◆

**DISCLAIMER:** If you encounter broken hyperlinks, please fill out Data Practice Form:  
<http://www.dot.state.mn.us/information/datapractices/index.html>

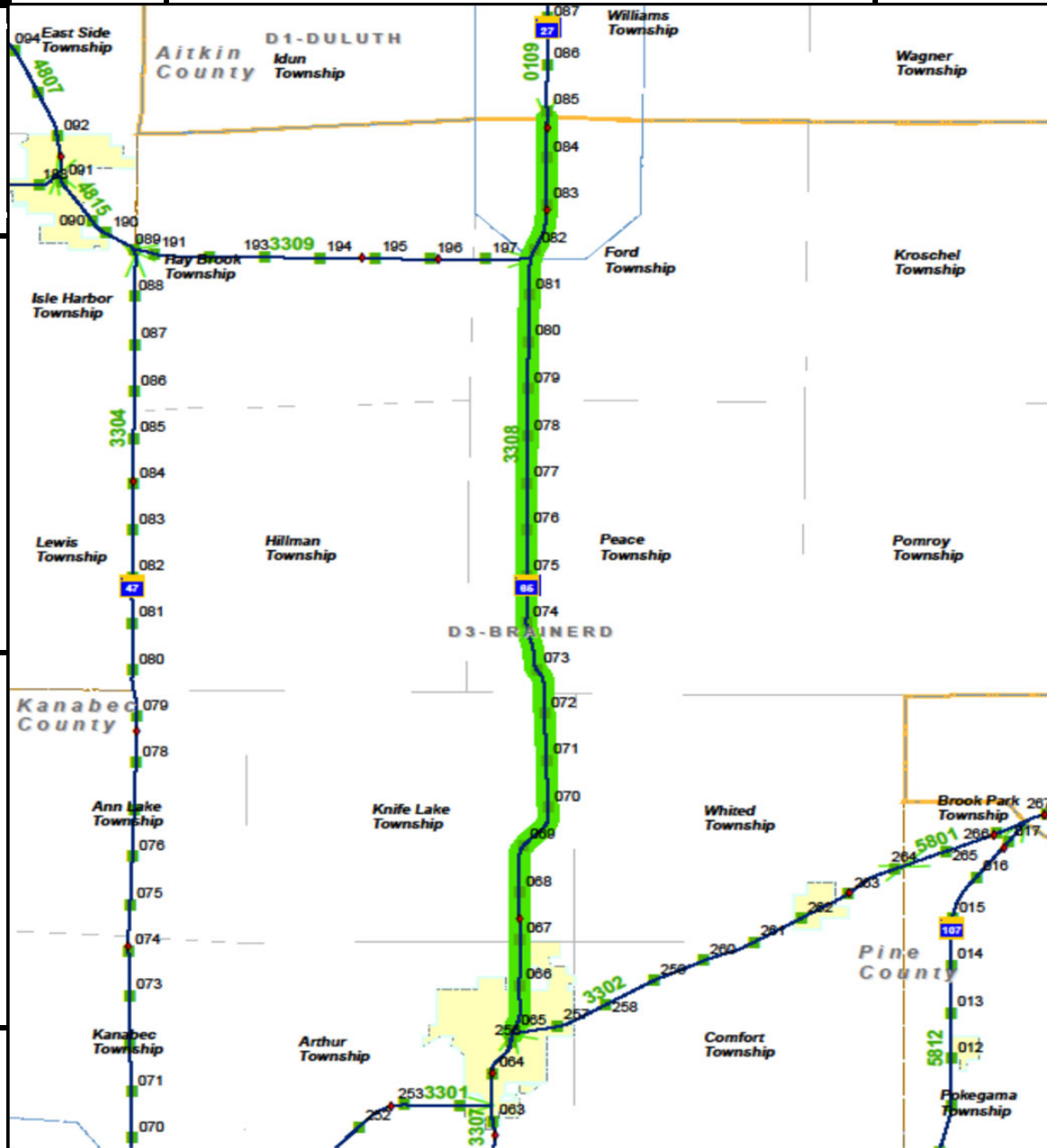

PREPARED BY  
HIGHWAY PLANNING SURVEY  
IN COOPERATION WITH  
U.S. PUBLIC ROADS ADMINISTRATION

STATE OF MINNESOTA  
DEPARTMENT OF HIGHWAYS  
ROAD LIFE STUDIES  
CONSTRUCTION PROJECT LOG RECORD

CONTROL SECTION 3309  
TRUNK HIGHWAY Kanabec  
COUNTY Kanabec  
DISTRICT 38

LIMITS: Jct.T.H.47 at W.Co.Line-Jct.T.H.65

YEAR BUILT	PROJECT N <sup>o</sup>	DESCRIPTION			CODE N <sup>o</sup>
		TYPE	WIDTH	THICKNESS	
		Gravel	24'	1 1/2"	No Record of Constr.
		Br.4208 (1)	19'		Added in 1934.
		Grading	24'		23' B.S.
1927		Gravel	24'	2"	Co.Job 2603&2705.
					1000 C.Y./Mile
					Added in 1934.
1930		Grading	24'		Co. Job 2902.
		Gravel	24'	2"	1000 C.Y./Mile.
					Added in 1934.
M	1946 A.F.E. 26	Spot Grade Lifts	24'	3"-11"	11556 C.Y. Sand
C	1946 A.F.E. 27	Sand Lift		0'-12"	SG3, 15258 Gal.
M	1949 A.F.E. 4	Bit. Surf. Repair	24'		RT-4, 1250 Gal.
M	1950 A.F.E. 4	Spot Treat. Bit. Surface Repair	22'		SC-4 MC3, 6312 Gal. Agg. 760 C.Y.
C	1952 A.F.E. 23	Bit. Resurfacing Mixed Bit	22'	1"	SG4, 52018 Gal. Agg. 5131 Tons
M	1953 A.F.E. 604	Spot Treat. Bit. Surf. Repair			SG4, 5112 Gal. Agg. 442 Tons
M	1954 A.F.E. 604	Spot Treat. Bit. Surf. Repair	24'		SG3, 10216 Gal. Agg. 1057 Tons
M	1955 A.F.E. 831	Spot Grav. Lift			Bit. 35713 Gal.
M	1956 A.F.E. 604	Spot Treat. Bit. Surf. Repair	24'		Agg. 3216 Tons
M	1957 A.F.E. 604	Spot Treat. Bit. Surf. Repair	24'		SC-4, 21047 Gal. Agg. 1795 Tons
M	1957 A.F.E. 604	Spot Treat. Bit. Surf. Repair	24'		SC-4, 7717 Gal. Agg. 609 Tons

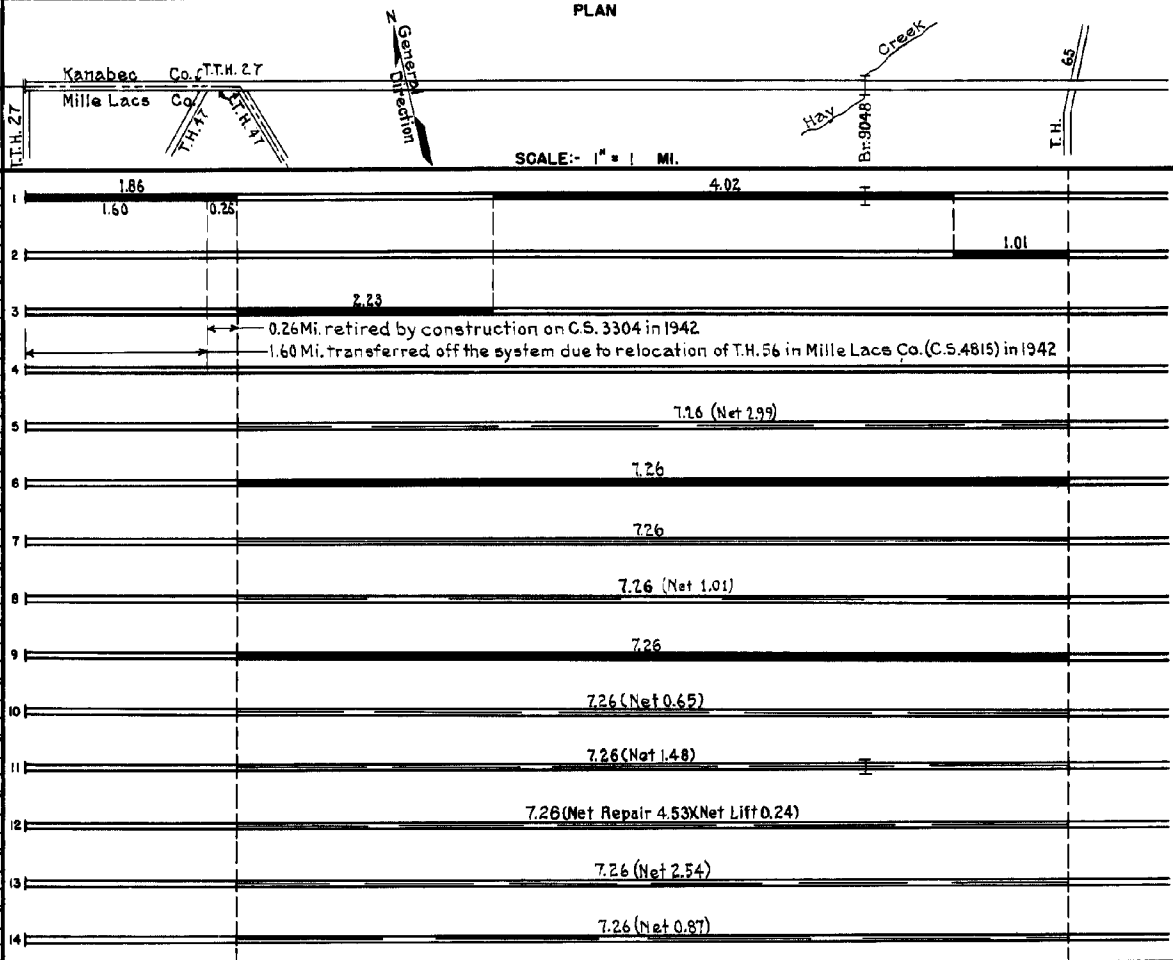

YEARS		TOTAL MILES	UNINCORPORATED		INCORPORATED		RURAL		URBAN	
FROM	TO		RDWY. MI.	BR. MI.	RDWY. MI.	BR. MI.	RDWY. MI.	BR. MI.	RDWY. MI.	BR. MI.
1934	1941	9.12	9.11	0.01	0.00	0.00	9.11	0.01	0.00	0.00
1942	1958	7.26	7.25	0.01	0.00	0.00	7.25	0.01	0.00	0.00
1959		7.21	7.20	0.01	0.00	0.00	7.20	0.01	0.00	0.00

REMARKS: Layout is to scale as of 1934

(1) Br.4208 built in 1924

PREPARED BY  
TRAFFIC AND PLANNING DIVISION  
IN COOPERATION WITH  
U.S. DEPARTMENT OF COMMERCE  
BUREAU OF PUBLIC ROADS

STATE OF MINNESOTA  
DEPARTMENT OF HIGHWAYS  
ROAD LIFE STUDIES  
CONSTRUCTION PROJECT LOG RECORD

CONTROL SECTION 3309  
TRUNK HIGHWAY 27  
COUNTY Kanabec  
DISTRICT 3B

LIMITS: Jct. T.H. 47 at W. Co. Line - Jct. T.H. 65  
Ref. Pt. 190+00.615 - 197+00.826

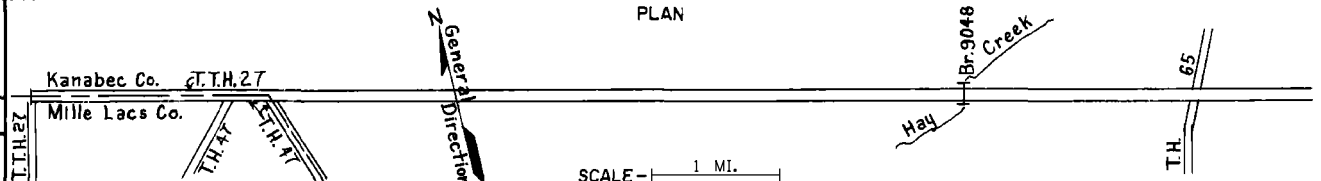

YEAR BUILT	PROJECT NO.	DESCRIPTION				REMARKS
		TYPE	WIDTH	THICKNESS		
C	3309-03	Grading				
1959		Base	36'	4 1/2"		
		Road Mix Bit. (Base)	26'	1 1/2"		122,567 Gal.
M						
1963	C	Light Bit. Seal	26'			RS-2K, 11978 Gal. Agg. 470 C.Y.
C	3309-09	Shoulder Grading				Rt. & Lt. of Rdwy. imp.
1965		Plant Mix Bit. Gravel Shoulders	24'	3"		
M						
1977	3309-11 SF	Bit. Seal Coat				
C	3309-12	Bit. Overlay	28'	3 1/2"		Spec. 2341
S		Grading				
2012	3309-14	Alt. Bit. & Conc. Surf. Bit. Mill 3" & Ovl. 4"	24'	6"		conc. undowl Spec. 2360
S		Grading				
2017	3309-16	Bit. Paving Bit. shldr	24' 6'	6" 6"		agg. base CL6 Spec. 2360 agg. shldr 2'

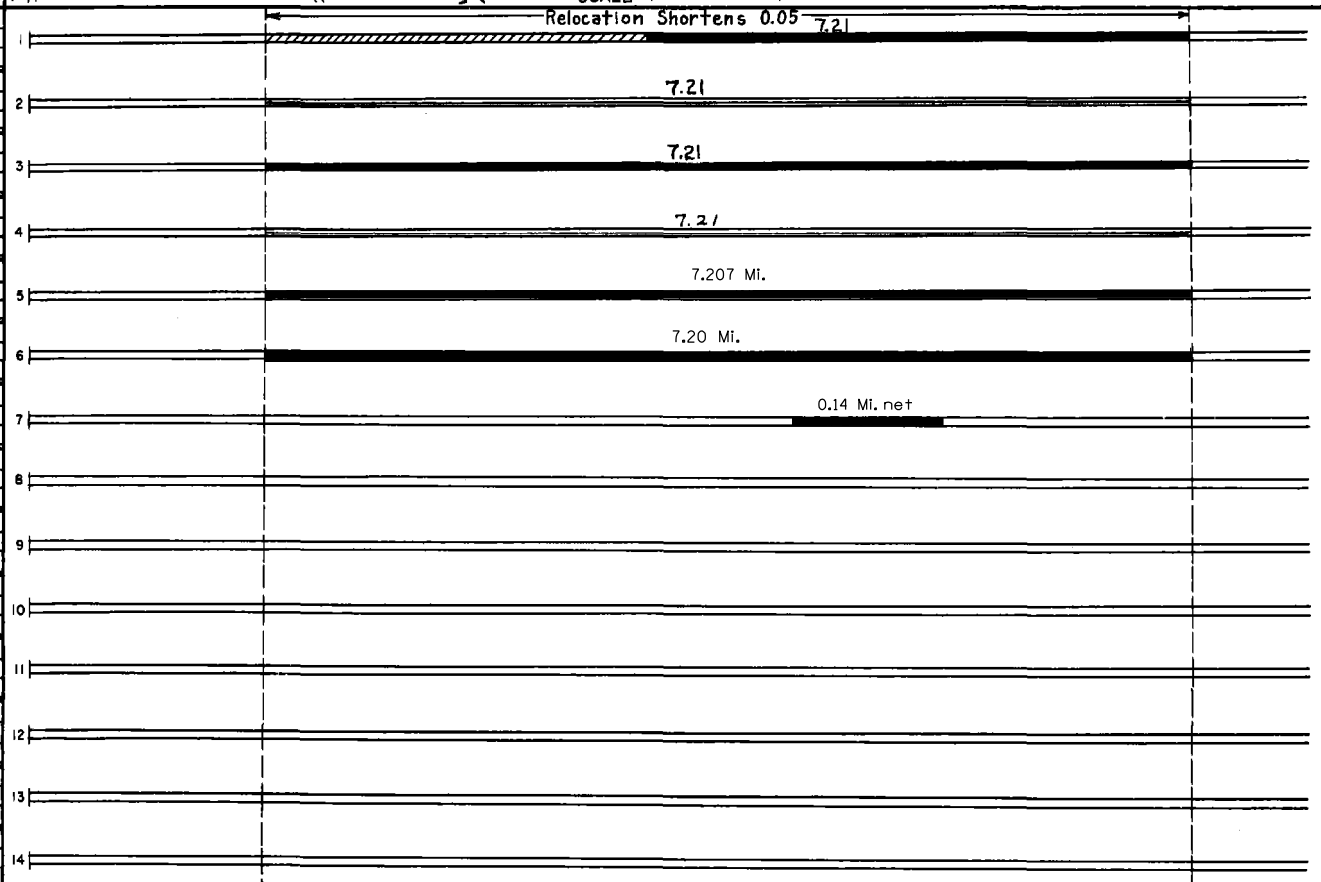

YEARS		TOTAL MILES	UNINCORPORATED		INCORPORATED		RURAL		URBAN	
FROM	TO		RDWY. MI.	BR. MI.	RDWY. MI.	BR. MI.	RDWY. MI.	BR. MI.	RDWY. MI.	BR. MI.

REMARKS: See sheet 1.