



CONSTRUCTION PROJECT LOG
 Prepared by
Office of Transportation System Management
 Last updated on: 10-7-2022

Control Section 3306
TRUNK HIGHWAY: MN70
COUNTY: Kanabec
DISTRICT: 3 (Brainerd)
LIMITS:
 JCT MN-65 to JCT MN-107
 Ref. Pt. 000+00.000 - 007+00.248

NOTES: CONTROL SECTION NOTES FROM SDW

Symbology:

Stick Map Legend				
Highway	State-Aid	Non State-Aid	City Limit	Bridge

DISCLAIMER: If you encounter broken hyperlinks, please fill out Data Practice Form:
<http://www.dot.state.mn.us/information/datapractices/index.html>

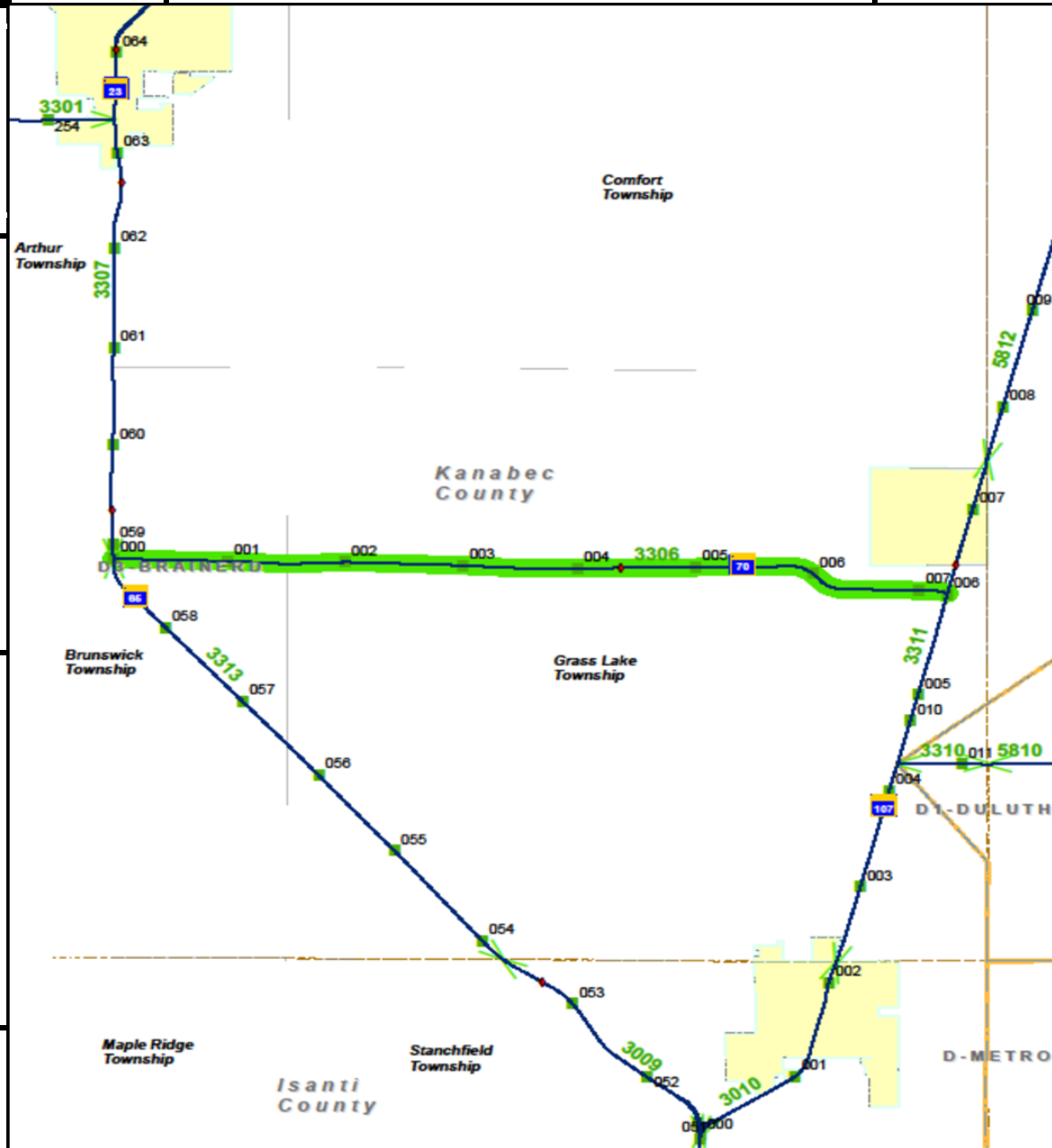

PREPARED BY
HIGHWAY PLANNING SURVEY
IN COOPERATION WITH
U. S. PUBLIC ROADS ADMINISTRATION

STATE OF MINNESOTA
DEPARTMENT OF HIGHWAYS
ROAD LIFE STUDIES
CONSTRUCTION PROJECT LOG RECORD

CONTROL SECTION 3306
TRUNK HIGHWAY (2) 70
COUNTY Kanabec
DISTRICT 38

LIMITS: Jct. T.H. 65- N. Jct. T.H. 107

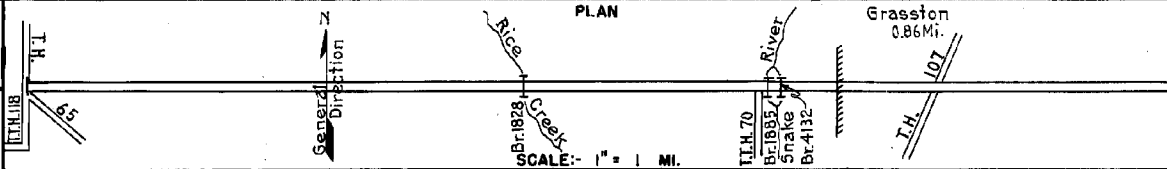

YEAR BUILT	PROJECT N ^o	DESCRIPTION			CODE N ^o
		TYPE	WIDTH	THICKNESS	
		Br. M-172	16'		1
				No Record of Constr. 60' L.T.	
1922	65-5-6	Grading Gravel	24'	3 1/2"	2
				1600 C.Y./Mile.	6.39
(1)					
1929	65-5-6	Tar Tr. Gravel	20'	1 1/2"	3
				10469 Gal./Mile. Maint. Dept.	6.39
(2)					
1930	65-5-6	Br. 1828	24'		4
				90' B.S. Maint. Dept.	
M		Spot Treat.			
1940	A.F.E. 26	Bit. Surf. Repair			5
				Rd Oil 4210 Gal./Mi. Grav. 273 C.Y./Mi. Maint. Dept.	6.39
M		Spot Treat.			
1941	A.F.E. 23	Bit. Surf. Repair	24'		6
				504,828 Gal./Mi. Grav. 71 C.Y./Mi. Maint. Dept.	6.39
M		Spot Treat.			
1942	A.F.E. 4	Bit. Surf. Repair	24'		7
				MG2, 638 Gal./Mi. Grav. 155 C.Y./Mi. Maint. Dept.	6.39
M		Spot Treat.			
1943	A.F.E. 4	Bit. Surf. Repair	24'		8
				MG-3, 896 Gal./Mi. Grav. 45 C.Y./Mi. Maint. Dept.	6.39
M		Spot Treat.			
1944	A.F.E. 4	Bit. Surf. Repair	24'		9
				RT6 & MG2, 2062 G./Mi. Grav. 85 C.Y./Mi. Maint. Div.	6.39
M		Spot Treat.			
1945	A.F.E. 4	Bit. Surf. Repair	22'		10
				RT-6, 2556 Gal./Mi. Grav. 142 C.Y./Mi. Maint. Div.	6.39
M		Spot Treat.			
1946	A.F.E. 4	Bit. Surf. Repair	22'		11
				SC3, 5589 Gal. Agg. 278 C.Y.	6.39 (Net 0.79)
M		Spot Treat.			
1947	A.F.E. 4	Bit. Surf. Repair	22'		12
				SC-3, 7561 Gal. Agg. 374 C.Y.	6.39 (Net 1.07)
M		Spot Treat.			
1948	A.F.E. 4	Bit. Surf. Repair	24'		13
				SC3, 9679 Gal. Agg. 888 Tons	6.39 (Net 1.58)
C					
1948	A.F.E. 19	Instal. Culvert			14
				36"x50" C.M.	

YEARS		TOTAL MILES	UNINCORPORATED			INCORPORATED			RURAL		URBAN	
FROM	TO		RDWY. MI.	BR. MI.	RDWY. MI.	BR. MI.	RDWY. MI.	BR. MI.	RDWY. MI.	BR. MI.		
1922	1929	6.39	6.38	0.01	0.00	0.00	6.38	0.01	0.00	0.00		
1930	1951	6.39	6.37	0.02	0.00	0.00	6.37	0.02	0.00	0.00		
1952		7.95	7.03	0.06	0.86	0.00	7.89	0.06	0.00	0.00		

REMARKS: Layout is to scale as of 1922

(1) This work not done under this project number but lies within the limits of this project. (2) Formerly T.H. 65. Changed to T.H. 70 in 1943 due to relocation of T.H. 65

PREPARED BY
HIGHWAY PLANNING SURVEY
IN COOPERATION WITH
U.S. PUBLIC ROADS ADMINISTRATION

STATE OF MINNESOTA
DEPARTMENT OF HIGHWAYS
ROAD LIFE STUDIES
CONSTRUCTION PROJECT LOG RECORD

CONTROL SECTION 3306
TRUNK HIGHWAY 70
COUNTY Kanabec
DISTRICT 38

LIMITS: Jct.T.H.65 - N.Jct.T.H.107

YEAR BUILT	PROJECT N°	DESCRIPTION			CODE N°	PLAN
		TYPE	WIDTH	THICKNESS		
M 1949	A.F.E. 4	Spot Treat. Bit. Surf. Repair	22'		SC-3, 8138 Gal. Agg. 700 Tons	1 6.39 (Net 1.14)
M 1950	A.F.E. 4	Spot Treat. Bit. Surf. Repair	24'		SC-4, 7225 Gal. Agg. 623 Tons	2 6.39 (Net 0.88)
M 1951	A.F.E. 4	Spot Treat. Bit Surf. Repair	24'		SC-3, 10357 Gal. Agg. 684 C.Y.	3 6.39 (Net 1.37)
M 1952	A.F.E. 4	Spot Treat. Bit. Surf. Repair	22'		SC-4, 10876 Gal. Agg. 724 C.Y.	4 6.39 (Net 1.38)
1935		Oil Tr. Gravel	20'	1"	13000 Gal./Mi.	5 1.47
		Gravel	22'		No record of construction.	6 0.09
M 1953	A.F.E. 604	Spot Treat. Bit. Surf. Repair	24'		SC-4, 8691 Gal. Agg. 750 Tons	7 7.86 (Net 1.06)
M 1954	A.F.E. 604	Spot Treat. Bit. Surf. Repair	24'		SC-4 & MC9, 15635 Gal. Agg. 1351 Tons	8 7.86 (Net 1.93)
M 1955	A.F.E. 604	Spot Treat. Bit. Surf. Repair	24'		SC-4, 5670 Gal. Agg. 525 Tons	9 7.86 (Net 0.74)
M 1956	A.F.E. 604	Spot Treat. Bit. Surf. Repair	24'		SC-4, 16056 Gals. Agg. 1232 Tons	10 7.86 (Net 1.80)
C&M 1957	A.F.E. 604	Spot Treat. Bit. Surf. Repair Mixed Bit. (0.09 Mi)	24'	1"	SC-4, 6965 Gal. Agg. 588 Tons	11 7.86 (Net 0.83) 0.09
M 1958	A.F.E. 604	Spot Treat. Bit. Surf. Repair	24'		SC-4, 12169 Gal. Agg. 1078 Tons	12 7.86 (Net 1.63)
M 1959	A.F.E. 604	Spot Treat. Bit. Surf. Repair	24'		4031 Gal. Bit. Agg. 322 Tons	13 5.96 (Net 0.45)
M 1960		Spot Treat. Bit. Resurfacing	24'		SC-3, 469 Gal. Agg. 40 Tons	14 0.42 (Net 0.05)

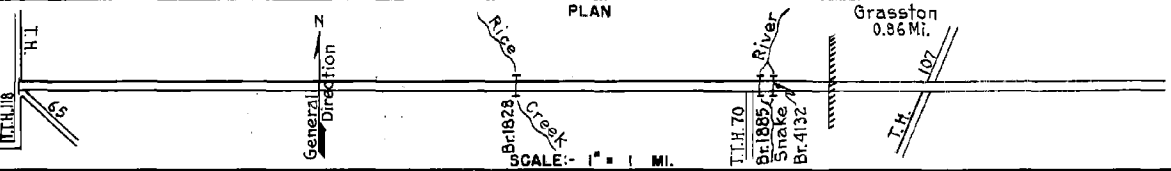

YEARS FROM TO		TOTAL MILES	UNINCORPORATED		INCORPORATED		RURAL		URBAN	
FROM	TO		RDWY. MI.	BR. MI.	RDWY. MI.	BR. MI.	RDWY. MI.	BR. MI.	RDWY. MI.	BR. MI.

REMARKS: See Sheet No. 1

PREPARED BY
TRAFFIC AND PLANNING DIVISION
IN COOPERATION WITH
U.S. DEPARTMENT OF COMMERCE
BUREAU OF PUBLIC ROADS

STATE OF MINNESOTA
DEPARTMENT OF HIGHWAYS
ROAD LIFE STUDIES
CONSTRUCTION PROJECT LOG RECORD

CONTROL SECTION 3306
TRUNK HIGHWAY 70
COUNTY Kanabec
DISTRICT 3B

LIMIT: Jct. T.H. 65 - N. Jct. T.H. 107
Ref. Pt. 000+00.000 - 007+00.248

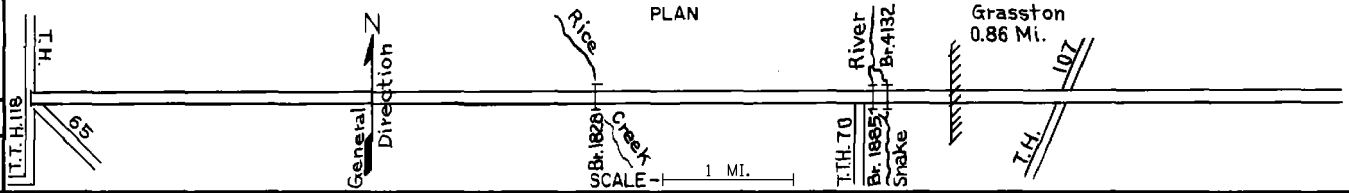

YEAR BUILT	PROJECT NO	DESCRIPTION			
		TYPE	WIDTH	THICKNESS	REMARKS
M 1964	C	Light Bit. Seal	25'		RS-2K, 12640 Gal. Agg. 500 C.Y.
C 1981	3306-07	Bit. Resurfacing	20'-22'	1 1/2"	
C 1992	3306-09	Grading	Var.	2"	Spec. 2331
	3306-10	Bit. Surfacing		1 1/2"	Spec. 2341
S 2007	3306-13	Milling Bit. Overlay	24'	2 1/4" 3"	Spec. 2360
	8823-240	Bit. Seal Coat			FA-2

1	7.95		
2	2.9		
3	0.078	1.406	
4	7.223 Mi.		
5	7.222 Mi.		
6			
7			
8			
9			
10			
11			
12			
13			
14			

YEARS		TOTAL MILES	UNINCORPORATED		INCORPORATED		RURAL		URBAN	
FROM	TO		RDWY. MI.	BR. MI.	RDWY. MI.	BR. MI.	RDWY. MI.	BR. MI.	RDWY. MI.	BR. MI.

REMARKS: See Sheet No. 1