



CONSTRUCTION PROJECT LOG
Prepared by
Office of Transportation System Management
Last updated on: 10-7-2022

Control Section 3302

TRUNK HIGHWAY: MN23
COUNTY: Kanabec
DISTRICT: 3 (Brainerd)
LIMITS:

JCT MN-65 to Kanabec-Pine County Line
Ref. Pt. 256+00.180 - 264+00.188

NOTES: CONTROL SECTION NOTES FROM SDW

Symbology:

Stick Map Legend				
Highway	State-Aid	Non State-Aid	City Limit	Bridge
			■ ■ ■ ■ ■ ■ ■ ■	◆

DISCLAIMER: If you encounter broken hyperlinks, please fill out Data Practice Form:

<http://www.dot.state.mn.us/information/datapractices/index.html>

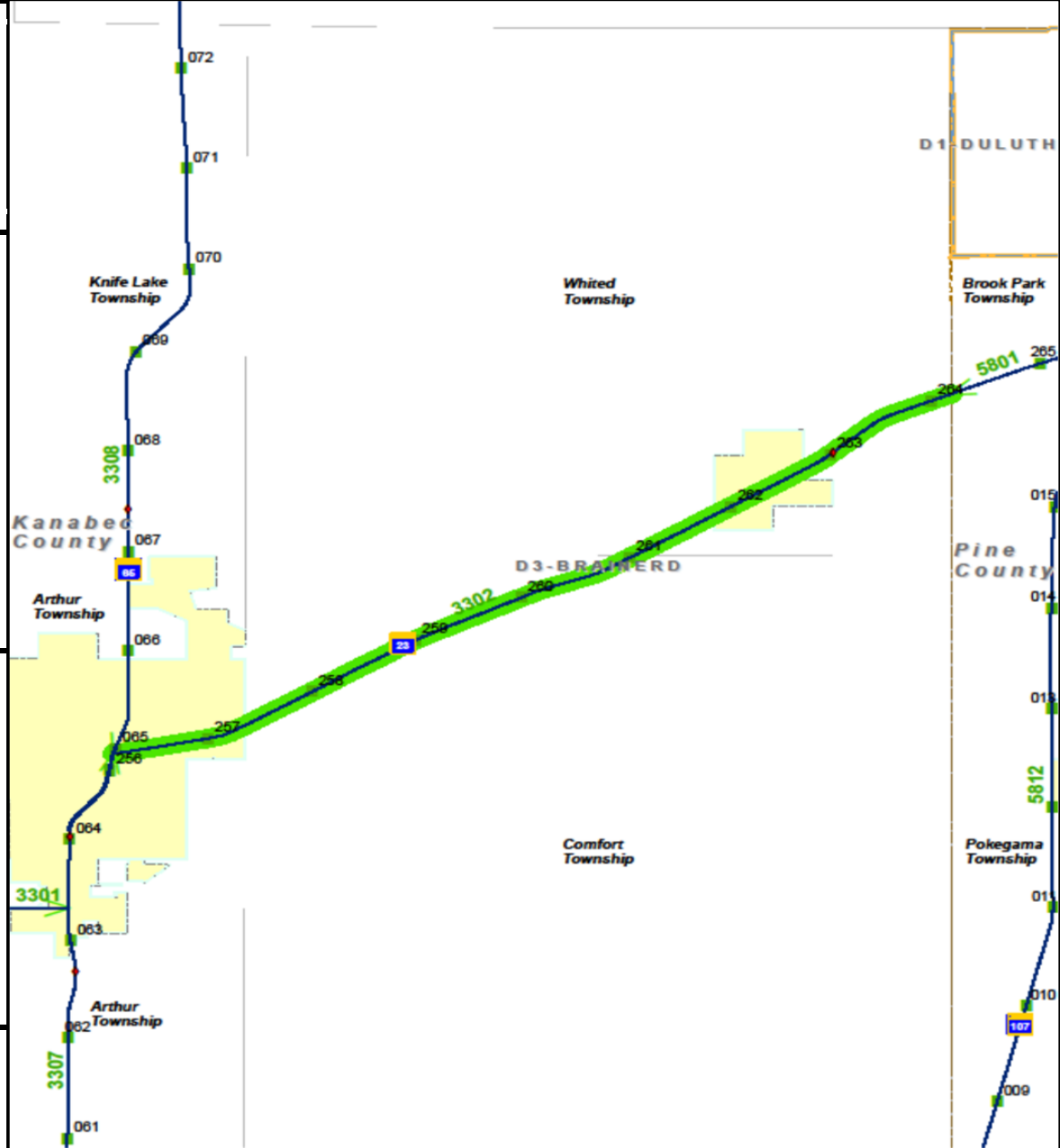

PREPARED BY
HIGHWAY PLANNING SURVEY
IN COOPERATION WITH
U.S. PUBLIC ROADS ADMINISTRATION

STATE OF MINNESOTA
DEPARTMENT OF HIGHWAYS
ROAD LIFE STUDIES
CONSTRUCTION PROJECT LOG RECORD

CONTROL SECTION 3302
TRUNK HIGHWAY 23
COUNTY Kanabec
DISTRICT 38

LIMITS: N.Jct. T.H. 65 in Mora - E. Co. Line

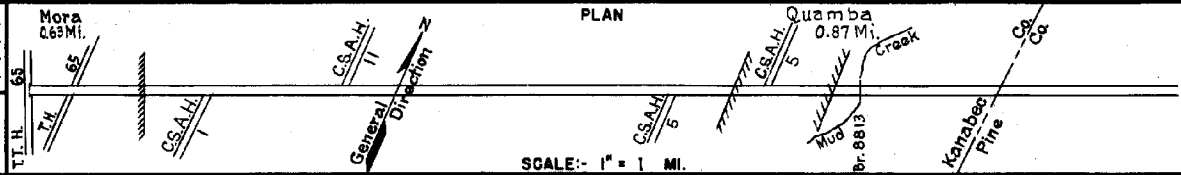

YEAR BUILT	PROJECT N ^o	DESCRIPTION		REMARKS	CODE N ^o
		TYPE	WIDTH THICKNESS		
1925	23-23-30A	Grading Gravel	30' 24'	1200 C.Y./Mile.	
1931	23-23-30A	Oil Tr. Gravel	33" 1 1/2"	1574 Gal./Mile. Maint. Dept.	
M		Spot Treat.		Rd. Oil, 3304 Gal./Mi.	
1940	A.F.E. 24	Bit. Surf. Repair		Grav. 181 C.Y./Mi. Maint. Dept.	
M		Spot Treat.		MC4 & RT3, 3201 Gal./M.	
1941	A.F.E. 11	Bit. Surf. Repair	26'	Agg. 159 C.Y./Mi. Maint. Dept.	
M		Spot Treat.		RT6 & MC2, 2002 G./Mi.	
1942	A.F.E. 4	Bit. Surf. Repair	26'	Grav. 88 C.Y./Mi. Maint. Dept.	
M		Spot Treat.		MC-3, 1159 Gal./Mi.	
1943	A.F.E. 4	Bit. Surf. Repair	26'	Grav. 51 C.Y./Mi. Maint. Dept.	
M		Spot Treat.		MC2, 2819 Gal./Mi.	
1944	A.F.E. 4	Bit. Surf. Repair	26'	Grav. 149 C.Y./Mi. Maint. Div.	
M		Spot Treat.		MC-3, 2093 Gal./Mi.	
1945	A.F.E. 4	Bit. Surf. Repair	26'	Grav. 96 C.Y./Mi. Maint. Div.	
M		Spot Treat.		SC3, 25406 Gal.	
1946	A.F.E. 4	Bit. Surf. Repair	24'	Agg. 1269 C.Y.	
M		Spot Treat.		MC3 & SC3, 13473 Gpl.	
1947	A.F.E. 4	Bit. Surf. Repair	24'	Agg. 962 tons	
C		Install Culvert		36" x 2' C.M.	
1948	A.F.E. 21				
M		Spot Treat.		SC-3, 18283 Gal.	
1948	A.F.E. 4	Bit. Surf. Repair	26'	Agg. 1527 Tons	
M		Spot Treat.		SC3, 28529 Gal.	
1949	A.F.E. 4	Bit. Surf. Repair	24'	Agg. 2709 Tons	
M		Spot Treat.		SC4, 17302 Gal.	
1950	A.F.E. 4	Bit. Surf. Repair	24'	Agg. 1184 C.Y.	

1	8.42	
2	8.42	
3	8.42	
4	8.42	
5	8.42	
6	8.42	
7	8.42	
8	8.42	
9	8.42 (Net 3.18)	
10	8.42 (Net 1.72)	
11		
12	8.42 (Net 2.20)	
13	8.42 (Net 3.63)	
14	8.42 (Net 2.39)	

YEARS FROM	TO	TOTAL MILES	UNINCORPORATED		INCORPORATED		RURAL		URBAN	
			RDWY. MI.	BR. MI.	RDWY. MI.	BR. MI.	RDWY. MI.	BR. MI.	RDWY. MI.	BR. MI.
1925	1951	8.42	7.40	0.00	1.02	0.00	7.40	0.00	1.02	0.00
1952	1952	8.04	6.53	0.00	1.51	0.00	7.40	0.00	0.64	0.00
1953		8.01	6.51	0.00	1.50	0.00	7.38	0.00	0.63	0.00

REMARKS: Layout is to scale as of 1925

(1) This work not done under this project number but lies within the limits of this project

PREPARED BY
HIGHWAY PLANNING SURVEY
IN COOPERATION WITH
U.S. PUBLIC ROADS ADMINISTRATION

STATE OF MINNESOTA
DEPARTMENT OF HIGHWAYS
ROAD LIFE STUDIES
CONSTRUCTION PROJECT LOG RECORD

CONTROL SECTION 3302
TRUNK HIGHWAY 23
COUNTY Kanabec
DISTRICT 38

LIMITS: N. Jct. T.H. 65 in Mora - E. Co. Line
Ref. Pt. 256+00.180 - 264+00.187

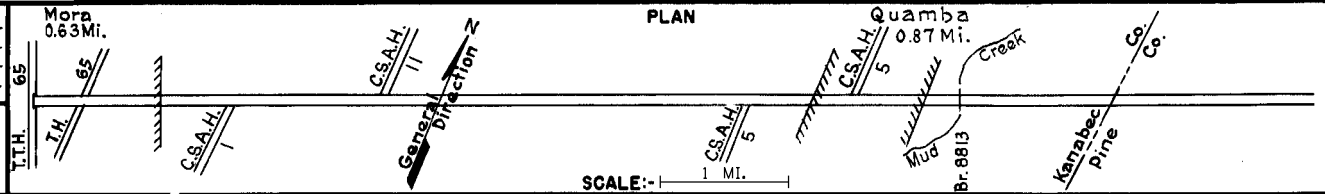

YEAR BUILT	PROJECT N ^o	DESCRIPTION			CODE N ^o
		TYPE	WIDTH	THICKNESS	
M 1951	A.F.E. 4	Spot Treat. Bit. Surf. Repair	24'		
M 1952	A.F.E. 4	Spot Treat. Bit. Surf. Repair	24'		
C 1953	3302-02	Grading Gravel & Salv. Bit. Br. 8813 (C108D)	42' 34' 6"	12" Granular Mat'l 2000 C.Y./Mi.	
C 1954	3302-04	Bit. Stab. Base * Mixed Bit.	24'	1" *upper 1"x2 1/2" of base inp. stabilized	
M 1956	A.F.E. 818 A.F.E. 605	Repair Base & Restore Bit. Surf. (0.08 Mi.) Light Bit. Seal	24'	RC2 & RT-4, 12916 Gal. Agg. 74 Tons & 390 C.Y.	
C 1958	3302-05	Concrete	24'	8"	
C 1958	3302-05	Bit. Stab. Base Plant Mix Bit.	40' 24'	5" 3"	
M 1978	SF	CLEAN & RESEAL JOINTS CRACKS IN CONC. PAVE.			
M 1988	M4303	Conc. Repair			
M 1989	M4343	Bit. Shouldering	2 1/2'		Spec. 2331
M 1995	3302-95134	Bit. Surfacing			At Various Places
S 2001	3302-12	Bit. Resurfacing	24' 1 1/2'-2'		Spec 2350
D 2006	D06080 8823-89	Bit. Seal Coat & Fog Seal	24'		FA-3 Spec. 2356
C 2018	3302-16	Milling & Bit. Overlay	var. 2'-3' var. 3'-3 1/2'		turn lanes added & widened

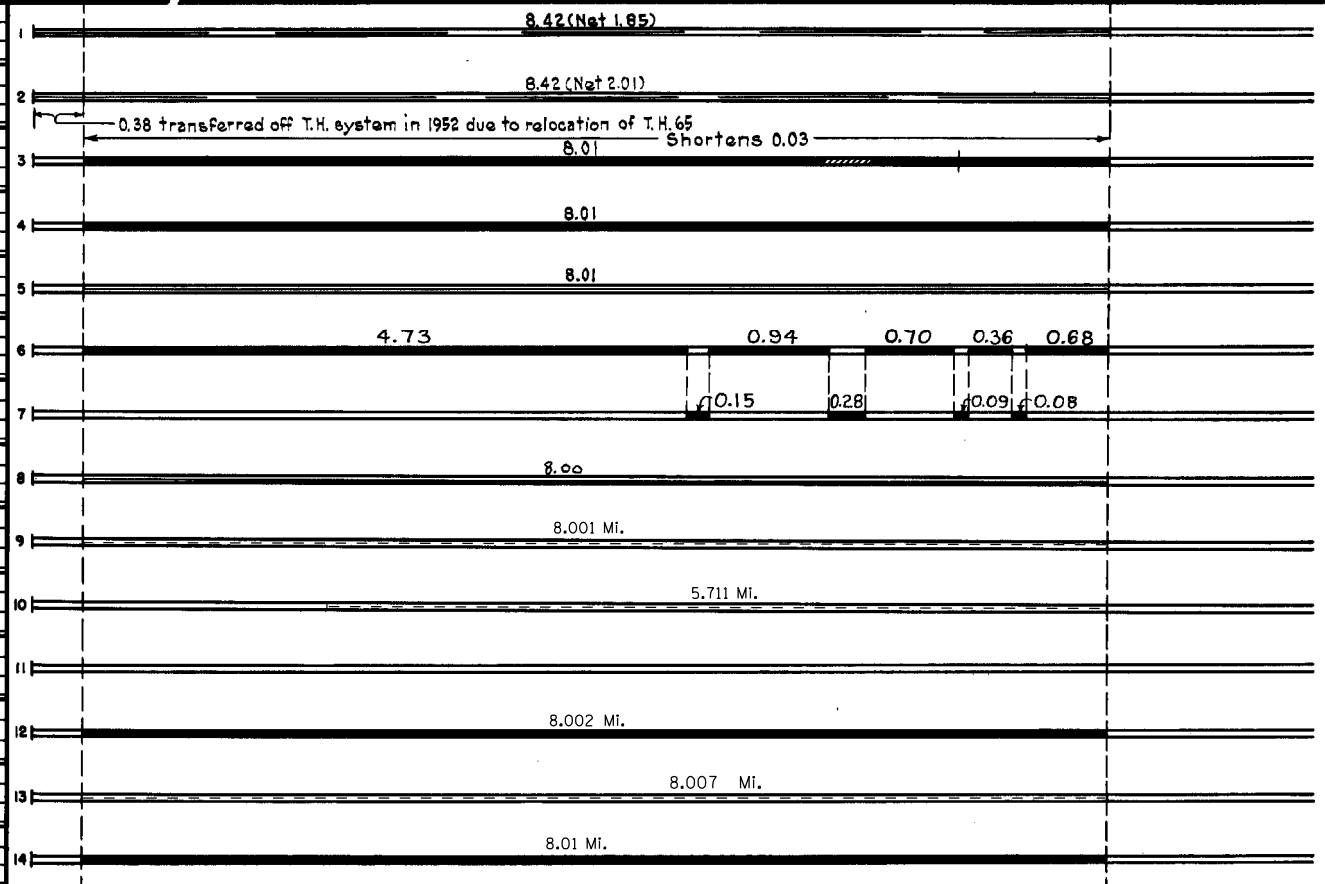

YEARS FROM	TOTAL MILES TO	UNINCORPORATED		INCORPORATED		RURAL		URBAN	
		RDWY. MI.	BR. MI.	RDWY. MI.	BR. MI.	RDWY. MI.	BR. MI.	RDWY. MI.	BR. MI.

REMARKS: See Sheet No. 1
(2) Contract not final but work substantially complete