

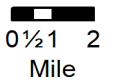

Map of CS# LIMITS:



CONSTRUCTION PROJECT LOG
Prepared by
Office of Transportation System Management
Last updated on: 10-7-2022

Control Section 3010

TRUNK HIGHWAY: MN107

COUNTY: Isanti

DISTRICT: 3 (Brainerd)

LIMITS:
JCT MN-65 to Isanti-Kanabec County Line
Ref. Pt. 000+00.000 - 002+00.212

NOTES: CONTROL SECTION NOTES FROM SDW

Symbology:

Stick Map Legend				
Highway	State-Aid	Non State-Aid	City Limit	Bridge

DISCLAIMER: If you encounter broken hyperlinks, please fill out Data Practice Form:

<http://www.dot.state.mn.us/information/datapractices/index.html>

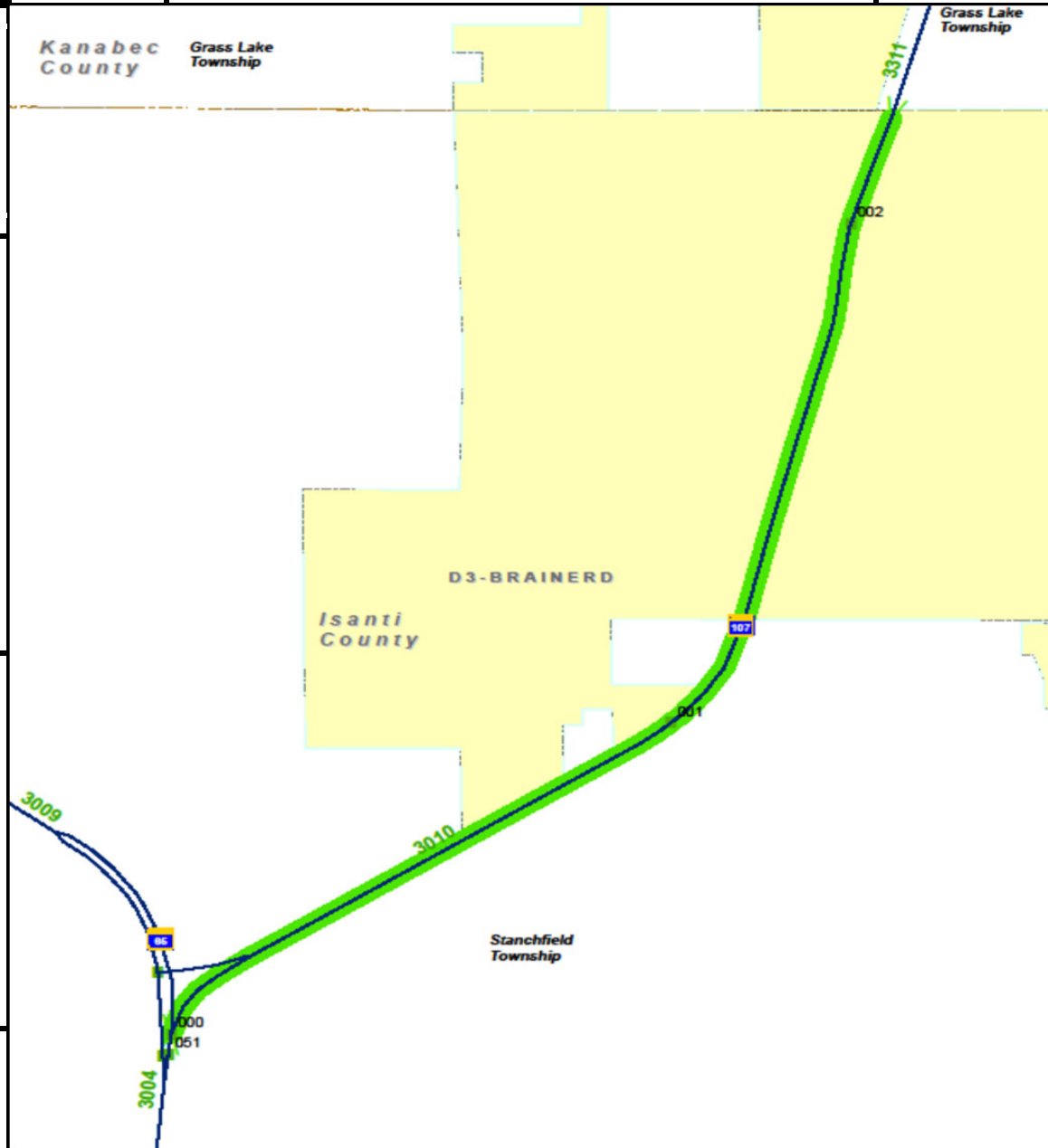

PREPARED BY
HIGHWAY PLANNING SURVEY
IN COOPERATION WITH
U.S. PUBLIC ROADS ADMINISTRATION

STATE OF MINNESOTA
DEPARTMENT OF HIGHWAYS
ROAD LIFE STUDIES
CONSTRUCTION PROJECT LOG RECORD

CONTROL SECTION 3010
TRUNK HIGHWAY 107
COUNTY Isanti
DISTRICT (38)0A

LIMITS: Jct.T.H.65 - No.Co.Line.(N.Limits of Braham)

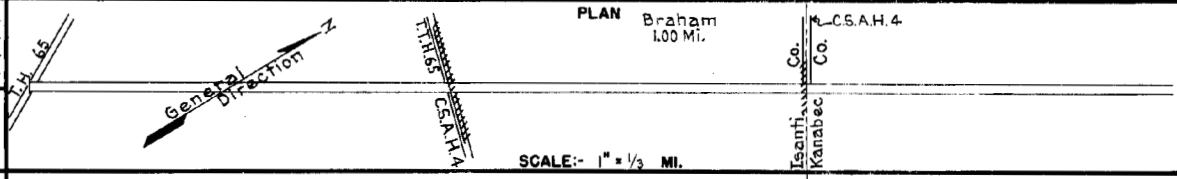

YEAR BUILT	PROJECT N ^o	DESCRIPTION			CODE N ^o
		TYPE	WIDTH	THICKNESS	
1922 (1)	65-5-21	Grading Gravel	30' 24'	5 3/4"	2700 C.Y./Mi.
1929 (1)	65-5-21	Tar Tr. Gravel	24'	1 1/4"	10920 Gal./Mi. Maint. Dept.
1936 (1)	65-5-21	Roadside Landscap			
1941	3010-07	2-Culverts			C46 X46 & C46 X40
M 1942	A.F.E. 4	Spot Treat. Bit. Surf. Repair	24'		RT-6 & MG-2, 64536/Mi. Grav. 303 C.Y./Mi. Maint. Dept.
C 1942	3010-05	Grading Salvaged Bit Surf.	36'		.36 Mi. Divided Highway 728 C.Y./Mi.
C 1942	3010-08	Sodding			
C 1942	A.F.E. 7	Seeding			Seed supplied by R.D.(S.P. 3004-17) Maint. Dept.
C 1943	3010-03	Stab. Gravel Base Mixed Bit.	34' 26'	2-6" 1"	24 Surf. on each roadway of divided highway
M 1944	A.F.E. 4	Spot Treat. Bit. Surf. Repair	26'		MG-3, 3697 Gal./Mi. Agg. 156 C.Y./Mi. Maint. Div.
M 1945	3010-12	Bit. Surf. Repair			
M 1945	A.F.E. 4	Spot Treat. Bit. Surf. Repair	26'		RT-6, 1358 Gal./Mi. Grav. 58 C.Y./Mi. Maint. Div.
M 1947	A.F.E. 4	Spot Treat. Bit. Surf. Repair			SC-3, 7470 Gal. Agg. 438 C.Y.
M 1948	A.F.E. 4	Spot Treat. Bit. Surf. Repair	26'		SC-3, 880 Gal. Agg. 91 Tons

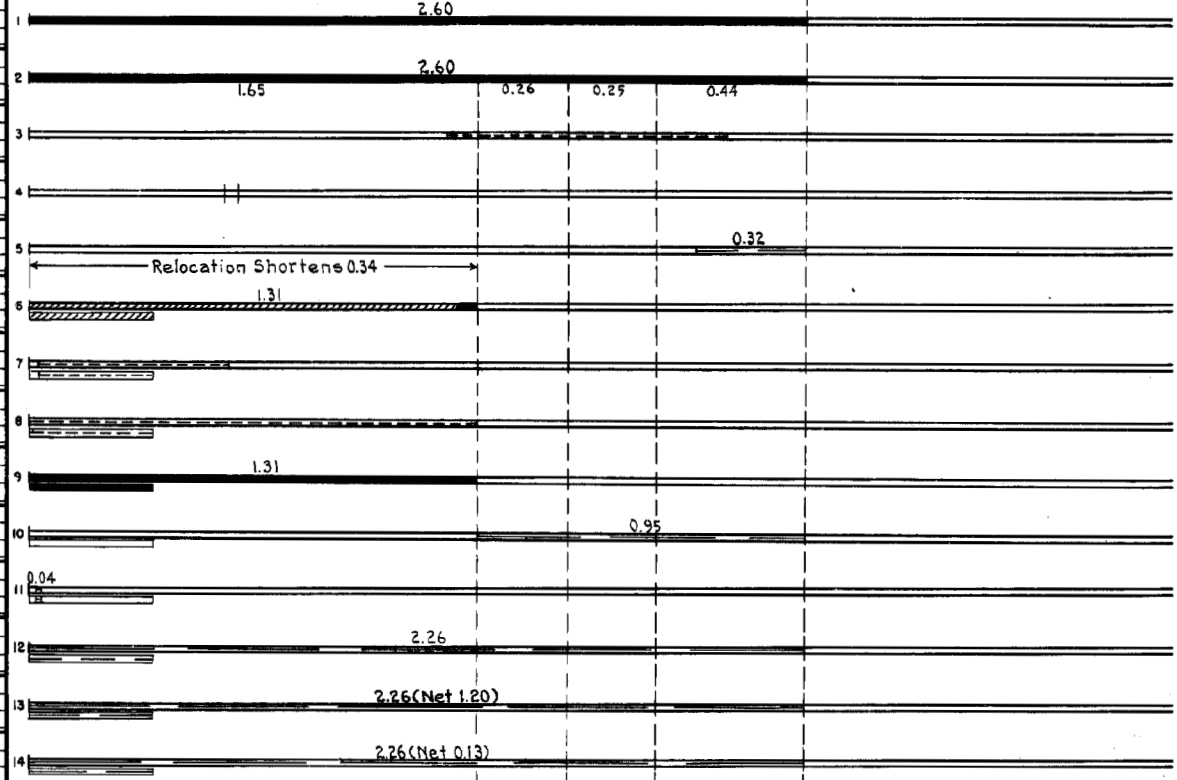

YEARS FROM	TOTAL MILES TO	UNINCORPORATED		INCORPORATED		RURAL		URBAN	
		RDWY. MI.	BR. MI.	RDWY. MI.	BR. MI.	RDWY. MI.	BR. MI.	RDWY. MI.	BR. MI.
1942	1951	2.26	0.00	1.04	0.00	2.26	0.00	0.00	0.00
1952		2.22	0.00	1.00	0.00	2.22	0.00	0.00	0.00

REMARKS: Layout is to scale as of 1942
(1) This was part of T.H. 65 (C.S. 3004) prior to 1942. Due to relocation of T.H. 65 it was changed to T.H. 107 (C.S. 3010).

PREPARED BY
HIGHWAY PLANNING SURVEY
IN COOPERATION WITH
U.S. PUBLIC ROADS ADMINISTRATION

STATE OF MINNESOTA
DEPARTMENT OF HIGHWAYS
ROAD LIFE STUDIES
CONSTRUCTION PROJECT LOG RECORD

CONTROL SECTION 3010
TRUNK HIGHWAY 107
COUNTY Isanti
DISTRICT(BB)(A)

LIMITS: Jct. T.H. 65 - N. Co. Line (N. Limits of Braham)

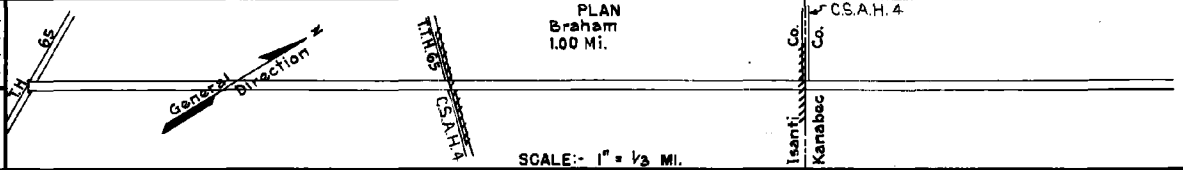

YEAR BUILT	PROJECT N ^o	DESCRIPTION			REMARKS	CODE N ^o
		TYPE	WIDTH	THICKNESS		
M	1950 A.F.E. 4	Spot Treat. Bit. Surf. Repair	24'		SC-4, 5852 Gal. Agg. 497 Tons	1
M	1951 A.F.E. 4	Bit. Surf. Repair	24'		SC-3, 1653 Gal. Agg. 120 C.Y.	2
C	1952 3010-13	Spot Base Repair Plant Mix Bit.	24' 1 1/2" added			3
C	1952 3010-02	Grading Sand Material Gravel	36" 12" 36" 2 1/2"			4
C	1953 3010-15	Bit. Stab. Base (Mixed Bit)	26'	2"		5
M	1954 A.F.E. 604	Spot Treat. Bit. Surf. Repair	24'		SC-4, 5063 Gal. Agg. 434 Tons	6
M	1955 A.F.E. 604	Spot Treat. Bit. Surf. Repair	24'		SC-4, 2230 Gal. Agg. 203 Tons	7
M	1956 A.F.E. 604	Bit. Surface Repair	24'		SC-4, 2140 Gal. Agg. 185 Tons	8
C	1957 3010-14	Sand-Grav. Subbase Bit. Stab. Base Mixed Bit.	52' 52' 52'	9" 6" 1"		9
C	1958 3010-17	Grav. Shldrs. (0.26) Bit. Stab. Base (0.26) Plant Mix Bit.	32' 32' 32'	7" 7" 2"	4' Rt. & Lt. Var. leveling course	10
M	1960	Bit. Seal Coat Bit. Resurfacing	Var. 24'		RC-2 & RC-4, 6615 Tons SC-4, 709 Gal.	11
M	1962	Bit. Seal Coat	37'		RS-2, 4811 Gal.	12
C	1965 3010-19	Grading Plant Mix Bit. Bit. Shoulders	24' 3 1/2"			13
C	1968 3010-20	Pl. Mix. Bit. Surf. Gravel Shldrs.	24'	3"	Bit. Mat'l. 46 Ton	14

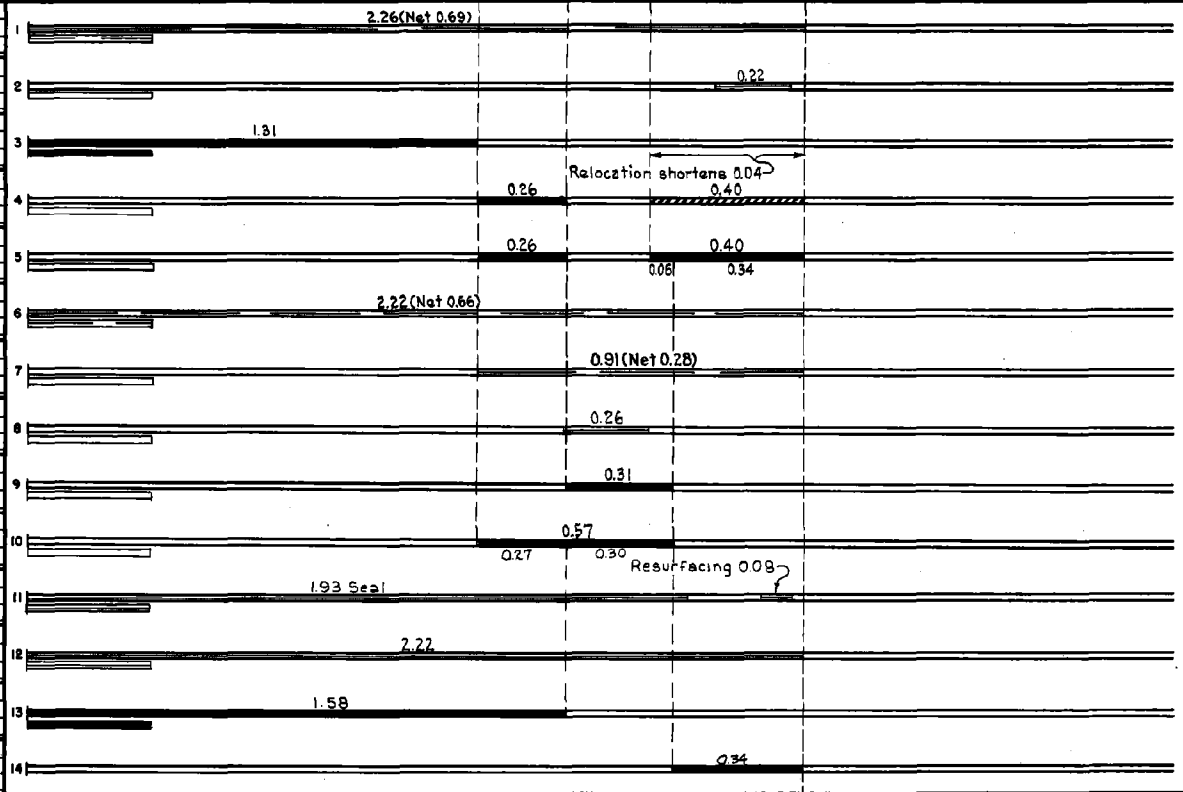

YEARS FROM	TO	TOTAL MILES	UNINCORPORATED		INCORPORATED		RURAL		URBAN	
			RDWY. MI.	BR. MI.	RDWY. MI.	BR. MI.	RDWY. MI.	BR. MI.	RDWY. MI.	BR. MI.

REMARKS: See Sheet No. 1

