







LEGEND

-  LIGHTING UNIT
-  FD. PT. CABINET
-  DIRECT BURIED CABLE 4 CONDUCTOR NO. 4
-  3" NMC DIRECTIONAL BORE (UNLESS OTHERWISE NOTED)
-  PERMANENT GROUND ROD (25 OHMS OR LESS)
-  LIGHTING UNIT IDENTIFIER
-  UTILITY POLE

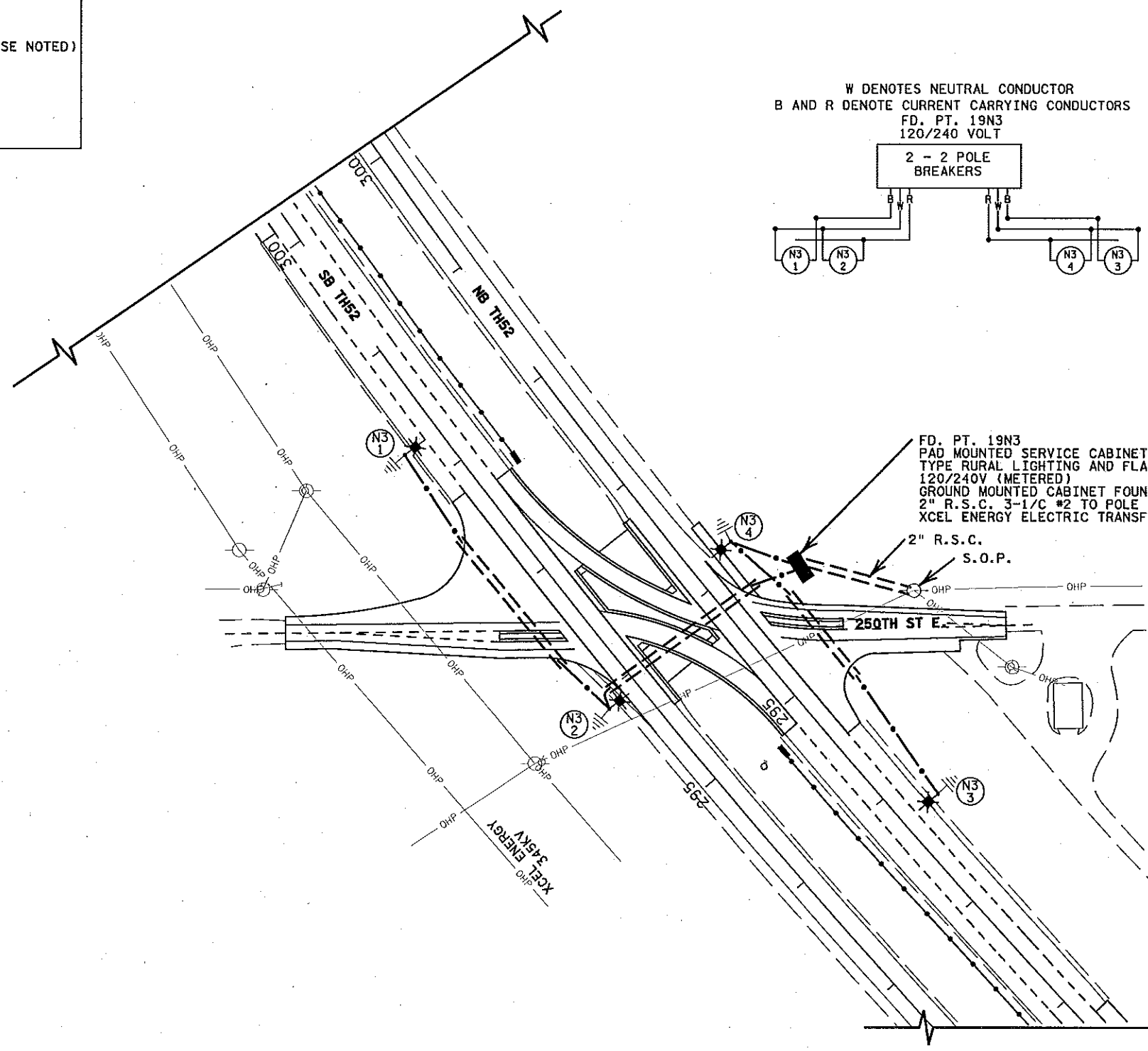
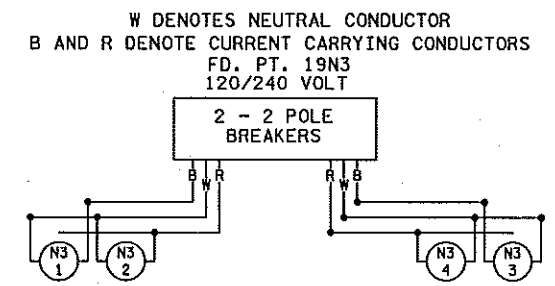
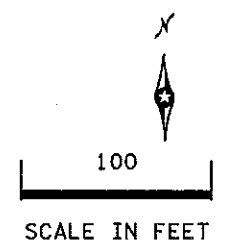

FD. PT. 19N3
PAD MOUNTED SERVICE CABINET
TYPE RURAL LIGHTING AND FLASHING (RLF)
120/240V (METERED)
GROUND MOUNTED CABINET FOUNDATION
2" R.S.C. 3-1/2" #2 TO POLE MOUNTED
XCEL ENERGY ELECTRIC TRANSFORMER.

FEEDPOINT 19N3
LIGHTING UNIT LOCATION AND TYPE

NO.	STATION	LT.	RT.	LOCATION	TYPE	FOUNDATION
1	298+30	X		SB TH52	9-40 LED	DESIGN E
2	295+90	X		NB TH52	9-40 LED	DESIGN E
3	293+75		X	NB TH52	9-40 LED	DESIGN E
4	296+15		X	NB TH52	9-40 LED	DESIGN E

PLOTTED/REVISED: 3/14/2017

DISTRICT: METRO
PLOT NAME: 1906-65.ltr.lto
PATH & FILENAME: IP_PWP-dlB41325\1906-65.ltr.lto.dgn

FEED POINT 19N3

LIGHTING PLAN

BY	DATE	REVISIONS	FEEDPOINT: 19N3 LOCATION: 250TH ST E METER ADDRESS: 24980 HIGHWAY 52 HAMPTON 55031	LIGHTING PLAN
			CERTIFIED BY <u>Michael P. Guberny</u> LIC. NO. 19863 DATE: 3/14/2017	
DRAWN BY: PB CKD BY: GK			STATE PROJ. NO. 1906-65 (T.H. 52) SHEET NO. SL4 OF SL8 SHEETS	