

RAMP PAVEMENT 1 FT. THRU 15 FT. WIDTH

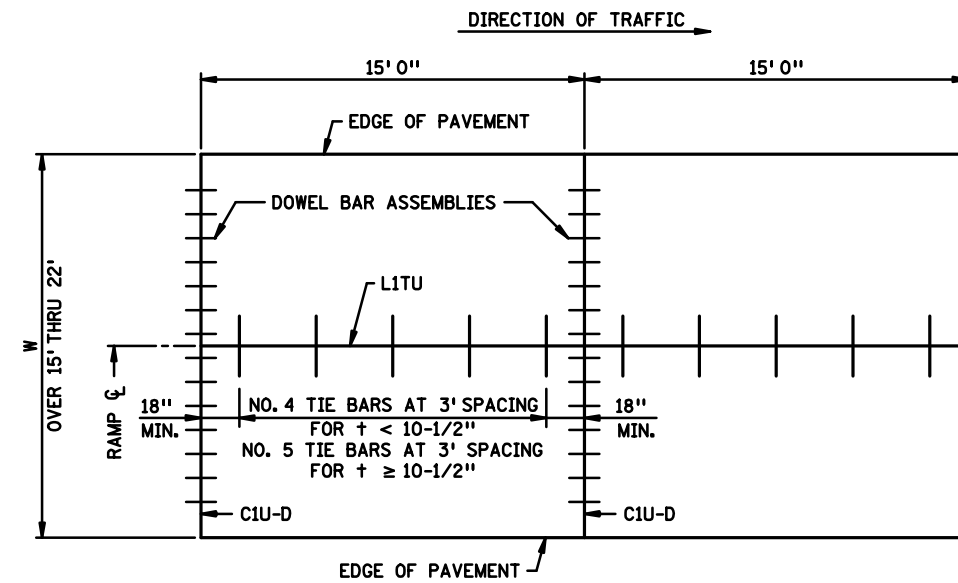

RAMP PAVEMENT OVER 15 FT. THRU 22 FT. WIDTH DOWELED

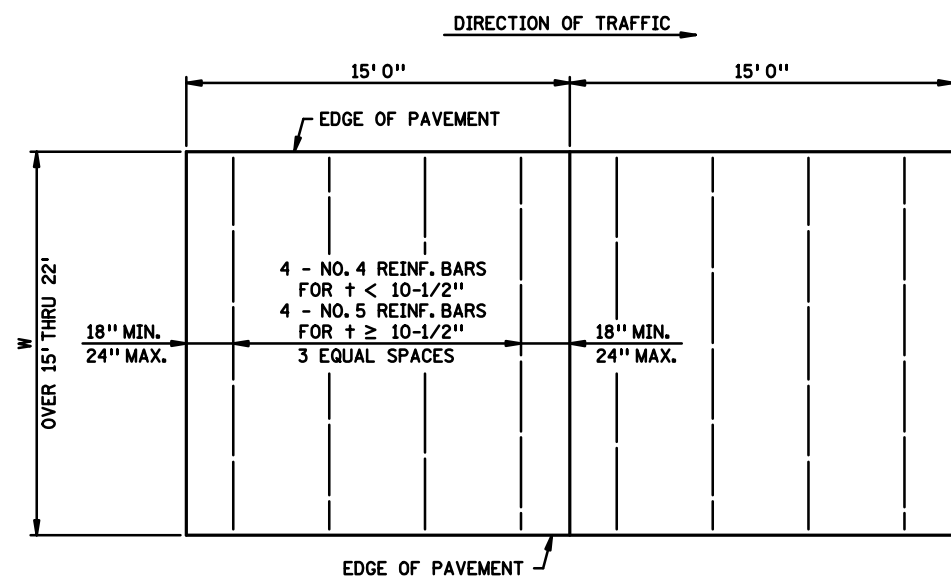

PANEL REINFORCEMENT
 PANELS OVER 15 FT. THRU 22 FT. WIDTHS
 IT IS PREFERRED TO ADD A LONGITUDINAL JOINT
 RATHER THAN PAVE GREATER THAN 15 FT. IN WIDTH.
 PLACEMENT DEPTH SHALL BE PLANNED $\pm/2 \pm 1"$

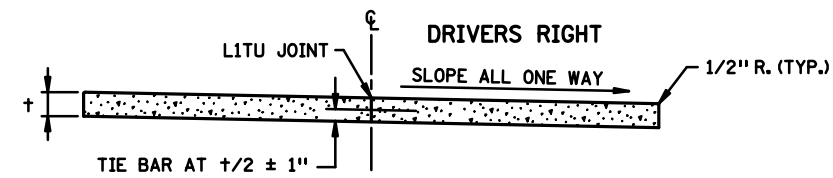

RURAL DESIGN RAMP
 CROSS SECTION

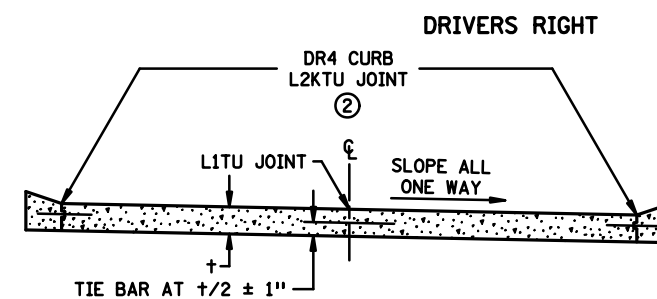

URBAN DESIGN RAMP
 CROSS SECTION

NOTES:

- WHEN RAMP THICKNESS IS LESS THAN 7", USE L2TU JOINTS INSTEAD OF L2KTU JOINTS.
- DOWEL BAR ASSEMBLIES, WHEN REQUIRED, SHALL BE SIMILAR TO THOSE SHOWN ON STANDARD PLATE 1103.
- SEE TYPICAL SECTIONS AND PLAN SHEETS FOR CROSS SLOPES AND PAVEMENT THICKNESS, t .
- ALL REINFORCING BARS SHALL BE EPOXY COATED AND COMPLY WITH SPEC. 3301.
- FOR SUPPLEMENTAL PAVEMENT REINFORCEMENT, SEE STANDARD PLATE 1070.
- ① DOWELS USED WHEN PAVEMENT WIDTH IS GREATER THAN OR EQUAL TO 4'.
- ② THE CONTRACTOR SHALL HAVE THE OPTION TO CONSTRUCT INTEGRANT CURBS IN PLACE OF DR4 CURB WITH L2KTU JOINTS. IN EITHER OPTION, DOWEL BAR ASSEMBLIES WILL NOT BE REQUIRED IN THE CURB AREA. PAYMENT WILL BE BASED ON THE DR4 CURB OPTION, REGARDLESS OF THE METHOD OF CONSTRUCTION USED. DR4 JOINTS SHALL BE SEALED.

LEAD EXPERT OFFICE
 GLENN ENGSTROM
 DIRECTOR
 OFFICE OF MATERIALS & ROAD RESEARCH



CONCRETE RAMP / LOOP PAVEMENT
 15 FT. PANEL LENGTH

APPROVED: 02-16-2016
 REVISED:

Thomas Styrbicki
 THOMAS STYRBICKI
 STATE DESIGN ENGINEER

STANDARD PLAN
 5-297.219

1 OF 1

STANDARD PLAN

STATE PROJ. NO.
 TRUNK HWY.

SHEET NO.
 TOTAL SHEETS