













PLOTTED/REVISED: 5-DEC-2019

I/PLOT NAME: 16285-135AB
 PATH & FILENAME: Projects\DM_R05\694\0000\Traffic\Lighting\16285-135AB.dgn

LEGEND

-  LIGHTING UNIT
-  UNDERPASS FIXTURE
-  PAD MOUNTED FD. PT. CABINET 240/480 VOLT
-  INSTALL SALVAGED SERVICE CABINET TYPE L1.
-  ARMORED CABLE 4 CONDUCTOR NO. 4
-  HANDHOLE
-  PERMANENT GROUND ROD (25 OHMS OR LESS)
-  3" NMC UNLESS NOTED OTHERWISE
-  INPLACE LIGHTING UNIT
-  INPLACE CONDUIT
-  INPLACE ARMORED CABLE 4 CONDUCTOR NO. 4
-  INPLACE OVERHEAD POWER LINES.

FEEDPOINT N2S					
LIGHTING STANDARDS AND BASES					
NO.	STATION	LT.	RT.	LOCATION	TYPE WATT
1	671+75		X	WB 694	9-49 400
2	674+25		X		9B-49
3	676+50		X		9B-49
4	678+80		X		9-49
5	681+25		X		
6	683+80		X		
7	686+60		X		
8	689+35		X		
9	692+15		X		
10	694+95		X		
11	697+75		X		
12	700+55		X		
13	703+35		X		
14	706+15		X		
15	708+95		X		
16	711+75		X	WB 694	
17	709+50		X	EB 694	
18	706+65	X			
19	704+00	X			
20	701+30	X			
21	698+65	X			
22	695+95	X			
23	693+25	X			
24	690+60	X			
25	687+85	X			
26	685+25	X		EB 694	9-49
27	59+63	X		EB CD	9B-49
28	678+00	X		EB 694	9-49
29	675+50	X			9B-49 400
30	673+00	X			
31	670+45	X			
32	667+95	X			
33	665+45	X			
34	663+00	X		EB 694	
35	57+20	X		EB CD	9B-49 400
36	54+80	X		EB CD	9B-40 250
37	682+25		X	SB 10	9-40
38	679+90		X		9-40
39	677+50		X		9-40
40	676+20		X		L
41	674+95		X	SB 10	L 250



DASHED LINES DENOTE INPLACE ITEMS
 W DENOTES NEUTRAL CONDUCTOR
 B AND R DENOTE CURRENT CARRYING CONDUCTORS
 FD. PT. N2S
 240/480 VOLT

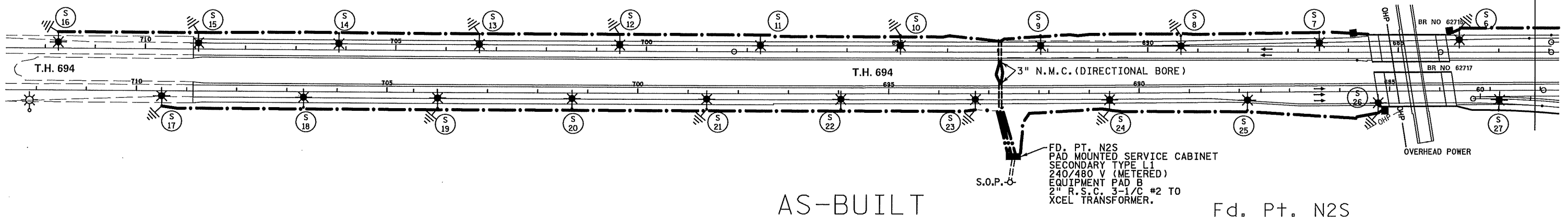
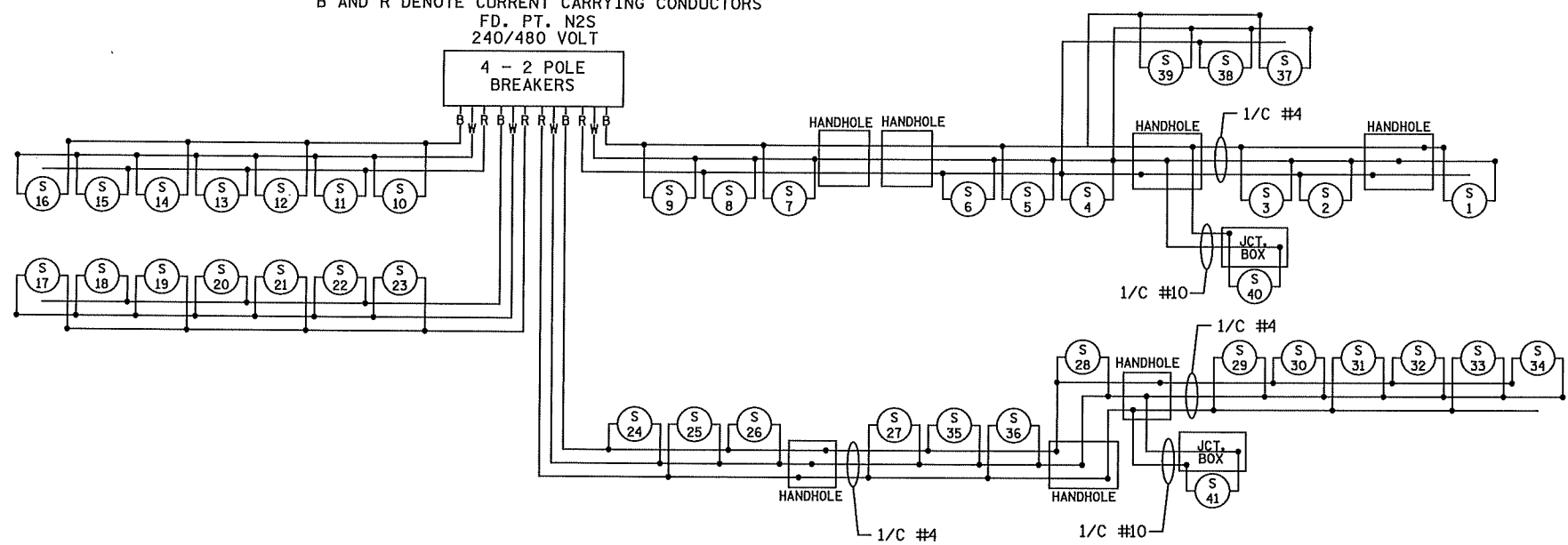

AS-BUILT

Fd. Pt. N2S

BY	DATE	REVISIONS	FEEDPOINT: N2S	LOCATION: T.H. 694., East of Old Hwy 10.	LIGHTING PLAN
HRL	01/28/19	CONSTRUCTION CHANGES	METER ADDRESS: 1700 T.H. 694, Arden Hills, 55112.		
DRAWN BY: PB CKD BY: GB DATE:			CERTIFIED BY DRAFT LIC. NO. _____ DATE: 5-DEC-2019		STATE PROJ. NO. 6285-135 (T.H. 694) SHEET NO. SL11 OF SL19 SHEETS

SEE LEGEND SHEET SL11

W DENOTES NEUTRAL CONDUCTOR
 B AND R DENOTE CURRENT CARRYING CONDUCTORS
 FD. PT. N2V
 240/480 VOLT

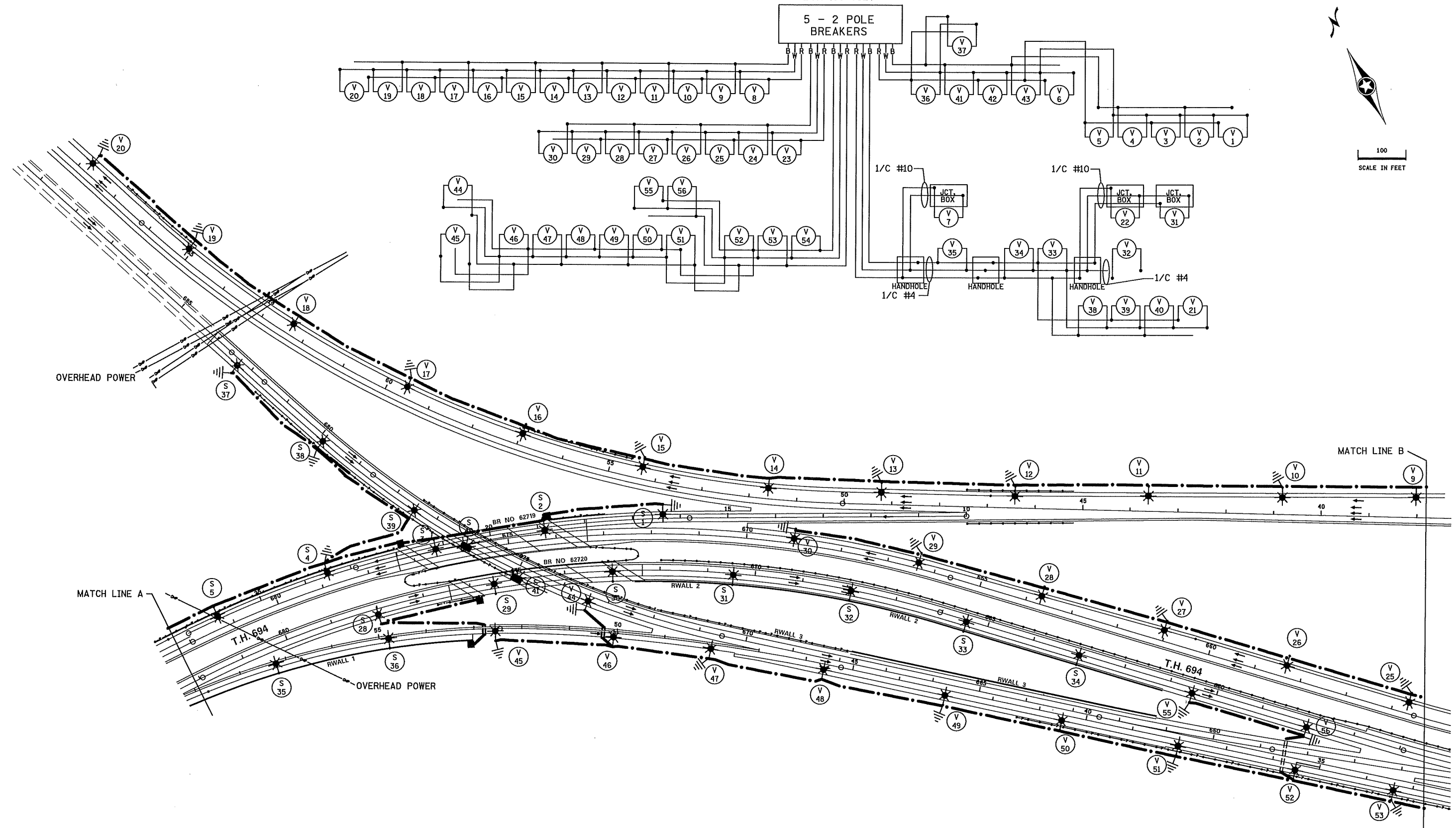

AS-BUILT

FD. PT. N2S, & N2V

BY	DATE	REVISIONS
HR	1/28/19	CONSTRUCTION CHANGES

FEEDPOINT: N2V LOCATION: T.H. 694 & T.H. 10 AT HAMLINE.
 METER ADDRESS: 4102 Hamline Ave N, Arden Hills, 55112

LIGHTING PLAN

DRAWN BY: PB CKD BY: GB DATE: _____

CERTIFIED BY **DRAFT** LIC. NO. _____ DATE: 5-DEC-2019
LICENSED PROFESSIONAL ENGINEER

STATE PROJ. NO. 6285-135 (T.H. 694) SHEET NO. SL12 OF SL19 SHEETS

PLOTTED/REVISED: 5-DEC-2019

PLOT NAME: 16285-135AB
 PATH & FILENAME: Projects\DM_ROMS\69-A\0000\Traffic\Lighting\16285-135AB.dgn

SEE LEGEND SHEET SL11

PLOTTED/REVISED: 6-DEC-2019

I/PLOT NAME: 16285-135AB
PATH & FILENAME: Projects\DM_R05\69-A00000\Traffic\Lighting\16285-135AB.dgn

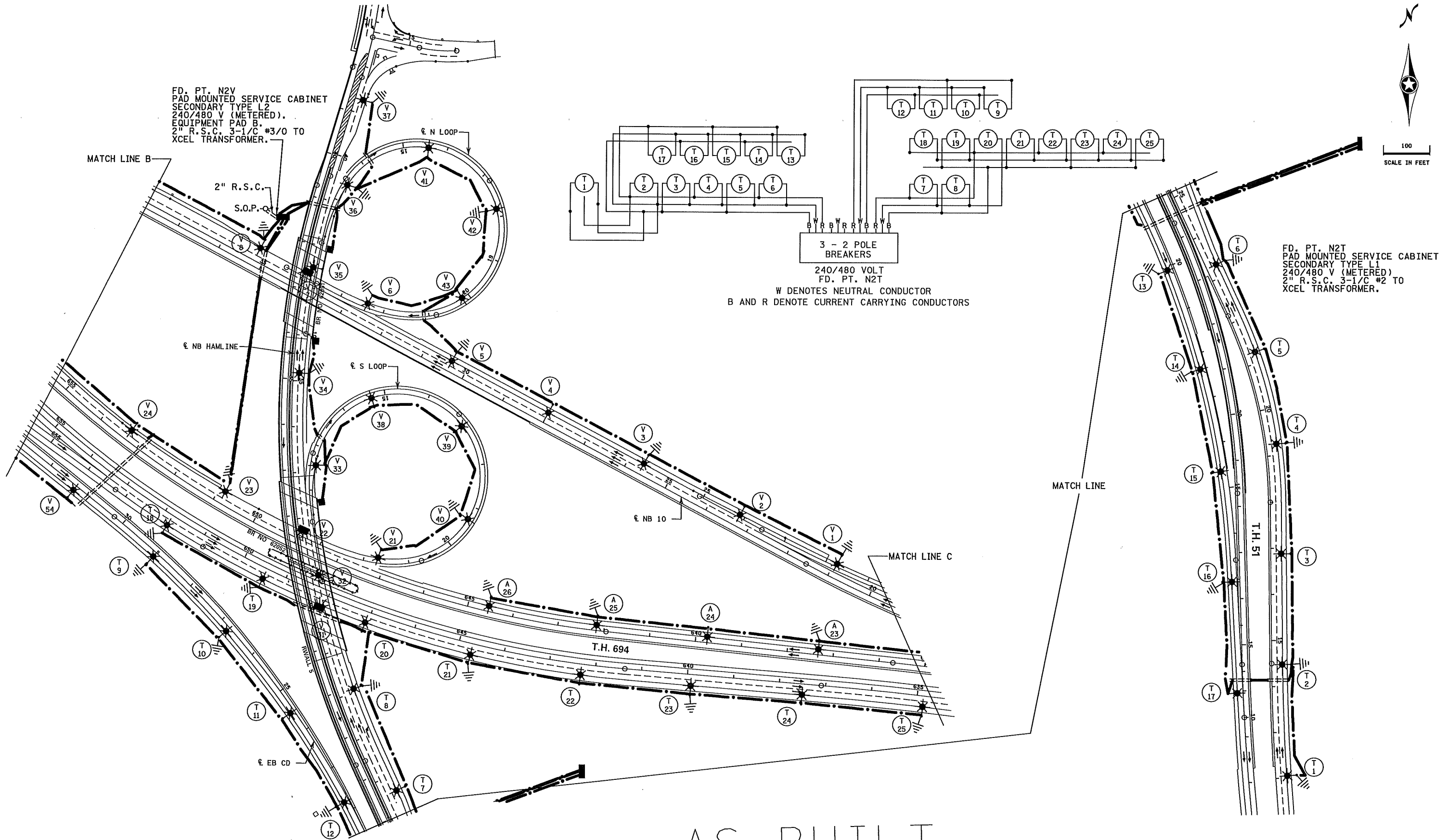

BY	DATE	REVISIONS
HRL	1/28/19	CONSTRUCTION CHANGES
DRAWN BY:	PB	CKD BY: GB DATE:

FEEDPOINT: N2T LOCATION: T.H. 694. & HAMLINE
METER ADDRESS: 3803 Snelling Ave, Arden Hills, 55112

CERTIFIED BY _____ **DRAFT** _____ LIC. NO. _____ DATE: 6-DEC-2019
LICENSED PROFESSIONAL ENGINEER

LIGHTING PLAN

STATE PROJ.NO.6285-135 (T.H.694) SHEET NO. SL13 OF SL19 SHEETS

SEE LEGEND SHEET SL11

PLOTTED/REVISED: 5-DEC-2019

I/PLOT NAME: 16285-135AB
 PATH & FILENAME: Projects\DM_ROS\694\0000\Traffic\Lighting\6285-135AB.dgn

DASHED LINES DENOTE INPLACE ITEMS
 W DENOTES NEUTRAL CONDUCTOR
 B AND R DENOTE CURRENT CARRYING CONDUCTORS
 FD. PT. N3A
 240/480 VOLT

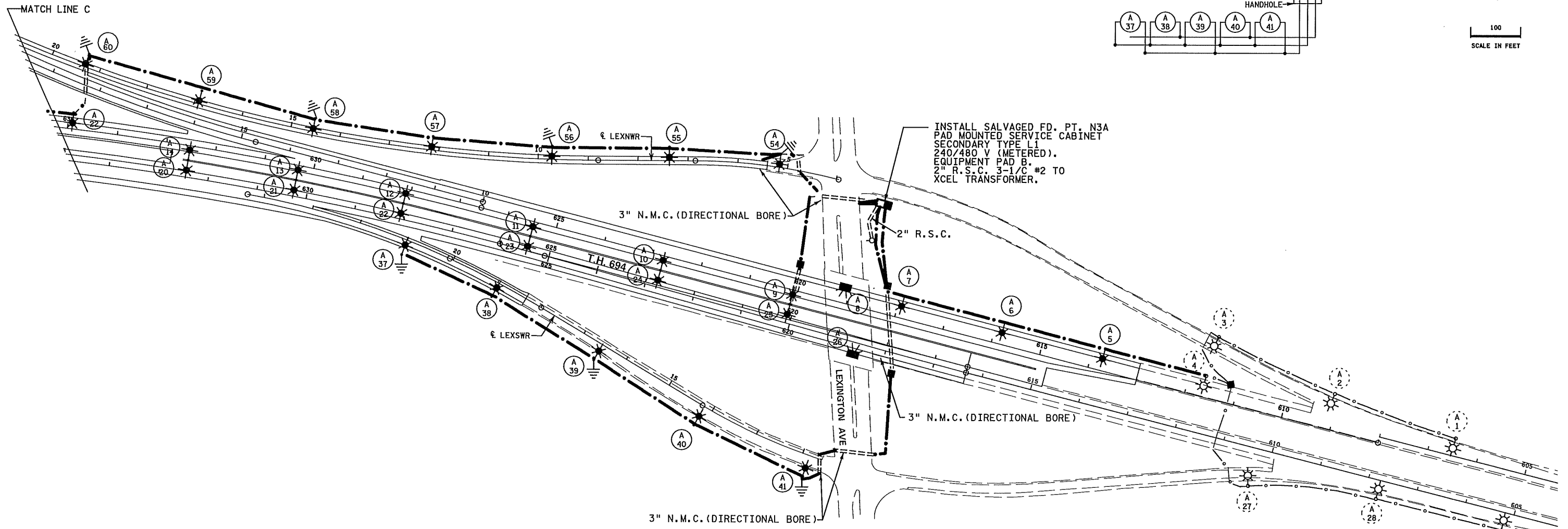
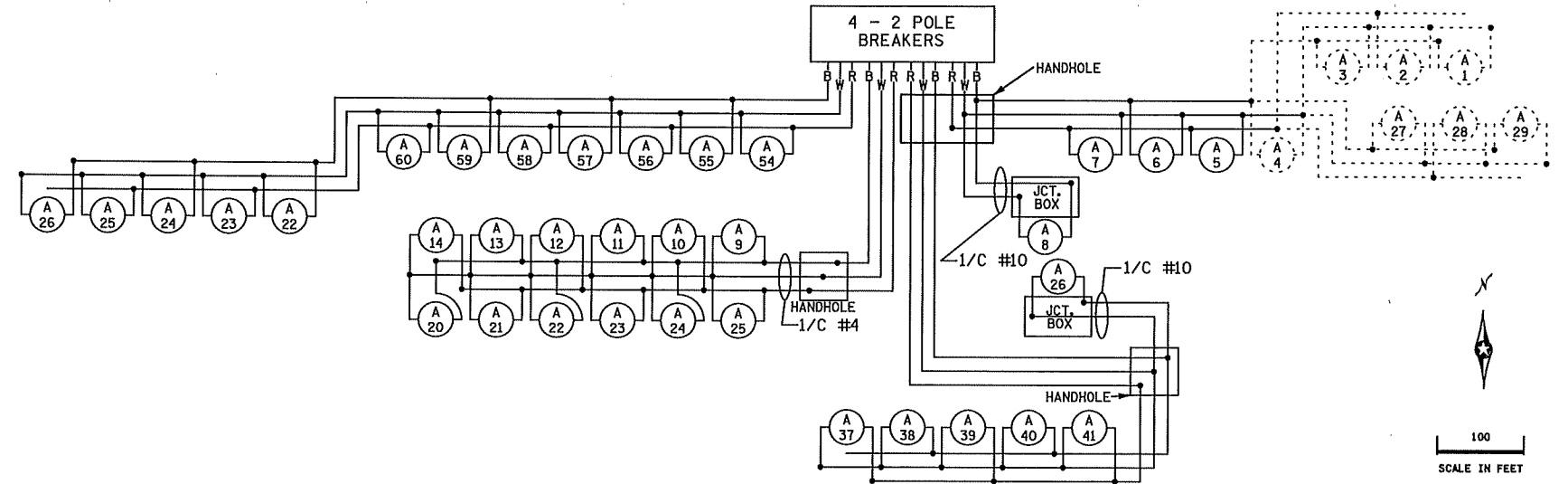

AS-BUILT

FD. PT. N3A

BY	DATE	REVISIONS	FEEDPOINT: N3A	LOCATION: T.H. 694 & LEXINGTON	LIGHTING PLAN
HRL	1/28/19	CONSTRUCTION CHANGES	METER ADDRESS:		
DRAWN BY: PB CKD BY: GB DATE:			CERTIFIED BY: <i>Michael P. Dubinsky</i> LIC. NO. 19863 DATE: 5-DEC-2019		STATE PROJ. NO. 6285-135 (T.H. 694) SHEET NO. SL14 OF SL19 SHEETS