

PLOTTED/REVISED: 14-JUN-2023

DISTRICT *: Metro
 PLOT NAME: layout
 FILENAME: Projects\DM_FOS\095\0000\Traffic\Signal\05\19_12\1\PICKETT_AV&slask\KING_PLANT-1736072\1736072_sgl.dgn

LOOP DETECTOR CHART		
NUMBER	SIZE (FT)	LOCATION
D1-1, D5-1	2-6x6	20 & 50
D1-2, D5-2	2-6x6	5 & 35
D2-1, D2-2	6x6	250
D4-1, D8-1	6x6	120
D4-2, D8-2	6x6	5
D4-3, D8-3	6x6	5 & 20
D6-1, D6-2	6x6	250

-ALL LOOP DETECTORS SHALL BE PVC UNLESS NOTED OTHERWISE
 -LOCATION: DISTANCE FROM CROSSWALK/STOP BAR IN FEET

SIGNAL FACE CHART				
FACE	R	Y	FYA	G
1-1, 1-2	←	←	←	←
2-1, 2-2, 2-3	●	●		●
4-1, 4-2, 4-3	●	●		●
5-1, 5-2	←	←	←	←
6-1, 6-2, 6-3	●	●		●
8-1, 8-2, 8-3	●	●		●

-ALL SIGNAL INDICATIONS SHALL BE 12" LED
 -ALL SIGNAL HEADS SHALL BE BLACK POLYCARBONITE WITH BACKGROUND SHIELDS
 -FYA DENOTES FLASHING YELLOW ARROW

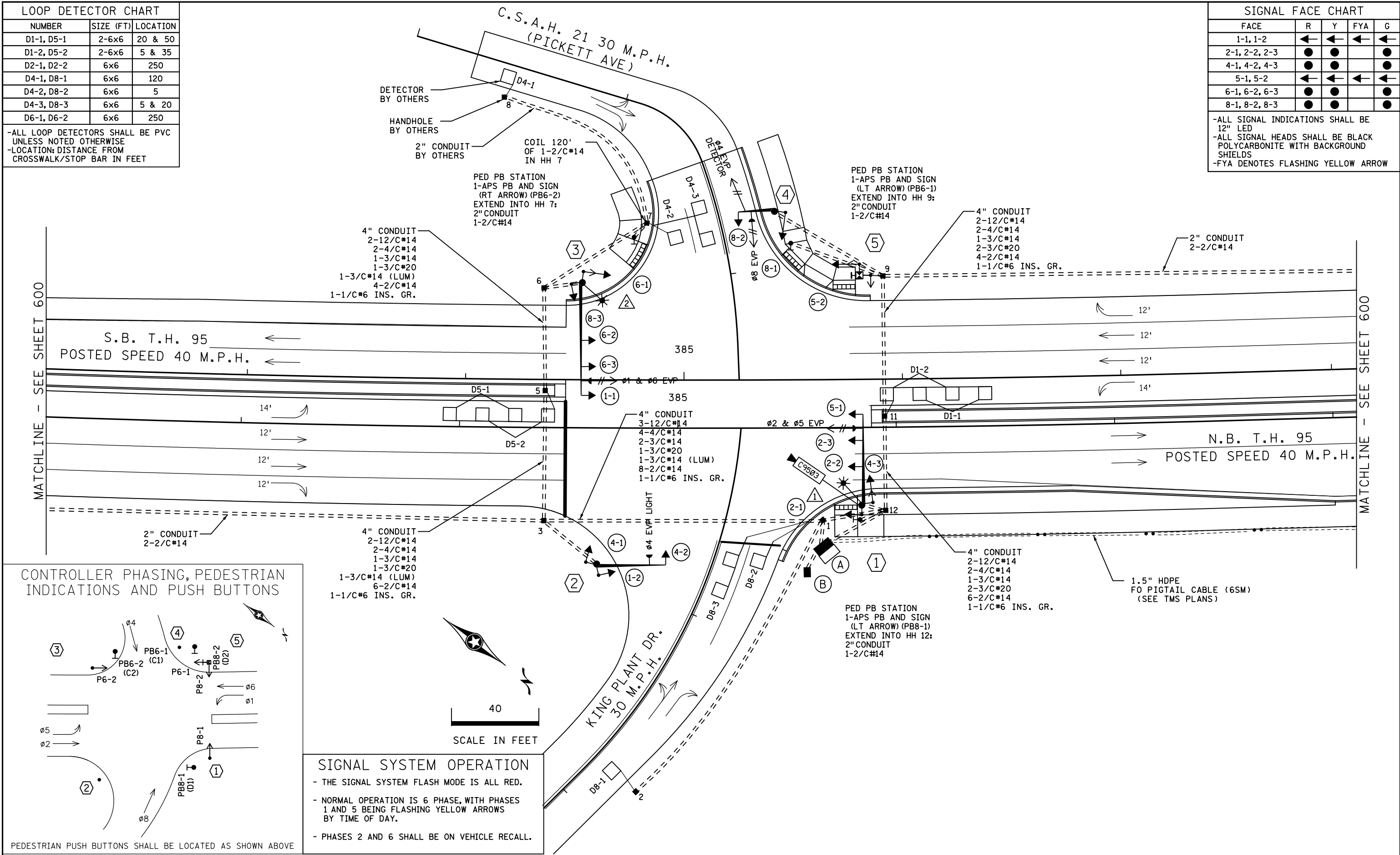

CONTROLLER PHASING, PEDESTRIAN INDICATIONS AND PUSH BUTTONS

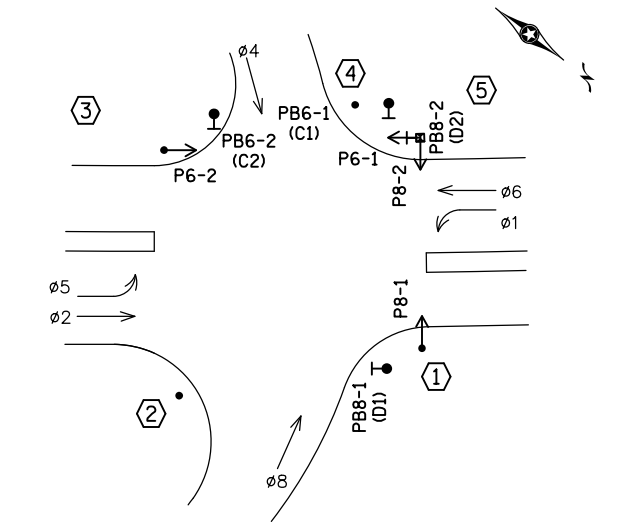

SIGNAL SYSTEM OPERATION

- THE SIGNAL SYSTEM FLASH MODE IS ALL RED.
- NORMAL OPERATION IS 6 PHASE, WITH PHASES 1 AND 5 BEING FLASHING YELLOW ARROWS BY TIME OF DAY.
- PHASES 2 AND 6 SHALL BE ON VEHICLE RECALL.

PEDESTRIAN PUSH BUTTONS SHALL BE LOCATED AS SHOWN ABOVE

BY: SJK	DATE: 06/14/23	REVISIONS: PTZ CAMERA UPGRADE SP 8825-890	SYSTEM ID: 1736072	T.E.	INTERSECTION LAYOUT TH 95 AT CSAH 21 (PICKETT AVE)/ KING PLANT DR IN WASHINGTON COUNTY	S.A.P. NO.	DRAWN BY:	CKD BY:	DATE:
			METER ADDRESS: 5725 ST. CROIX TR.	OLD SYSTEM ID:		CERTIFIED BY: _____	LIC. NO. _____	DATE: _____	STATE PROJ.NO. 8214-144 (T.H.95) SHEET NO. 1 OF 3 SHEETS

PLOTTED/REVISED: 14-JUN-2023

DISTRICT *: Metro
 IPLOT NAME: match lines
 FILENAME: Projects\DM_FROSO950000\Traffic\Signal\0519_121\PICKETT_AV&slashtg\ING PLANT-1736072\1736072_sgl.dgn

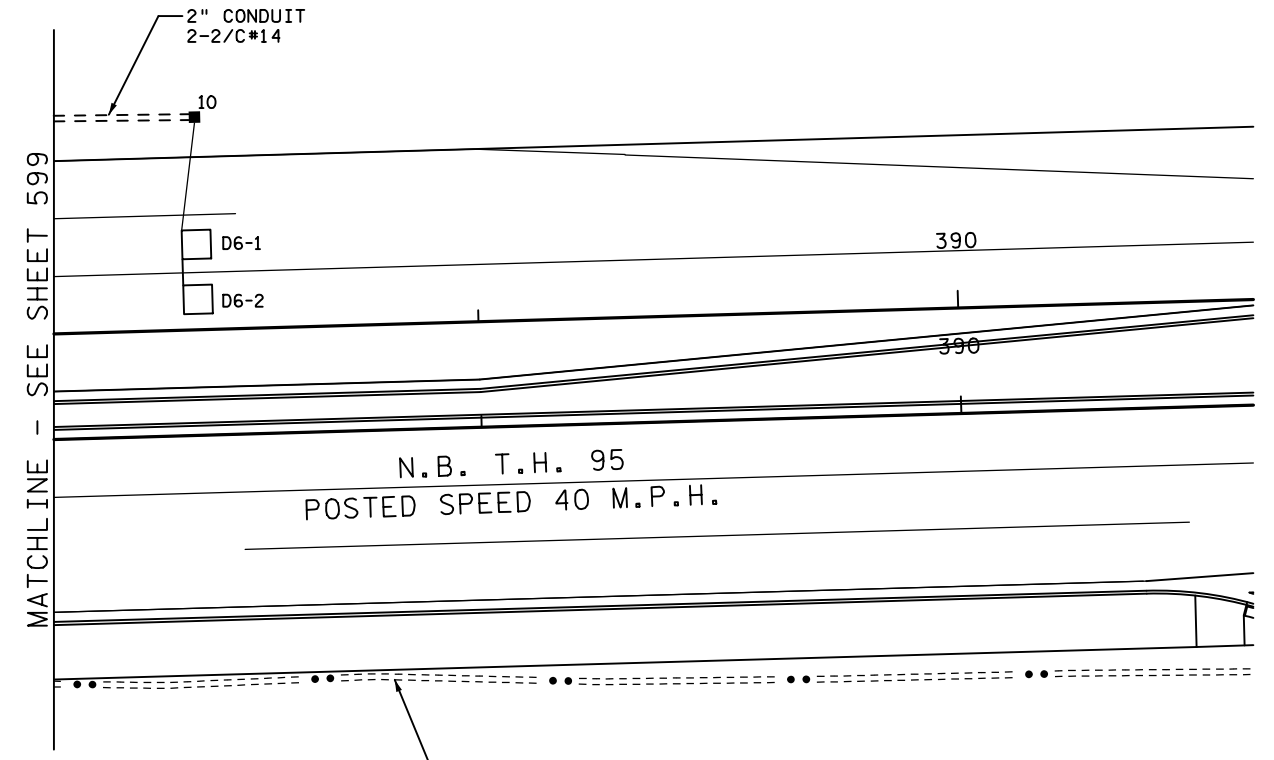
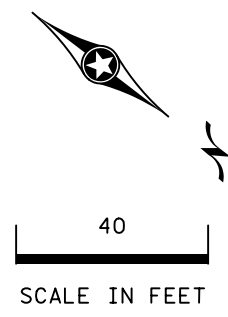
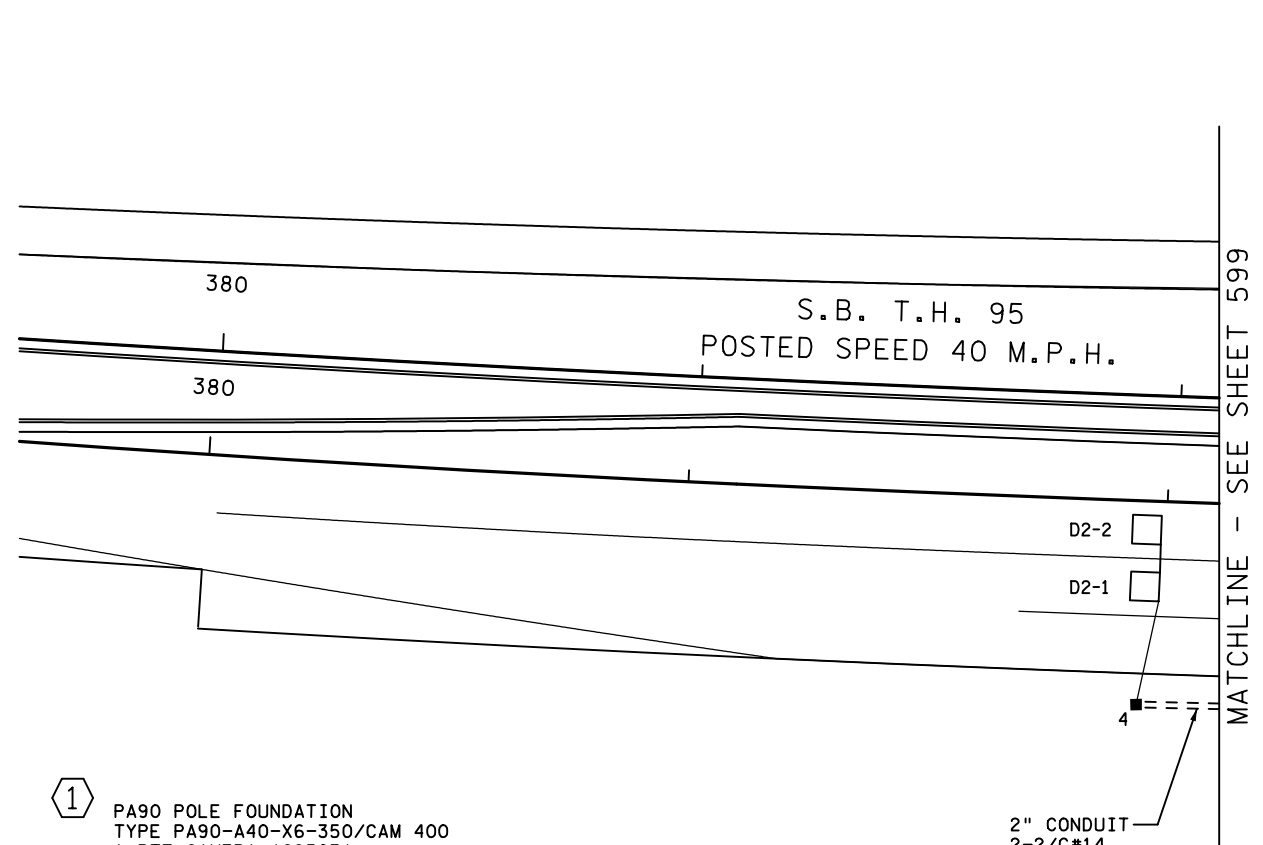

- ① PA90 POLE FOUNDATION
 TYPE PA90-A40-X6-350/CAM 400
 1-PTZ CAMERA (C9503)
 1-ANGLE MOUNT SIGNAL OVERHEAD AT 0'
 2-STRAIGHT MOUNT SIGNALS OVERHEAD
 AT 12' AND 24'
 2-ANGLE MOUNT SIGNALS AT 90 AND 180 DEG
 1-ANGLE MOUNT C. D. PED IND
 AT 90 DEG
 1-ONE WAY EVP DETECTOR AND
 CONFIRMATORY LIGHT (PHASES 2+5)
 LUMINAIRE-250W LED
 1-R10-X12 SIGN ADJACENT TO HEAD (5-1)
 2-TYPE D SIGN (D-16 & D-17) (SEE SIGN DETAILS)
 3" CONDUIT TO HH 12:
 2-12/C#14
 2-4/C#14
 1-3/C#14
 1-3/C#20
 1-3/C#14 (LUM)
 1-3/C#14 (CAM POWER)
 1-1/C#6 INS. GR.
 1-CAT5E (COMM)

- ② PA85 POLE FOUNDATION
 TYPE PA85-A-30
 1-ANGLE MOUNT SIGNAL OVERHEAD AT 0'
 2-ANGLE MOUNT SIGNALS AT 90 AND 180 DEG
 1-ONE WAY EVP CONFIRMATORY LIGHT (PHASE 4)
 1-TYPE D SIGN (D-20) (SEE SIGN DETAILS)
 3" CONDUIT TO HH 3:
 1-12/C#14
 2-4/C#14
 1-3/C#14
 1-1/C#6 INS. GR.

- ⑤ PEDESTAL FOUNDATION
 13' PEDESTAL POLE PLUS BASE
 1-ANGLE MOUNT SIGNAL AT 90 DEG
 2-ANGLE MOUNT C. D. PED INDS
 AT 90 AND 180 DEG
 1-APS PB (RT ARROW) AT 0 DEG (PB8-2)
 3" CONDUIT TO HH 9:
 1-12/C#14
 2-4/C#14
 1-2/C#14
 1-1/C#6 INS. GR.

- ③ PA100 POLE FOUNDATION
 TYPE PA100-A-50-D40-9 (DAVIT AT 350 DEG)
 1-ANGLE MOUNT SIGNAL OVERHEAD AT 0'
 2-STRAIGHT MOUNT SIGNALS OVERHEAD
 AT 12' AND 24'
 2-ANGLE MOUNT SIGNALS AT 90 AND 180 DEG
 1-ANGLE MOUNT C. D. PED IND
 AT 180 DEG
 1-ONE WAY EVP DETECTOR AND
 CONFIRMATORY LIGHT (PHASES 1+6)
 LUMINAIRE-250W LED
 1-R10-X12 SIGN ADJACENT TO HEAD (1-1)
 2-TYPE D SIGN (D-18 & D-19) (SEE SIGN DETAILS)
 3" CONDUIT TO HH 6:
 2-12/C#14
 2-4/C#14
 1-3/C#14
 1-3/C#20
 1-3/C#14 (LUM)
 1-1/C#6 INS. GR.

- ④ PA85 POLE FOUNDATION
 TYPE PA85-A-15
 1-ANGLE MOUNT SIGNAL OVERHEAD AT 0'
 1-ANGLE MOUNT SIGNAL AT 180 DEG
 1-ONE WAY EVP DETECTOR (PHASE 4)
 1-ONE WAY EVP DETECTOR AND
 CONFIRMATORY LIGHT (PHASE 8)
 1-TYPE D SIGN (D-20) (SEE SIGN DETAILS)
 3" CONDUIT TO HH 9:
 1-12/C#14
 1-3/C#14
 2-3/C#20
 1-1/C#6 INS. GR.

- Ⓐ EQUIPMENT PAD (SEE DETAIL SHEET)
 SERVICE CABINET (SSB)
 CONTROLLER AND CABINET (STATE FURNISHED)
 4" CONDUIT TO HH 1:
 11-2/C#14
 3-12/C#14
 4-4/C#14
 2-3/C#14
 1-3/C#20
 1-1/C#6 INS. GR.
 4" CONDUIT TO HH 12:
 7-2/C#14
 4-12/C#14
 2-3/C#14
 3-3/C#20
 4-4/C#14
 1-CAT5E (COMM)
 1-1/C#6 INS. GR.
 2-2" AND 1-3" CONDUIT STUBBED OUT (CAPPED BOTH ENDS)
 1-1/2" CONDUIT TO SIGNAL SYTEM F:
 1-FO PIGTAIL (6-SM)
 CONTROLLER CABINET TO SERVICE CABINET:
 2" CONDUIT
 2-1/C#6
 1-1/C#6 INS. GR.
 CONTROLLER CABINET TO SERVICE CABINET (COMMS):
 2" CONDUIT
 1-6PR#19
 SERVICE CABINET TO GROUND MOUNTED TRANSFORMER:
 2" CONDUIT
 3-1/C#2
 SERVICE CABINET TO HH 1:
 2" CONDUIT
 2-3/C#14 (LUM)
 HH 1 TO HH 12:
 2" CONDUIT
 1-3/C#14 (LUM)
- Ⓑ SOP-GROUND MOUNTED
 TRANSFORMER (XCEL ENERGY)
 2" CONDUIT INTO SERVICE CABINET:
 3-1/C#2

BY	DATE	REVISIONS
SJK	06/14/23	PTZ CAMERA UPGRADE

SYSTEM ID: 1736072 T.E.
 METER ADDRESS: 5725 ST. CROIX TR.
 OLD SYSTEM ID:

**MATCH LINES AND POLE NOTES
 TH 95 AT CSAH 21 (PICKETT AVE)/
 KING PLANT DR
 IN WASHINGTON COUNTY**

S.A.P. NO.	DRAWN BY:	CKD BY:	DATE:
CERTIFIED BY _____	LIC. NO. _____	DATE: _____	
STATE PROJ.NO. 8214-144 (T.H.95)		SHEET NO. 2 OF	3 SHEETS

PLOTTED/REVISED: 14-JUN-2023

DISTRICT *: Metro
PLOT NAME: wire
FILENAME: Projects\DM_FOS\09500001\Traffic\Signal\0519_121\PICKETT AV&slasky\KING PLANT-IT36072\IT36072_sgl.dgn

CONTROLLER CABINET

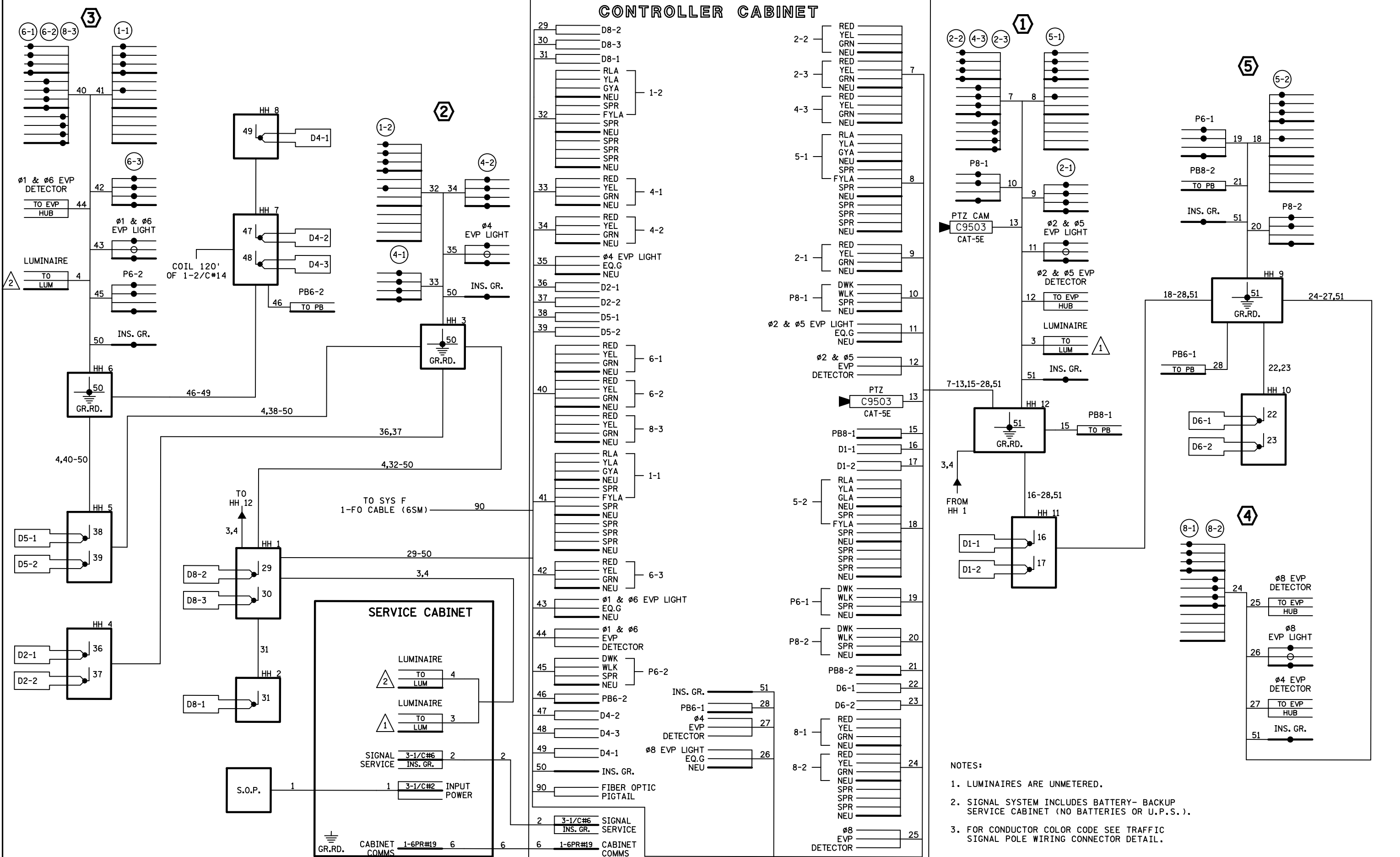

NOTES:

- LUMINAIRES ARE UNMETERED.
- SIGNAL SYSTEM INCLUDES BATTERY- BACKUP SERVICE CABINET (NO BATTERIES OR U.P.S.).
- FOR CONDUCTOR COLOR CODE SEE TRAFFIC SIGNAL POLE WIRING CONNECTOR DETAIL.

BY	DATE	REVISIONS	SYSTEM ID:	T.E.	S.A.P. NO.	DRAWN BY:	CKD BY:	DATE:
SJK	06/14/23	PTZ CAMERA UPGRADE	1736072	T.E.				
			METER ADDRESS: 5725 ST. CROIX TR.	IFIELD WIRING DIAGRAM TH 95 AT CSAH 21 (PICKETT AVE)/ KING PLANT DR IN WASHINGTON COUNTY		CERTIFIED BY _____ LIC. NO. _____ DATE: _____		
			OLD SYSTEM ID:			STATE PROJ.NO. 8214-144 (T.H.95)		SHEET NO. 3 OF 3 SHEETS

LOOP DETECTOR CHART		
NUMBER	SIZE (FT)	LOCATION
D1-1, D5-1	2-6x6	20 & 50
D1-2, D5-2	2-6x6	5 & 35
D2-1, D2-2	6x6	250
D4-1, D8-1	6x6	120
D4-2, D8-2	6x6	5
D4-3, D8-3	6x6	5 & 20
D6-1, D6-2	6x6	250

-ALL LOOP DETECTORS SHALL BE PVC UNLESS NOTED OTHERWISE
-LOCATION: DISTANCE FROM CROSSWALK/STOP BAR IN FEET

SIGNAL FACE CHART				
FACE	R	Y	FYA	G
1-1, 1-2	←	←	←	←
2-1, 2-2, 2-3	●	●		●
4-1, 4-2, 4-3	●	●		●
5-1, 5-2	←	←	←	←
6-1, 6-2, 6-3	●	●		●
8-1, 8-2, 8-3	●	●		●

-ALL SIGNAL INDICATIONS SHALL BE 12" LED
-ALL SIGNAL HEADS SHALL BE BLACK POLYCARBONITE WITH BACKGROUND SHIELDS
-FYA DENOTES FLASHING YELLOW ARROW

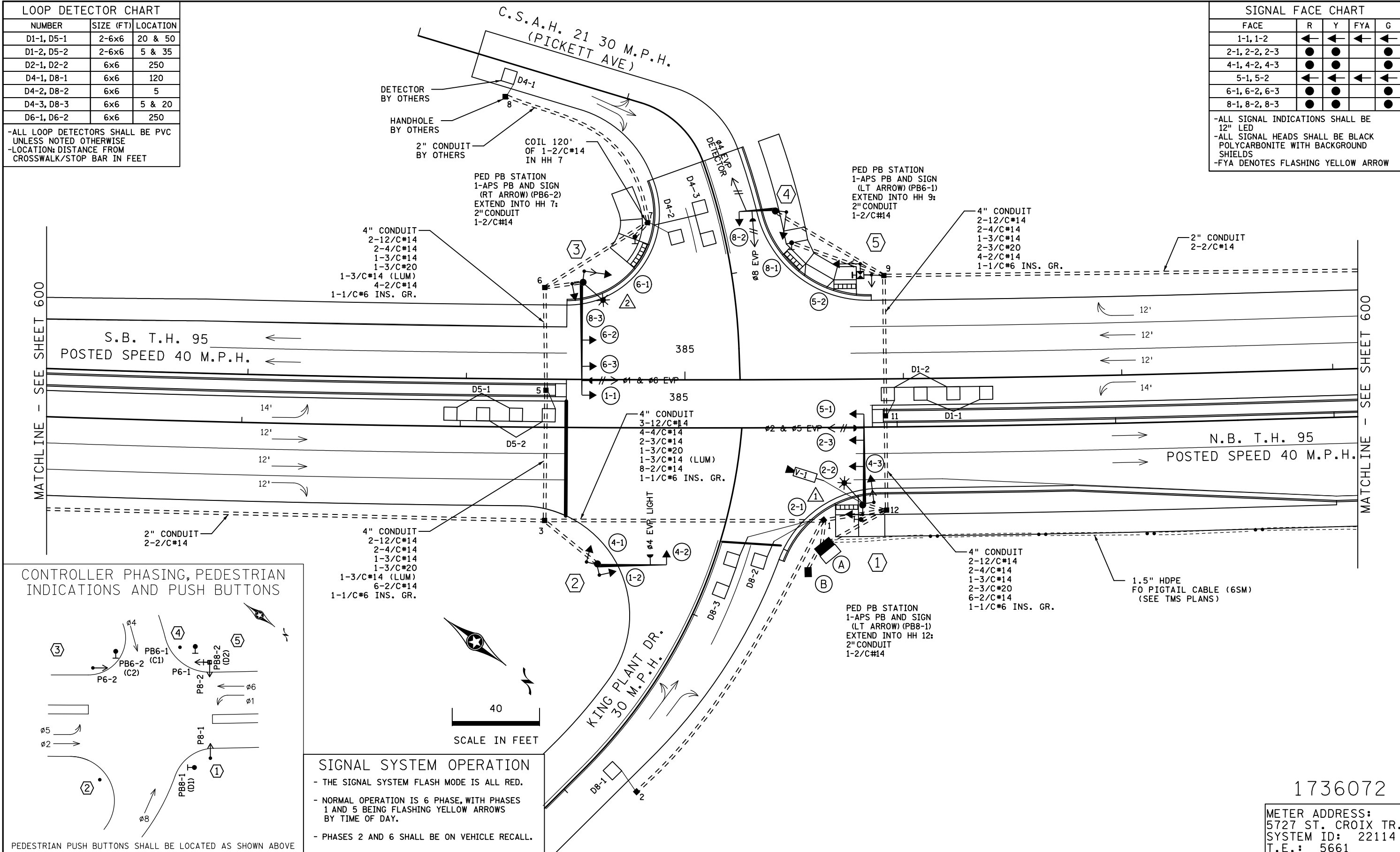

1736072

METER ADDRESS:
5727 ST. CROIX TR.
SYSTEM ID: 22114
T.E.: 5661

NO	DATE	BY	CHKD	APPR	REVISION
0	06/20/13	KAS	RJG	JWD	EARLY RELEASE - DP T-2
1	06/27/13	KAS	RJG	JWD	NDC 004 - MA CHANGES DUE TO CSAH 21 TRAIL UPDATE
2	08/08/13	KS	RJG	KAS	INITIAL RELEASE FOR CONSTRUCTION - DP T-2
3	03/22/16	NSM	TJJ	JWD	RECORD PLAN
4	12/7/18	JBA			BY MNDOT: ADDED TAMS SYSTEM ID*, TO OPERATIONS PLAN

DRAWING NO.: SGL90

RECORD DRAWING NOTE

THESE RECORD DRAWINGS WERE DEVELOPED BASED ON THE PREVIOUS DRAWING REVISIONS AND INFORMATION TRANSMITTED FROM THE FIELD BY OTHERS. THE INFORMATION CONTAINED WITHIN THIS RECORD AS-BUILT PLAN REPRESENTS THE ACTUAL CONDITIONS FOR ALL CHANGES OF WHICH ALLIANT IS AWARE. FUTURE USERS OF THESE DRAWINGS SHOULD VERIFY AS-BUILT CONDITIONS IN THE FIELD IN ALL CIRCUMSTANCES.



ST. CROIX MN APPROACHES (S.P. 8214-114) SHEET

SIGNAL SYSTEM E
INTERSECTION LAYOUT

T.H. 95 AT C.S.A.H. 21 (PICKETT AVE)/KING PLANT DR

599 OF 628

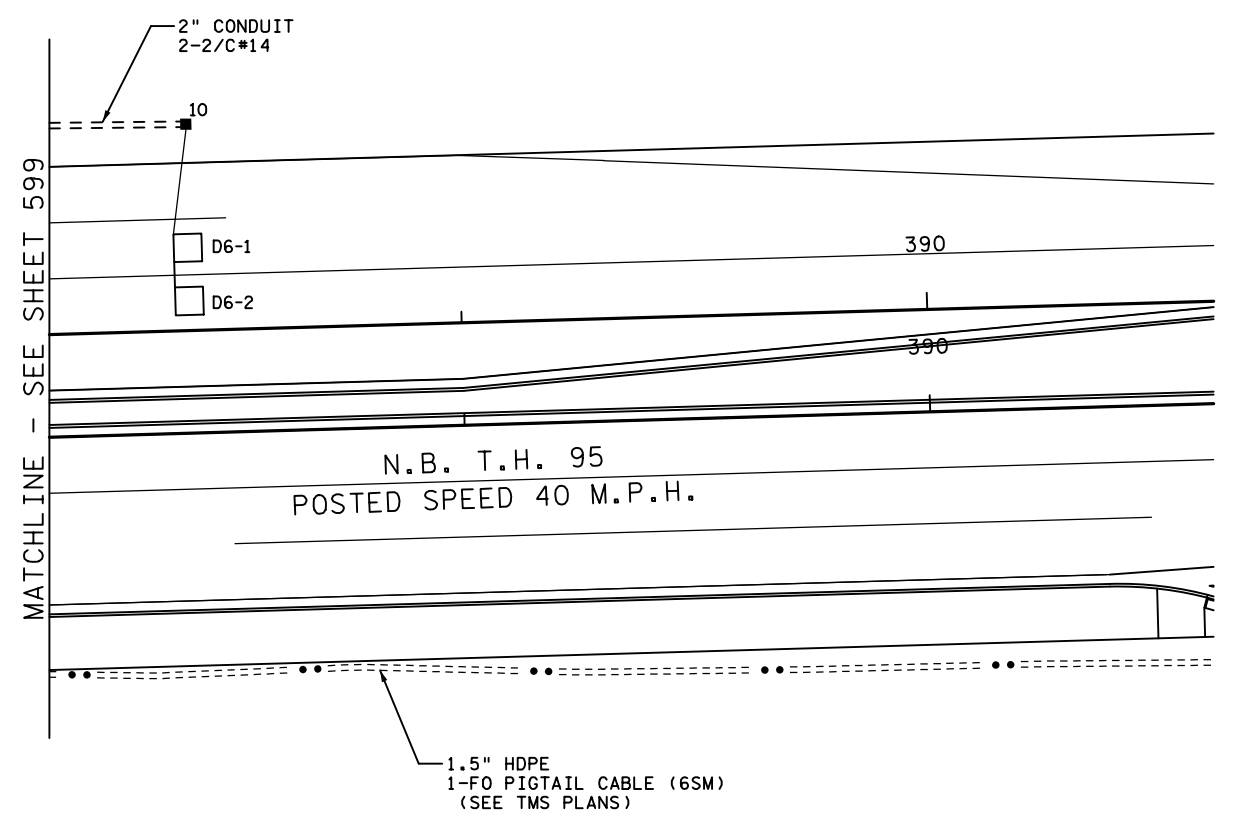
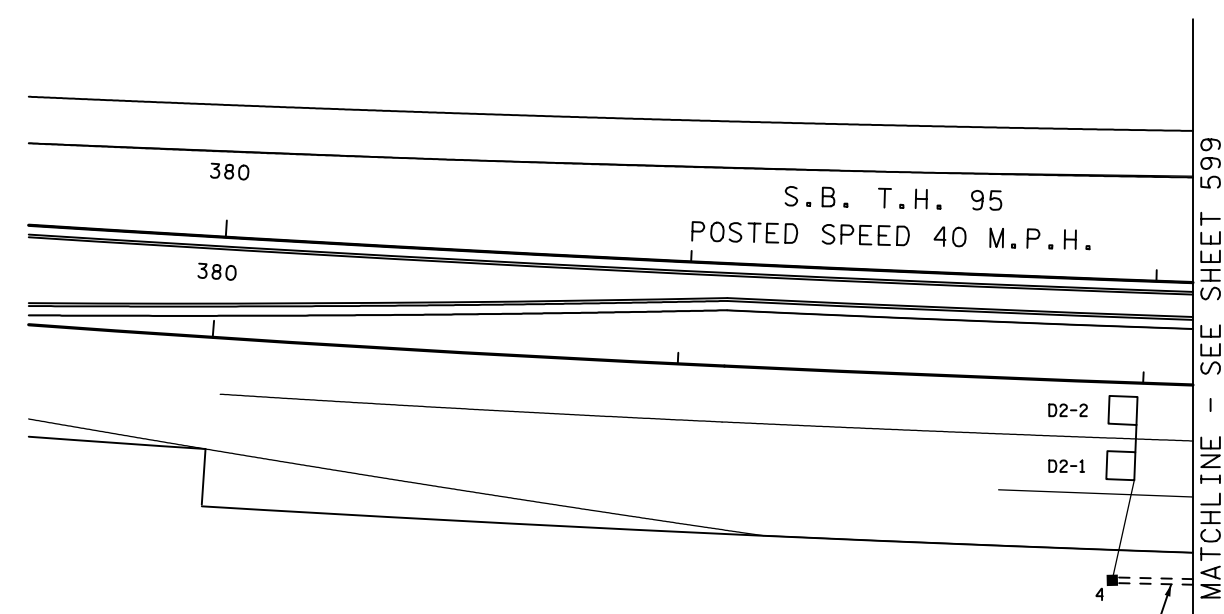
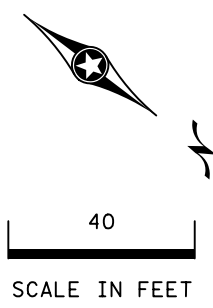

- ① X=511710.7718
Y=204398.9773
PA90 POLE FOUNDATION
TYPE PA90-A40-X6-350/CAM 400
1-VIDEO CAMERA WITH MOUNT (STATE FURNISHED)
1-ANGLE MOUNT SIGNAL OVERHEAD AT 0'
2-STRAIGHT MOUNT SIGNALS OVERHEAD AT 12' AND 24'
2-ANGLE MOUNT SIGNALS AT 90 AND 180 DEG
1-ANGLE MOUNT C. D. PED IND AT 90 DEG
1-ONE WAY EVP DETECTOR AND CONFIRMATORY LIGHT (PHASES 2+5)
LUMINAIRE-250W LED
1-R10-X12 SIGN ADJACENT TO HEAD (5-1)
2-TYPE D SIGN (D-16 & D-17) (SEE SIGN DETAILS)
3" CONDUIT TO HH 12:
2-12/C#14
2-4/C#14
1-3/C#14
1-3/C#20
1-3/C#14 (LUM)
1-3/C#14 (CAM POWER)
1-1/C#6 INS. GR.
1-COM CABLE
1-COAXIAL CABLE

- ② X=511805.9069
Y=204318.9079
PA85 POLE FOUNDATION
TYPE PA85-A-30
1-ANGLE MOUNT SIGNAL OVERHEAD AT 0'
2-ANGLE MOUNT SIGNALS AT 90 AND 180 DEG
1-ONE WAY EVP CONFIRMATORY LIGHT (PHASE 4)
1-TYPE D SIGN (D-20) (SEE SIGN DETAILS)
3" CONDUIT TO HH 3:
1-12/C#14
2-4/C#14
1-3/C#14
1-1/C#6 INS. GR.

- ⑤ X=511627.8577
Y=204334.2105
PEDESTAL FOUNDATION
13' PEDESTAL POLE PLUS BASE
1-ANGLE MOUNT SIGNAL AT 90 DEG
2-ANGLE MOUNT C. D. PED INDS AT 90 AND 180 DEG
1-APS PB (RT ARROW) AT 0 DEG (PB8-2)
3" CONDUIT TO HH 9:
1-12/C#14
2-4/C#14
1-2/C#14
1-1/C#6 INS. GR.

- ③ X=511707.5433
Y=204235.4795
PA100 POLE FOUNDATION
TYPE PA100-A-50-D40-9 (DAVIT AT 350 DEG)
1-ANGLE MOUNT SIGNAL OVERHEAD AT 0'
2-STRAIGHT MOUNT SIGNALS OVERHEAD AT 12' AND 24'
2-ANGLE MOUNT SIGNALS AT 90 AND 180 DEG
1-ANGLE MOUNT C. D. PED IND AT 180 DEG
1-ONE WAY EVP DETECTOR AND CONFIRMATORY LIGHT (PHASES 1+6)
LUMINAIRE-250W LED
1-R10-X12 SIGN ADJACENT TO HEAD (1-1)
2-TYPE D SIGN (D-18 & D-19) (SEE SIGN DETAILS)
3" CONDUIT TO HH 6:
2-12/C#14
2-4/C#14
1-3/C#14
1-3/C#20
1-3/C#14 (LUM)
1-1/C#6 INS. GR.

- ④ X=511628.2111
Y=204285.5493
PA85 POLE FOUNDATION
TYPE PA85-A-15
1-ANGLE MOUNT SIGNAL OVERHEAD AT 0'
1-ANGLE MOUNT SIGNAL AT 180 DEG
1-ONE WAY EVP DETECTOR (PHASE 4)
1-ONE WAY EVP DETECTOR AND CONFIRMATORY LIGHT (PHASE 8)
1-TYPE D SIGN (D-20) (SEE SIGN DETAILS)
3" CONDUIT TO HH 9:
1-12/C#14
1-3/C#14
2-3/C#20
1-1/C#6 INS. GR.

- Ⓐ EQUIPMENT PAD (SEE DETAIL SHEET)
SERVICE CABINET (SSB)
CONTROLLER AND CABINET (STATE FURNISHED)
4" CONDUIT TO HH 1:
11-2/C#14
3-12/C#14
4-4/C#14
2-3/C#14
1-3/C#20
1-1/C#6 INS. GR.
4" CONDUIT TO HH 12:
7-2/C#14
4-12/C#14
2-3/C#14
3-3/C#20
4-4/C#14
1-COM CABLE
1-COAXIAL CABLE
1-1/C#6 INS. GR.
2-2" AND 1-3" CONDUIT STUBBED OUT (CAPPED BOTH ENDS)
1-1/2" CONDUIT TO SIGNAL SYTEM F:
1-FO PIGTAIL (6-SM)
CONTROLLER CABINET TO SERVICE CABINET:
2" CONDUIT
2-1/C#6
1-1/C#6 INS. GR.
CONTROLLER CABINET TO SERVICE CABINET (COMMS):
2" CONDUIT
1-6PR#19
SERVICE CABINET TO GROUND MOUNTED TRANSFORMER:
2" CONDUIT
3-1/C#2
SERVICE CABINET TO HH 1:
2" CONDUIT
2-3/C#14 (LUM)
1-3/C#14 (CAM POWER)
HH 1 TO HH 12:
2" CONDUIT
1-3/C#14 (LUM)
1-3/C#14 (CAM POWER)

- Ⓑ SOP-GROUND MOUNTED TRANSFORMER (XCEL ENERGY)
2" CONDUIT INTO SERVICE CABINET:
3-1/C#2

1736072

METER ADDRESS:
5727 ST. CROIX TR.
SYSTEM ID: 22114
T.E.: 5661

NO	DATE	BY	CHKD	APPR	REVISION
0	06/20/13	KAS	RJG	JWD	EARLY RELEASE - DP T-2
1	06/27/13	KAS	RJG	JWD	NDC 004 - MA CHANGES DUE TO CSAH 21 TRAIL UPDATE
2	08/08/13	KS	RJG	KAS	INITIAL RELEASE FOR CONSTRUCTION - DP T-2
3	03/22/16	NSM	TJJ	JWD	RECORD PLAN
4	12/7/18	JBA			BY MNDOT: ADDED TAMS SYSTEM ID*, TO OPERATIONS PLAN

DRAWING NO.: SGL91

RECORD DRAWING NOTE
THESE RECORD DRAWINGS WERE DEVELOPED BASED ON THE PREVIOUS DRAWING REVISIONS AND INFORMATION TRANSMITTED FROM THE FIELD BY OTHERS. THE INFORMATION CONTAINED WITHIN THIS RECORD AS-BUILT PLAN REPRESENTS THE ACTUAL CONDITIONS FOR ALL CHANGES OF WHICH ALLIANT IS AWARE. FUTURE USERS OF THESE DRAWINGS SHOULD VERIFY AS-BUILT CONDITIONS IN THE FIELD IN ALL CIRCUMSTANCES.

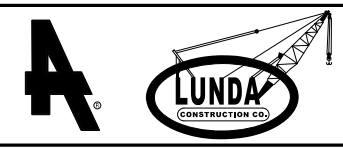

ST. CROIX MN APPROACHES (S.P. 8214-114) SHEET 600
SIGNAL SYSTEM E OF
MATCHLINE LAYOUT AND POLE NOTES
T.H. 95 AT C.S.A.H. 21 (PICKETT AVE)/KING PLANT DR 628

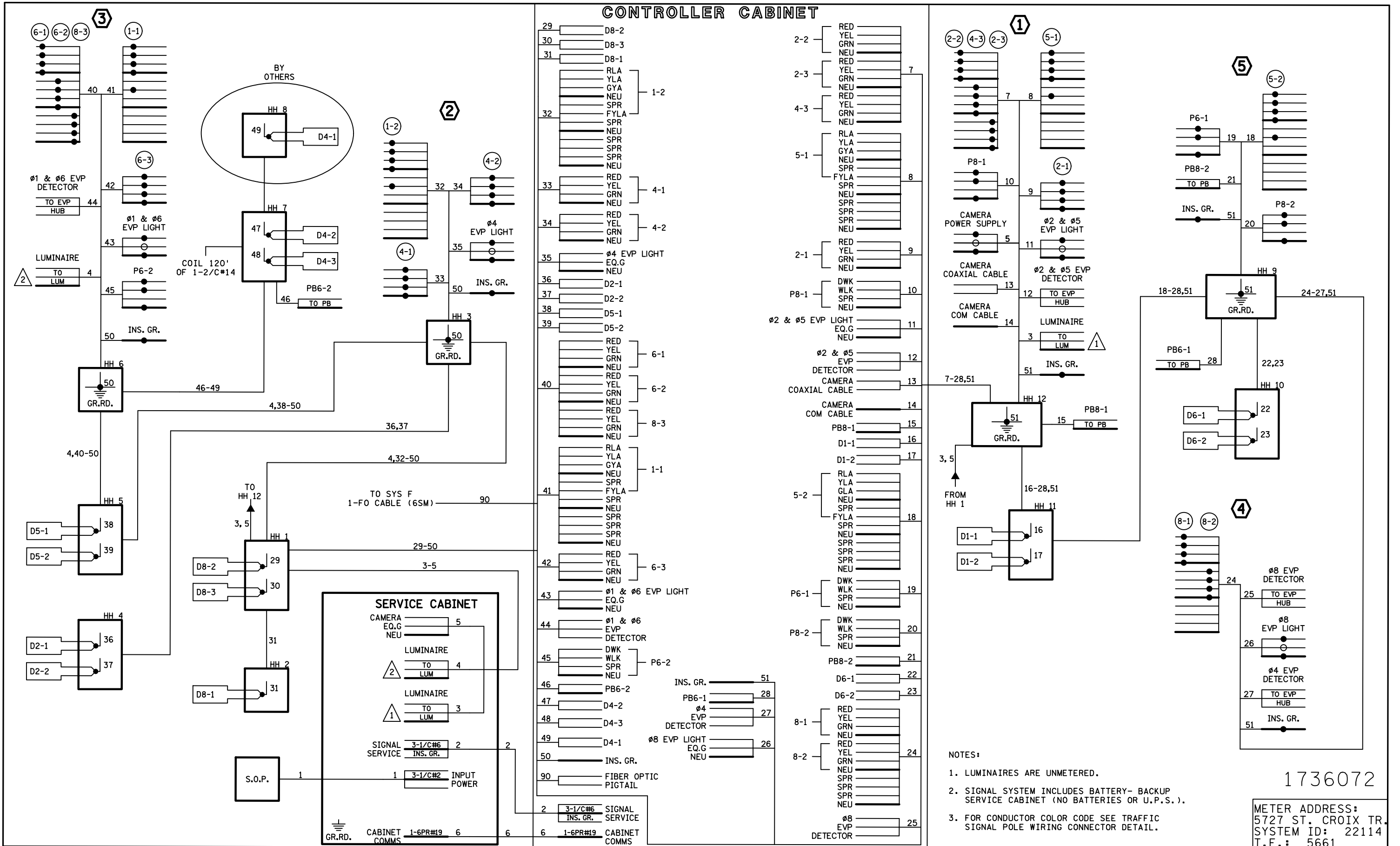

- NOTES:
- LUMINAIRES ARE UNMETERED.
 - SIGNAL SYSTEM INCLUDES BATTERY- BACKUP SERVICE CABINET (NO BATTERIES OR U.P.S.).
 - FOR CONDUCTOR COLOR CODE SEE TRAFFIC SIGNAL POLE WIRING CONNECTOR DETAIL.

1736072

METER ADDRESS:
5727 ST. CROIX TR.
SYSTEM ID: 22114
T.E.: 5661

NO	DATE	BY	CKD	APPR	REVISION
0	08/08/13	KS	RJG	KAS	INITIAL RELEASE FOR CONSTRUCTION - DP T-2
1	03/22/16	NSM	TJJ	JWD	RECORD PLAN
2	12/7/18	JBA			BY MNDOT: ADDED TAMS SYSTEM ID*, TO OPERATIONS PLAN
NO					

DRAWING NO.: SGL92

RECORD DRAWING NOTE

THESE RECORD DRAWINGS WERE DEVELOPED BASED ON THE PREVIOUS DRAWING REVISIONS AND INFORMATION TRANSMITTED FROM THE FIELD BY OTHERS. THE INFORMATION CONTAINED WITHIN THIS RECORD AS-BUILT PLAN REPRESENTS THE ACTUAL CONDITIONS FOR ALL CHANGES OF WHICH ALLIANT IS AWARE. FUTURE USERS OF THESE DRAWINGS SHOULD VERIFY AS-BUILT CONDITIONS IN THE FIELD IN ALL CIRCUMSTANCES.

