

PLOTTED/REVISED: 8/22/2014

DISTRICT #: METRO
 IPLOT NAME: layout
 PATH & FILENAME: IP_PWP-d\371698\T.kenrick-sgl.dgn

LOOP DETECTOR CHART		
NUMBER	SIZE (FT)	LOCATION
D2-1, D2-2	6X6	400'
D3-1	6X6	15' & 45'
D3-2	6X6	0' & 30'
D4-1	6X6	0' & 15'
D5-1, D5-2	6X6	10' & 40'
D6-1, D6-2, D6-3	6X6	400'
D7-1	6X6	40'
D7-2	6X6	10'
D8-1	6X6	180'
D8-2	6X6	150'
D8-3, D8-4	6X6	0' & 15'

-ALL LOOP DETECTORS ARE PVC
 -LOCATION: DISTANCE FROM CROSSWALK/STOP BAR IN FEET

SIGNAL HEAD PHASING					
HEADS 8-2 & 8-3					
HEADS	R	Y	G	Y	G
2-1, 2-2, 2-3	○	○	○		
4-1, 4-2, 4-3	○	○	○		
5-1, 5-2	◀	◀	◀		
6-1, 6-2, 6-3, 6-4	○	○	○		
7-1, 7-2	◀	◀	◀		
8-1	○	○	○		
8-2, 8-3	○	○	○	◀	◀

-ALL SIGNAL INDICATIONS ARE 12" LED
 -ALL SIGNAL FACES HAVE A BACKGROUND SHIELD
 -ALL SIGNAL HEADS ARE BLACK POLYCARBONITE

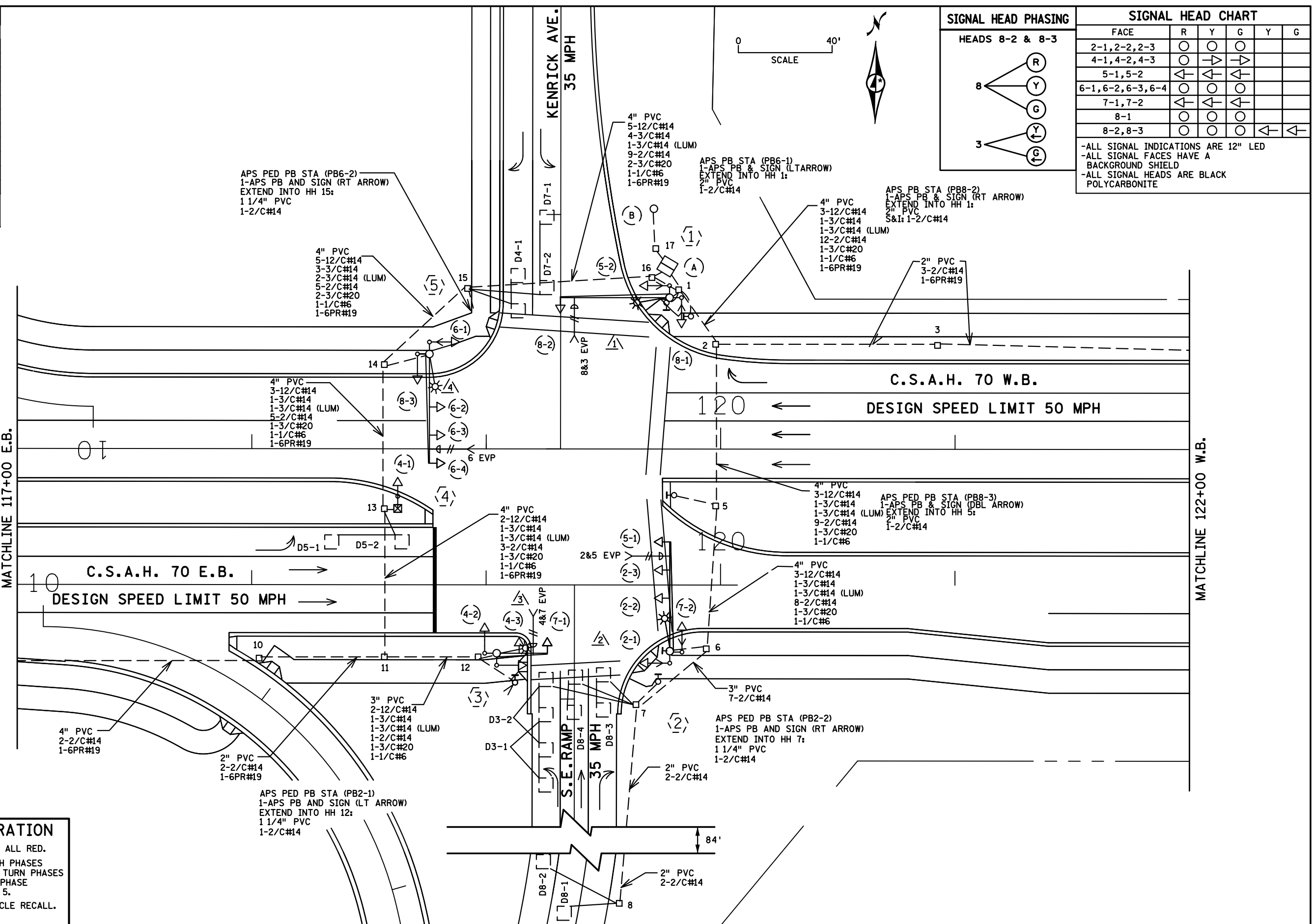

SIGNAL SYSTEM OPERATION

- THE SIGNAL SYSTEM FLASH MODE IS ALL RED.
- NORMAL OPERATION IS 7 PHASE, WITH PHASES 5 AND 7 BEING A PROTECTED LEFT TURN PHASES 3 BEING A PROTECTED/PERMISSIVE PHASE 4 BEING RIGHT TURN OVERLAP 4 & 5.
- PHASES 2 AND 6 SHALL BE ON VEHICLE RECALL.

BY: EJA	DATE: 08-22-14	REVISIONS: AS-BUILT OF SP 7080-51 APS CHANGES	SYSTEM ID: 38708	T.E. 5829	INTERSECTION LAYOUT TH 35 @ CSAH 70/KENRICK AVE E RAMP IN LAKEVILLE, DAKOTA COUNTY	S.A.P. NO.	Michael P. Galinsky LICENSED PROFESSIONAL ENGINEER	DRAWN BY: DMC	CKD BY: EJA	DATE: 04/03/13
			METER ADDRESS: 210TH ST. W. AT KENRICK	MASTER ID: 38710 KENSINGTON T.E.	STATE PROJ. NO. (T.H.35)		SHEET NO. 1 OF 3 SHEETS		CERTIFIED BY: [Signature] LIC. NO. 19863 DATE: 03-21-13	

PLOTTED/REVISED: 8/22/2014

DISTRICT #: METRO
IPLOT NAME: matchline pole notes
PATH & FILENAME: IP_PWP-d1371698TKenrick-sg.dgn

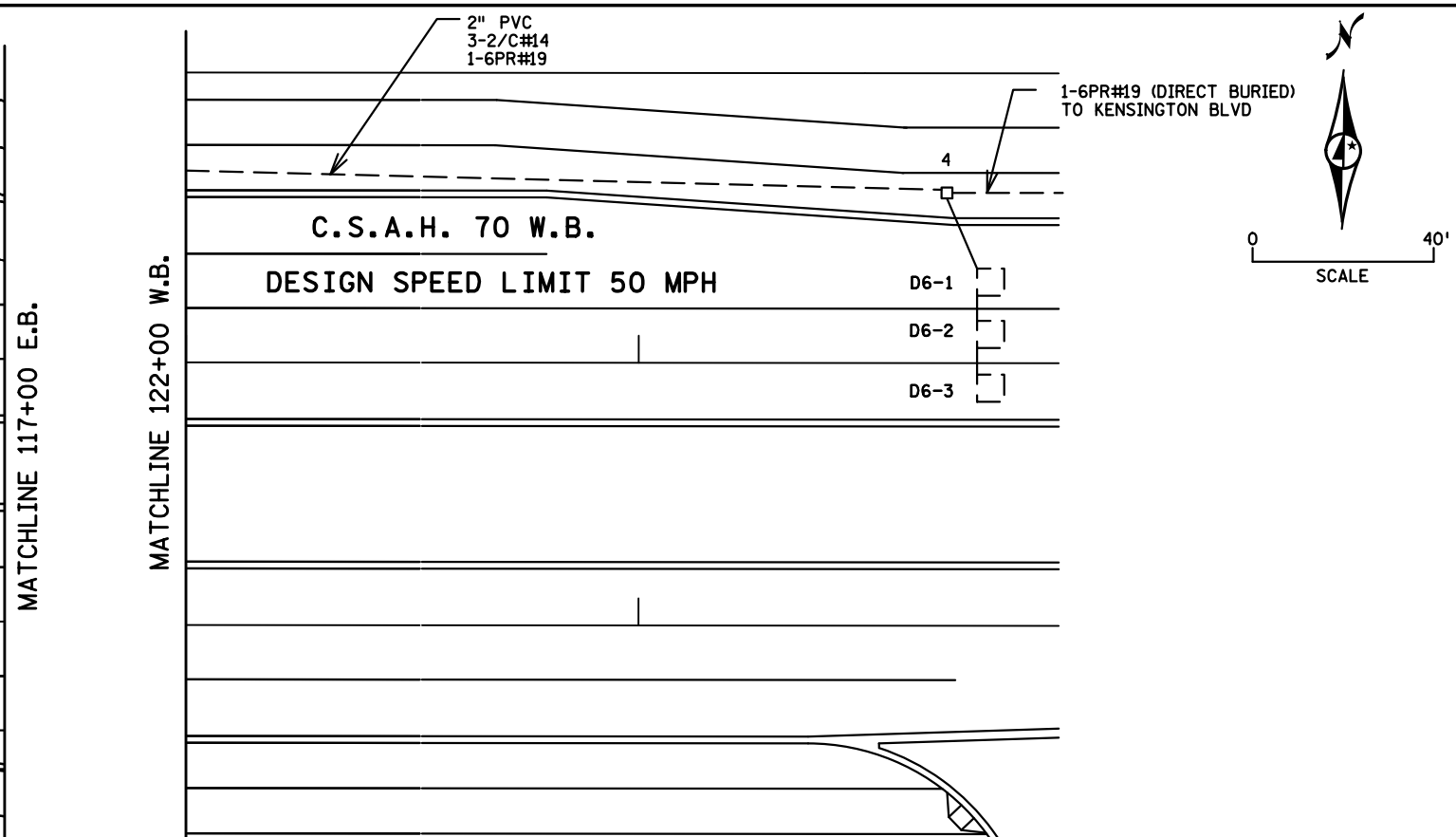
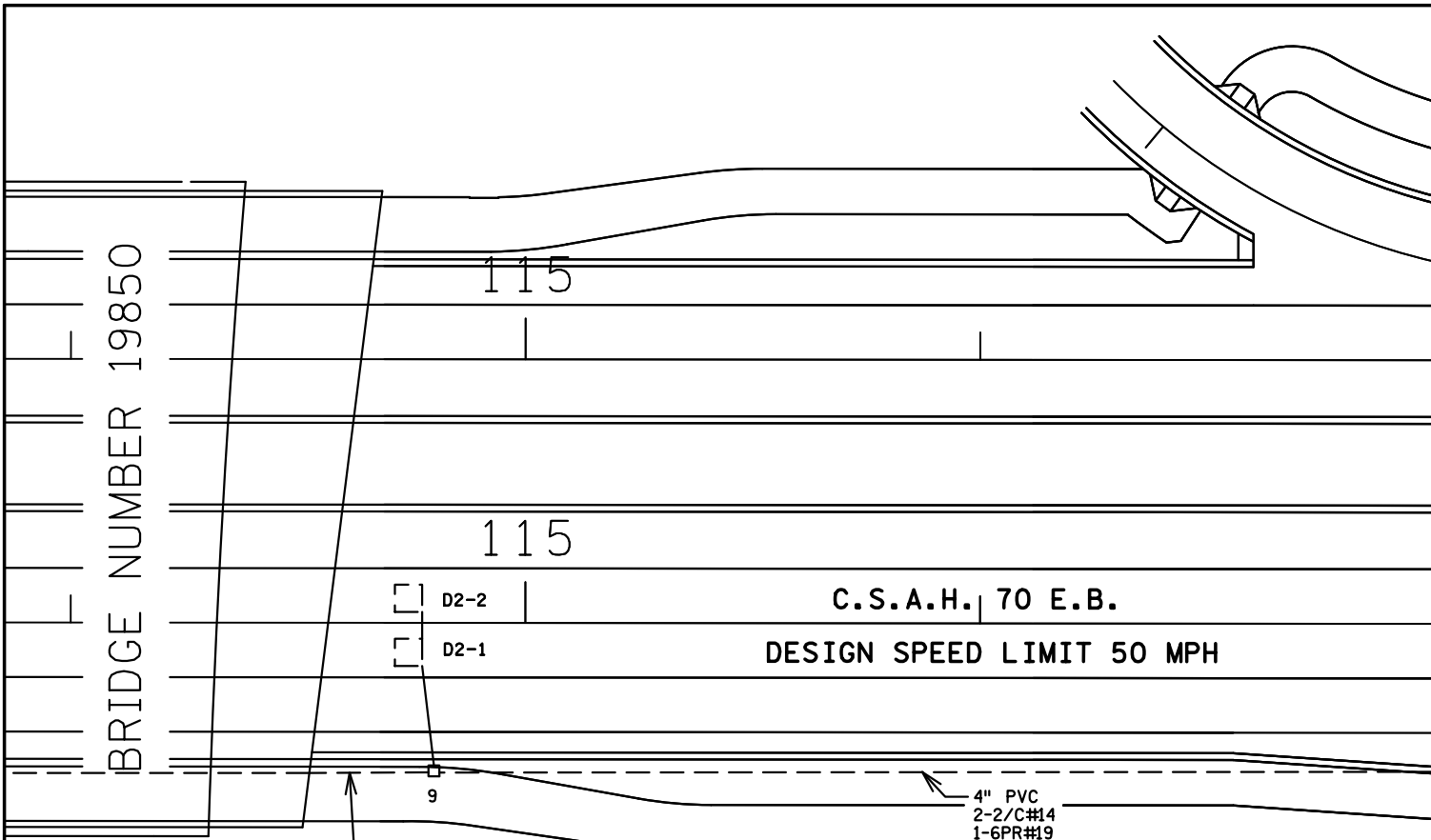

- (4) E.B. STA. 118+62, 33' LT
PEDESTAL FOUNDATION
(W/1" PVC STUB OUT & 5/8" 15' GR. ROD)
13' PEDESTAL PLUS BASE
1-ONE WAY SIGNAL
2-R9-3 SIGNS (FACING POLES 3 AND 5)
EXTEND INTO HH 13:
3" PVC
1-12/C#14
2-1/C#6

- (A) W.B. STA. 119+77, 78' RT.
EQUIPMENT PAD
SERVICE CABINET
CONTROLLER AND CABINET
4" PVC TO HH 16: 4" PVC TO HH 1:
5-12/C#14 5-12/C#14
3-3/C#14 2-3/C#14
9-2/C#14 14-2/C#14
2-3/C#20 2-3/C#20
1-1/C#6 1-1/C#6
1-6PR#19 1-6PR#19

- (1) W.B. STA. 119+78, 64' RT
PA100 POLE FOUNDATION
(W/1" PVC STUB OUT & 5/8" 15' GR. ROD)
TYPE PA100-A-45-D40-9 (DAVIT AT 350 DEG)
LUMINAIRE 250 WATT HPS
TYPE D SIGN
1-R10-12 SIGN ADJACENT TO HEAD 8-2
1-ONE WAY SIGNAL OVERHEAD AT 0'
ONE WAY EVP DETECTOR AND CONFIRMATORY LIGHT (8+3)
2-ONE WAY SIGNALS AT 45 AND 225 DEG
2-ONE WAY CD PED HEADS AT 45 AND 225 DEG
EXTEND INTO HH 1:
3" PVC
2-12/C#14
1-3/C#14
1-3/C#14 (LUM)
1-3/C#20
2-1/C#6

- (3) E.B. STA. 119+05, 29' RT
PA85 POLE FOUNDATION
(W/1" PVC STUB OUT & 5/8" 15' GR. ROD)
TYPE PA85-A-20-D40-9 (DAVIT AT 350 DEG)
LUMINAIRE 250 WATT HPS
TYPE D SIGN
2-ONE WAY SIGNAL OVERHEAD AT 0' AND 11'
ONE WAY EVP DETECTOR AND CONFIRMATORY LIGHT (4+7)
ONE WAY SIGNAL AT 225 DEG
ONE WAY CD PED HEAD AT 45 DEG
R9-3 SIGN (FACING POLE 4)
EXTEND INTO HH 12:
3" PVC
2-12/C#14
1-3/C#14
1-3/C#14 (LUM)
1-3/C#20
1-1/C#6

- (5) W.B. STA. 118+76, 40' RT
PA100 POLE FOUNDATION
(W/1" PVC STUB OUT & 5/8" 15' GR. ROD)
TYPE PA100-A-45-D40-9 (DAVIT AT 350 DEG)
LUMINAIRE 250 WATT HPS
TYPE D SIGN
3-ONE WAY SIGNAL OVERHEAD AT 0', 11' AND 23'
ONE WAY EVP DETECTOR AND CONFIRMATORY LIGHT
2-ONE WAY SIGNALS AT 45 AND 225 DEG
ONE WAY CD PED HEAD AT 225 DEG
1-R9-3 (FACING POLE 4)
EXTEND INTO HH 14:
3" PVC
2-12/C#14
2-3/C#14
1-3/C#14 (LUM)
1-3/C#20
2-1/C#6

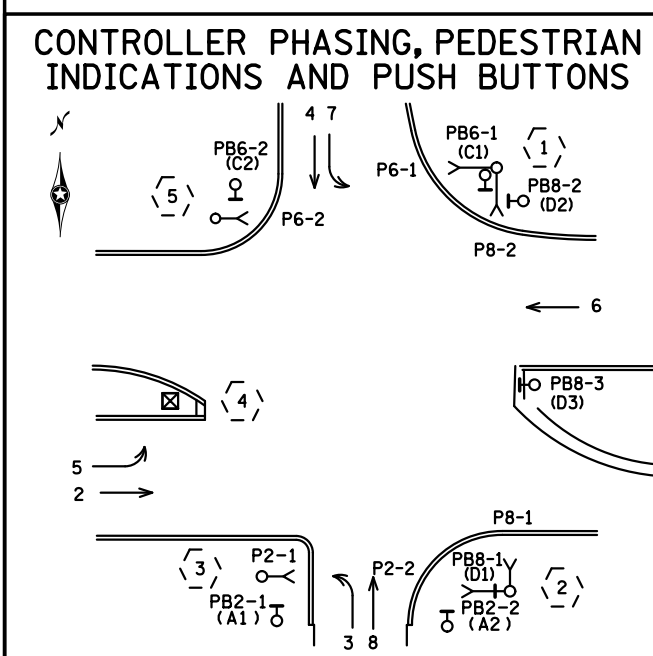

- 2" AND 3" PVC STUBBED OUT (CAPPED BOTH ENDS)
SERVICE CABINET TO CONTROLLER CABINET:
2" PVC
2-1/C#6
1-1/C#6 (INS.GR.)
SERVICE CABINET TO HH 17:
2" PVC
3-1/C#2
SERVICE CABINET TO HH 16:
2" PVC
4-3/C#14 (LUM)
HH 16 TO HH 1:
2" PVC
2-3/C#14 (LUM)

- (B) WOOD POLE AND TRANSFORMER
(BY DAKOTA ELECTRIC)
2" PVC RISER AND WEATHERHEAD
AND PVC TO HH 17:
3- 1/C #2

PEDESTRIAN PUSH BUTTONS SHALL BE LOCATED AS SHOWN ABOVE

BY	DATE	REVISIONS
EJA	8-22-14	AS-BUILT OF SP 7080-51 APS CHANGES

SYSTEM ID: 38708 T.E. 5829
 METER ADDRESS: 210TH ST. W. AT KENRICK
 MASTER ID: 38710 (KENSINGTON) T.E.

MATCHLINES AND POLE NOTES
 TH 35 @ CSAH 70/KENRICK AVE E RAMP
 IN LAKEVILLE, DAKOTA COUNTY

S.A.P. NO.	DRAWN BY: DMC	CKD BY: EJA	DATE: 02/19/13
CERTIFIED BY: <i>Michael P. Lubinsky</i>	LIC. NO. 19863	DATE: 04-03-13	
STATE PROJ. NO. (T.H.35)	SHEET NO. 2 OF 3 SHEETS		

PLOTTED/REVISED: 8/22/2014

DISTRICT #: METRO
IPLOT NAME: wiring diagram
PATH & FILENAME: IP_PWP-d1371698Tkenrick.sgl.dgn

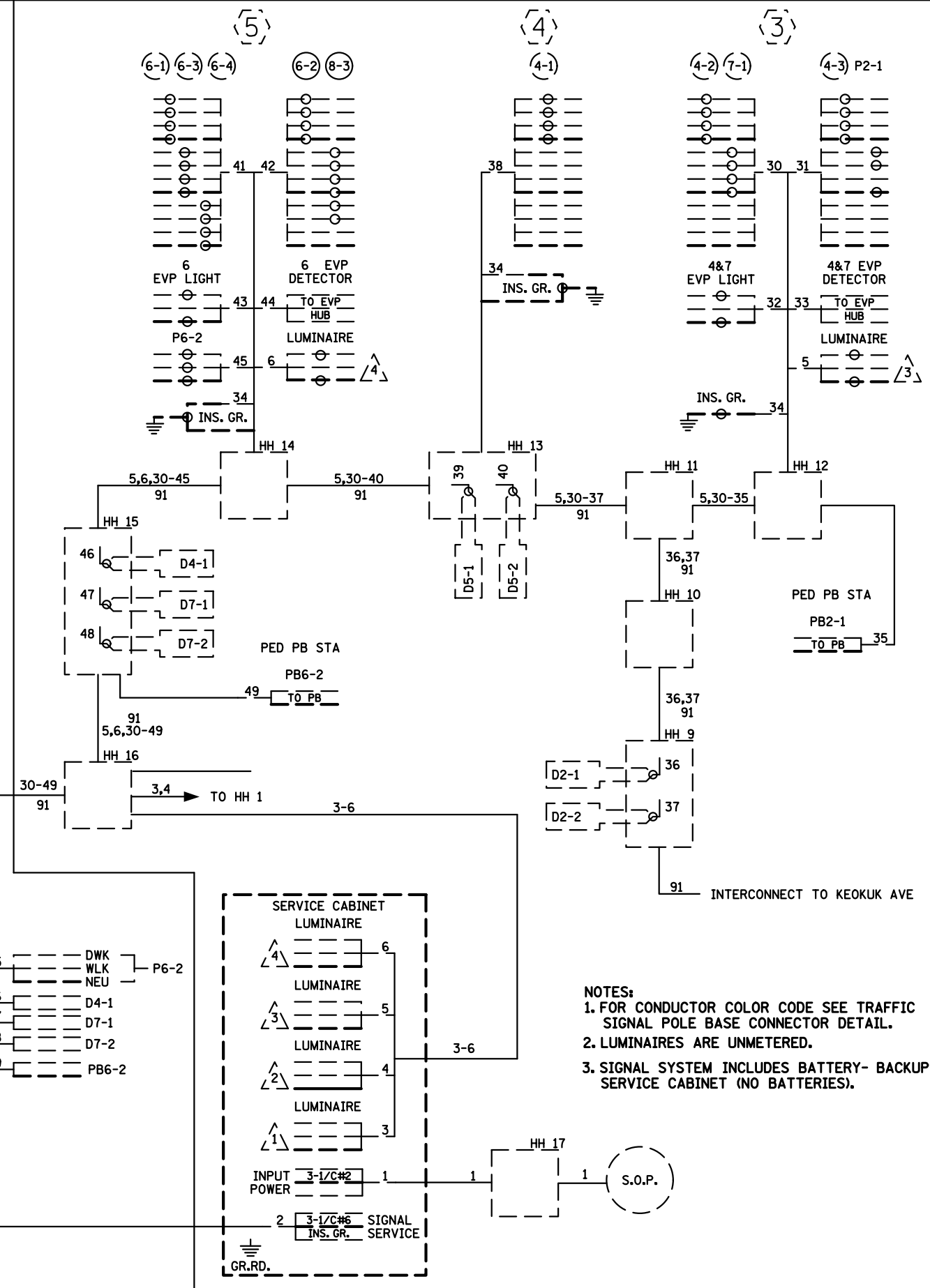
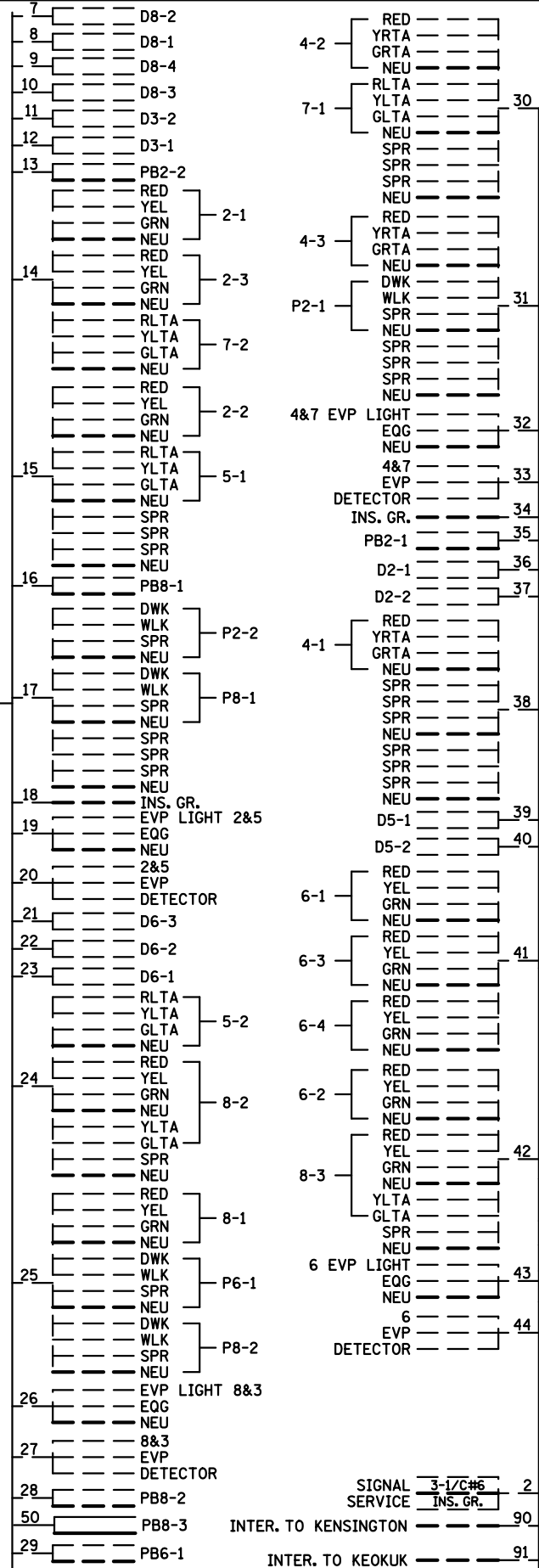
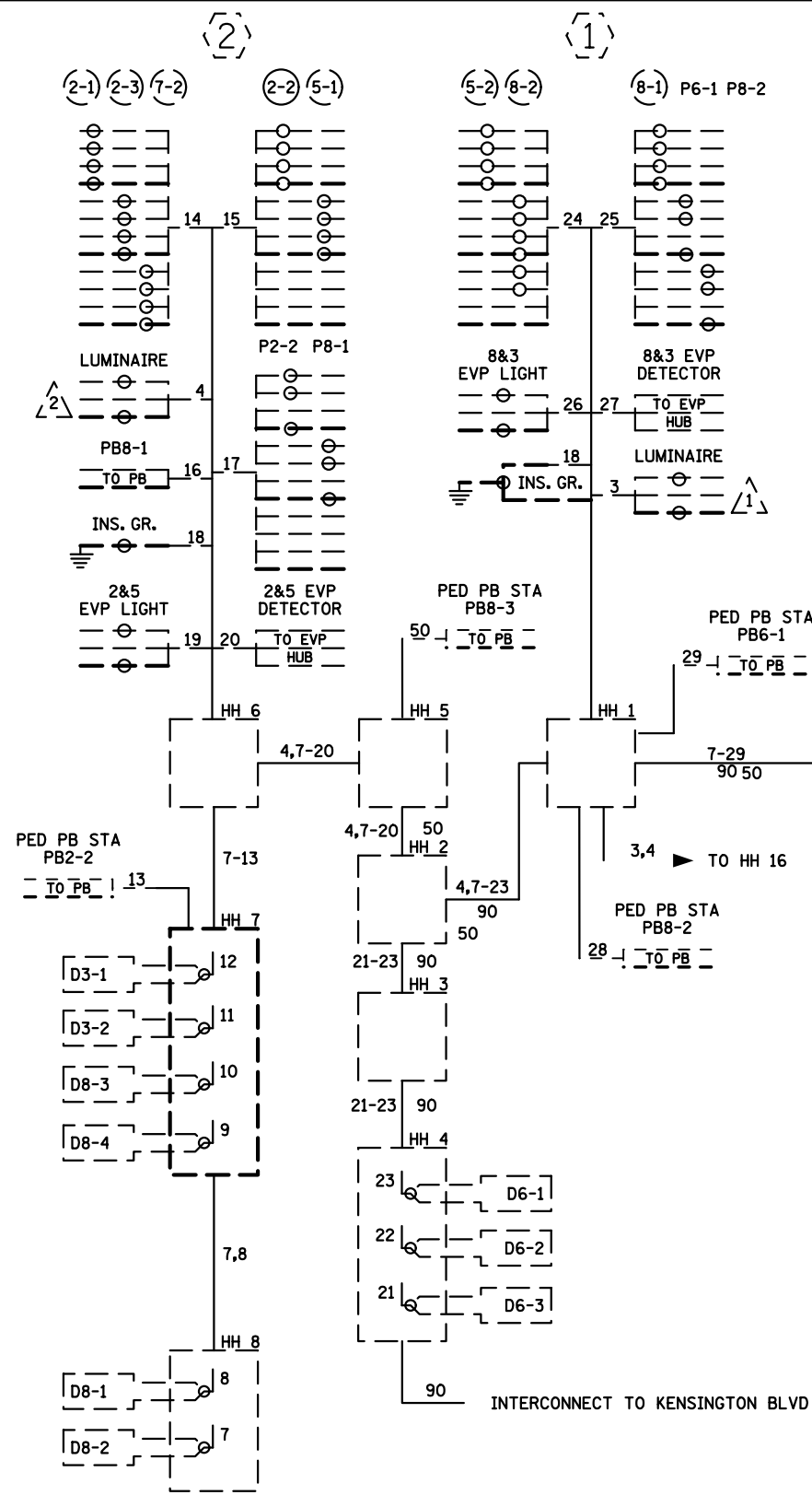

NOTES:
 1. FOR CONDUCTOR COLOR CODE SEE TRAFFIC SIGNAL POLE BASE CONNECTOR DETAIL.
 2. LUMINAIRES ARE UNMETERED.
 3. SIGNAL SYSTEM INCLUDES BATTERY- BACKUP SERVICE CABINET (NO BATTERIES).

BY	DATE	REVISIONS
EJA	8-22-14	AS-BUILT OF SP 7080-51 APS CHANGES

SYSTEM ID: 38708 T.E. 5829
 METER ADDRESS: 210TH ST. W. AT KENRICK
 MASTER ID: 38710 KENSINGTON T.E.

WIRING DIAGRAM
TH 35 @ CSAH 70/KENRICK AVE E RAMP
IN LAKEVILLE, DAKOTA COUNTY

S.A.P. NO. _____ DRAWN BY: DMC CKD BY: EJA DATE: 04/03/13
 CERTIFIED BY: *Michael P. Lubinsky* LIC. NO. 19863 DATE: 03-21-13
 STATE PROJ. NO. (T.H.35) SHEET NO. 3 OF 3 SHEETS