

0' 30' 100'

SCALE

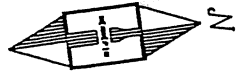

CITY OF BLOOMINGTON

HH-6 TO MA-2/MA-3
3" RSC
4-12/C #12
3- 3/C #12
2- 3/C #20 (SHLD)

HH-6 TO HH-7
3" RSC
4-12/C #12
3- 3/C #12
2- 3/C #20 (SHLD)

HH-7 TO SA-2
3" RSC
1-12/C #12
1- 2/C #12 (SHLD)

HH-7 TO HH-8
2" RSC
2- 2/C #12 (SHLD)

HH-7 TO HH-9
4" RSC
5-12/C #12
3- 3/C #12
3- 2/C #12 (SHLD)
2- 3/C #20 (SHLD)

HH-9 TO SA-3
3" RSC
1-12/C #12
1- 2/C #12 (SHLD)

HH-9 TO HH-10
4" RSC
6-12/C #12
3- 3/C #12
4- 2/C #12 (SHLD)
2- 3/C #20 (SHLD)

HH-10 TO HH-CA
TO HH-CB
2" RSC *
1-25PR #19 *

HH-1 TO HH-10
2" RSC
1-3/C #12

SOP-1 TO HH-11 TO SP-1
2" RSC
3-1/C #3

HH-CB TO HH-CC
3" RSC *
1-25PR #19 *

HH-CC TO HH-DA
2" RSC *
2-2/C #12 (SHLD) *
1-25PR #19 *

SA-1 TO HH-4
3" RSC
1-12/C #12
1- 2/C #12 (SHLD)

HH-1 TO HH-2
3" RSC
1-12/C #12
7- 2/C #12 (SHLD)
1- 25PR #19 *

SP-1 TO CAC-1
2" RSC
3-1/C #3

HH-4 TO HH-5
3" RSC - INPLACE
2- 2/C #12 (SHLD)
1- 25PR #19 *

HH-2 TO HH-3
2" RSC
2- 2/C #12 (SHLD)

HH-1 TO MA-1
3" RSC
2-12/C #12
2- 3/C #12
2- 2/C #12 (SHLD)
1- 3/C #20 (SHLD)

HH-2 TO HH-4
3" RSC
1-12/C #12
3- 2/C #12 (SHLD)
1- 25PR #19 *

HH-5 TO HH-BB
3" RSC - INPLACE
1- 25PR #19 *

CONTROLLER PHASING LAYOUT
(NO SCALE)

EAST BUSH LAKE ROAD
C.S.A.H. 28

EAST BUSH LAKE ROAD
C.S.A.H. 28

SIGNAL SYSTEM OPERATION

- SIGNAL SYSTEM FLASH MODE IS ALL RED.
- PHASES 2 AND 6 ARE ON VEHICLE RECALL.
- NORMAL OPERATION IS 3 PHASES.

- NOTES:
- 1) SEE DIVISIONS "SS" OF SPECIAL PROVISIONS FOR MATERIALS PROVIDED BY HENNEPIN COUNTY.
 - 2) SEE SPECIAL PROVISIONS FOR EMERGENCY VEHICLE PREEMPTION (EVP) SYSTEM REQUIREMENTS.
 - 3) SEE SHEET 851 OF 876 FOR SIGNAL SYSTEM TABULATIONS.
 - 4) COMMON BACKFILL AT SIGNAL STRUCTURES AS DIRECTED BY THE ENGINEER SHALL BE INCIDENTAL TO THE SIGNAL SYSTEM.
 - 5) RESTORATION AND CLEAN-UP WORK AS DIRECTED BY THE ENGINEER SHALL BE INCIDENTAL TO THE SIGNAL SYSTEM.
 - 6) ONE PEDESTRIAN PUSH BUTTONS SHALL BE INSTALLED ON SA-1, SA-2 AND SA-3 AND TWO PUSH BUTTONS ON MA-1 FOR OPERATION AS SHOWN IN THE PHASING LAYOUT.
 - 7) SEE BRIDGE PLANS FOR DETAILS ON CONDUIT PLACEMENT ON BRIDGE.
 - 8) ONE 250 WATT HIGH PRESSURE SODIUM VAPOR LUMINAIRE WITH PHOTO ELECTRIC CELL RECEPTABLE SHALL BE INSTALLED ON EACH MAST ARM LUMINAIRE SHAFT EXTENSION.
 - 9) THE SIGNAL SYSTEM SHALL NOT INCLUDE THE SIGNAL INTERCONNECT AND LOOP DETECTOR (DX-1, DX-2) QUANTITIES.
 - 10) SEE BRIDGE PLANS FOR DETAILS ON SA-1, HH-4, HH-5, D1-2 AND D1-2 INSTALLATION.
 - 11) * ITEMS INCLUDED IN TRAFFIC CONTROL INTERCONNECTION PAY ITEM.
 - 12) EXTEND EXISTING 3" RSC CAPPED FROM BRIDGE INTO HH-2.

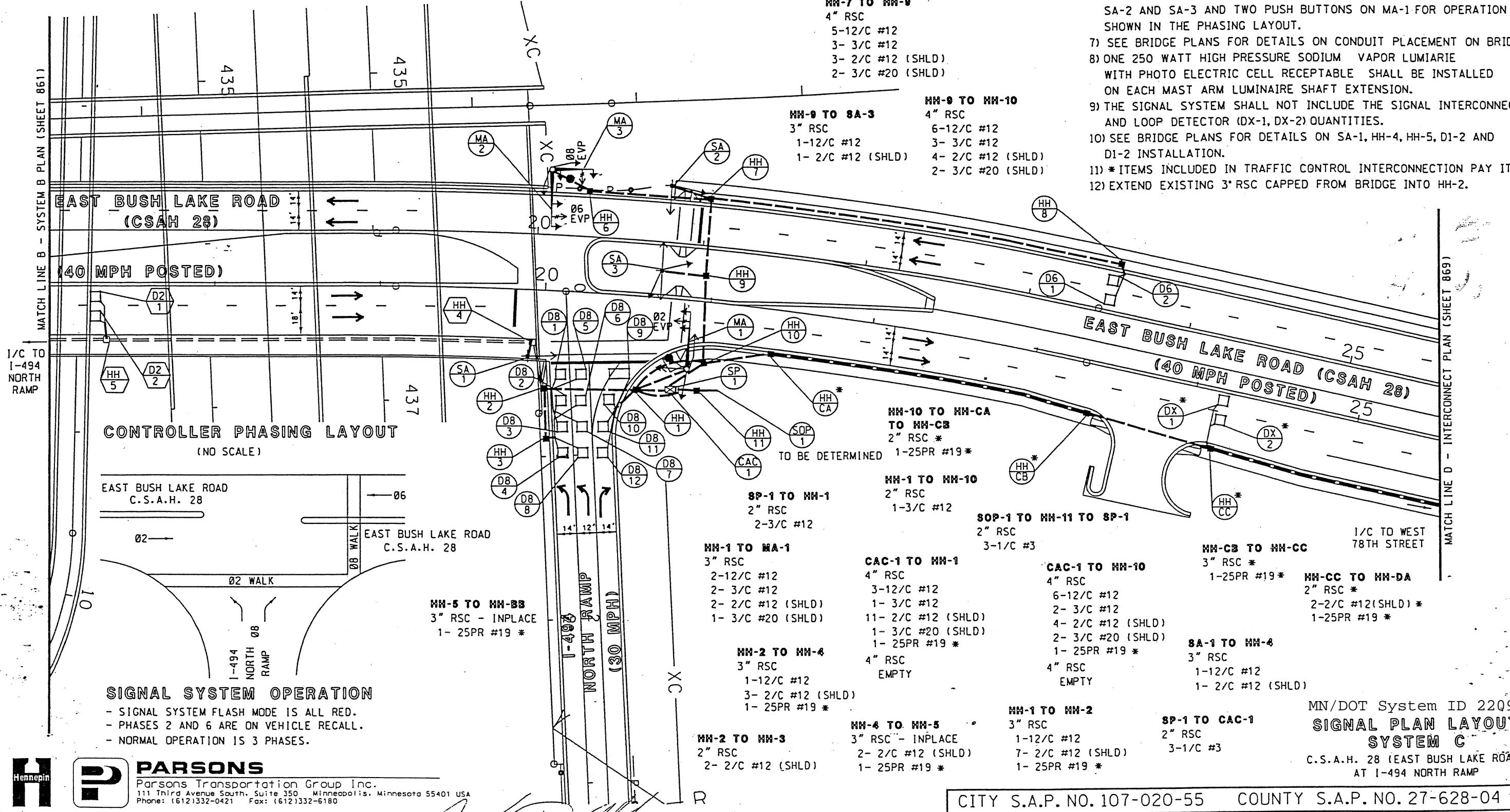

PURCHASING TRANSPORTATION 17
 DRAWING NAME: 12-437-02
 DATE: 12/03/02
 LINE: 05/26/04 PN

PARSONS
Parsons Transportation Group Inc.
111 Third Avenue South, Suite 350 Minneapolis, Minnesota 55401 USA
Phone: (612)332-0421 Fax: (612)332-6180

I.D. NO. 9027800

MN/DOT System ID 22091
SIGNAL PLAN LAYOUT
SYSTEM C
C.S.A.H. 28 (EAST BUSH LAKE ROAD)
AT I-494 NORTH RAMP