

PLOT NAME: system B layout
 PATH & FILENAME: Projects\DM_R05\036\0000\Traffic\Signal\2.33_(5)\LEXINGTON AV NR-1735297\Pending\1735297.dgn PLOTTED/REVISED: 13-DEC-2023

| SIGNAL HEAD CHART | | | | |
|-------------------|---|---|-----|---|
| FACE | R | Y | FYA | G |
| 2-1, 2-2 | ● | ● | ● | ● |
| 5-1, 5-2 | ← | ← | ← | ← |
| 6-1, 6-2 | ● | ● | ● | ● |
| 8-1, 8-2, 8-3 | ● | ● | ● | ● |

-ALL SIGNAL INDICATIONS SHALL BE 12" LED
 -ALL SIGNAL HEADS SHALL BE BLACK POLYCARBONITE WITH BACKGROUND SHIELDS
 -FYA DENOTES FLASHING YELLOW ARROW

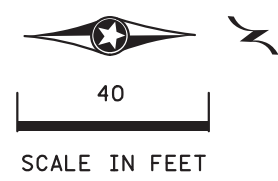

| LOOP DETECTOR CHART | | |
|---------------------|-----------|----------|
| NUMBER | SIZE (FT) | LOCATION |
| D2-1, D6-1 | 6x6 | 180 |
| D5-1 | 2-6x6 | 20 & 50 |
| D5-2 | 2-6x6 | 5 & 35 |
| D8-1, D8-2 | 6x6 | 120 |
| D8-3 | 2-6x6 | 0 & 15 |
| D8-4 | 2-6x6 | 5 & 20 |

-ALL LOOP DETECTORS SHALL BE PVC UNLESS NOTED OTHERWISE
 -LOCATION: DISTANCE FROM CROSSWALK/STOP BAR IN FEET

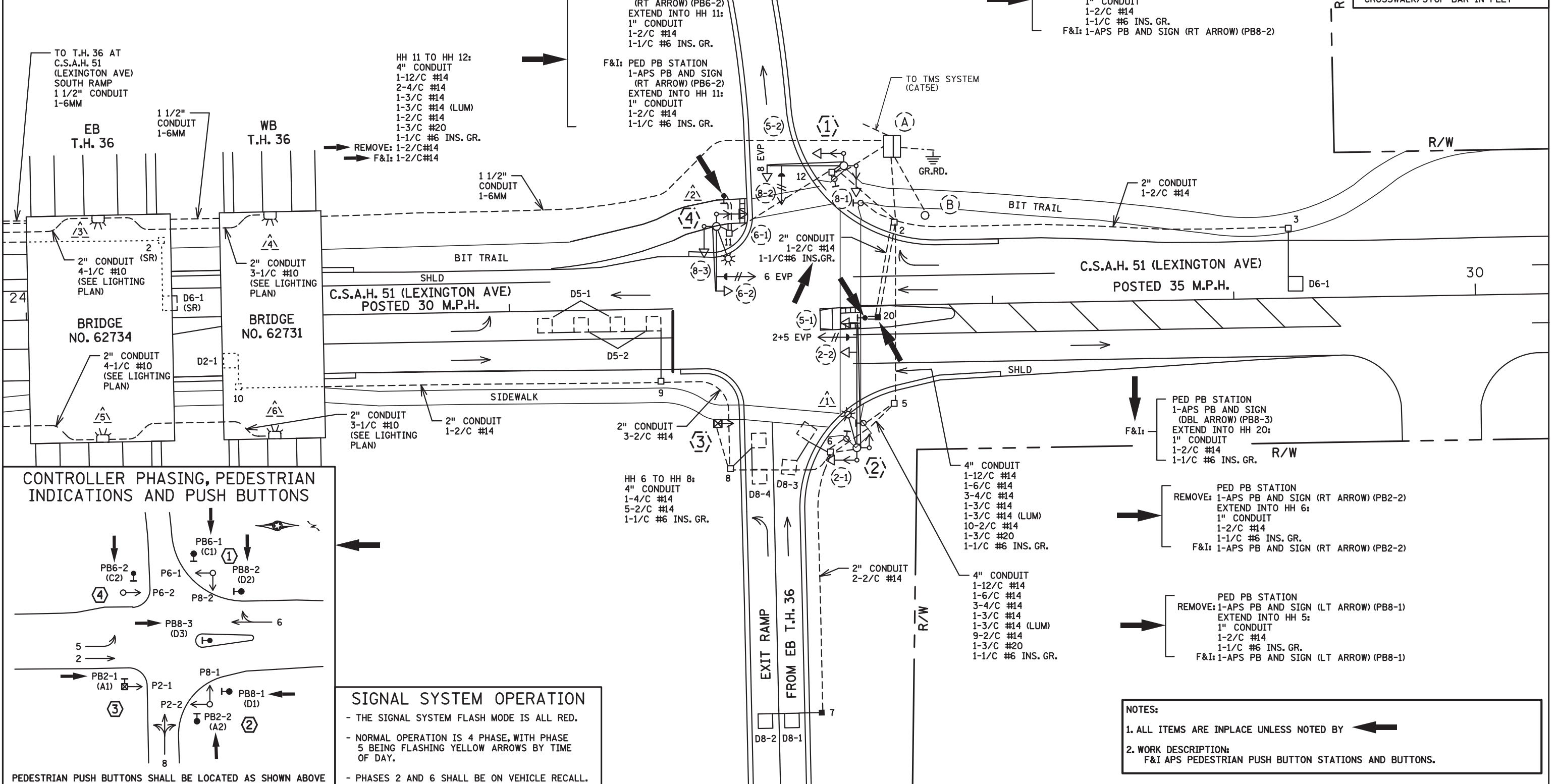

CONTROLLER PHASING, PEDESTRIAN INDICATIONS AND PUSH BUTTONS

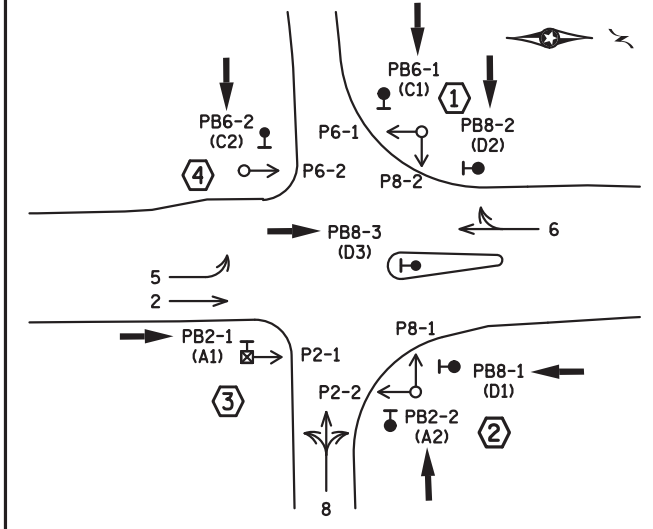

SIGNAL SYSTEM OPERATION

- THE SIGNAL SYSTEM FLASH MODE IS ALL RED.
- NORMAL OPERATION IS 4 PHASE, WITH PHASE 5 BEING FLASHING YELLOW ARROWS BY TIME OF DAY.
- PHASES 2 AND 6 SHALL BE ON VEHICLE RECALL.

| BY | DATE | REVISIONS |
|----|------|-----------|
| | | |

SYSTEM ID: 1735297 T.E. 100201
 METER ADDRESS: 2324 LEXINGTON AVE N
 MASTER ID: T.E.

REVISE SIGNAL SYSTEM B INTERSECTION LAYOUT
 T.H. 36 AT C.S.A.H. 51 (LEXINGTON AVE.)
 NORTH RAMP IN ROSEVILLE, RAMSEY COUNTY

S.A.P. NO. _____
 CERTIFIED BY: *Gregory Kim* LIC. NO. 26829 DATE: 12/13/23
 STATE PROJ. NO. 6212-192 (T.H.36) SHEET NO. SS13 OF SS30 SHEETS

NOTES:
 1. ALL ITEMS ARE INPLACE UNLESS NOTED BY ←
 2. WORK DESCRIPTION:
 F&I APS PEDESTRIAN PUSH BUTTON STATIONS AND BUTTONS.

IPLOT NAME: system B pole notes
 PATH & FILENAME: Projects\DM罗斯03600000\Traffic\Signals\2.33_(5)\LEXINGTON AV NR-1735297\Pending\1735297_spl.dgn PLOTTED/REVISED: 13-DEC-2023

④ PA85 POLE FOUNDATION
 TYPE PA85-A-25-D30-9 (DAVIT AT 350 DEG)
 1-ANGLE MOUNT SIGNAL OVERHEAD AT 0'
 2-ANGLE MOUNT SIGNALS AT 90 AND 180 DEG
 1-ANGLE MOUNT C. D. PED HEAD AT 180 DEG
 1-ONE WAY EVP DETECTOR AND CONFIRMATORY LIGHT (PHASE 6)
 LUMINAIRE-LED
 1-R9-3 SIGN (NO PEDS) FACING POLE 3
 2-TYPE D SIGNS (D-5)(D-6) (SEE SIGN DETAILS)
 3" CONDUIT TO HH 11:
 1-12/C #14
 2-4/C #14
 1-3/C #14
 1-3/C #14 (LUM)
 1-3/C #20
 1-1/C #6 INS. GR.

③ PEDESTAL FOUNDATION
 10' PEDESTAL POLE PLUS BASE
 1-STRAIGHT MOUNT C. D. PED HEAD AT 180 DEG
 REMOVE: 1-APS PB AND SIGN (LT ARROW) (PB2-1)
 F&I: 1-APS PB AND SIGN (LT ARROW) (PB2-1)
 1-R9-3 SIGN (NO PEDS) FACING POLE 4
 3" CONDUIT TO HH 8:
 1-4/C #14
 1-2/C #14
 1-1/C #6 INS. GR.

① PA85 POLE FOUNDATION
 TYPE PA85-A-30
 1-ANGLE MOUNT SIGNAL OVERHEAD AT 0'
 2-ANGLE MOUNT SIGNALS AT 90 AND 180 DEG
 2-ANGLE MOUNT C. D. PED HEADS AT 90 AND 180 DEG
 1-ONE WAY EVP DETECTOR AND CONFIRMATORY LIGHT (PHASE 8)
 2-R6-1(R AND L) SIGNS (ONE WAY)
 1-TYPE D SIGN (D-4) (SEE SIGN DETAILS)
 3" CONDUIT TO HH 12:
 1-12/C #14
 1-6/C #14
 2-4/C #14
 1-3/C #14
 1-3/C #20
 1-1/C #6 INS. GR.

② PA100 POLE FOUNDATION
 TYPE PA100-A-50-D30-9 (DAVIT AT 350 DEG)
 1-ANGLE MOUNT SIGNAL OVERHEAD AT 0'
 1-STRAIGHT MOUNT SIGNAL OVERHEAD AT 11'
 1-ANGLE MOUNT SIGNAL AT 180 DEG
 2-ANGLE MOUNT C. D. PED HEADS AT 90 AND 180 DEG
 1-ONE WAY EVP DETECTOR AND CONFIRMATORY LIGHT (PHASES 2+5)
 LUMINAIRE-LED
 1-R10-X12 SIGN ADJACENT TO HEAD (5-1)
 1-TYPE D SIGN (D-7) (SEE SIGN DETAILS)
 3" CONDUIT TO HH 6:
 1-12/C #14
 1-6/C #14
 2-4/C #14
 1-3/C #14
 1-3/C #14 (LUM)
 1-3/C #20
 1-1/C #6 INS. GR.

⑤ SOP-WOOD POLE
 (BY XCEL ENERGY)
 2" CONDUIT RISER, WEATHERHEAD
 WITH:
 3-1/C #2

(A) EQUIPMENT PAD (SEE DETAIL SHEET)
 SERVICE CABINET (SSB)
 F&I: APS CCU UNIT
 CONTROLLER AND CABINET
 4" CONDUIT TO HH 2:
 1-12/C #14
 1-6/C #14
 3-4/C #14
 1-3/C #14
 12-2/C #14
 1-3/C #20
 1-1/C #6 INS. GR.
 F&I: 1-2/C#14
 REMOVE: 1-2/C#14
 F&I: 1-2/C#14
 4" CONDUIT TO HH 12:
 2-12/C #14
 1-6/C #14
 4-4/C #14
 2-3/C #14
 2-2/C #14
 2-3/C #20
 1-1/C #6 INS. GR.

GROUND WIRE AND GROUND ROD - MIN 8' OUT FROM PAD
 1-2" AND 1-3" CONDUIT STUBBED OUT (CAPPED BOTH ENDS)
 3/4" CONDUIT STUBBED OUT (FOR TELEPHONE LINE)
 CAT5E TO TMS SYSTEM
 CONTROLLER CABINET TO SOUTH RAMP:
 1-1/2" CONDUIT
 1-6-MM FO PIGTAIL WITH FIELD TERMINATED END
 CONTROLLER CABINET TO SERVICE CABINET:
 2" CONDUIT
 2-1/C #6
 1-1/C #6 INS. GR.
 CONTROLLER CABINET TO SERVICE CABINET (COMMS):
 2" CONDUIT (FOR FUTURE USE)
 1-6PR #19
 SERVICE CABINET
 1-2" CONDUIT STUBBED OUT (CAPPED BOTH ENDS)
 SERVICE CABINET TO SOP VIA HH 1:
 2" CONDUIT
 3-1/C #2
 SERVICE CABINET TO HH 12:
 2" CONDUIT
 2-3/C #14 (LUM)
 SERVICE CABINET TO EXTERNAL GR. RD.:
 1" CONDUIT
 1-1/C #6 INS. GR.
 (SEE EQUIPMENT PAD LAYOUT)
 HH 12 TO HH 2:
 2" CONDUIT
 1-3/C #14 (LUM)

NOTES:
 1. ALL ITEMS ARE INPLACE UNLESS NOTED BY ←
 2. WORK DESCRIPTION:
 F&I APS PEDESTRIAN PUSH BUTTON STATIONS AND BUTTONS.

| | | | | | | | | |
|----|------|-----------|-------------------------------------|---|---|----------------|----------------|----------------|
| BY | DATE | REVISIONS | SYSTEM ID: 1735297 T.E. 100201 | REVISE SIGNAL SYSTEM B INTERSECTION NOTES T.H. 36 AT C.S.A.H. 51 (LEXINGTON AVE.) NORTH RAMP IN ROSEVILLE, RAMSEY COUNTY | S.A.P. NO. | DRAWN BY: SJK | CKD BY: GAK | DATE: 12/13/23 |
| | | | METER ADDRESS: 2324 LEXINGTON AVE N | | CERTIFIED BY: <i>Gregory Kim</i> | LIC. NO. 26829 | DATE: 12/13/23 | |
| | | | MASTER ID: T.E. | | STATE PROJ. NO. 6212-192 (T.H.36) SHEET NO. SS14 OF SS30 SHEETS | | | |

IPLOT NAME: system B wiring
 PATH & FILENAME: Projects\DM罗斯03600000\Traffic\Signal\2.33_(5)\LEXINGTON AV NR-1735297_Pending\1735297_spl.dgn PLOTTED/REVISED: 13-DEC-2023

CONTROLLER CABINET

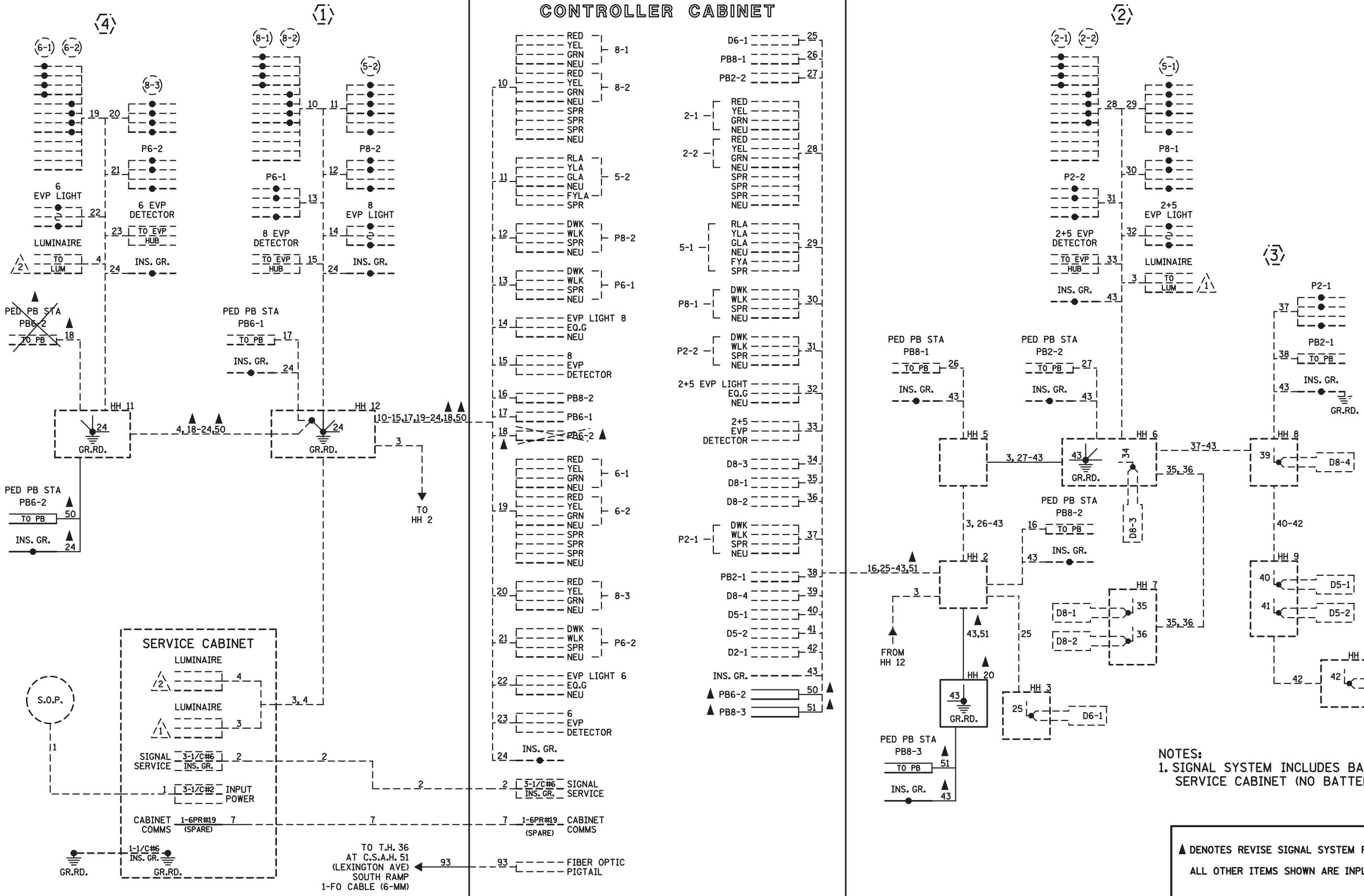

NOTES:
 1. SIGNAL SYSTEM INCLUDES BATTERY-BACKUP SERVICE CABINET (NO BATTERIES).

▲ DENOTES REVISE SIGNAL SYSTEM PAY ITEM WORK.
 ALL OTHER ITEMS SHOWN ARE INPLACE.

| BY | DATE | REVISIONS | SYSTEM ID: 1735297 T.E. 100201 | REVISE SIGNAL SYSTEM B | S.A.P. NO. |
|----|------|-----------|-------------------------------------|---|---|
| | | | METER ADDRESS: 2324 LEXINGTON AVE N | FIELD WIRING DIAGRAM | CERTIFIED BY <i>Gregory Kim</i> LIC. NO. 26829 DATE: 12/13/23 |
| | | | MASTER ID: T.E. | T.H. 36 AT C.S.A.H. 51 (LEXINGTON AVE.) | STATE PROJ. NO. 6212-192 (T.H.36) SHEET NO. SS15 OF SS30 SHEETS |
| | | | | NORTH RAMP IN ROSEVILLE, RAMSEY COUNTY | |

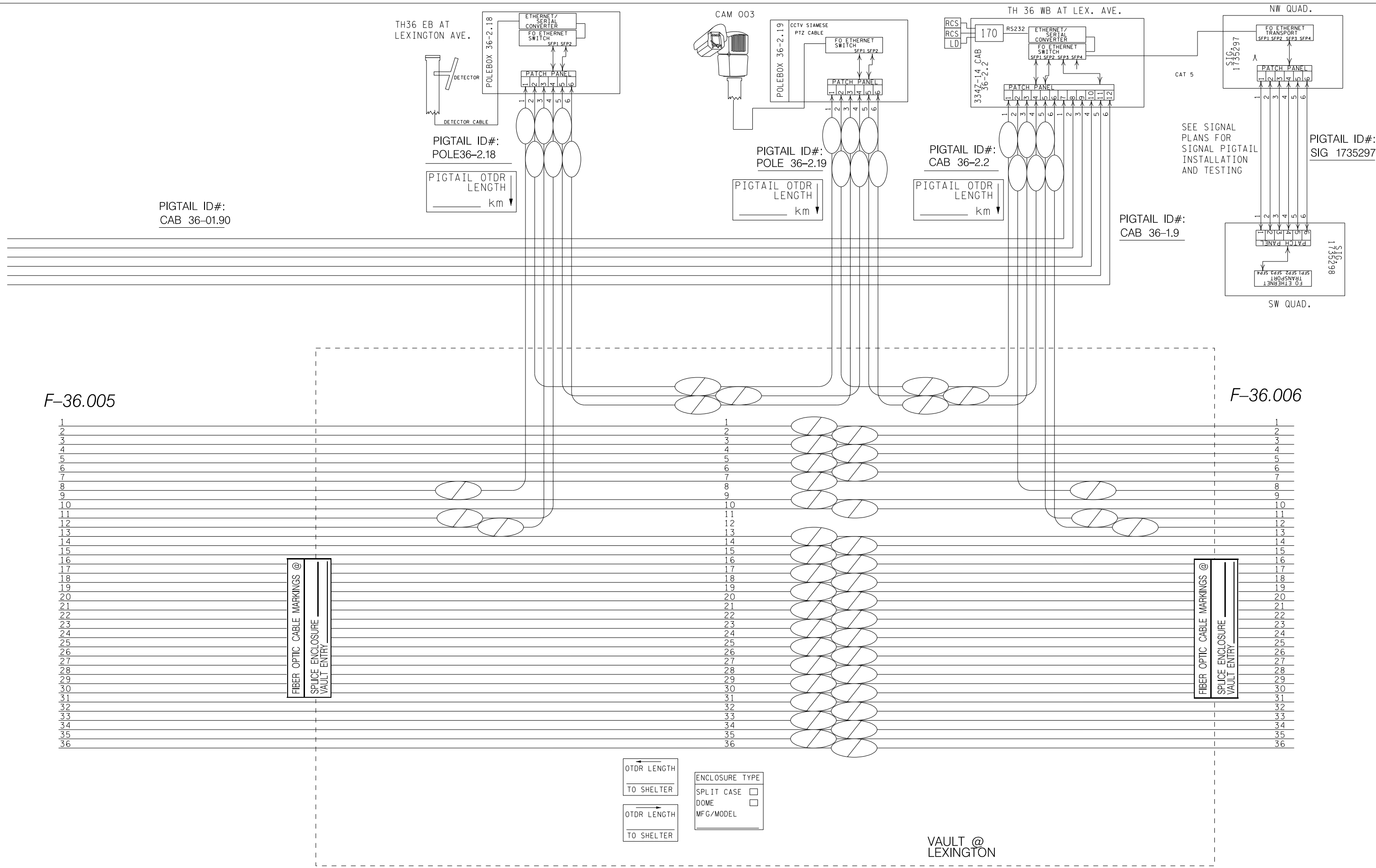

F-36.005

F-36.006

- 1
- 2
- 3
- 4
- 5
- 6
- 7
- 8
- 9
- 10
- 11
- 12
- 13
- 14
- 15
- 16
- 17
- 18
- 19
- 20
- 21
- 22
- 23
- 24
- 25
- 26
- 27
- 28
- 29
- 30
- 31
- 32
- 33
- 34
- 35
- 36

- 1
- 2
- 3
- 4
- 5
- 6
- 7
- 8
- 9
- 10
- 11
- 12
- 13
- 14
- 15
- 16
- 17
- 18
- 19
- 20
- 21
- 22
- 23
- 24
- 25
- 26
- 27
- 28
- 29
- 30
- 31
- 32
- 33
- 34
- 35
- 36

- 1
- 2
- 3
- 4
- 5
- 6
- 7
- 8
- 9
- 10
- 11
- 12
- 13
- 14
- 15
- 16
- 17
- 18
- 19
- 20
- 21
- 22
- 23
- 24
- 25
- 26
- 27
- 28
- 29
- 30
- 31
- 32
- 33
- 34
- 35
- 36

FIBER OPTIC CABLE MARKINGS @
 SPLICE ENCLOSURE
 VAULT ENTRY

FIBER OPTIC CABLE MARKINGS @
 SPLICE ENCLOSURE
 VAULT ENTRY

OTDR LENGTH TO SHELTER
 ENCLOSURE TYPE
 SPLIT CASE
 DOME
 MFG/MODEL

VAULT @ LEXINGTON

DISTRICT #: Metro
 PLOT NAME: layout
 PATH & FILENAME: Projects\DM罗斯03600000\Traffic\Signal\2.33_(5)\LEXINGTON AV NR-1735297\T1735297_sgl.dgn
 PLOTTED/REVISED: 19-OCT-2022

| SIGNAL HEAD CHART | | | | |
|-------------------|---|---|-----|---|
| FACE | R | Y | FYA | G |
| 2-1, 2-2 | ● | ● | ● | ● |
| 5-1, 5-2 | ← | ← | ← | ← |
| 6-1, 6-2 | ● | ● | ● | ● |
| 8-1, 8-2, 8-3 | ● | ● | ● | ● |

-ALL SIGNAL INDICATIONS SHALL BE 12" LED
 -ALL SIGNAL HEADS SHALL BE BLACK POLYCARBONITE WITH BACKGROUND SHIELDS
 -FYA DENOTES FLASHING YELLOW ARROW

| LOOP DETECTOR CHART | | |
|---------------------|-----------|----------|
| NUMBER | SIZE (FT) | LOCATION |
| D2-1, D6-1 | 6x6 | 180 |
| D5-1 | 2-6x6 | 20 & 50 |
| D5-2 | 2-6x6 | 5 & 35 |
| D8-1, D8-2 | 6x6 | 120 |
| D8-3 | 2-6x6 | 0 & 15 |
| D8-4 | 2-6x6 | 5 & 20 |

-ALL LOOP DETECTORS SHALL BE PVC UNLESS NOTED OTHERWISE
 -LOCATION: DISTANCE FROM CROSSWALK/STOP BAR IN FEET

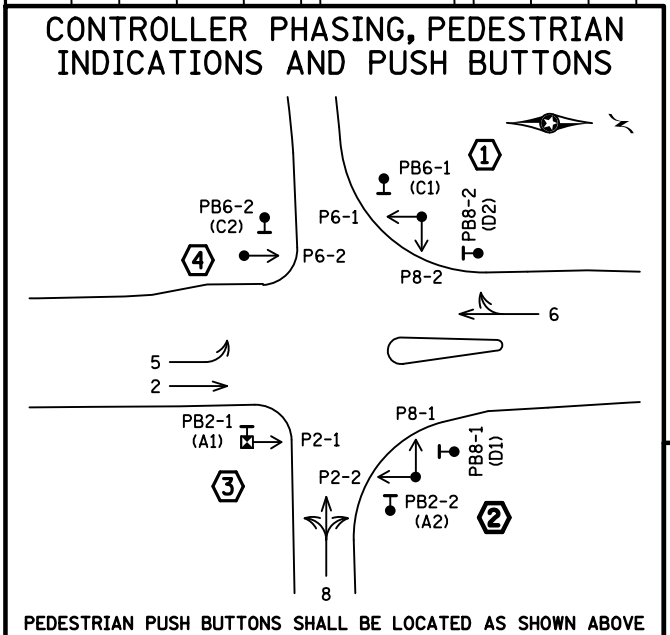
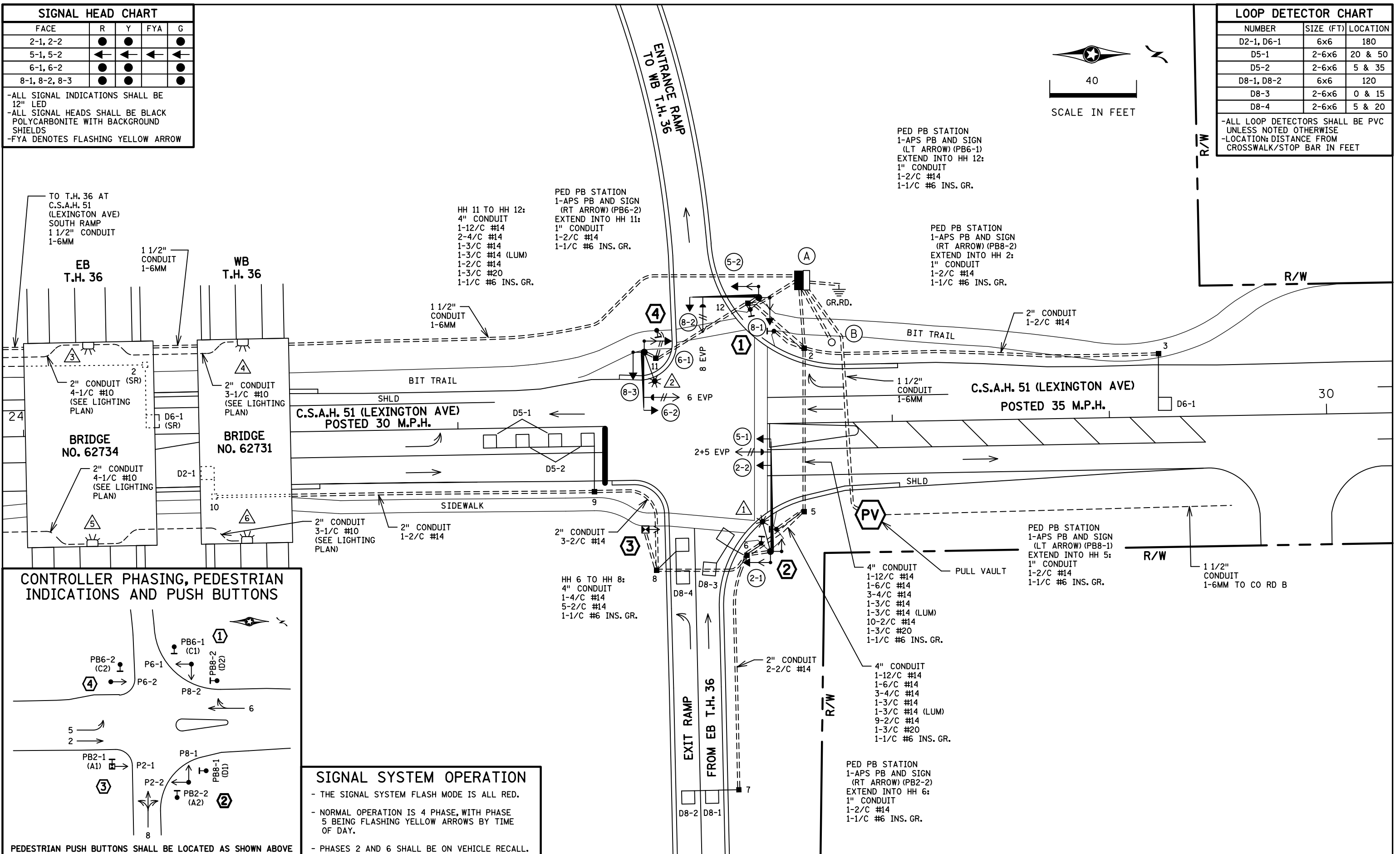
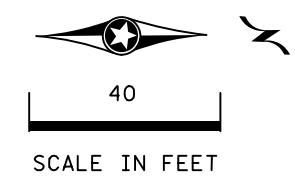

SIGNAL SYSTEM OPERATION

- THE SIGNAL SYSTEM FLASH MODE IS ALL RED.
- NORMAL OPERATION IS 4 PHASE, WITH PHASE 5 BEING FLASHING YELLOW ARROWS BY TIME OF DAY.
- PHASES 2 AND 6 SHALL BE ON VEHICLE RECALL.

| | | | | | | | | |
|-----|----------|---------------------------|-------------------------------------|------|-----------------------------------|--------------------------------|-------------|-------------------------------|
| BY | DATE | REVISIONS | SYSTEM ID: 20628 | T.E. | S.A.P. NO. 062-651-049 | DRAWN BY: GDS | CKD BY: EJA | DATE: 06-30-15 |
| SJK | 10/18/22 | AS-BUILT PLAN SP 6212-148 | METER ADDRESS: 2324 LEXINGTON AVE N | T.E. | CERTIFIED BY _____ | LICENSED PROFESSIONAL ENGINEER | | LIC. NO. _____ DATE: _____ |
| | | | MASTER ID: _____ | | STATE PROJ. NO. 6212-148 (T.H.36) | | | SHEET NO. SS15 OF SS20 SHEETS |

DISTRICT #: Metro
 PLOT NAME: pole notes
 PATH & FILENAME: Projects\DM罗斯0360000\Traffic\Signals\2.33_(5)\LEXINGTON AV NR-1735297\1735297.sgl.dgn
 PLOTTED/REVISED: 19-OCT-2022

④ PA85 POLE FOUNDATION
 TYPE PA85-A-25-D30-9 (DAVIT AT 350 DEG)
 1-ANGLE MOUNT SIGNAL OVERHEAD AT 0'
 2-ANGLE MOUNT SIGNALS AT 90 AND 180 DEG
 1-ANGLE MOUNT C.D. PED HEAD AT 180 DEG
 1-ONE WAY EVP DETECTOR AND
 CONFIRMATORY LIGHT (PHASE 6)
 LUMINAIRE-LED
 1-R9-3 SIGN (NO PEDS) FACING POLE 3
 2-TYPE D SIGNS (D-5)(D-6) (SEE SIGN DETAILS)
 3" CONDUIT TO HH 11:
 1-12/C #14
 2-4/C #14
 1-3/C #14
 1-3/C #14 (LUM)
 1-3/C #20
 1-1/C #6 INS. GR.

③ PEDESTAL FOUNDATION
 10' PEDESTAL POLE PLUS BASE
 1-STRAIGHT MOUNT C.D. PED HEAD AT 180 DEG
 1-APS PB AND SIGN (LT. ARROW) (PB2-1)
 1-R9-3 SIGN (NO PEDS) FACING POLE 4
 3" CONDUIT TO HH 8:
 1-4/C #14
 1-2/C #14
 1-1/C #6 INS. GR.

① PA85 POLE FOUNDATION
 TYPE PA85-A-30
 1-ANGLE MOUNT SIGNAL OVERHEAD AT 0'
 2-ANGLE MOUNT SIGNALS AT 90 AND 180 DEG
 2-ANGLE MOUNT C.D. PED HEADS
 AT 90 AND 180 DEG
 1-ONE WAY EVP DETECTOR AND
 CONFIRMATORY LIGHT (PHASE 8)
 2-R6-1(R AND L) SIGNS (ONE WAY)
 1-TYPE D SIGN (D-4) (SEE SIGN DETAILS)
 3" CONDUIT TO HH 12:
 1-12/C #14
 1-6/C #14
 2-4/C #14
 1-3/C #14
 1-3/C #20
 1-1/C #6 INS. GR.

② PA100 POLE FOUNDATION
 TYPE PA100-A-50-D30-9 (DAVIT AT 350 DEG)
 1-ANGLE MOUNT SIGNAL OVERHEAD AT 0'
 1-STRAIGHT MOUNT SIGNAL OVERHEAD AT 11'
 1-ANGLE MOUNT SIGNAL AT 180 DEG
 2-ANGLE MOUNT C.D. PED HEADS
 AT 90 AND 180 DEG
 1-ONE WAY EVP DETECTOR AND
 CONFIRMATORY LIGHT (PHASES 2+5)
 LUMINAIRE-LED
 1-R10-X12 SIGN ADJACENT TO HEAD (5-1)
 1-TYPE D SIGN (D-7) (SEE SIGN DETAILS)
 3" CONDUIT TO HH 6:
 1-12/C #14
 1-6/C #14
 2-4/C #14
 1-3/C #14
 1-3/C #14 (LUM)
 1-3/C #20
 1-1/C #6 INS. GR.

Ⓐ EQUIPMENT PAD (SEE DETAIL SHEET)
 SERVICE CABINET (SSB)
 CONTROLLER AND CABINET
 4" CONDUIT TO HH 2: 4" CONDUIT TO HH 12:
 1-12/C #14 2-12/C #14
 1-6/C #14 1-6/C #14
 3-4/C #14 4-4/C #14
 1-3/C #14 2-3/C #14
 12-2/C #14 2-2/C #14
 1-3/C #20 2-3/C #20
 1-1/C #6 INS. GR. 1-1/C #6 INS. GR.

GROUND WIRE AND GROUND ROD - MIN 8' OUT FROM PAD
 1-2" AND 1-3" CONDUIT STUBBED OUT (CAPPED BOTH ENDS)
 3/4" CONDUIT STUBBED OUT (FOR TELEPHONE LINE)
 CONTROLLER CABINET TO PULL VAULT TO CO RD B2:
 1-1/2" CONDUIT
 1-6-MM FO PIGTAIL WITH FIELD TERMINATED ENDS
 CONTROLLER CABINET TO SOUTH RAMP:
 1-1/2" CONDUIT
 1-6-MM FO PIGTAIL WITH FIELD TERMINATED END
 CONTROLLER CABINET TO SERVICE CABINET:
 2" CONDUIT
 2-1/C #6
 1-1/C #6 INS. GR.
 CONTROLLER CABINET TO SERVICE CABINET (COMMS):
 2" CONDUIT (FOR FUTURE USE)
 1-6PR #19
 SERVICE CABINET
 1-2" CONDUIT STUBBED OUT (CAPPED BOTH ENDS)
 SERVICE CABINET TO SOP VIA HH 1:
 2" CONDUIT
 3-1/C #2
 SERVICE CABINET TO HH 12:
 2" CONDUIT
 2-3/C #14 (LUM)
 SERVICE CABINET TO EXTERNAL GR. RD.:
 1" CONDUIT
 1-1/C #6 INS. GR.
 (SEE EQUIPMENT PAD LAYOUT)
 HH 12 TO HH 2:
 2" CONDUIT
 1-3/C #14 (LUM)

Ⓑ SOP-WOOD POLE
 (BY XCEL ENERGY)
 2" CONDUIT RISER, WEATHERHEAD
 WITH:
 3-1/C #2

(SEE NOTES ON SHEET 15)

| | | | | | | | | | |
|-----|----------|---------------------------|-------------------------------------|------|--|----------------------------------|-------------------------------|-------------|---------------|
| BY | DATE | REVISIONS | SYSTEM ID: 20628 | T.E. | INTERSECTION NOTES TRAFFIC CONTROL SIGNAL SYSTEM B T.H. 36 AT C.S.A.H. 51 (LEXINGTON AVE.) NORTH RAMP IN ROSEVILLE, RAMSEY COUNTY | S.A.P. NO. 062-651-049 | DRAWN BY:GDS | CKD BY:EJA | DATE:06-30-15 |
| SJK | 10/18/22 | AS-BUILT PLAN SP 6212-148 | METER ADDRESS: 2324 LEXINGTON AVE N | | | CERTIFIED BY _____ | LIC. NO. _____ | DATE: _____ | |
| | | | MASTER ID: | T.E. | | STATE PROJ.NO. 6212-148 (T.H.36) | SHEET NO. SS16 OF SS20 SHEETS | | |

DISTRICT #: Metro
 PLOT NAME: wiring diagram
 PATH & FILENAME: Projects\DM_POS\036\0000\Traffic\Signal\2.33_(5)\LEXINGTON AV NR-1735299\T1735297_.sldgn
 PLOTTED/REVISED: 19-OCT-2022

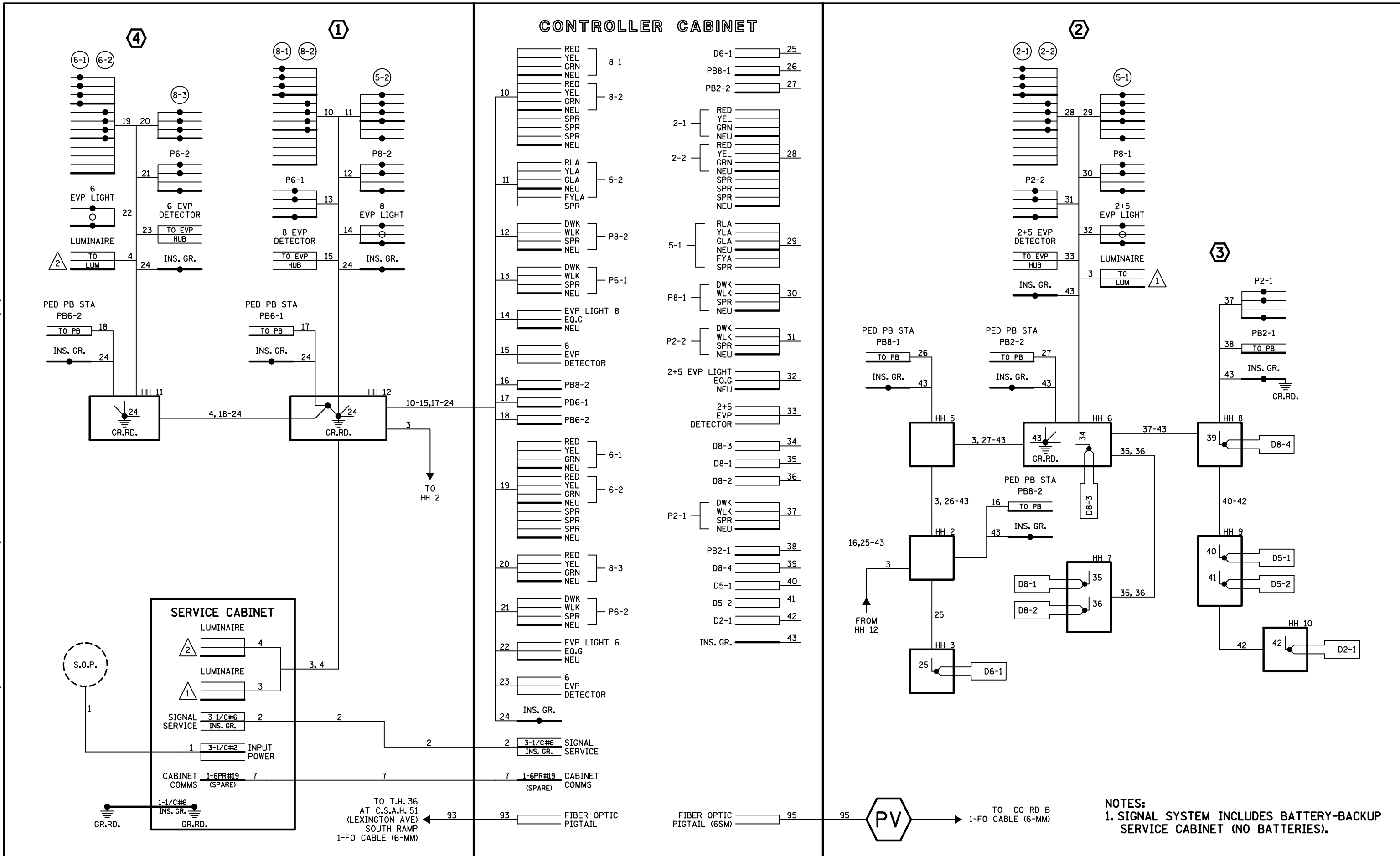

NOTES:
 1. SIGNAL SYSTEM INCLUDES BATTERY-BACKUP SERVICE CABINET (NO BATTERIES).

| BY | DATE | REVISIONS | SYSTEM ID: 20628 | T.E. | S.A.P. NO. 062-651-049 | DRAWN BY:GDS | CKD BY:EJA | DATE:06-30-15 |
|--|----------|---------------------------|-------------------------------------|------|---|--------------|------------|---------------|
| SJK | 10/18/22 | AS-BUILT PLAN SP 6212-148 | METER ADDRESS: 2324 LEXINGTON AVE N | | CERTIFIED BY _____ | | | |
| | | | MASTER ID: | T.E. | LICENSED PROFESSIONAL ENGINEER | | | |
| FIELD WIRING DIAGRAM | | | | | STATE PROJ.NO. 6212-148 (T.H.36) SHEET NO. SS17 OF SS20 SHEETS | | | |
| TRAFFIC CONTROL SIGNAL SYSTEM B | | | | | SHEET NO. SS17 OF SS20 SHEETS | | | |
| T.H. 36 AT C.S.A.H. 51 (LEXINGTON AVE.) | | | | | SHEET NO. SS17 OF SS20 SHEETS | | | |
| NORTH RAMP IN ROSEVILLE, RAMSEY COUNTY | | | | | SHEET NO. SS17 OF SS20 SHEETS | | | |

PLOTTED/REVISED: 10/28/2014

DISTRICT #: METRO
 IPLOT NAME: T20628_sgl
 PATH & FILENAME: IP_PWP-d0780720T20628_sgl.dgn

| FACE | PHASE | FLASH | TYPE AND SIZE IN INCHES | | | | | |
|------|---------|-------|-------------------------|-----|-----|-----|-----|--|
| | | | R | Y | G | Y | G | |
| 6-1 | | | | | | | | |
| 6-2 | 6 | R | 12" | 12" | 12" | | | |
| 4-1 | | | | | | | | |
| 4-2 | 4 | R | 12" | 12" | 12" | | | |
| 4-3 | | | | | | | | |
| 2-1 | 2 AND 5 | R | 12" | 12" | 12" | 12" | 12" | |
| 2-2 | 2 | R | 12" | 12" | 12" | | | |
| 2-3 | 2 AND 5 | R | 12" | 12" | 12" | 12" | 12" | |

RED INDICATIONS ARE LED

| DETECTOR CHART | | |
|----------------|-------|-------------|
| DESIGNATION | PHASE | SIZE IN FT. |
| D5-1 | 5 | 6x15 |
| D5-2 | 5 | 6x15 |
| D6-1 | 6 | 6 X 6 |
| D2-1 | 2 | 6 X 6 |
| D4-1 | 4 | 6 X 15 |
| D4-2 | 4 | 18 X 6 |
| D4-3 | 4 | 18 X 6 |
| D4-4 | 4 | 6 X 15 |

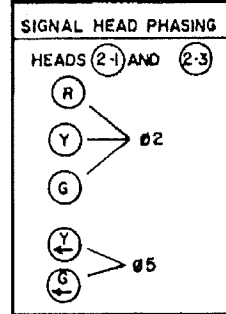

3 TYPE A20-D35-9
 ONE WAY SIGNAL OVERHEAD
 TYPE 20B POLE MOUNTED AT 270 DEG
 ONE WAY EVP AND CONFIRMATORY LIGHT
 LUMINAIRE 200 WATT HPS
 1-PEDESTRIAN PUSH BUTTON
 1-PED HEAD
 1-R9-3 FACING POLE #2
 EXTEND INTO HH8:
 3" RSC
 2-12/C#12
 1-3/C#12
 1-3/C#20
 2-1/C#10 (LUM)

4 TYPE A-25
 ONE WAY SIGNAL OVERHEAD
 TYPE 20C POLE MOUNTED AT 270 DEG
 ONE WAY EVP DETECTOR AND CONFIRMATORY LIGHT
 2-PED HEADS
 2-PEDESTRIAN PUSH BUTTONS AND SIGNS
 EXTEND INTO HH 9:
 3" RSC
 3-12/C#12
 3-3/C#12
 1-3/C#20

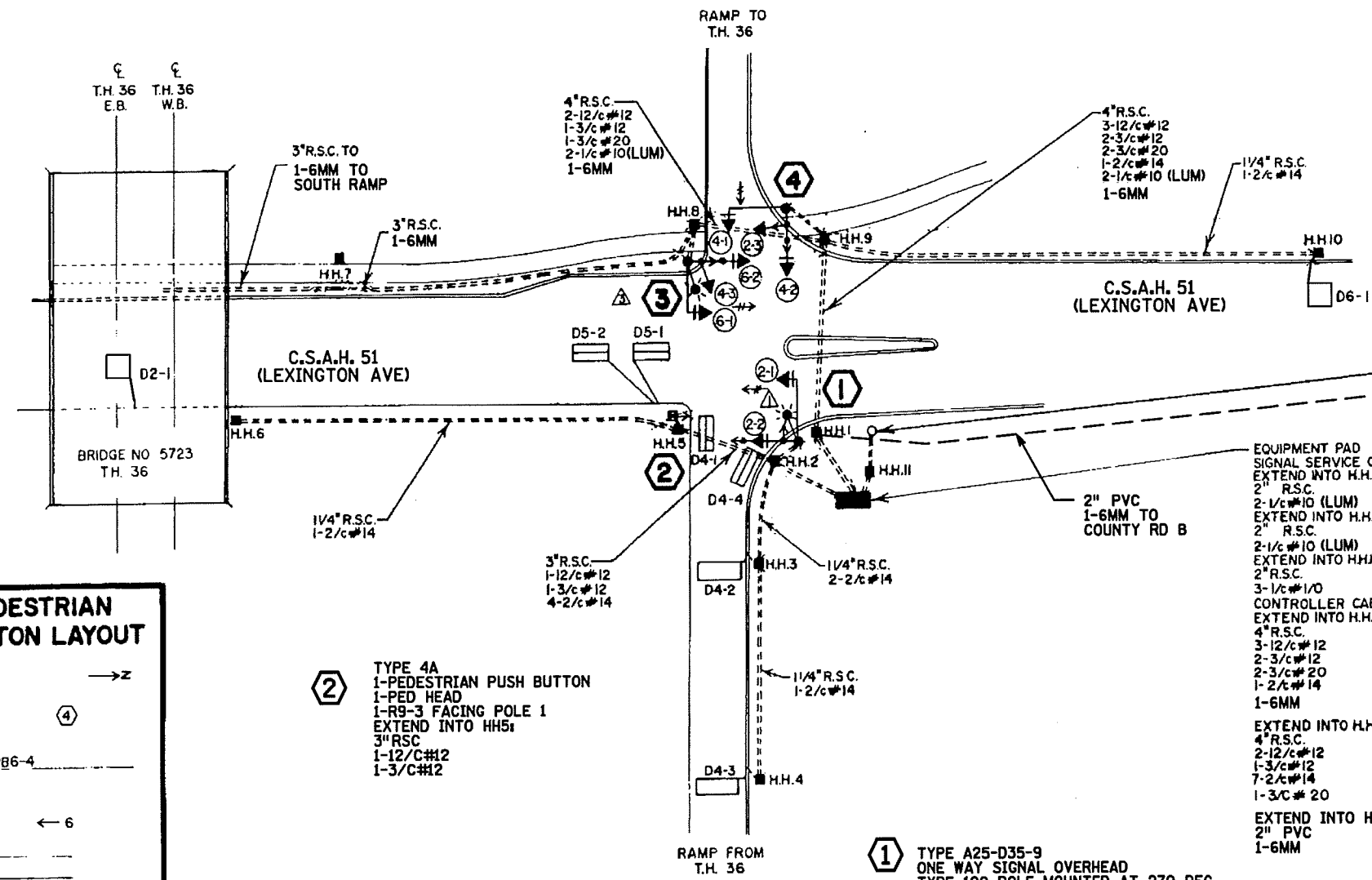
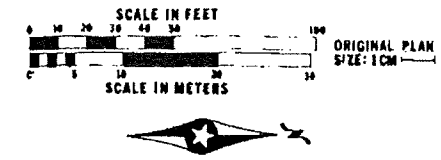

WOOD POLE
 2" R.S.C. RISER AND WEATHERHEAD ABOVE DISCONNECT SWITCH
 3-1/C # 1/0
 DISCONNECT SWITCH
 2" R.S.C. BELOW DISCONNECT SWITCH
 EXTEND INTO H.H. 11:
 2" R.S.C.
 3-1/C # 1/0

EQUIPMENT PAD
 SIGNAL SERVICE CABINET
 EXTEND INTO H.H.1:
 2" R.S.C.
 2-1/C#10 (LUM)
 EXTEND INTO H.H.2:
 2" R.S.C.
 2-1/C#10 (LUM)
 EXTEND INTO HH11 FROM METER:
 2" R.S.C.
 3-1/C#1/0
 CONTROLLER CABINET
 EXTEND INTO H.H.1:
 4" R.S.C.
 3-12/C#12
 2-3/C#12
 2-3/C#20
 1-2/C#14
 1-6MM
 EXTEND INTO H.H.2:
 4" R.S.C.
 2-12/C#12
 1-3/C#12
 7-2/C#14
 1-3/C#20
 EXTEND INTO HH 1:
 2" PVC
 1-6MM

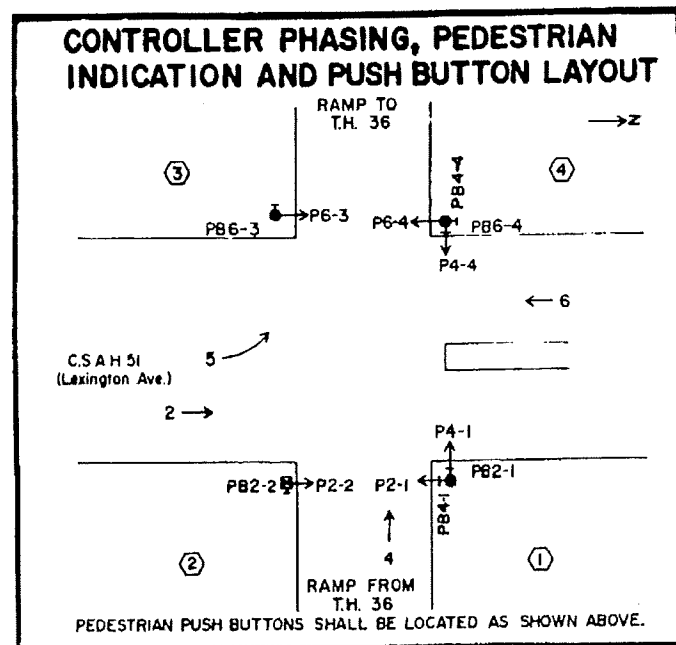

SIGNAL SYSTEM OPERATION

- THE SIGNAL SYSTEM FLASH MODE IS ALL RED.
- NORMAL OPERATION IS 4 PHASE, WITH PHASE 5 BEING A PROTECTED/PERMISSIVE LEFT TURN PHASE.
- PHASES 2 AND 6 SHALL BE ON VEHICLE RECALL.

| | | | | | | | | | |
|-----|----------|---------------------|------------------|------|--|--------------------|----------------|-------------|---------------|
| BY | DATE | REVISIONS | SYSTEM ID: 20628 | T.E. | INTERSECTION LAYOUT T.H. 36 AT C.S.A.H. 51 (LEXINGTON AVE) NORTH RAMP IN ROSEVILLE, RAMSEY COUNTY | S.A.P. NO. | DRAWN BY: | CKD BY: | DATE: |
| SJK | 11-01-14 | ADDED FIBER TO PLAN | METER ADDRESS: | T.E. | | CERTIFIED BY _____ | LIC. NO. _____ | DATE: _____ | |
| | | | MASTER ID: | | | STATE PROJ. NO. | (T.H. 36) | SHEET NO. | 1 OF 2 SHEETS |

PLOTTED/REVISED: 10/28/2014

DISTRICT #: METRO
I/PLOT NAME: T20628.sgl
PATH & FILENAME: IP_PWP-d0780720-T20628.sgl.dgn

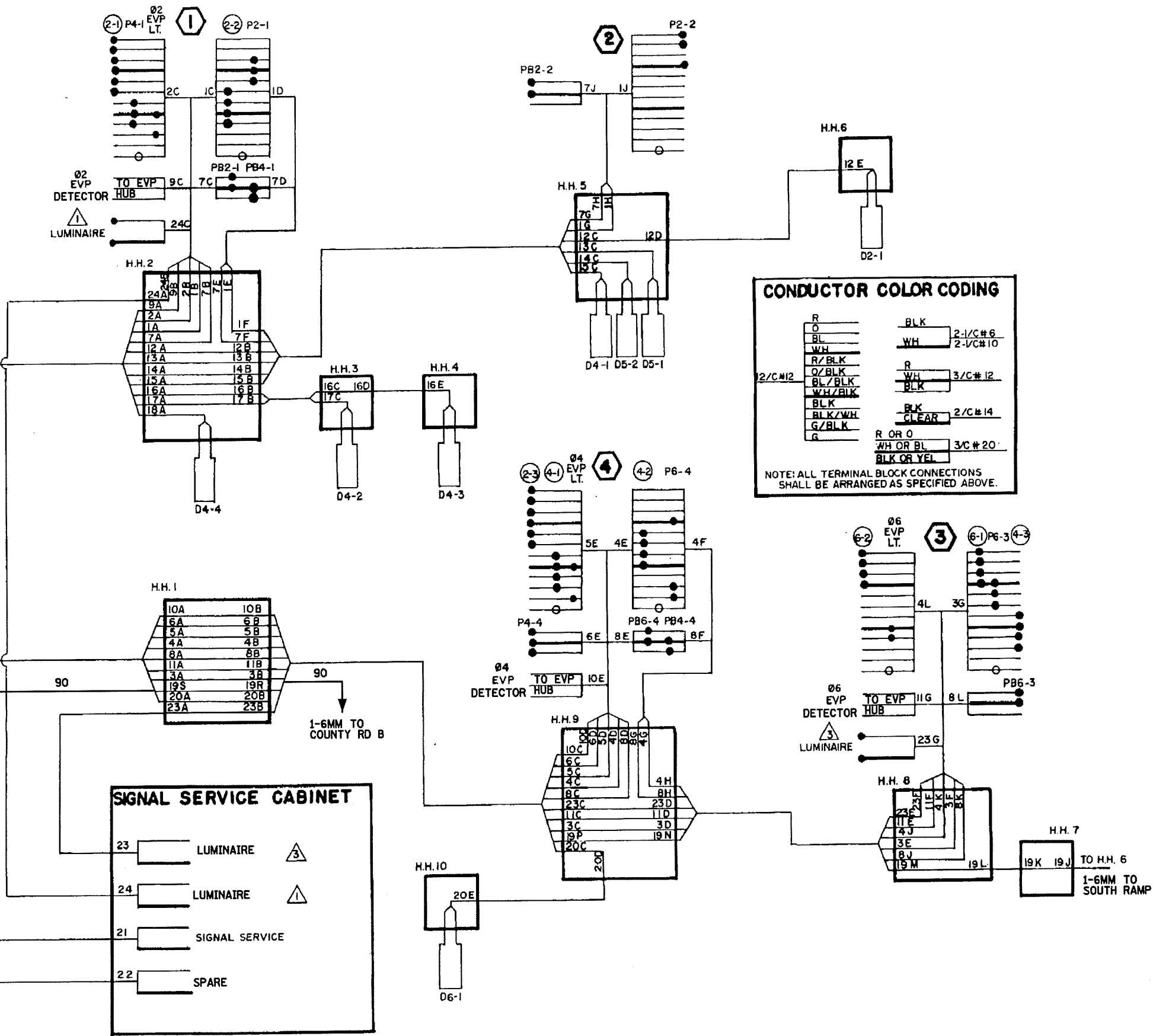
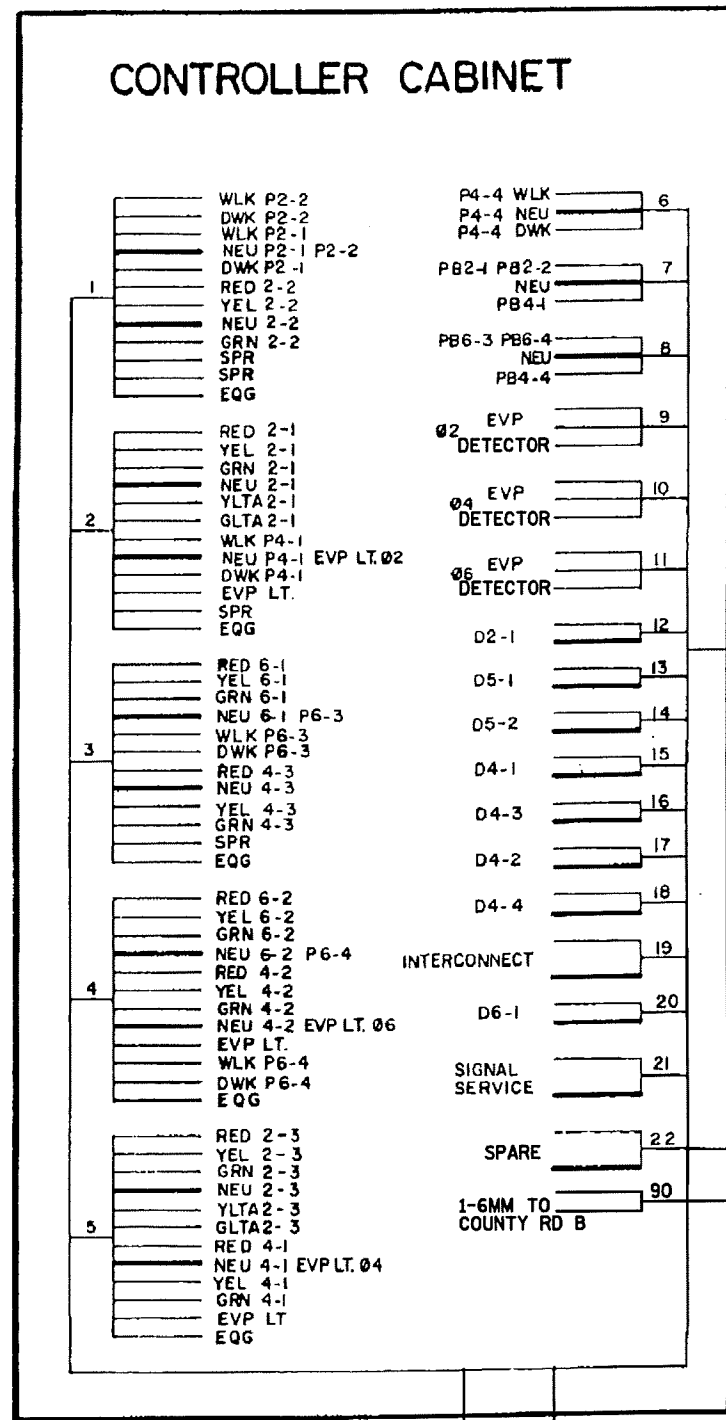

| BY | DATE | REVISIONS |
|-----|----------|---------------------|
| SJK | 11-01-14 | ADDED FIBER TO PLAN |
| | | |
| | | |

| | |
|------------------|------|
| SYSTEM ID: 20628 | T.E. |
| METER ADDRESS: | |
| MASTER ID: | T.E. |

WIRING DIAGRAM
 T.H. 36 AT C.S.A.H. 51
 (LEXINGTON AVE) NORTH RAMP
 IN ROSEVILLE, RAMSEY COUNTY

| | | | |
|--------------------|----------------|-------------------------|-------|
| S.A.P. NO. | DRAWN BY: | CKD BY: | DATE: |
| CERTIFIED BY _____ | LIC. NO. _____ | DATE: _____ | |
| STATE PROJ. NO. | (T.H. 36) | SHEET NO. 2 OF 2 SHEETS | |