





**LEGEND**

-  LIGHTING UNIT & LIGHT BASE DESIGN E
-  ARMORED CABLE 4 CONDUCTOR NO. 4
-  3" NON-METALLIC CONDUIT  
DIRECTIONAL BORE (UNLESS OTHERWISE NOTED).
-  PERMANENT GROUND ROD (25 OHMS OR LESS)
-  PAD MOUNTED FEEDPOINT
-  -OHP- OVERHEAD POWER LINES

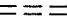
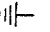

100  
SCALE IN FEET

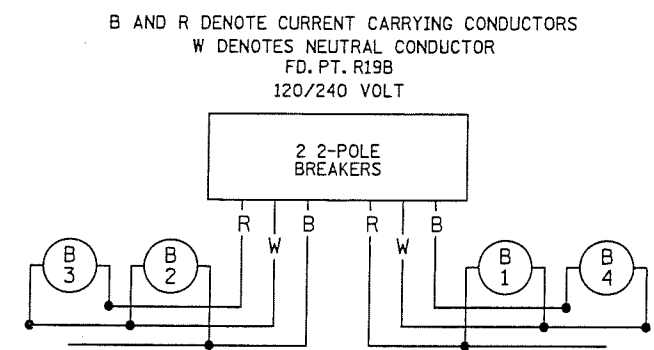
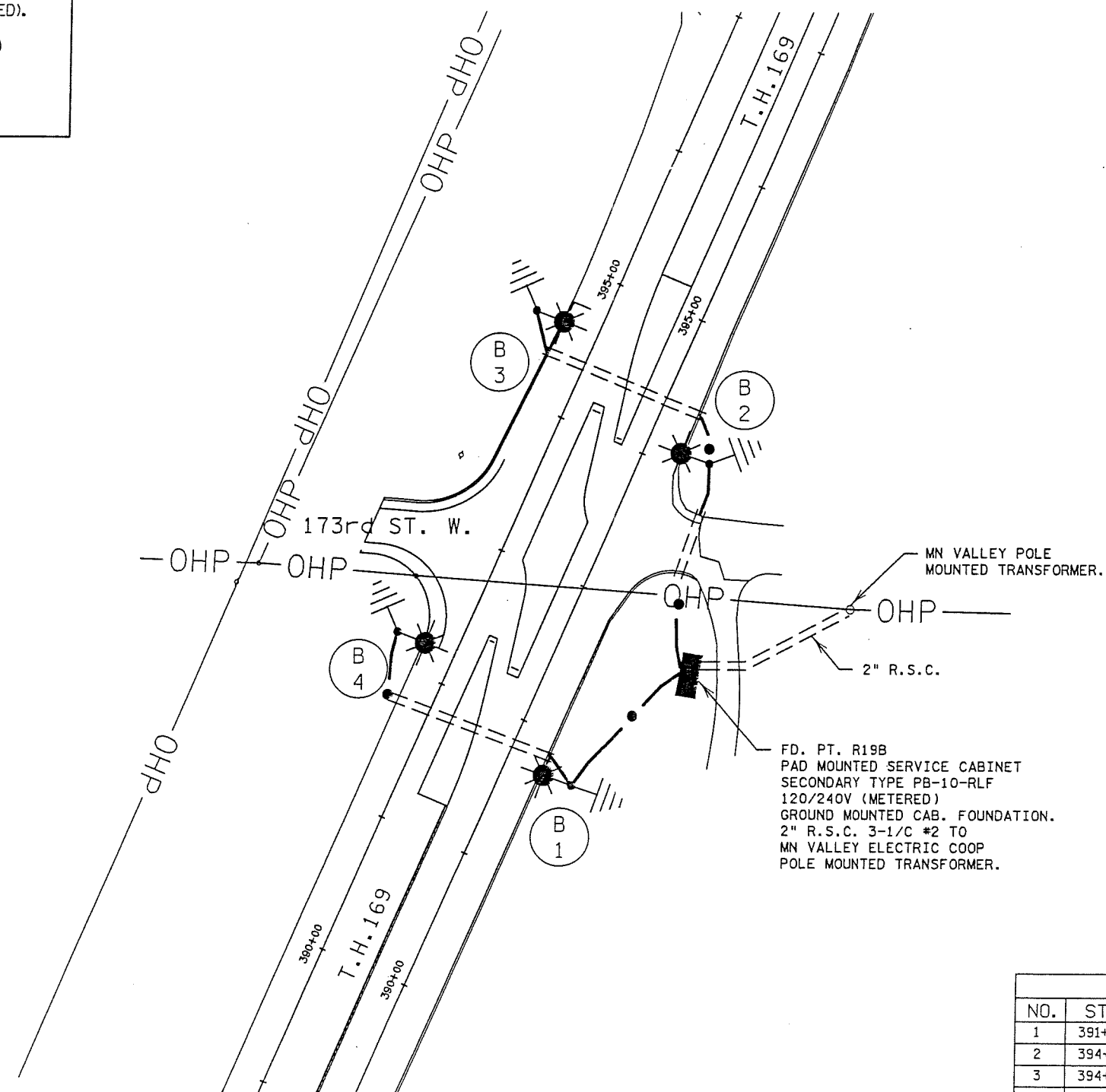

B AND R DENOTE CURRENT CARRYING CONDUCTORS  
W DENOTES NEUTRAL CONDUCTOR  
FD. PT. R19B  
120/240 VOLT

FD. PT. R19B  
PAD MOUNTED SERVICE CABINET  
SECONDARY TYPE PB-10-RLF  
120/240V (METERED)  
GROUND MOUNTED CAB. FOUNDATION.  
2" R.S.C. 3-1/C #2 TO  
MN VALLEY ELECTRIC COOP  
POLE MOUNTED TRANSFORMER.

LIGHTING STANDARDS AND BASES							
NO.	STA.	ALI	LT.	RT.	LOCATION	TYPE	WATTAGE
1	391+70	NB169			SE QUADRANT	9-40	250
2	394+10	NB169			NE QUADRANT	9-40	250
3	394+60	SB169			NW QUADRANT	9-40	250
4	392+20	SB169			SW QUADRANT	9-40	250

FEED POINT R19B

**LIGHTING PLAN**

BY	DATE	REVISIONS	FEEDPOINT: R19B	LOCATION: T.H.169 at 173rd St. W.	<b>LIGHTING PLAN</b>
			METER ADDRESS: 3500 173rd St. W. Jordan, 55352		
DRAWN BY: PB			CERTIFIED BY: <i>Michael P. Selinsky</i>		STATE PROJ.NO.7009-70 (T.H.169) SHEET NO. 13.03 OF 13.03 SHEETS
CKD BY: GB			LIC. NO. 19863 DATE: 7/25/2011		
DATE:					

PLOTTED/REVISED: 7/25/2011

DISTRICT \*: METRO  
IPLOT NAME: 17009-701o3  
PATH & FILENAME: IP\_PWP-d\381425\7009-701o3.dgn