

NUMBER	SIZE (FT)	LOCATION
D1-1	2-6X6	20&50
D1-2	2-6X6	5&35
D2-1	6X6	250
D4-1	6X6	120
D4-2	6X6	0
D4-3	2-6X6	5&20
D6-1	6X6	160

-LOCATION: DISTANCE FROM CROSSWALK/STOP BAR IN FEET

FACE	R	Y	FYA	G
1-1,1-2	←	←	←	←
2-1,2-2	●	●	●	●
4-1,4-2,4-3	●	●		●
6-1,6-2	●	●		●

-ALL SIGNAL INDICATIONS ARE 12" LED
 -ALL SIGNAL HEADS ARE BLACK POLYCARBONITE WITH BACKGROUND SHIELDS
 -FYA DENOTES FLASHING YELLOW ARROW

5 PA90 POLE FOUNDATION
 TYPE PA90-A-35-D40-9 (DAVIT AT 350 DEG)
 1-ANGLE MOUNT SIGNAL OVERHEAD AT 0'
 1-STRAIGHT MOUNT SIGNAL OVERHEAD AT 11'
 1-ANGLE MOUNT SIGNAL AT 180 DEG
 2-ANGLE MOUNT C.D. PED INDS AT 90 AND 180 DEG
 1-ONE WAY EVP DETECTOR AND CONFIRMATORY LIGHT (PHASE 6 & 1) AT 6' LUMINAIRE-250W HPS
 1-TYPE D SIGN
 1-SIGN R10-X12 (LT YIELD ON FYA) ADJACENT TO HEAD 1-1
 EXTEND INTO HH 9:
 3" PVC
 2-12/C#14
 1-3/C#14 (LUM)
 1-3/C#14
 1-3/C#20
 1-1/C#6 INS. GR.

APS PED PB STA
 1-APS PB AND SIGN (RT ARROW) (PB6-2)
 EXTEND INTO HH 9:
 2" PVC
 1-2/C#14

APS PED PB STA
 1-APS PB AND SIGN (LT ARROW) (PB4-1)
 EXTEND INTO HH 9:
 2" PVC
 1-2/C#14

B INPLACE: WOOD POLE (XCEL ENERGY)
 2" PVC RISER AND WEATHERHEAD TO SERVICE CABINET VIA HH 1:
 2" PVC
 3-1/C#2

A EQUIPMENT PAD - SEE DETAIL
 SERVICE CABINET CONTROLLER AND CABINET
 4" PVC TO HH 2:
 4-12/C#14
 1-4/C#14
 2-3/C#14
 5-2/C#14
 2-3/C#20
 1-1/C#6 INS. GR.
 1-6 PR.#19
 3" PVC STUBBED OUT CAPPED BOTH ENDS
 3/4" PVC STUBBED OUT CAPPED BOTH ENDS
 2" PVC TO SERVICE CABINET
 2-1/C#6
 1-1/C#6 INS. GR.
 2" PVC TO SERVICE CABINET (COMMS)
 SERVICE CABINET TO HH 2:
 2" PVC
 3-3/C#14 (LUM)
 SERVICE CABINET TO HH 1:
 3-1/C#2
 2" PVC STUBBED OUT CAPPED BOTH ENDS
 HH 2 TO HH 11:
 1-3/C#14 (LUM)
 4" PVC TO HH 11:
 2-12/C#14
 1-4/C#14
 1-3/C#14
 6-2/C#14
 1-3/C#20
 1-1/C#6 INS. GR.

1 TYPE 4A PEDESTAL FOUNDATION
 8' PEDESTAL PLUS BASE
 1-APS PB AND SIGN (LT ARROW) (PB6-1)
 1-TYPE R9-3a (NO PED) SIGN FACING POLE 2
 EXTEND INTO HH 11:
 2" PVC
 1-4/C#14
 1-2/C#14
 2-1/C#6 INS. GR.

4 PEDESTAL FOUNDATION
 10' PEDESTAL AND BASE
 1-STRAIGHT MOUNT C.D. PED IND. AT 0 DEG
 1-APS PB AND SIGN (LT ARROW) (PB4-2)
 EXTEND INTO HH 7:
 2" PVC
 1-4/C#14
 1-2/C#14
 1-1/C#6 INS. GR.

3 PA85 POLE FOUNDATION
 TYPE PA85-A-25-D40-9 (DAVIT AT 350 DEG)
 1-ANGLE MOUNT SIGNAL OVERHEAD AT 0'
 2-ANGLE MOUNT SIGNALS AT 0 AND 180 DEG
 1-ONE WAY EVP DETECTOR AND CONFIRMATORY LIGHT (PHASE 4) AT 6' LUMINAIRE-250W HPS
 1-TYPE D SIGN
 1-TYPE R9-3a SIGNS (NO PED) FACING POLE 2
 EXTEND INTO HH 4:
 3" PVC
 2-12/C#14
 1-3/C#14 (LUM)
 1-3/C#14
 1-3/C#20
 1-1/C#6 INS. GR.

3" PVC
 1-4/C#14
 2-2/C#14
 1-1/C#6 INS. GR.

2 PA85 POLE FOUNDATION
 TYPE PA85-A-25-D40-9 (DAVIT AT 350 DEG)
 1-ANGLE MOUNT SIGNAL OVERHEAD AT 0'
 2-ANGLE MOUNT SIGNALS AT 90 AND 180 DEG
 1-ONE WAY EVP DETECTOR AND CONFIRMATORY LIGHT (PHASE 2) AT 6' LUMINAIRE-250W HPS
 1-TYPE D SIGN
 2-TYPE R9-3a SIGNS (NO PED) FACING POLES 1 AND 3
 EXTEND INTO HH 4:
 3" PVC
 2-12/C#14
 1-3/C#14 (LUM)
 1-3/C#14
 1-3/C#20
 1-1/C#6 INS. GR.

4" PVC
 2-12/C#14
 1-4/C#14
 1-3/C#14 (LUM)
 1-3/C#14
 2-2/C#14
 1-3/C#20
 1-1/C#6 INS. GR.

CONTROLLER PHASING, PEDESTRIAN INDICATIONS AND PUSH BUTTONS

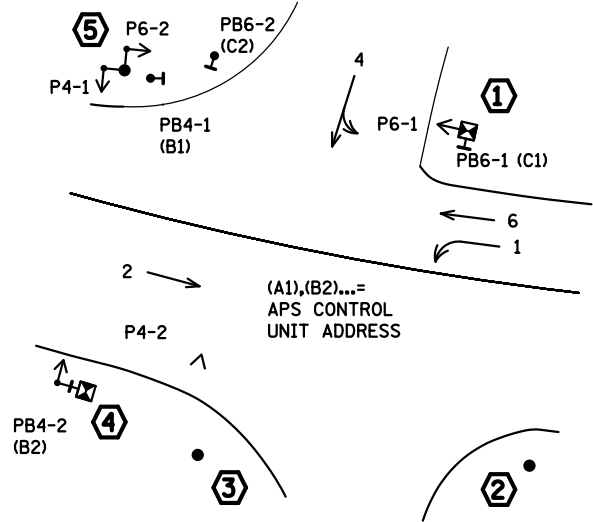

SIGNAL SYSTEM OPERATION

- THE SIGNAL SYSTEM FLASH MODE IS ALL RED.
- NORMAL OPERATION IS 4 PHASE. WITH PHASE 1 BEING A FLASHING YELLOW ARROW BY TIME OF DAY.
- PHASES 2 AND 6 SHALL BE ON VEHICLE RECALL.

PEDESTRIAN PUSH BUTTONS SHALL BE LOCATED AS SHOWN ABOVE

BY	DATE	REVISIONS
EJA	2-8-2012	AS-BUILT OF SP 1902-56

SYSTEM ID: 39258 T.E. 5239
 METER ADDRESS: 959 SIBLEY MEMORIAL HWY

INTERSECTION LAYOUT
 T.H. 35E AT T.H. 13/(SIBLEY MEMORIAL HWY)
 WEST RAMPS
 IN MENDOTA HEIGHTS, DAKOTA COUNTY

S.A.P. NO. _____
 DRAWN BY: MAS CKD BY: EJA DATE: 3-15-11
 CERTIFIED BY: *Michael P. Gelbrich* LIC. NO. 19863 DATE: 3-15-11
 STATE PROJ. NO. 1902-56 (T.H.13) SHEET NO. SS10R OF SS16 SHEETS

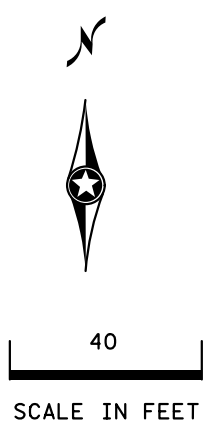

PLOTTED/REVISED: 2/9/2012

DISTRICT #: METRO
 IPLOT NAME: LAYOUT
 PATH & FILENAME: IP_PWP-d1343554Y39258_sgl.dgn

STA. 43+00 E.B.

PLOTTED/REVISED: 2/9/2012

DISTRICT #: METRO
IPLOT NAME: WIRING
PATH & FILENAME: IP_PWP-d1343554T39258_sgl.dgn

CONTROLLER CABINET

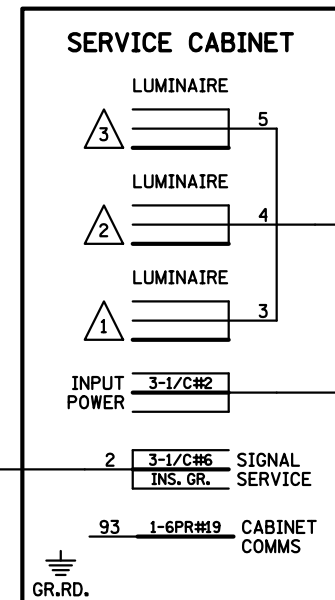
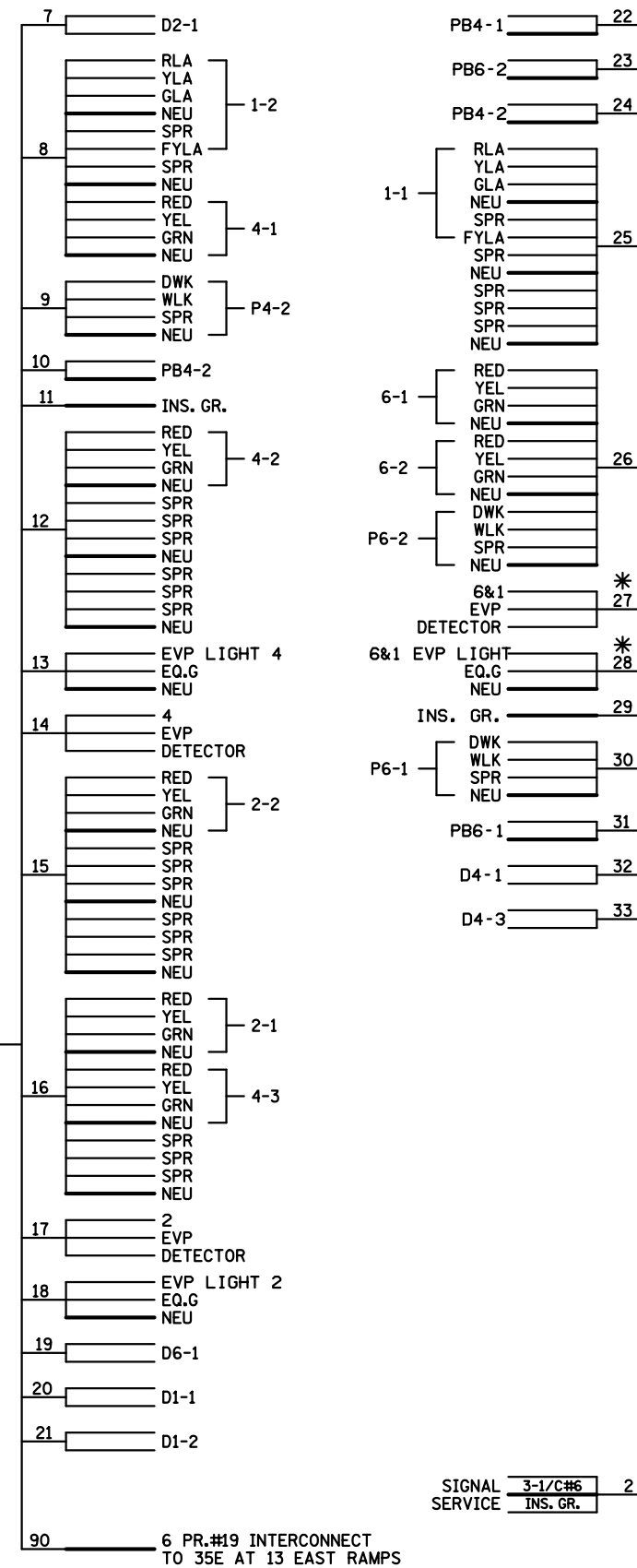

- NOTES:**
- LUMINAIRES ARE UNMETERED.
 - SIGNAL SYSTEM INCLUDES BATTERY- BACKUP SERVICE CABINET (NO BATTERIES).
 - FOR CONDUCTOR COLOR CODE SEE TRAFFIC SIGNAL POLE WIRING CONNECTOR DETAIL.

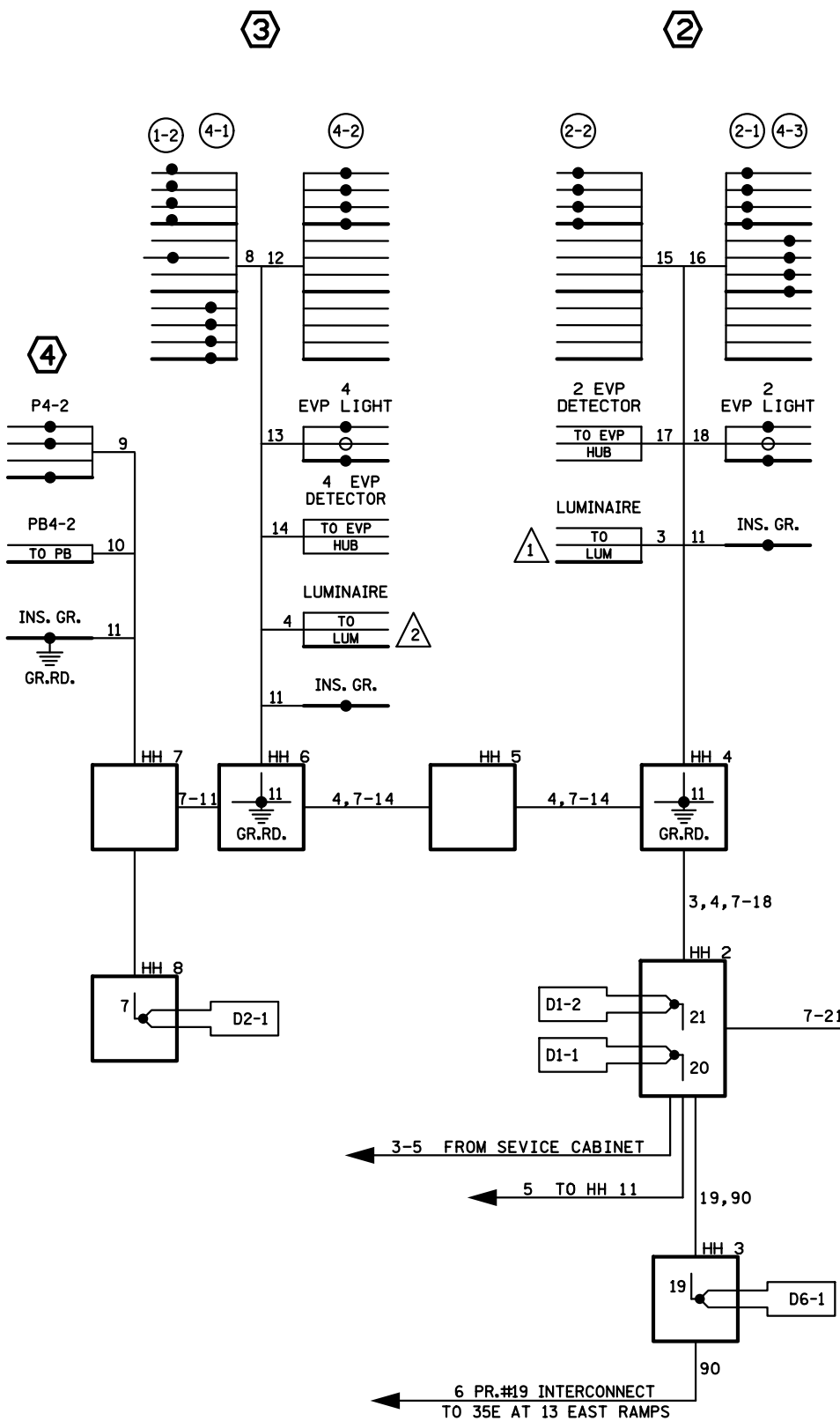

FIELD WIRING DIAGRAM
TRAFFIC CONTROL SIGNAL SYSTEM A
T.H. 35E AT T.H. 13/(SIBLEY MEMORIAL HWY)
WEST RAMPS
IN MENDOTA HEIGHTS, DAKOTA COUNTY

S.A.P. NO. _____
DRAWN BY: MAS CKD BY: EJA DATE: 3-15-11
CERTIFIED BY: *Michael P. Gubinsky* LIC. NO. 19863 DATE: 3-15-11
STATE PROJ. NO. 1902-56 (T.H.13) SHEET NO. SS11R OF SS16 SHEETS

BY	DATE	REVISIONS	SYSTEM ID: 39258 T.E. 5239
EJA	2-8-2-12	AS-BUILT OF SP 1902-56	METER ADDRESS: 959 SIBLEY MEMORIAL HWY

PLOTTED/REVISED: 8/4/2011

DISTRICT #: METRO
 IPLOT NAME: utilities_layout
 PATH & FILENAME: IP_PWP-dl343553\utilities_sgl.dgn

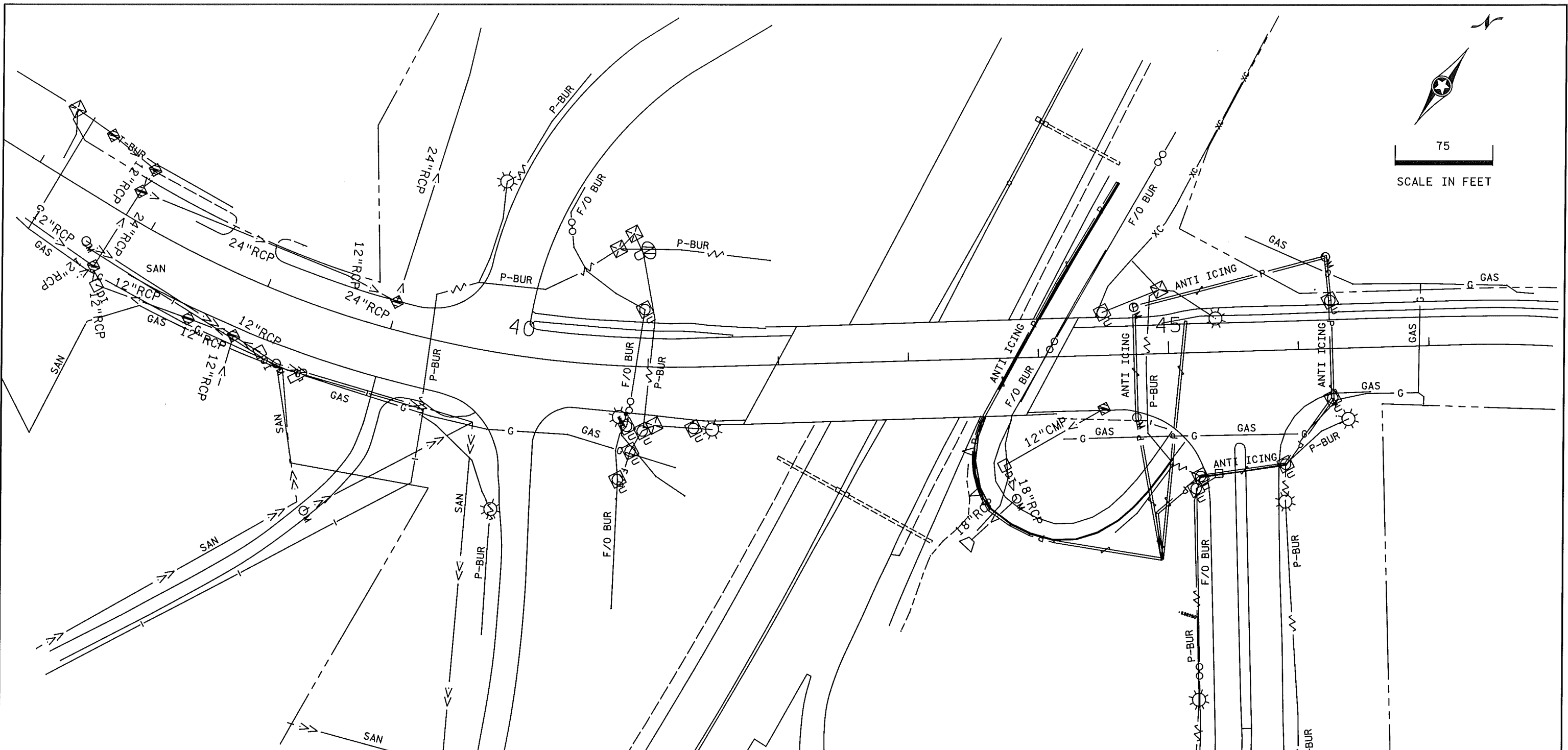
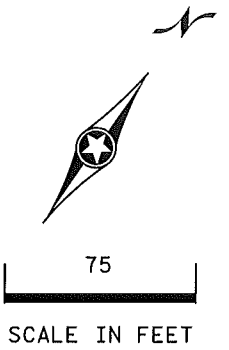

UTILITY OWNERSHIP	
F/O-BUR	MN/DOT
P-BUR	MN/DOT
ANTI ICING	MN/DOT
T-BUR	QWEST CORPORATION
GAS	XCEL ENERGY
WATER	ST. PAUL REGIONAL WATER SERVICES
SANITARY	CITY OF MENDOTA HEIGHTS

- NOTES:
- IT SHALL BE THE CONTRACTOR'S RESPONSIBILITY TO UTILIZE THE "ONE CALL EXCAVATION NOTICE SYSTEM" (TELEPHONE NUMBER 651-454-0002). THIS IS REQUIRED BY MINNESOTA STATUTE 2160.
 - FOR PLAN AND UTILITY SYMBOLS, SEE TECHNICAL MANUAL.
 - NO UTILITIES WILL BE AFFECTED BY THIS PROJECT.
 - THE SUBSURFACE UTILITY INFORMATION IN THIS PLAN IS UTILITY QUALITY LEVEL D. THIS UTILITY LEVEL WAS DETERMINED ACCORDING TO THE GUIDELINES OF CI/ASCE 38-02, ENTITLED "STANDARD GUIDELINES FOR THE COLLECTION AND DEPICTION OF EXISTING SUBSURFACE UTILITY DATA".

BY	DATE	REVISIONS

SYSTEM ID: 39257,39258 T.E. 5238,5239
 METER ADDRESS:
 MASTER ID: T.E.

UTILITIES LAYOUT
 35E AT T.H.13/(SIBLEY MEMORIAL HWY) RAMPS
 IN LILLYDALE AND MENDOTA HEIGHTS,
 DAKOTA COUNTY

S.A.P. NO. _____
 DRAWN BY: SJK CKD BY: EJA DATE: 12-03-10
 CERTIFIED BY: *Michael P. Sulovsky* LIC. NO. 19863 DATE: 12-03-10
 LICENSED PROFESSIONAL ENGINEER
 STATE PROJ. NO. 1902-56 (T.H.13) SHEET NO. SS16 OF SS16 SHEETS