

DESIGN B

DESIGN NO.	CURB WIDTH A	CURB HEIGHT H	CONCRETE	
			CU. YDS. PER LIN. FT.	LIN. FT. PER CU. YD.
B4	7-3/8"	4"	0.0294	34.0
B6	8"	6"	0.0352	28.4
B8	8-5/8"	8"	0.0414	24.2
B9	9"	9"	0.0449	22.3
B10	9-3/8"	10"	0.0485	20.6

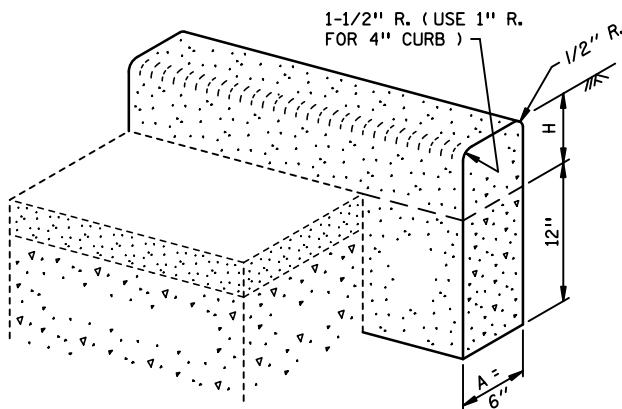

DESIGN V

DESIGN NO.	CURB HEIGHT H	CONCRETE	
		CU. YDS. PER LIN. FT.	LIN. FT. PER CU. YD.
V4	4"	0.0247	40.5
V6	6"	0.0277	36.1
V8	8"	0.0308	32.5
V9	9"	0.0323	31.0
V10	10"	0.0338	29.6

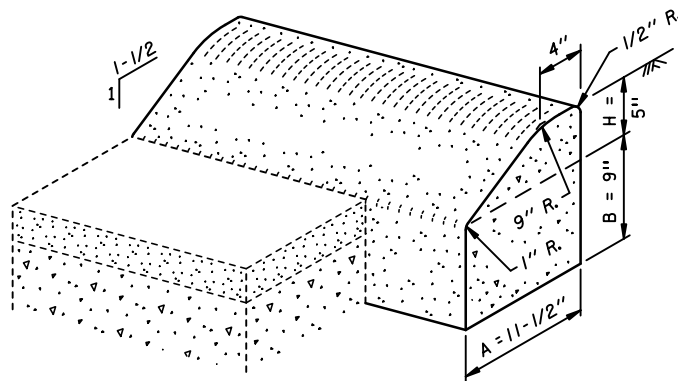

DESIGN S

DESIGN NO.	CONCRETE	
	CU. YDS. PER LIN. FT.	LIN. FT. PER CU. YD.
S5	0.0364	27.5

NOTE:

ALL CURB SLOPE MEASUREMENTS ARE IN RELATION TO ADJACENT PAVEMENT SLOPE.

APPROVED JULY 25, 2011

M. J. Henneman
STATE DESIGN ENGINEER

STATE OF MINNESOTA
DEPARTMENT OF TRANSPORTATION

CONCRETE CURB
DESIGN B, DESIGN V, DESIGN S, DESIGN DR AND DESIGN BR

SPECIFICATION
REFERENCE

2531

STANDARD
PLATE
NO.

7020K

1 OF 2

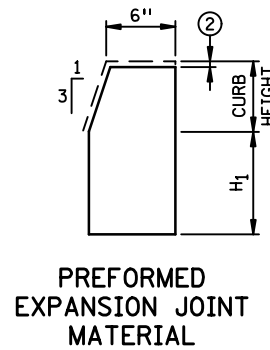
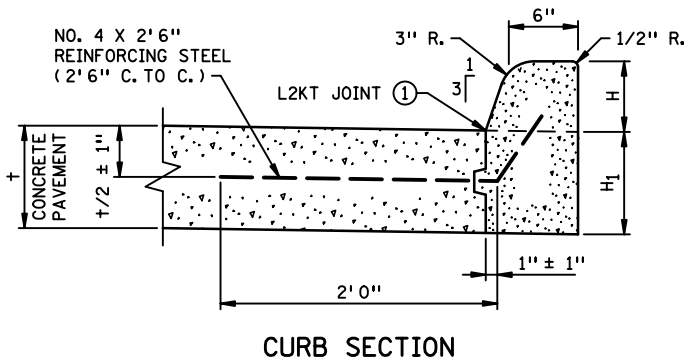

TABLE OF CU. YDS. PER LIN. FT. ③

DIMENSION H ₁	DIMENSION H					
	4"	6"	7"	8"	9"	10"
8"	0.0222	0.0275	0.0303	0.0332	0.0361	0.0392
9"	0.0240	0.0295	0.0324	0.0354	0.0384	0.0415
10"	0.0259	0.0315	0.0345	0.0375	0.0407	0.0439
11"	0.0277	0.0335	0.0366	0.0397	0.0429	0.0462
12"	0.0295	0.0355	0.0387	0.0419	0.0452	0.0486

DESIGN BRH-H₁
(EXAMPLE: DESIGN BR6-9)

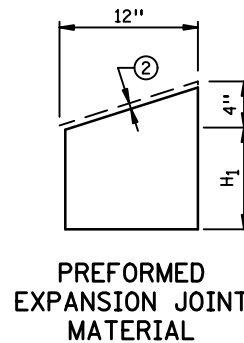
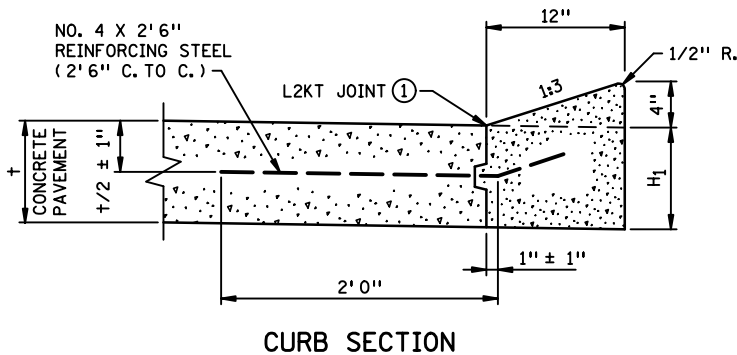
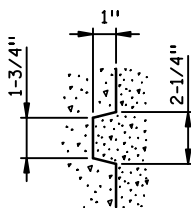

TABLE OF
CU. YDS. PER
LIN. FT. ③

DIMENSION H ₁	CU. YDS. CONC.
8"	0.0313
9"	0.0344
10"	0.0374
11"	0.0404
12"	0.0435

DESIGN DR4-H₁
(EXAMPLE: DESIGN DR4-9)



ALTERNATE KEYWAY DETAIL

NOTES:

- ALL CURB SLOPE MEASUREMENTS ARE IN RELATION TO ADJACENT PAVEMENT SLOPE.
- SEE STANDARD PLAN 5-297.221 FOR STANDARD PAVEMENT KEYWAY DETAIL.
- JOINT MATERIAL SHALL BE OF 1/2" THICKNESS.
- 1 THICKNESS REQUIRED AT 1/2" EXPANSION JOINTS AND 3 THICKNESSES REQUIRED AT 1" EXPANSION JOINTS.

- ① SEE PLANS FOR SEALING REQUIREMENTS.
- ② 1/2" LESS THAN CURB DIMENSIONS FOR APPLICATION OF SEALER.
- ③ BASED ON A 2% PAVEMENT CROSS SLOPE AND STANDARD KEYWAY DESIGN.

APPROVED JULY 25, 2011

Michael J. Henneman
STATE DESIGN ENGINEER

STATE OF MINNESOTA
DEPARTMENT OF TRANSPORTATION

CONCRETE CURB
DESIGN B, DESIGN V, DESIGN S, DESIGN DR AND DESIGN BR

SPECIFICATION
REFERENCE

2531

REVISED
3-22-2013 M.J.E.

STANDARD
PLATE
NO.

7020K

2 OF 2