

SIGNAL HEAD CHART

FACE	R	Y	G	Y	G
2-1, 2-2	○	○	○		
2-3, 2-4	○	○	○	◄	◄
6-1, 6-2	○	○	○		
8-1	○	○	○		
8-2	○	○	○		◄
8-3, 8-4	○	◄	◄		
EL2-1, EL6-1	○				

-ALL SIGNAL INDICATIONS ARE 12" LED
-ALL SIGNAL HEADS ARE BLACK POLYCARBONITE WITH BACKGROUND SHIELDS

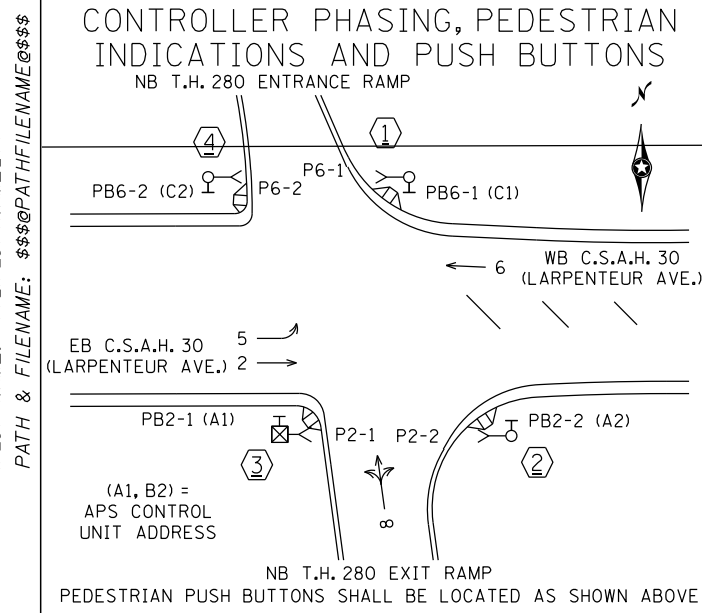
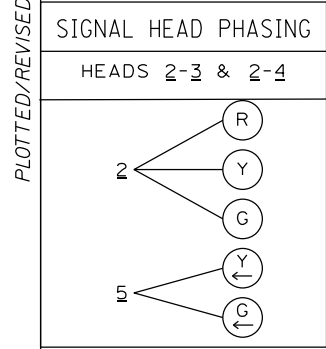

4 WB LARPEN TEUR STA 17+70, 27' LT
PA85 POLE FOUNDATION
TYPE PA85-A-25-D40-9 (DAVIT AT 350 DEG)
1-ANGLE MOUNT SIGNAL OVERHEAD AT 0'
2-ANGLE MOUNT SIGNALS AT 90 AND 180 DEG
1-ANGLE MOUNT C.D. PED HEAD AT 180 DEG
1-ONE WAY EVP DETECTOR AND CONFIRMATORY LIGHT (PHASE 6)
1-ONE WAY EVP DETECTOR (PHASES 1+6 WR ADVANCE)
LUMINAIRE-250W HPS
1-APS PB AND SIGN (RT ARROW) (PB6-2)
1-BLUE ENFORCEMENT LIGHT (EL6-1)
1-R9-3 SIGN (NO PED) FACING POLE 3
1-TYPE D SIGN (D-2)
EXTEND INTO HH 8:
3" PVC
2-12/C #14
1-4/C #14
1-3/C #14
1-3/C #14 (LUM)
1-2/C #14
2-3/C #20
1-1/C #6 INS. GR.

4" PVC
2-12/C #14
2-4/C #14
1-3/C #14
1-3/C #14 (LUM)
9-2/C #14
3-3/C #20
1-1/C #6 INS. GR.

4" PVC
1-4/C #14
8-2/C #14
4-3/C #20
1-FO CABLE (6SM)
1-1/C #6 INS. GR.

3" RSC STUBBED OUT OF ABUTMENT

3" RSC SUSPENDED UNDER BRIDGE
4-2/C #14
4-3/C #20
1-FO CABLE (6SM)

3" RSC STUBBED OUT OF ABUTMENT
4-2/C #14
4-3/C #20
1-FO CABLE (6SM)

3 EB LARPEN TEUR STA. 17+91, 26' RT
PEDESTAL FOUNDATION
9' SIGNAL PEDESTAL POLE AND BASE (8' POLE PLUS BASE)
TYPE 4A BRACKETING
1-C.D. PED HEAD
1-APS PB AND SIGN (LT ARROW) (PB2-1)
1-R9-3 SIGN (NO PED) FACING POLE 4
1-R6-1R SIGN (ONE WAY)
1-R6-1L SIGN (ONE WAY)
EXTEND INTO HH 6:
3" PVC
1-4/C #14
1-2/C #14
1-1/C #6 INS. GR.

SIGNAL SYSTEM OPERATION

- THE SIGNAL SYSTEM FLASH MODE IS ALL RED.
- NORMAL OPERATION IS 4 PHASE, WITH PHASE 5 BEING A PROTECTED/PERMISSIVE LEFT TURN PHASE.
- PHASES 2 AND 6 SHALL BE ON VEHICLE RECALL.

1 WB LARPEN TEUR STA 18+33, 33' LT
PA90 POLE FOUNDATION
TYPE PA90-A-35
1-ANGLE MOUNT SIGNAL OVERHEAD AT 0'
1-STRAIGHT MOUNT SIGNAL OVERHEAD AT 11'
2-ANGLE MOUNT SIGNALS AT 90 AND 180 DEG
1-ANGLE MOUNT C.D. PED HEAD AT 90 DEG
1-ONE WAY EVP DETECTOR AND CONFIRMATORY LIGHT (PHASE 8)
1-ONE WAY EVP DETECTOR (PHASES 1+6 WR ADVANCE)
RADIO INTERCONNECT ANTENNA (SEE NOTE 10)
1-APS PB AND SIGN (LT ARROW) (PB6-1)
1-R9-3 SIGN (NO PED) FACING POLE 2
1-R6-1R SIGN (ONE WAY)
1-R6-1L SIGN (ONE WAY)
1-TYPE D SIGN (D-1)
EXTEND INTO HH 1:
3" PVC
2-12/C #14
1-4/C #14
1-3/C #14
1-2/C #14
2-3/C #20
1-RADIO COAXIAL CABLE
1-1/C #6 INS. GR.

TO TMS FO SPLICE VAULT
1 1/2" PVC
1-FO CABLE (6SM)
(SEE TMS PLAN)

2" PVC
2-2/C #14

6 EVP
1+6 EVP (WR)
8 EVP (WR)

2+5 EVP

2" PVC
3-2/C #14

4" PVC
2-12/C #14
1-4/C #14
1-3/C #14
1-3/C #14 (LUM)
5-2/C #14
1-3/C #20
1-1/C #6 INS. GR.

2 EB LARPEN TEUR STA. 18+76, 28' RT
PA90 POLE FOUNDATION
TYPE PA90-A-35-D40-9 (DAVIT AT 350 DEG)
1-ANGLE MOUNT SIGNAL OVERHEAD AT 0'
1-STRAIGHT MOUNT SIGNAL OVERHEAD AT 11'
1-ANGLE MOUNT SIGNAL AT 180 DEG
1-ANGLE MOUNT C.D. PED HEAD AT 180 DEG
1-ONE WAY EVP DETECTOR AND CONFIRMATORY LIGHT (PHASES 2+5)
LUMINAIRE-250W HPS
1-APS PB AND SIGN (RT ARROW) (PB2-2)
1-BLUE ENFORCEMENT LIGHT (EL2-1)
1-R10-12 SIGN (36 X 48) ADJACENT TO HEAD (2-3)
1-R9-3 SIGN (NO PED) FACING POLE 1
EXTEND INTO HH 3:
3" PVC
2-12/C #14
1-4/C #14
1-3/C #14
1-3/C #14 (LUM)
1-2/C #14
1-3/C #20
1-1/C #6 INS. GR.

A WB LARPEN TEUR STA. 18+50, 38' LT
EQUIPMENT PAD (SEE DETAIL SHEET)
SERVICE CABINET
MASTER CONTROLLER
CONTROLLER AND CABINET (STATE FURNISHED)
4" PVC TO HH 9:
2-12/C #14
2-4/C #14
1-3/C #14
8-2/C #14
3-3/C #20
1-1/C #6 INS. GR.

4" PVC TO HH 1:
4-12/C #14
2-4/C #14
2-3/C #14
8-2/C #14
2-3/C #20
1-RADIO COAXIAL CABLE
1-1/C #6 INS. GR.

2" AND 3" PVC STUBBED OUT (CAPPED BOTH ENDS)
3/4" PVC STUBBED OUT (CAPPED FOR TELEPHONE LINE)
1 1/2" PVC TO FO SPLICE VAULT:
1-FO PIGTAIL (6SM)
1 1/2" PVC TO HH 8:
1-FO PIGTAIL (6SM)
SERVICE CABINET TO CONTROLLER CABINET:
2" PVC
2-1/C #6
1-1/C #6 INS. GR.
SERVICE CABINET TO HH 10:
2" PVC
3-1/C #2
SERVICE CABINET TO HH 1:
2" PVC
2-3/C #14 (LUM)
HH 1 TO HH 9:
2" PVC
1-3/C #14 (LUM)
1-3/C #20

B SOP-45' WOOD POLE (XCEL ENERGY)
2" PVC RISER AND WEATHERHEAD
2" PVC INTO HH 10:
3-1/C #2

LOOP DETECTOR CHART

NUMBER	SIZE (FT)	LOCATION	STATUS
D2-1, D2-2	6x6	250	PVC
D5-1	2-6x6	20 & 50	PVC
D5-2	2-6x6	5 & 35	PVC
D6-1, D6-2	6x6	115	PVC
D8-1, D8-2, D8-3	6x6	120	SAW
D8-4	2-6x6	0 & 20	PVC
D8-5, D8-6	2-6x6	5 & 20	PVC

-ALL LOOP DETECTORS ARE PVC UNLESS NOTED OTHERWISE
-LOCATION: DISTANCE FROM CROSSWALK/STOP BAR IN FEET

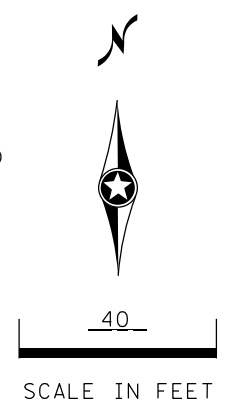

DISTRICT #: \$\$\$\$DISTRICT\$\$\$
 PLOT NAME: \$\$\$PLOTNAME\$\$\$
 PATH & FILENAME: \$\$\$PATHFILENAME\$\$\$
 PLOTTED/REVISED: \$\$\$DATE\$\$\$

PLOTTED/REVISED: \$\$\$@DATE@\$\$\$

DISTRICT #: \$\$\$@DISTRICT@\$\$
PLOT NAME: \$\$\$@PLOT\$NAME@\$\$
PATH & FILENAME: \$\$\$@PATH\$FILENAME@\$\$\$

CONTROLLER CABINET

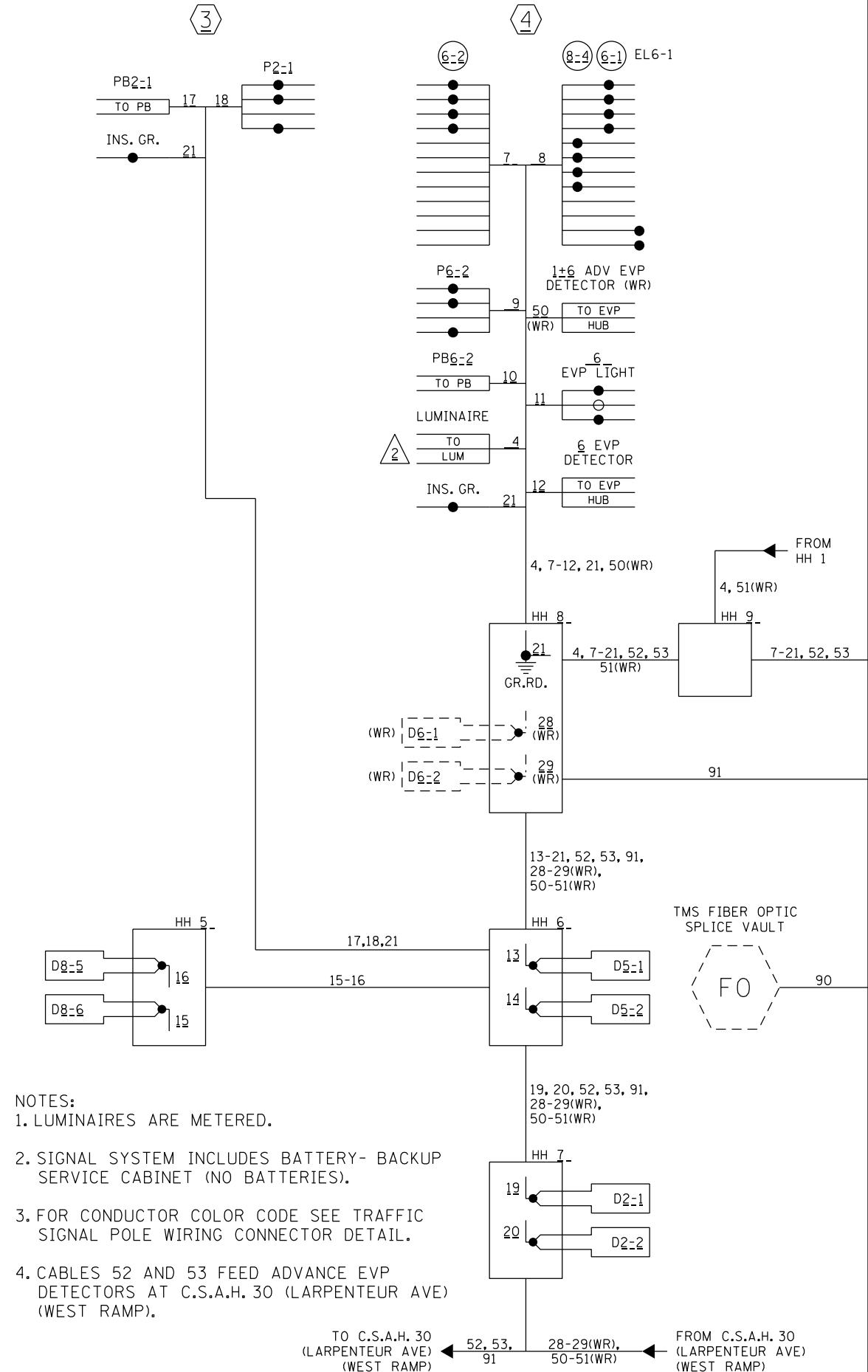
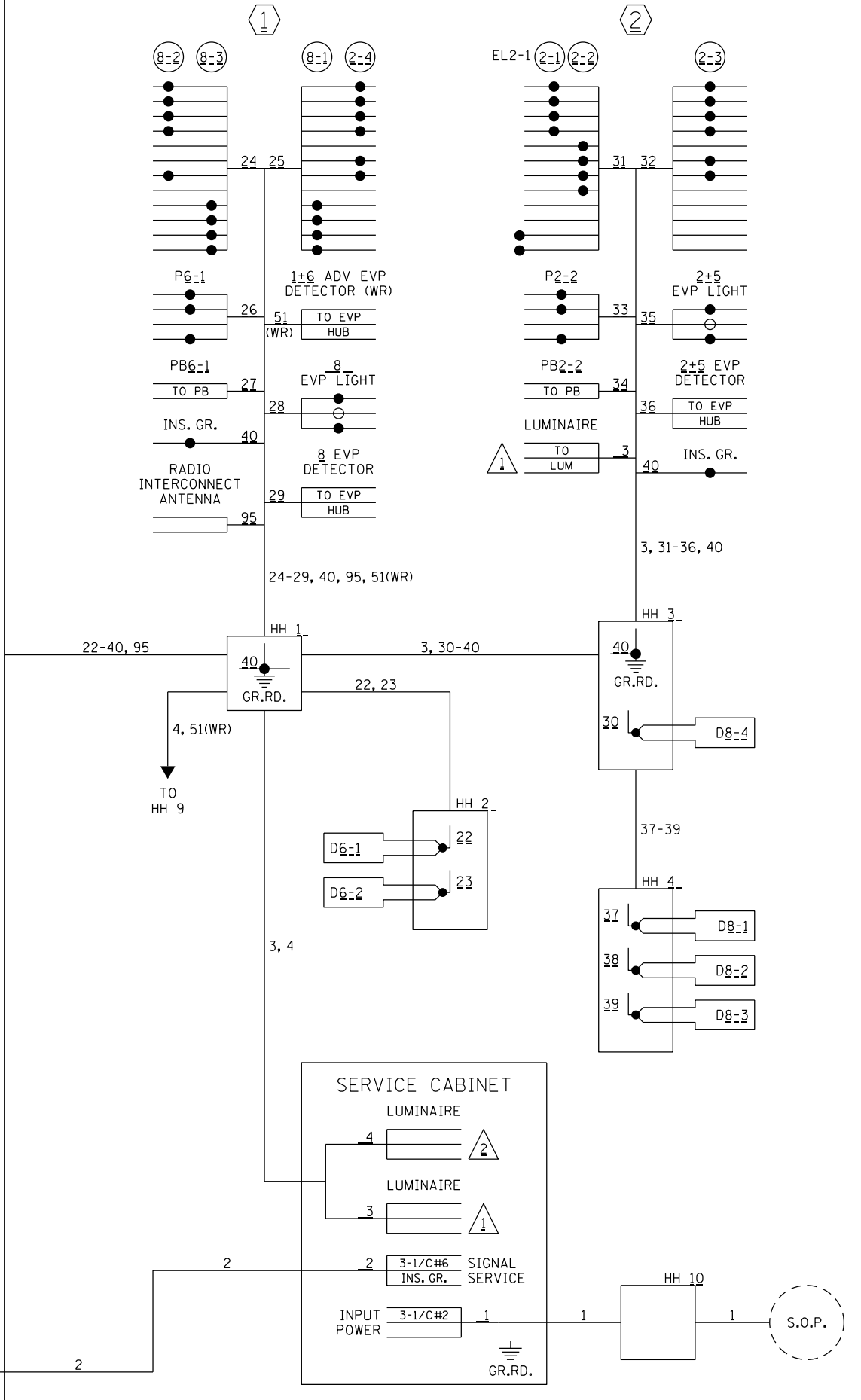
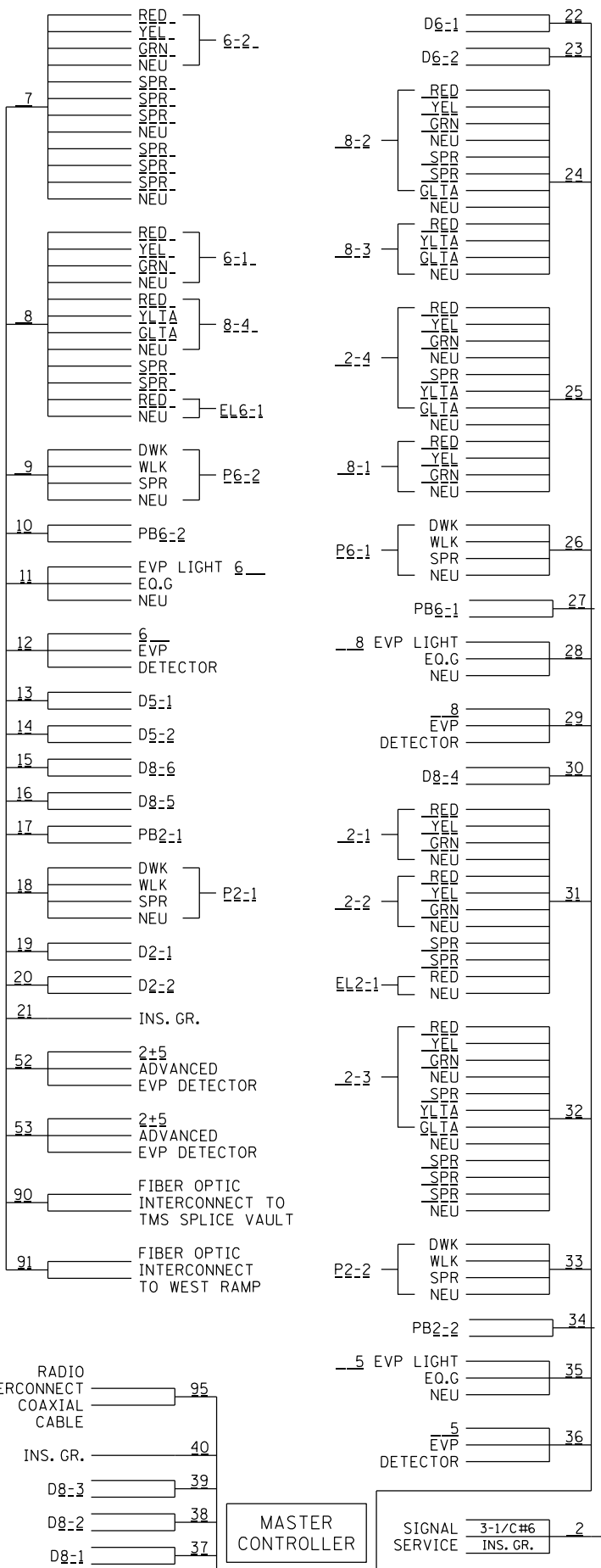

- NOTES:
- LUMINAIRES ARE METERED.
 - SIGNAL SYSTEM INCLUDES BATTERY- BACKUP SERVICE CABINET (NO BATTERIES).
 - FOR CONDUCTOR COLOR CODE SEE TRAFFIC SIGNAL POLE WIRING CONNECTOR DETAIL.
 - CABLES 52 AND 53 FEED ADVANCE EVP DETECTORS AT C.S.A.H. 30 (LARPEN TEUR AVE) (WEST RAMP).

BY	DATE	REVISIONS
GDS	10-29-10	AS BUILT- D8-1, D8-2, AND D8-3 ARE SAWCUT LOOPS
SJK	11-17-11	FIELD REVISIONS OF SP 6241-51
EJA	04-29-15	AS-BUILT OF SP 062-030-016 ENFORCEMENT LIGHTS ADDED

SYSTEM ID: 38721 T.E. 4689
 METER ADDRESS: 2619 LARPEN TEUR AVE, W
 MASTER ID: 38725 T.E. 4700

FIELD WIRING DIAGRAM EAST RAMP
 T.H. 280 AT C.S.A.H. 30 (LARPEN TEUR AVE.)
 IN LAUDERDALE, RAMSEY COUNTY

PLOTTED/REVISED: 10/29/2010

DISTRICT #: METRO
I/PLOT NAME: Interconnect
PATH & FILENAME: IP_PWP-d078376VT38721L.sgl.dgn

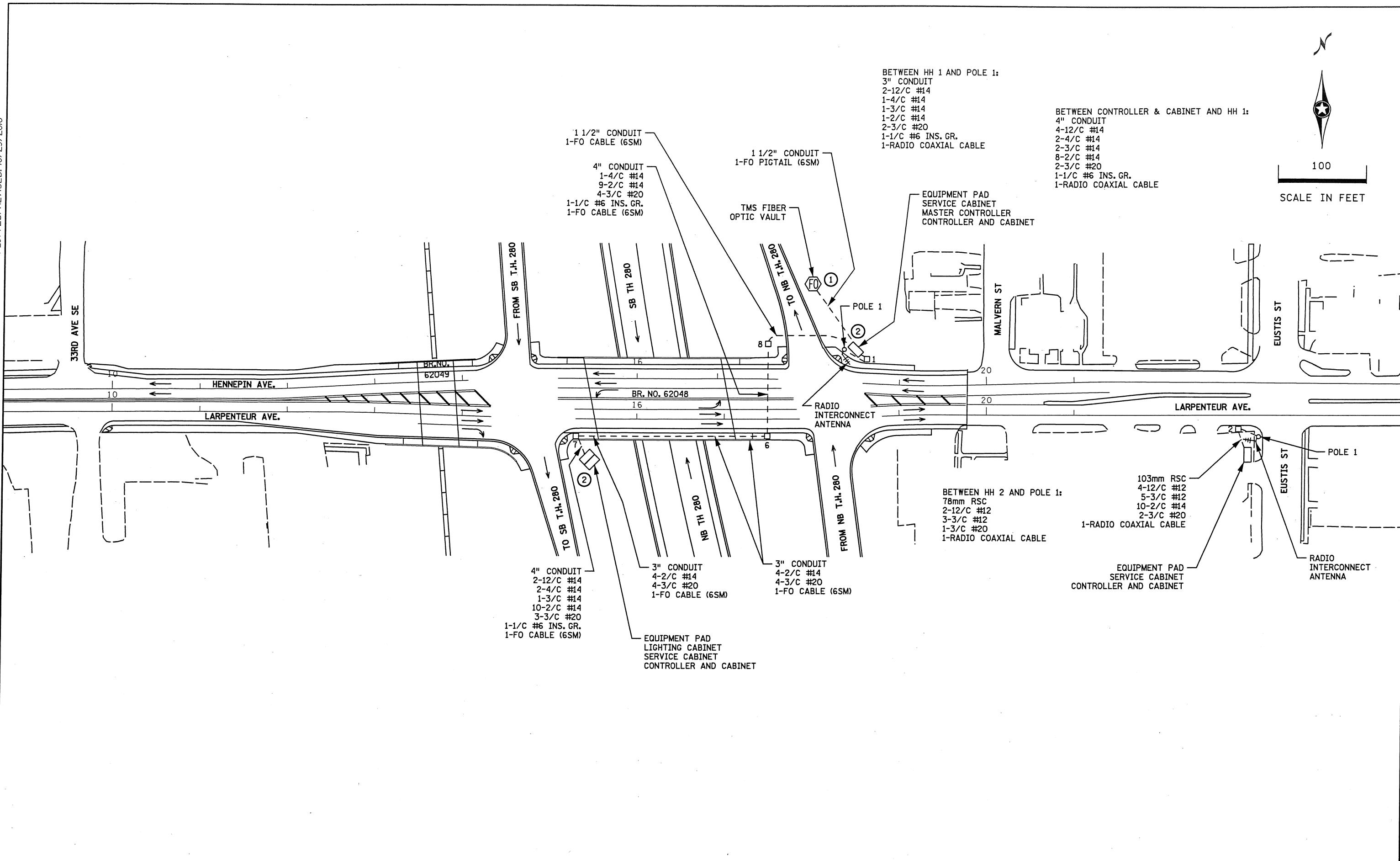

100
SCALE IN FEET

BY	DATE	REVISIONS
GDS	10-29-10	AS BUILT

SYSTEM ID: 38721, 38722, 38808

INTERCONNECT LAYOUT
T.H. 280 BETWEEN LARPENTEUR AVE.
/HENNEPIN AVE. TO EUSTIS ST.
IN LAUDERDALE, RAMSEY COUNTY

S.A.P. NO. 62-630-53	DRAWN BY:GDS	CKD BY:EJA	DATE:12-22-08
CERTIFIED BY _____		LIC. NO. 19863	DATE: 12-22-08
STATE PROJ.NO. 6241-51 (T.H.280)		SHEET NO. 400 OF 503 SHEETS	