

PLOTTED/REVISED: 4/20/2011

DISTRICT #: METRO
PLOT NAME: INTERSECTION
PATH & FILENAME: IP_PWP-d138252N21520_SGL.dgn

- (A) EQUIPMENT PAD**
 CONTROLLER & CABINET
 4" RSC TO HH-1 4" RSC TO HH-13
 6-12/C#12 5-12/C#12
 6-3/C#12 7-3/C#12
 10-2/C#14 11-2/C#14
 2-3/C#20 2-3/C#20
 1-6PR#19 2-6PR#19

- F&I: 3-2/C#14** **F&I: 1-2/C#14**
(B) S.O.P.-WOOD POLE
 2" RSC TO INP.-HH-1
 3-1/C#0
 2" RSC RISER & WEATHERHEAD
 3-1/C#0

- (B) S.O.P.-WOOD POLE**
 2" RSC TO INP.-HH-1
 3-1/C#0
 2" RSC RISER & WEATHERHEAD
 3-1/C#0

LOOP DETECTORS			
DESIGNATION	NO. & SIZE/FT.	LOCATION	STATUS
D1-1,D1-2	2-6'X6'	10' AND 40'	INPLACE
D2-1,D2-2	1-6'X6'	475'	INPLACE
D3-1	2-6'X6'	10' AND 40'	INPLACE
D4-1,D4-2	1-6'X6'	120'	INPLACE
D4-3,D4-4	2-6'X6'	0' AND 14'	INPLACE
D4-5	1-6'X15'	0'	INPLACE
D5-1,D5-2	2-6'X6'	10' AND 40'	INPLACE
D6-1,D6-2	1-6'X6'	475'	INPLACE
D7-1,D7-2	2-6'X6'	10' AND 40'	INPLACE
D8-1,D8-2	1-6'X6'	120'	INPLACE
D8-3,D8-4	2-6'X6'	0' AND 14'	INPLACE
D8-3,D8-4	1-6'X6'	29'	F & I
D8-5	1-6'X15'	0'	INPLACE
D8-5	1-6'X6'	24'	F & I

-LOCATION: DISTANCE FROM CROSSWALK/STOP LINE IN FEET
 -ALL LOOP DETECTORS SHALL BE IN NMC CONDUIT, EXCEPT LOOPS IN EXISTING CONCRETE PAVEMENT WHICH SHALL BE SANCUIT.

LED SIGNAL INDICATIONS			
SIGNAL FACE	R	Y	G
1-1,1-2	←	←	←
2-1,2-2,2-3	●	●	●
3-1,3-2	←	←	←
4-1,4-2,4-3,4-4	●	●	●
5-1,5-2	←	←	←
6-1,6-2,6-3,6-4	●	●	●
7-1,7-2	←	←	←
8-1,8-2,8-3,8-4	●	●	●

-ALL VEHICLE SIGNAL INDICATIONS SHALL BE 12"
 -EACH SIGNAL FACE SHALL HAVE A BACKGROUND SHIELD

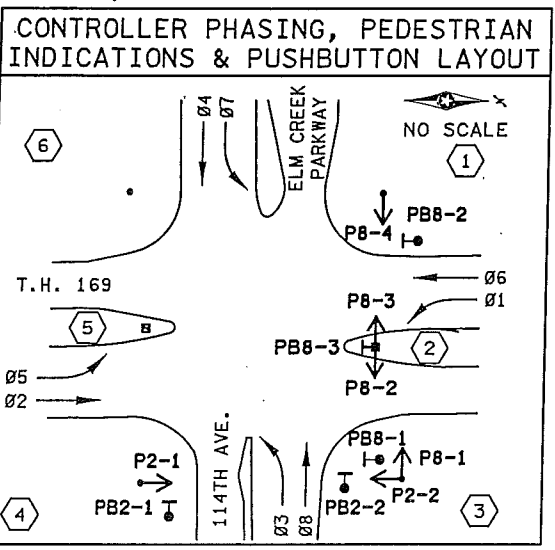

- SIGNAL OPERATION NOTES**
- FLASH MODE SHALL BE ALL RED
 - Ø2 & Ø6 SHALL BE ON VEHICLE RECALL
 - Ø1 & Ø5 SHALL BE PROTECTED LEFT TURNS
 - Ø3 & Ø7 SHALL BE PROTECTED LEFT TURNS

- NOTES:**
1. ALL ITEMS ARE INPLACE UNLESS NOTED.
 2. THE EXACT LOCATION OF PED CURB RAMPS, PED IND'S, PB'S, PED PB STA, AND LOOP DETECTORS SHALL BE DETERMINED IN THE FIELD BY MN/DOT TRAFFIC OFFICE PERSONNEL.
 3. FOR PED CURB RAMPS AND ASSOCIATED CONCRETE WORK SEE DETAILS.
 4. FOR PAVEMENT MARKINGS SEE DETAILS.
 5. REMOVE ALL PB'S AND PB SIGNS FROM POLES 1, 2, 3, 4, 5 AND 6.
 6. ALL NEW PED IND SHALL BE C.D. PED IND.
 7. ADD PED PB STA WITH SIGNS NEAR POLES 1, 3 AND 4.
 8. ADD LOOP DETECTORS D8-3, D8-4 AND D8-5.
 9. ADJUST HH 6.

BY	DATE	REVISIONS	SYSTEM ID: 21520	T.E. 5373	S.A.P. NO.	DRAWN BY: MAS	CKD BY: BTJ	DATE: 4-21-11
		REVISED AT MN/DOT BY: J.D.P. 02-14-06	METER ADDRESS: 11401 T.H. 169		CERTIFIED BY: <i>Michael P. Selinsky</i>		LIC. NO. 19863	DATE: 4-21-11
		UPDATED: RELABELED PHASES 5 & 1 LOOPS.	MASTER ID:	T.E.	STATE PROJ. NO. 8825-393		SHEET NO. 80 OF 122 SHEETS	

**INTERSECTION LAYOUT
REVISE SIGNAL SYSTEM G
T.H. 169 AT ELM CREEK PARKWAY & 114TH AVE
IN CHAMPLIN, HENNEPIN COUNTY**

PLOTTED/REVISED: 4/20/2011

DISTRICT #: METRO
PLOT NAME: POLE NOTES
PATH & FILENAME: IP_PWP-d138252121520_SGL.dgn

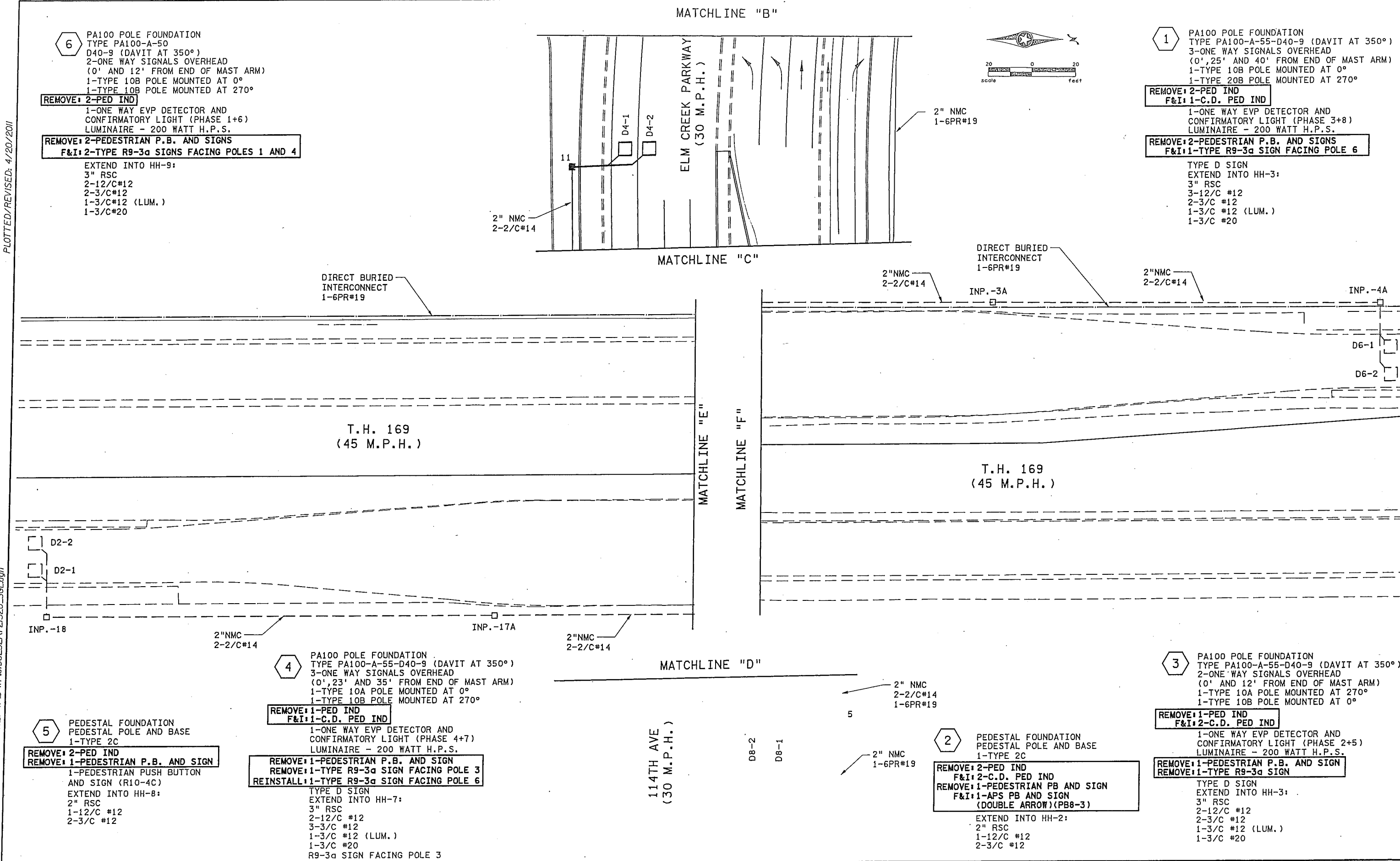

6 PA100 POLE FOUNDATION
 TYPE PA100-A-50
 D40-9 (DAVIT AT 350°)
 2-ONE WAY SIGNALS OVERHEAD
 (0' AND 12' FROM END OF MAST ARM)
 1-TYPE 10B POLE MOUNTED AT 0°
 1-TYPE 10B POLE MOUNTED AT 270°

REMOVE: 2-PED IND
 1-ONE WAY EVP DETECTOR AND
 CONFIRMATORY LIGHT (PHASE 1+6)
 LUMINAIRE - 200 WATT H.P.S.

REMOVE: 2-PEDESTRIAN P.B. AND SIGNS
F&I: 2-TYPE R9-3a SIGNS FACING POLES 1 AND 4

EXTEND INTO HH-9:
 3" RSC
 2-12/C#12
 2-3/C#12
 1-3/C#12 (LUM.)
 1-3/C#20

1 PA100 POLE FOUNDATION
 TYPE PA100-A-55-D40-9 (DAVIT AT 350°)
 3-ONE WAY SIGNALS OVERHEAD
 (0', 25' AND 40' FROM END OF MAST ARM)
 1-TYPE 10B POLE MOUNTED AT 0°
 1-TYPE 20B POLE MOUNTED AT 270°

REMOVE: 2-PED IND
F&I: 1-C.D. PED IND
 1-ONE WAY EVP DETECTOR AND
 CONFIRMATORY LIGHT (PHASE 3+8)
 LUMINAIRE - 200 WATT H.P.S.

REMOVE: 2-PEDESTRIAN P.B. AND SIGNS
F&I: 1-TYPE R9-3a SIGN FACING POLE 6

TYPE D SIGN
 EXTEND INTO HH-3:
 3" RSC
 3-12/C #12
 2-3/C #12
 1-3/C #12 (LUM.)
 1-3/C #20

5 PEDESTAL FOUNDATION
 PEDESTAL POLE AND BASE
 1-TYPE 2C

REMOVE: 2-PED IND
REMOVE: 1-PEDESTRIAN P.B. AND SIGN
 1-PEDESTRIAN PUSH BUTTON
 AND SIGN (R10-4C)
 EXTEND INTO HH-8:
 2" RSC
 1-12/C #12
 2-3/C #12

4 PA100 POLE FOUNDATION
 TYPE PA100-A-55-D40-9 (DAVIT AT 350°)
 3-ONE WAY SIGNALS OVERHEAD
 (0', 23' AND 35' FROM END OF MAST ARM)
 1-TYPE 10A POLE MOUNTED AT 0°
 1-TYPE 10B POLE MOUNTED AT 270°

REMOVE: 1-PED IND
F&I: 1-C.D. PED IND
 1-ONE WAY EVP DETECTOR AND
 CONFIRMATORY LIGHT (PHASE 4+7)
 LUMINAIRE - 200 WATT H.P.S.

REMOVE: 1-PEDESTRIAN P.B. AND SIGN
REMOVE: 1-TYPE R9-3a SIGN FACING POLE 3
REINSTALL: 1-TYPE R9-3a SIGN FACING POLE 6

TYPE D SIGN
 EXTEND INTO HH-7:
 3" RSC
 2-12/C #12
 3-3/C #12
 1-3/C #12 (LUM.)
 1-3/C #20
 R9-3a SIGN FACING POLE 3

2 PEDESTAL FOUNDATION
 PEDESTAL POLE AND BASE
 1-TYPE 2C

REMOVE: 2-PED IND
F&I: 2-C.D. PED IND
REMOVE: 1-PEDESTRIAN PB AND SIGN
F&I: 1-APS PB AND SIGN
 (DOUBLE ARROW)(PB8-3)

EXTEND INTO HH-2:
 2" RSC
 1-12/C #12
 2-3/C #12

3 PA100 POLE FOUNDATION
 TYPE PA100-A-55-D40-9 (DAVIT AT 350°)
 2-ONE WAY SIGNALS OVERHEAD
 (0' AND 12' FROM END OF MAST ARM)
 1-TYPE 10A POLE MOUNTED AT 270°
 1-TYPE 10B POLE MOUNTED AT 0°

REMOVE: 1-PED IND
F&I: 2-C.D. PED IND
 1-ONE WAY EVP DETECTOR AND
 CONFIRMATORY LIGHT (PHASE 2+5)
 LUMINAIRE - 200 WATT H.P.S.

REMOVE: 1-PEDESTRIAN P.B. AND SIGN
REMOVE: 1-TYPE R9-3a SIGN

TYPE D SIGN
 EXTEND INTO HH-3:
 3" RSC
 2-12/C #12
 2-3/C #12
 1-3/C #12 (LUM.)
 1-3/C #20

BY	DATE	REVISIONS	SYSTEM ID: 21520	T.E. 5373	POLE NOTES AND MATCHLINE LAYOUT REVISE SIGNAL SYSTEM G T.H. 169 AT ELM CREEK PARKWAY & 114TH AVE IN CHAMPLIN, HENNEPIN COUNTY	S.A.P. NO.	DRAWN BY: MAS	CKD BY: BTJ	DATE: 4-21-11
			METER ADDRESS: 11401 T.H. 169			CERTIFIED BY: <i>Michael P. Delaney</i> LICENSED PROFESSIONAL ENGINEER	LIC. NO. 19863	DATE: 4-21-11	
			MASTER ID:	T.E.		STATE PROJ. NO. 8825-393	SHEET NO. 81	OF 122 SHEETS	

PLOTTED/REVISED: 4/20/2011

DISTRICT #: METRO
IPLOT NAME: WIRING
PATH & FILENAME: IP_FWP-d\38252AT\21520_SGL.dgn

CONDUCTOR COLOR CODING

R	BLK	3/C#12
O	WH	
BL	R	
WH	YEL	3/C#20
R/BLK	BL	
O/BLK	O	
BL/BLK	BLK	2/C#14
WH/BLK	CLR	
BLK	BLK	
BLK/WH	WH	2-1/C#6
G/BLK		
G		

NOTE: ALL TERMINAL BLOCK CONNECTIONS SHALL BE ARRANGED AS SPECIFIED ABOVE.

NAME: 4252.WDD DATE: Jan. 07, 2002

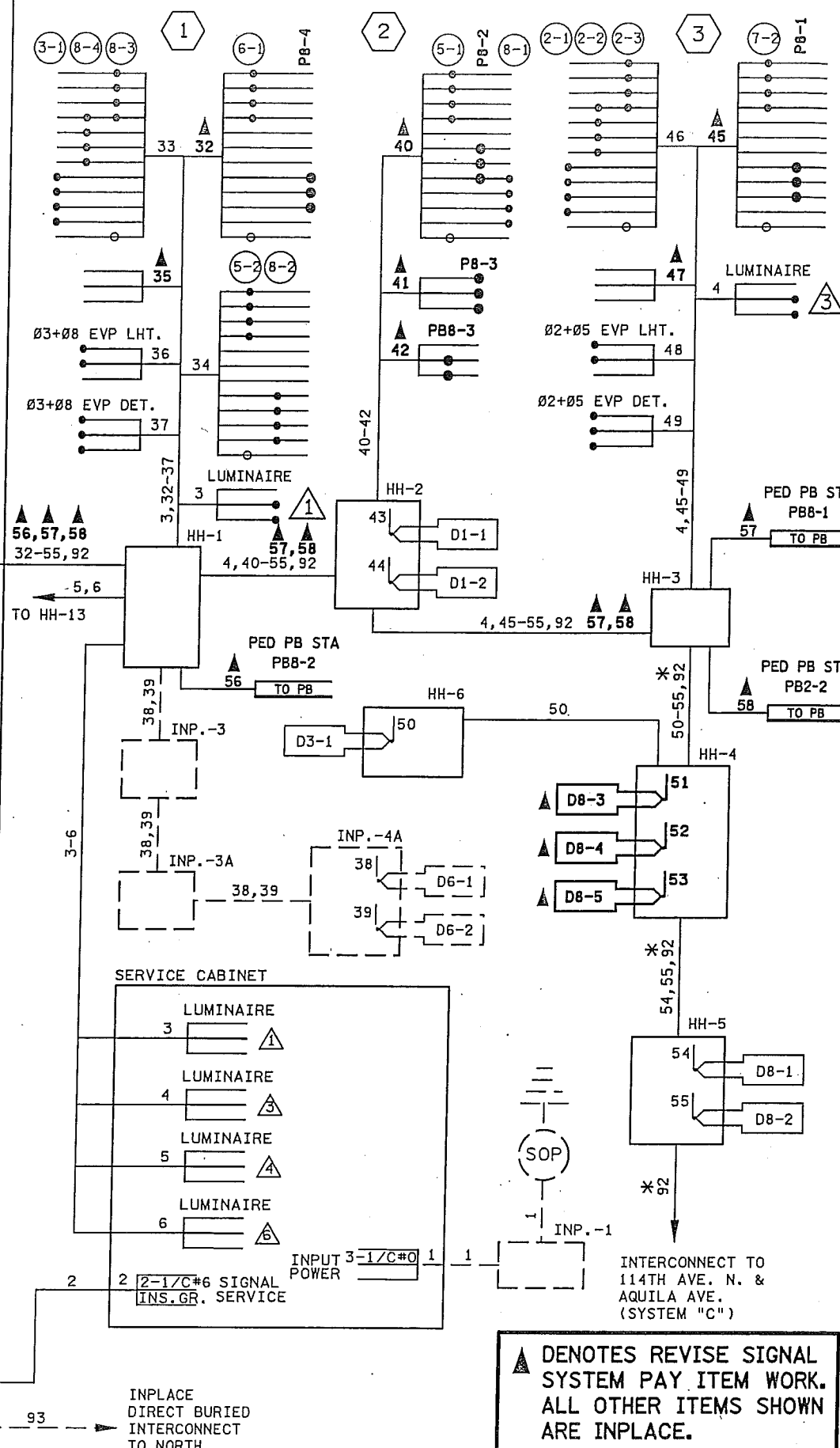
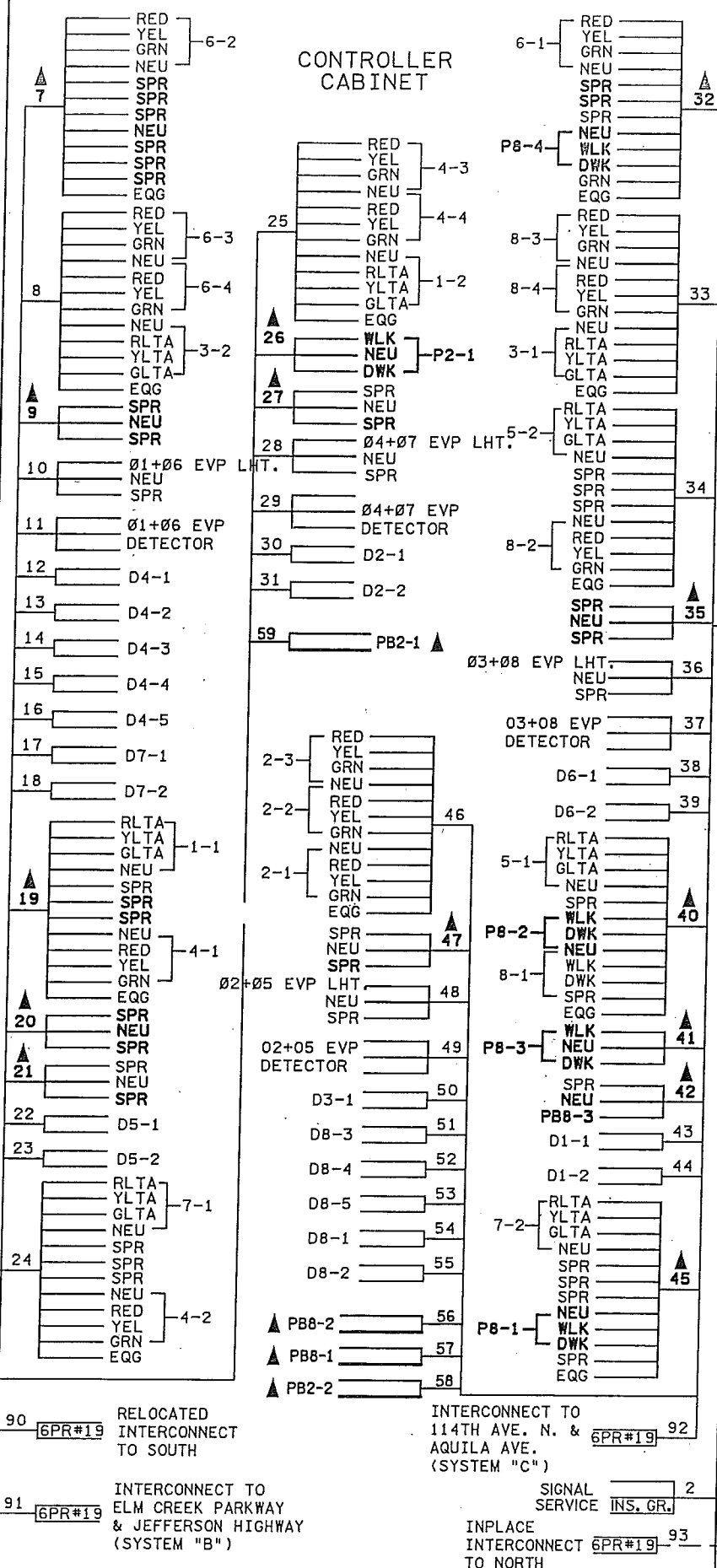
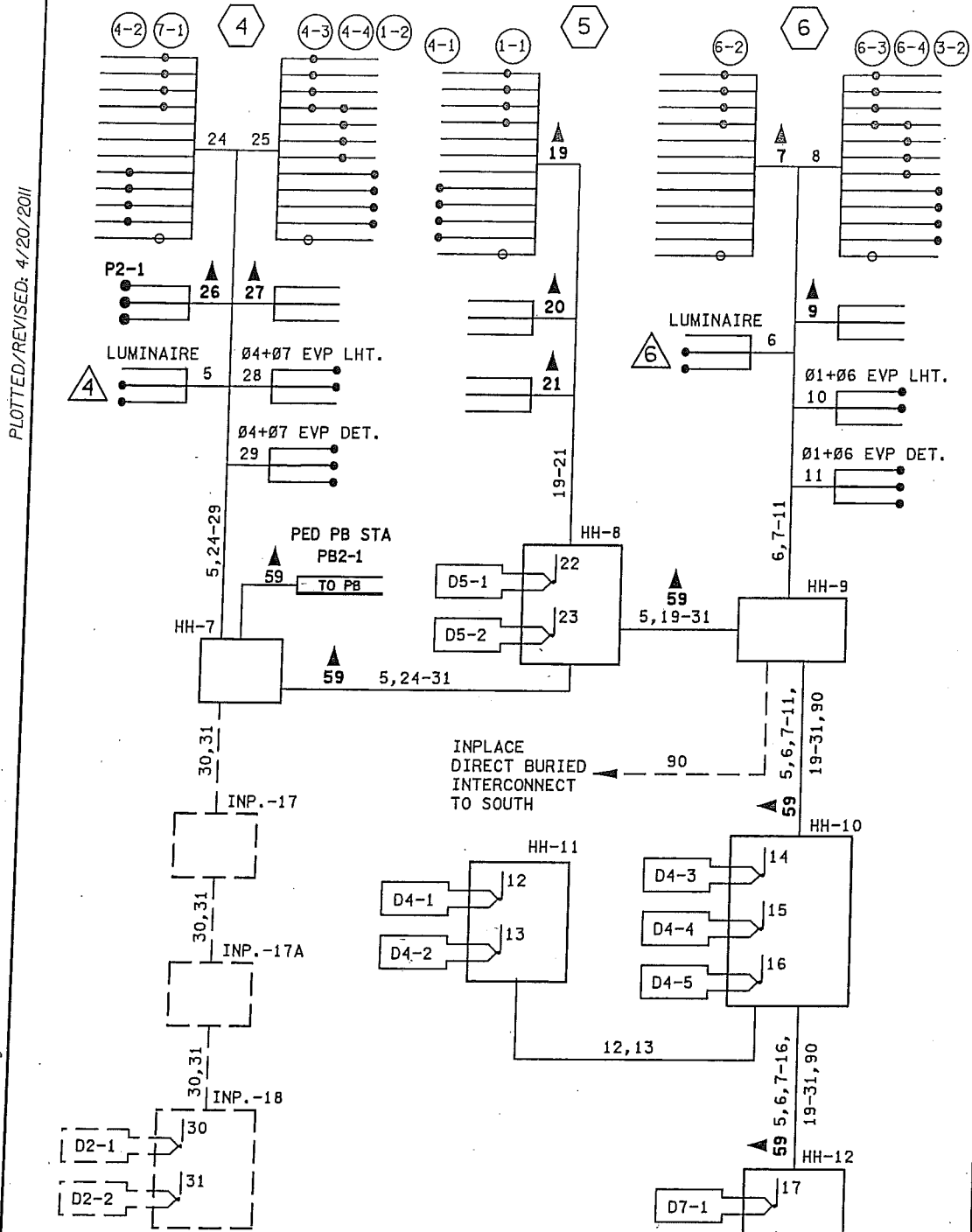

▲ DENOTES REVISE SIGNAL SYSTEM PAY ITEM WORK. ALL OTHER ITEMS SHOWN ARE INPLACE.

BY	DATE	REVISIONS	SYSTEM ID: 21520	T.E. 5373	WIRING DIAGRAM LAYOUT	S.A.P. NO.	DRAWN BY: MAS	CKD BY: BTJ	DATE: 4-21-11
			METER ADDRESS: 11401 T.H. 169		REVISE SIGNAL SYSTEM G	CERTIFIED BY: <i>Michael P. Lubinsky</i>			DATE: 4-21-11
			MASTER ID:	T.E.	T.H. 169 AT ELM CREEK PARKWAY & 114TH AVE IN CHAMPLIN, HENNEPIN COUNTY	STATE PROJ. NO. 8825-393	LIC. NO. 19863		DATE: 4-21-11
						SHEET NO. 82 OF 122 SHEETS			