

LOOP DETECTORS

DESIGNATION	SIZE(FT)	LOCATION	TYPE
D1-1	6 x 15	0	PVC
D2-1, D2-2	6 x 6	120	PVC
D4-1, D4-2	6 x 6	120	SAW CUT
D4-3	6 x 15	3	PVC
D4-4	6 x 6	0	PVC
D6-1		120 (1)	(2)
D6-2, D6-3	6 x 6	80	PVC

SIGNAL HEAD CHART

FACE	R	Y	G	RLTA	YLTA	GLTA
2-1	○	○	○			
2-2	○	○	○			
2-3	○	○	○			
6-1	○	○	○			
6-2	○	○	○		◀	◀
6-3	○	○	○		◀	◀
4-1	○	○	○			
4-2	○	○	○			
4-3	○	○	○			

LOCATION:
DISTANCE FROM CROSS WALK OR STOP BAR TO THE FRONT OF DETECTOR IN FT.

(1) DETECTION DISTANCE AND NOT PHYSICAL LOCATION OF THE UNIT.
(2) TC-26B MICROWAVE

NOTE: 1. ALL SIGNAL INDICATIONS ARE 12" LEDS.
2. EACH SIGNAL HEAD HAS A BACKGROUND SHIELD.

② PA90 POLE FOUNDATION
TYPE P90-A-25-D40-9 (DAVIT @ 350 DEG)
1-ONE WAY SIGNAL OVERHEAD AT 0'
TYPE 10B AT 180 DEG
TYPE 30A AT 90 DEG
2-CD PED HEADS AT 90 AND 180 DEG
R10-12 SIGN (ADJACENT TO HEAD 6-2)
ONE WAY-EVP DETECTOR AND CONFIRMATORY LIGHT (6&1)
LUMINAIRE 250W HPS
TYPE "D" SIGN PANEL
1-APS PB AND SIGN (LT ARROW) (PB4-1)
EXTEND INTO HH 4:
3" RSC
2-12/C#12
3-3/C#12
1-3/C#12(LUM)
1-3/C#20



③ PEDESTAL FOUNDATION
14" PEDESTAL POLE PLUS BASE
TYPE 5B
1-CD PED HEAD
R9-3 SIGN (FACING POLE 4)
TYPE TC-26B MICROWAVE DETECTOR
EXTEND INTO HH 6:
3" RSC
1-12/C#12
1-4/C#18

PEDESTAL FOUNDATION
1-APS PB AND SIGN (RT ARROW) (PB6-1)
EXTEND INTO HH 6:
2" PVC
1-2/C#14

① XCEL ENERGY WOOD POLE
120/240 SERVICE
2" RSC RISER AND WEATHERHEAD WITH 3-1/C#2
EXTEND INTO HH 12
2" RSC WITH 3-1/C#2

PED PB STATION
1-APS PB AND SIGN (RT ARROW) (PB6-2)
EXTEND INTO HH 4:
2" PVC
1-2/C#14

3" RSC
3-12/C#12
4-3/C#12
1-3/C#20
9-2/C#14
1-4/C#18

TYPE TC-26B MICROWAVE DETECTOR

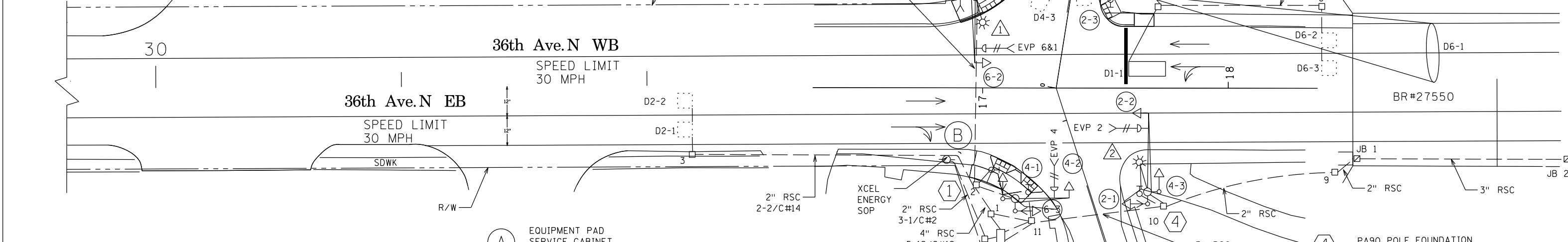

CONTROLLER PHASING, PEDESTRIAN INDICATIONS AND PUSH BUTTONS

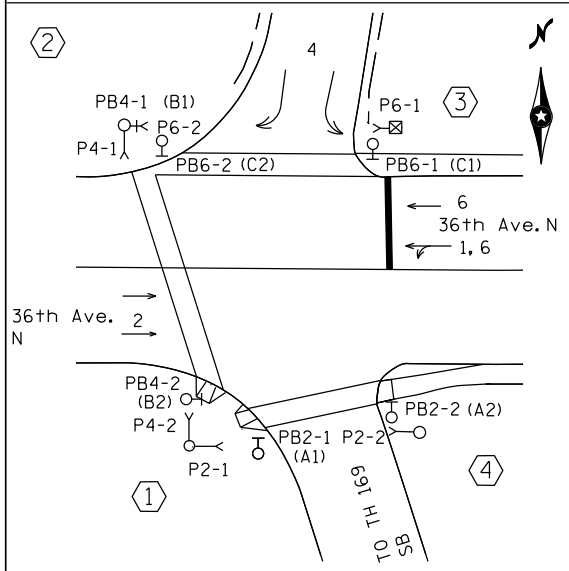

SIGNAL HEAD PHASING

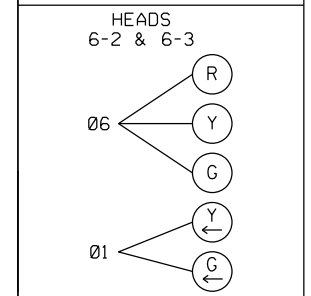

SIGNAL SYSTEM OPERATION
- THE SIGNAL SYSTEM FLASH MODE IS ALL RED.
- NORMAL OPERATION IS 4 PHASE, WITH PHASE 1 BEING PROTECTED/PERMISSIVE LEFT TURN AND PHASES 2 & 6 ON VEHICLE RECALL.

① EQUIPMENT PAD
SERVICE CABINET
CONTROLLER AND CABINET
CONTROLLER CABINET TO HH 1
4" RSC
5-12/C#12
6-3/C#12
2-3/C#20
12-2/C#14
1-4/C#18

PED PB STATION
1-APS PB AND SIGN (RT ARROW) (PB4-2)
EXTEND INTO HH 2:
2" PVC
1-2/C#14

① PA90 POLE FOUNDATION
TYPE P90-A-20
1-ONE WAY SIGNAL OVERHEAD AT 0' (FROM END OF MAST ARM)
2-TYPE 10B AT 90 AND 180 DEG
2-CD PED HEADS AT 90 AND 180 DEG
ONE WAY-EVP DETECTOR AND CONFIRMATORY LIGHT (4)
TYPE "D" SIGN PANEL (D-1)
EXTEND INTO HH 2
3" RSC
2-12/C#12
3-3/C#12
1-3/C#20

④ PA90 POLE FOUNDATION
TYPE P90-A-30-D40-9 (DAVIT @ 350 DEG)
1-ONE WAY SIGNALS OVERHEAD AT 0' (FROM END OF MAST ARM)
TYPE 10A AT 90 DEG
TYPE 10B AT 180 DEG
1-CD PED HEAD AT 180 DEG
R9-3 SIGN (FACING POLE 3)
ONE WAY-EVP DETECTOR AND CONFIRMATORY LIGHT (2)
LUMINAIRE 250W HPS
TYPE "D" SIGN PANEL
EXTEND INTO HH 10:
3" RSC
2-12/C#12
3-3/C#12
1-3/C#20

BY	DATE	REVISIONS	SYSTEM ID: 21513	T.E. 5793	S.A.P. NO.	DRAWN BY: MAS	CKD BY: GAK	DATE: 2/19/13
EJA	06-23-15	AS-BUILT OF SP 2772-92 APS AND CD PEDS ADDED	METER ADDRESS: 9605 35TH AVE. NO.		CERTIFIED BY	LIC. NO.	DATE:	
			MASTER ID: 22398	T.E.	STATE PROJ. NO.	(T.H.169)	SHEET NO.	1 OF 2 SHEETS

INTERSECTION LAYOUT
T.H. 169 AT 36TH AVENUE NORTH, WEST RAMPS
IN PLYMOUTH, HENNEPIN COUNTY

DISTRICT #: \$\$\$\$DISTRICT\$\$\$
 PLOT NAME: \$\$\$PLOTNAME\$\$\$
 PATH & FILENAME: \$\$\$PATHFILENAME\$\$\$
 PLOTTED/REVISED: \$\$\$DATE\$\$\$

PLOTTED/REVISED: \$\$\$@DATE@\$\$\$

DISTRICT #: \$\$@DISTRICT@\$
 IPLOT NAME: \$\$\$@PLOT\$NAME@\$\$
 PATH & FILENAME: \$\$\$@PATH\$FILENAME@\$\$\$

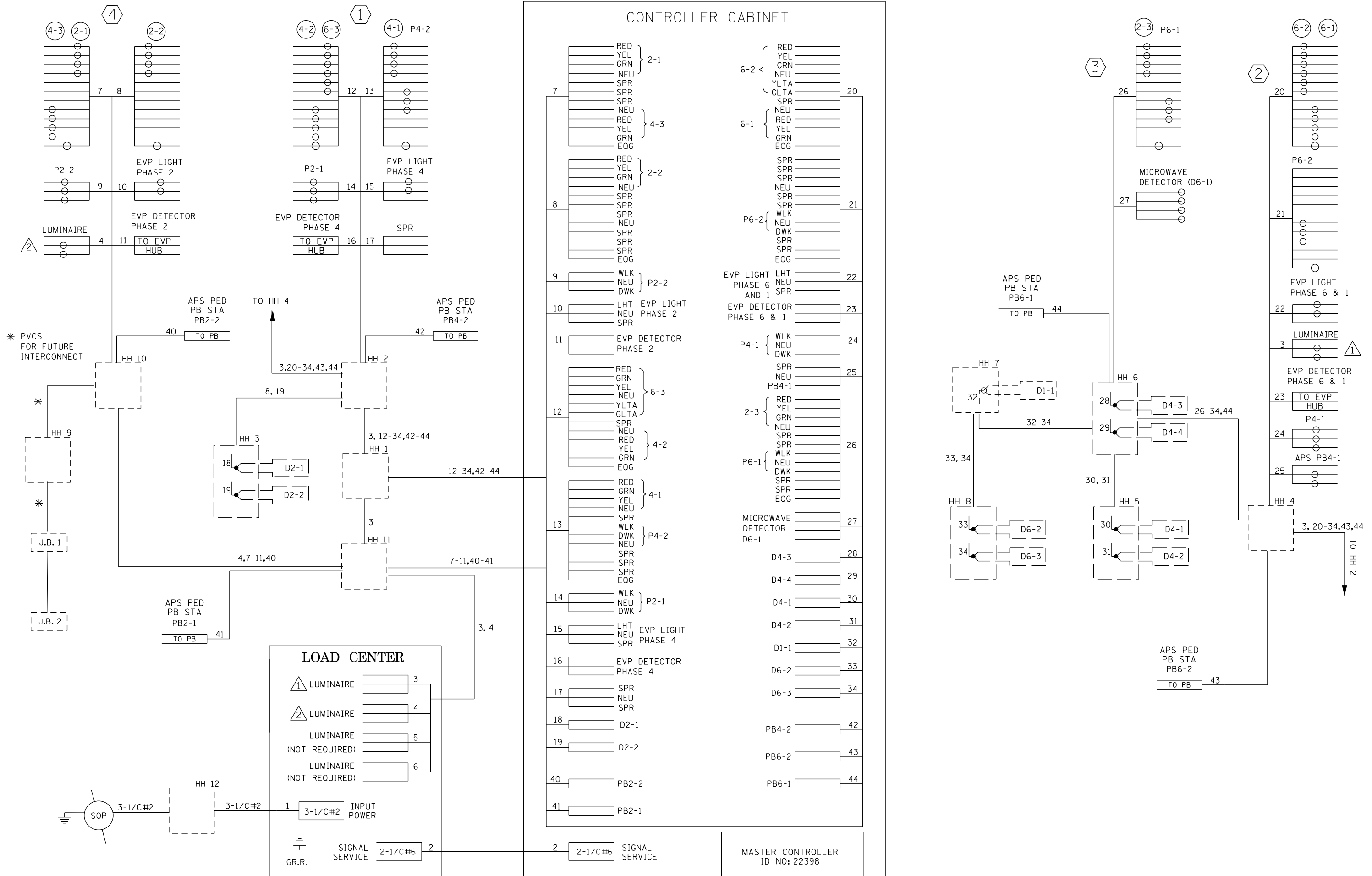

BY	DATE	REVISIONS	SYSTEM ID: 21513	T.E. 5793	S.A.P. NO.	DRAWN BY: MAS	CKD BY: GAK	DATE: 2/19/13
EJA	06-23-15	AS-BUILT OF SP 2772-92 APS AND CD PEDS ADDED	METER ADDRESS: 9605 35TH AVE. NO.		CERTIFIED BY _____ LIC. NO. _____ DATE: _____			
			MASTER ID: 22398	T.E.	STATE PROJ. NO. (T.H.169) SHEET NO. 2 OF 2 SHEETS			
WIRING DIAGRAM T.H.169 AT 36TH AVENUE NORTH, WEST RAMPS IN PLYMOUTH, HENNEPIN COUNTY								

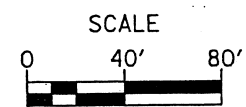

NOTE: SEE INTERSECTION LAYOUT ON SHEET NO. 5 AND "FOR INFORMATION ONLY" SHEET FOR ADDITIONAL CABLES IN CONDUIT.

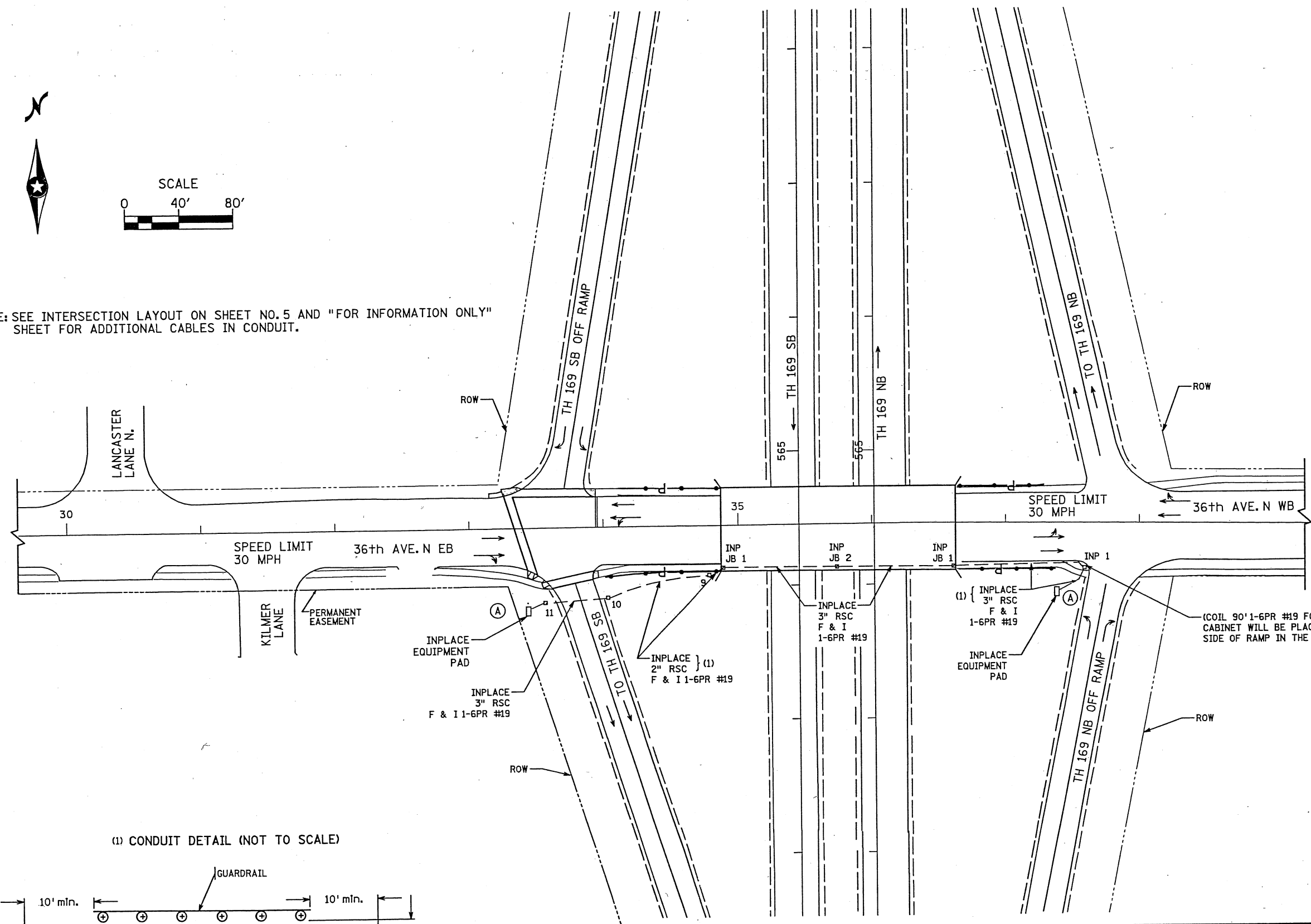

(1) CONDUIT DETAIL (NOT TO SCALE)

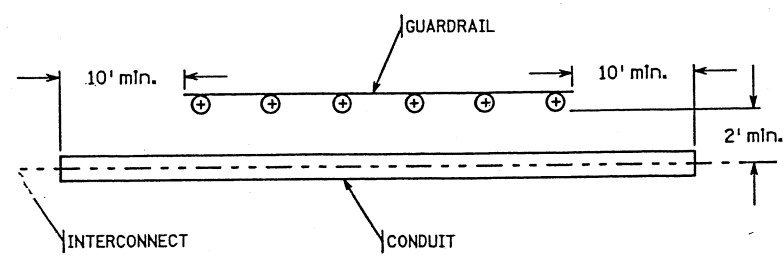

DRAWN BY: ABT	REVISED BY:	REVISED BY:	AS BUILT BY:
CHECKED: JEW DATE:	CHECKED: DATE:	CHECKED: DATE:	CHECKED: DATE:
MASTER ID 22398, TE. NO. 2307			
METER ADDRESS: 9455 36th Ave. N			

INTERCONNECTION LAYOUT
TRAFFIC CONTROL SIGNAL SYSTEM

T.H. 169 (RAMPS) AT 36th Ave. N
IN PLYMOUTH/NEW HOPE, HENNEPIN COUNTY

1
2
3
4
5
6
7
8
9
10
11
12
13
14
15
16
17
18
19
20
21
22
23
24
25
26
27
28
29
30
31
32
33
34
35
36
37
38
39
40
41
42
43
44
45
46
47
48
49
50
51
52
53
54
55
56
57
58
59
60
61
62
63
64
65
66
67
68
69
70
71
72

1
2
3
4
5
6
7
8
9
10
11
12
13
14
15
16
17
18
19
20
21
22
23
24
25
26
27
28
29
30
31
32
33
34
35
36
37
38
39
40
41
42
43
44
45
46
47
48
49
50
51
52
53
54
55
56
57
58
59
60
61
62
63
64
65
66
67
68
69
70
71
72

F-169.77

FIBER OPTIC CABLE MARKINGS @
 SPLICE ENCLOSURE
 VAULT ENTRY

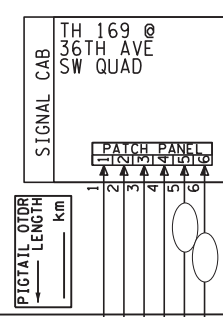
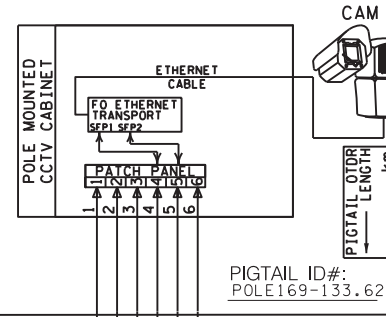
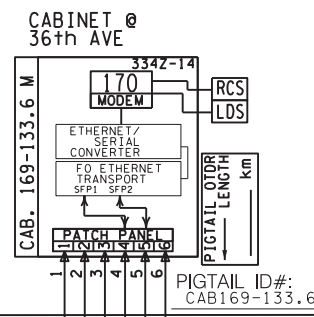
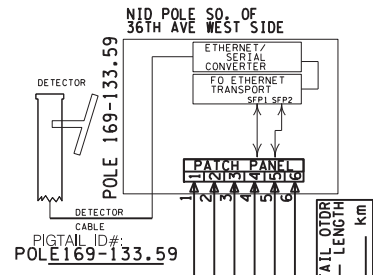

FIBER OPTIC CABLE MARKINGS @
 SPLICE ENCLOSURE
 VAULT ENTRY

OTDR LENGTH
 TO SHELTER

OTDR LENGTH
 TO SHELTER

VAULT @
 36th AVE SW QUAD

REV. NO.	DATE: 2/25/20
REV. NO.	DATE: / /

CERTIFIED BY *Michael P. Manly*
 LICENSED PROFESSIONAL ENGINEER

LIC. NO. 43957 FEB 28 2023

STATE PROJ. NO. 2772-124 (TH 169) SHEET NO. SZ23 OF SZ30 SHEETS