

PVC LOOP DETECTOR CHART		
NUMBER	SIZE (FT)	LOCATION
D1-1	6' X 6'	20'
D1-2	2-6' X 6'	5' & 36'
D2-1, D2-1	6' X 6'	120'
D3-1	2-6' X 6'	5' & 20'
D4-1	6' X 6'	120'
D4-2	6' X 6'	21'
D4-3	6' X 6'	5'
D5-1	6' X 6'	20'
D5-2	2-6' X 6'	5' & 36'
D6-1, D6-2	6' X 6'	122'
D7-1	2-6' X 6'	5' & 20'
D8-1	6' X 6'	120'
D8-2	2-6' X 6'	5' & 21'
D8-3	6' X 6'	-3'

-LOCATION: DISTANCE FROM CROSSWALK/STOP BAR IN FEET

SIGNAL HEAD CHART						
FACE	R	Y	G	Y	G	
2-1, 2-2	○	○	○			
2-3, 2-4	○	○	○	◀	◀	
4-1	○	○	○			
4-2, 4-3	○	○	○	◀	◀	
6-1, 6-2	○	○	○			
6-3, 6-4	○	○	○	◀	◀	
8-1	○	○	○			
8-2, 8-3	○	○	○	◀	◀	

-ALL SIGNAL INDICATIONS ARE 12" LEDS
-ALL SIGNAL FACES HAVE A BACKGROUND SHIELD

PLOTTED/REVISED: \$\$\$DATE\$\$\$

DISTRICT #: \$\$\$DISTRICT\$\$\$
PLOT NAME: \$\$\$PLOTNAME\$\$\$
PATH & FILENAME: \$\$\$PATHFILENAME\$\$\$

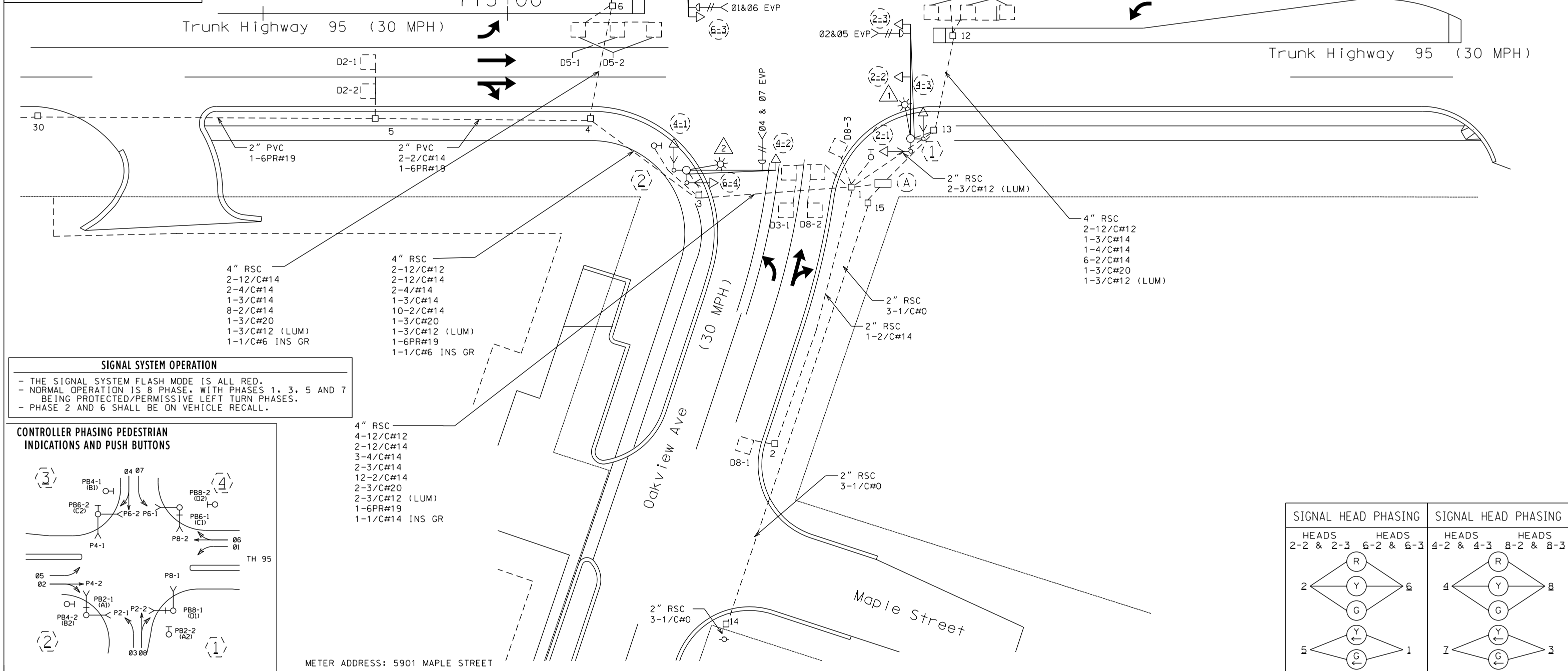

SIGNAL SYSTEM OPERATION

- THE SIGNAL SYSTEM FLASH MODE IS ALL RED.
- NORMAL OPERATION IS 8 PHASE, WITH PHASES 1, 3, 5 AND 7 BEING PROTECTED/PERMISSIVE LEFT TURN PHASES.
- PHASE 2 AND 6 SHALL BE ON VEHICLE RECALL.

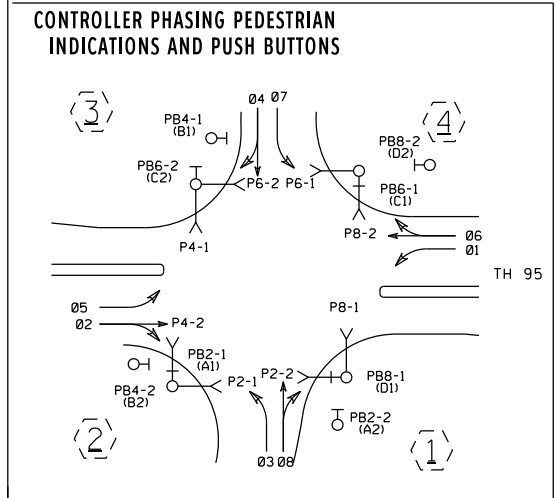

4" RSC
4-12/C#12
2-12/C#14
3-4/C#14
2-3/C#14
12-2/C#14
2-3/C#20
2-3/C#12 (LUM)
1-6PR#19
1-1/C#14 INS GR

BY	DATE	REVISIONS
BAM	5-31-07	ADDED A 2ND D8-2 LOOP AT 5', MOVED LOOP D8-3 TO -3', CHANGED EVERYTHING TO INPLACE, WB# 168945
EJA	05-02-14	AS BUILT OF SP 1307-19 (APS, CD PEDS, NEW MASI ARMS)

SYSTEM ID: 22339 T.E. _____
METER ADDRESS: 5901 MAPLE STREET
MASTER ID: _____ T.E. _____

INTERSECTION LAYOUT
TH 95 @ OAKVIEW AVE.
IN THE CITY OF NORTH BRANCH,
CHISAGO COUNTY

S.A.P. NO. _____ DRAWN BY: BAM CKD BY: EJA DATE: _____
CERTIFIED BY _____ LIC. NO. _____ DATE: _____
STATE PROJ. NO. _____ (T.H. 95) SHEET NO. 1 OF 3 SHEETS

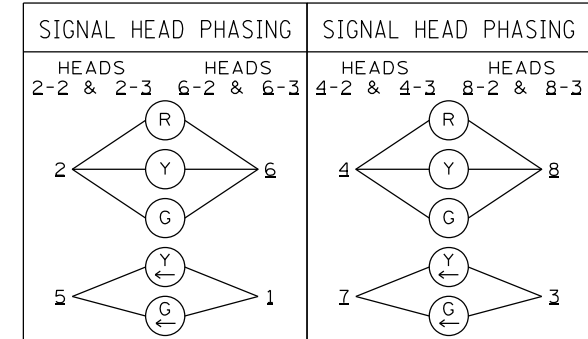

PLOTTED/REVISED: \$\$\$@DATE@\$\$\$\$

DISTRICT #: \$\$\$@DISTRICT@
PLOT NAME: \$\$\$@PLOT\$NAME@
PATH & FILENAME: \$\$\$@PATH\$FILENAME@\$\$\$

- (A) EQUIPMENT PAD
CONTROLLER AND CABINET
SERVICE CABINET
CONTROLLER CABINET TO HH 13
4" RSC
2-12/C#12
2-12/C#14
3-4/C#14
2-3/C#14
7-2/C#14
2-3/C#20
1-1/C#6 INS GR
CONTROLLER CABINET TO HH 1
4" RSC
2-12/C#12
2-12/C#14
3-4/C#14
2-3/C#14
17-2/C#14
2-3/C#20
1-6PR#19
1-1/C#6 INS GR

- SERVICE CABINET TO
CONTROLLER CABINET
2" RSC
2-1/C#6
1-1/C#6 INS GR
SERVICE CABINET TO HH 15
2" RSC
3-1/C#0
SERVICE CABINET TO HH 1
2" RSC
4-3/C#12 (LUM)

- (B) POWER SUPPLIED BY
NORTH BRANCH UTILITIES
WOOD POLE W/DISCONNECT
2" RSC RISER W/ WEATHERHEAD
3-1/C#0

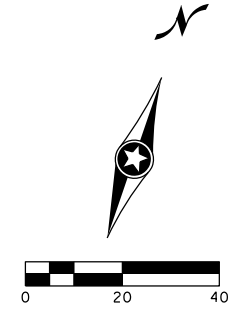
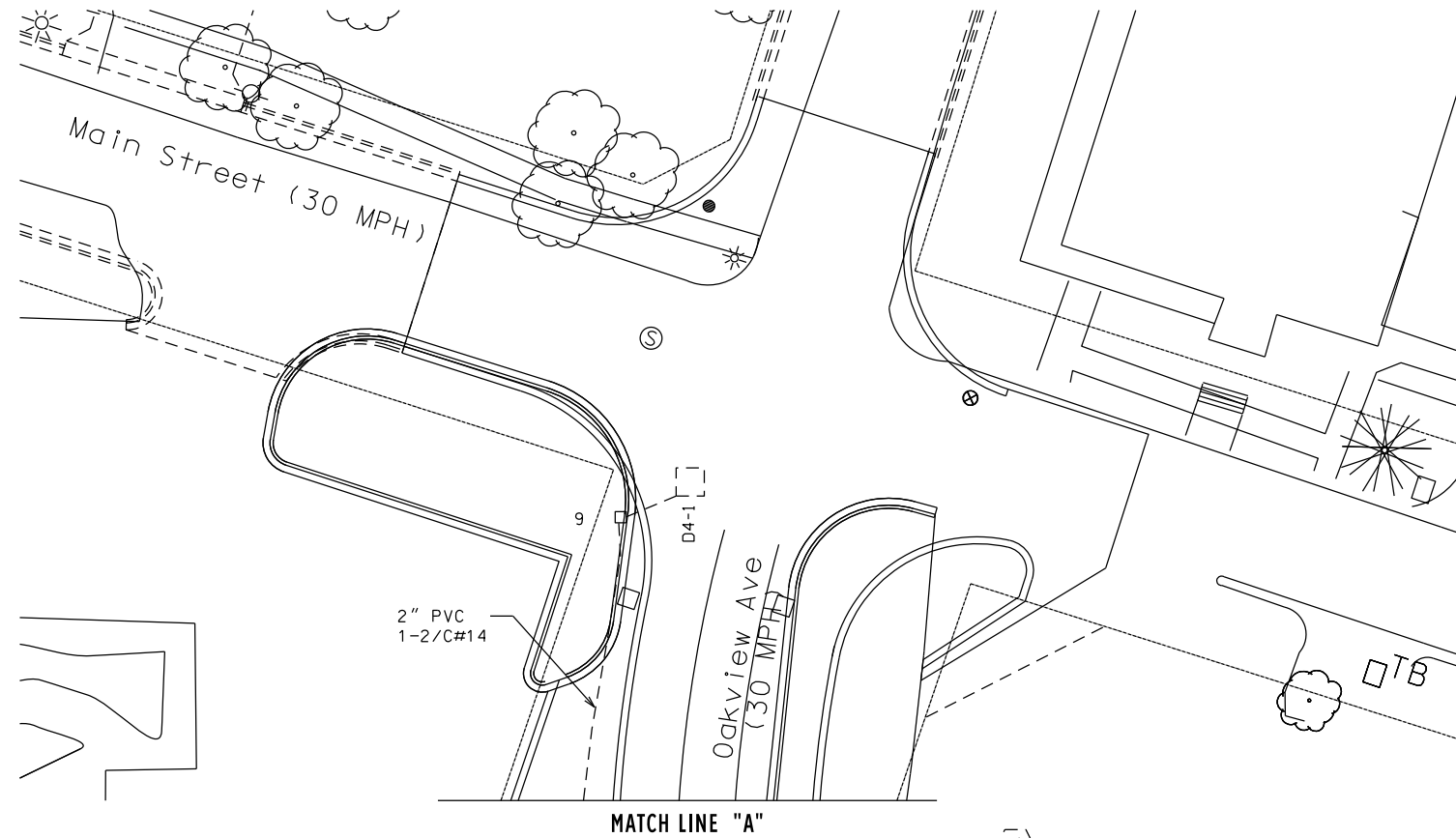

- (3) PA100 POLE FOUNDATION
TYPE PA100-A45-D40-9 (DAVIT AT 350 DEG)
1-ANGLE MOUNT SIGNAL AT 0'
1-STRAIGHT MOUNT SIGNAL AT 18'
ONEWAY EVP DETECTOR & CONFIRMATORY LT (PHASES 1+6)
2- ANGLE MOUNT SIGNALS AT 90 & 180 DEG
2-ANGLE MOUNT CD PED HEADS AT 90 & 180 DEG
LUMINAIRE-250 WATT HPS
1-APS PB & SIGN (RT ARROW) (PB6-2)
1-R10-12 SIGN (ADJACENT TO HEAD 6-3)
EXTEND INTO HH 7:
3" PVC
2-12/C#14
2-4/C#14
1-3/C#14
1-3/C#14 (LUM)
1-3/C#20
1-2/C#14
1-1/C#6 INS GR

- (2) PA90 POLE FOUNDATION
TYPE PA90-A35-D40-9 (DAVIT AT 350 DEG)
1-ONEWAY SIGNAL OVERHEAD AT 0'
2-TYPE 10B AT 90 & 180 DEG
2-CD PED HEADS
ONE WAY EVP DETECTOR & CONFIRMATORY LT (PHASES 4+7)
LUMINAIRE-250 WATT HPS
1-APS PB & SIGN (LT ARROW) (PB2-1)
1- SIGN TYPE R10-12 (ADJACENT TO HEAD 4-2)
1-SIGN TYPE R6-1L (ONEWAY)
1-SIGN TYPE R6-1R (ONEWAY)
EXTEND INTO HH 3:
3" RSC
2-12/C#12
1-4/C#14
1-3/C#14
1-3/C#12 (LUM)
1-3/C#20
1-2/C#14

- (4) PA90 POLE FOUNDATION
TYPE PA90-A30-D40-9 (DAVIT AT 350°)
1-ONE WAY SIGNAL OVERHEAD AT 0'
ONE WAY EVP DETECTOR & CONFIRMATORY LT (PHASES 3+8)
2-TYPE 10B AT 90 & 180 DEG
2-CD PED HEADS
LUMINAIRE-250 WATT HPS
1-APS PB & SIGN (LT ARROW) (PB6-1)
1-SIGN TYPE R6-1L (ONEWAY)
1-SIGN TYPE R6-1R (ONEWAY)
1- SIGN TYPE R10-12 (ADJACENT TO HEAD 8-2)
EXTEND INTO HH 10:
3" RSC
2-12/C#12
1-4/C#14
1-3/C#14
1-3/C#20
1-3/C#12 (LUM)
1-2/C#14

- (1) PA100 POLE FOUNDATION
TYPE PA100-A45-D40-9 (DAVIT AT 350 DEG)
1-ANGLE MOUNT SIGNAL OVERHEAD AT 0'
1-STRAIGHT MOUNT SIGNAL OVERHEAD AT 18'
2-ANGLE MOUNT SIGNALS AT 90 & 180 DEG
2-ANGLE MOUNTCD PED HEADS AT 90 & 180 DEG
ONE WAY EVP DETECTOR & CONFIRMATORY LT (PHASES 2+5)
LUMINAIRE- 250 WATT HPS
1-APS PB AND SIGN (RT ARROW) (PB8-1)
1-R10-12 SIGN (ADJACENT TO HEAD 2-3)
EXTEND INTO HH 13:
3" PVC
2-12/C#14
2-4/C#14
1-3/C#14
1-3/C#20
1-3/C#14 (LUM)
1-2/C#14
1-1/C#6 INS GR

BY	DATE	REVISIONS	SYSTEM ID: 22339	T.E.	POLE NOTES & MATCH LINE TH 95 @ OAKVIEW AVE IN THE CITY OF NORTH BRANCH, CHISAGO COUNTY	S.A.P. NO.	DRAWN BY: BAW	CKD BY: EJA	DATE:
BAW	5-31-07	ADDED A 2ND D8=2 LOOP AT 5', MOVED LOOP D8=3 TO -3', CHANGED EVERYTHING TO INPLACE, WB# 168945	METER ADDRESS: 5901 MAPLE SIBEEI						
EJA	05-02-14	AS-BUILT OF SE 1307=19 TAPS, CD PEDS, NEW MASI ARMS	MASTER ID:	T.E.					
						STATE PROJ. NO. (T.H. 95)	SHEET NO. 2 OF 3 SHEETS		

PLOTTED/REVISED: \$\$\$@DATE@\$\$\$\$

DISTRICT #: \$\$\$@DISTRICT@\$\$
PLOT NAME: \$\$\$@PLOT\$NAME@\$\$
PATH & FILENAME: \$\$\$@PATH\$FILENAME@\$\$

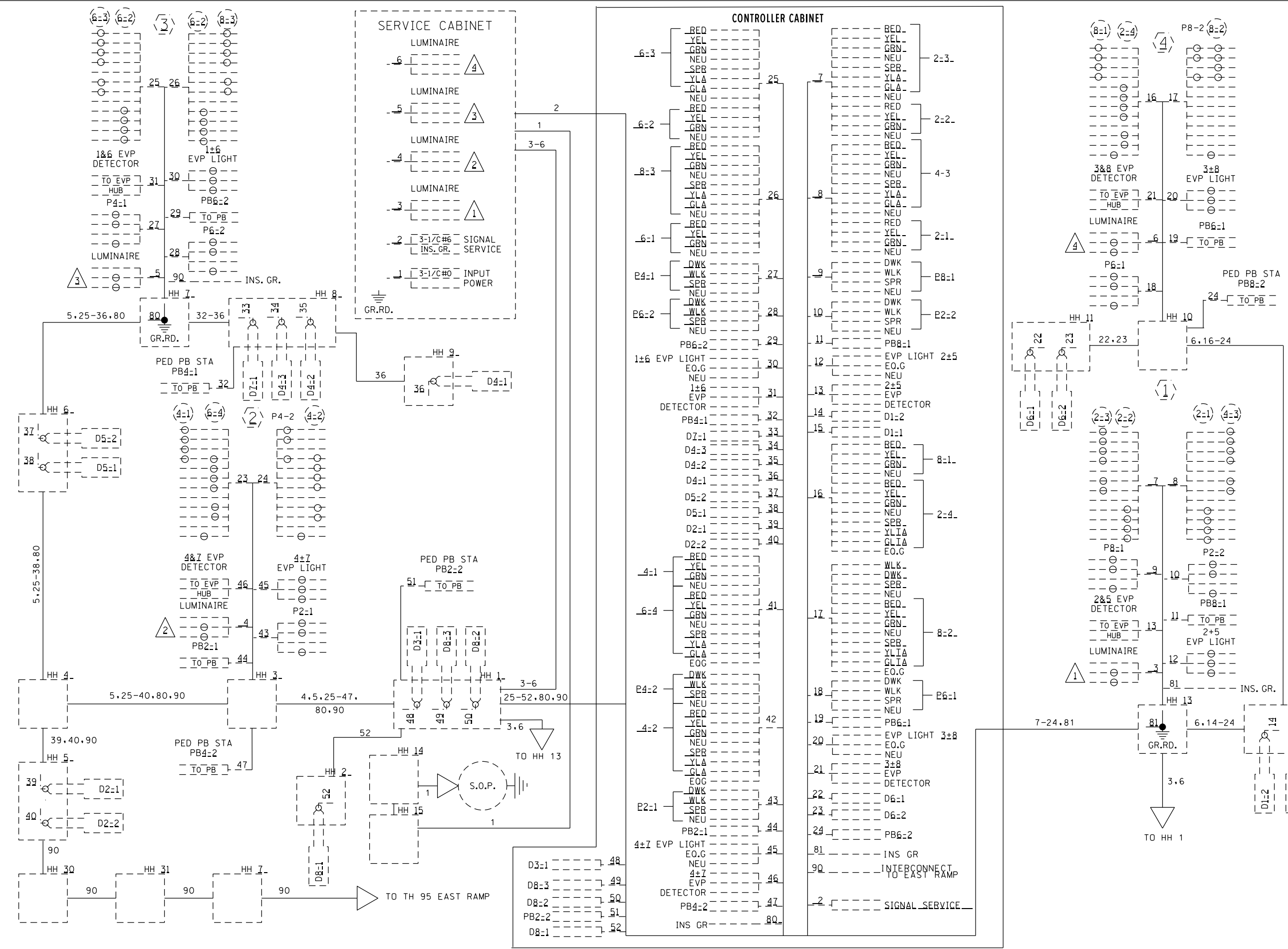

CONDUCTOR COLOR CODING

R	R	
O	O	
BL	BL	5/C#12
WH	WH	
R/BLK	R	3/C#12
O/BLK	WH	BLK
BL/BLK	BLK	
WH/BLK	BLK/WH	R OR O
BLK	G/BLK	WH OR YEL
BLK/WH	G	3/C#20
G/BLK		BLK OR BL
G		
		BLK
		WH
		CLEAR
		2/C#14

NOTE: ALL TERMINAL BLOCK CONNECTIONS SHALL BE ARRANGED AS SPECIFIED ABOVE

4/C#14	R	R
	BLK/R	O
	BLK	BL
	WH	WH
		R/BLK
3/C#14	BLK	O/BLK
	G	BL/BLK
	WH	WH/BLK
		BLK
		BLK/WH
		BLK/R
		WH/R

#14 WIRES USE POLE BASE CONNECTORS

BY	DATE	REVISIONS
BAM	5-31-07	ADDED A 2ND D8-2 LOOP AT 5', MOVED LOOP D8-3 TO 3', CHANGED EVERYTHING TO INPLACE, WR#-168945
EJA	05-02-14	AS-BUILT OF SP-1307-19 (APS, CD PEDS, NEW MASI ARMS)

SYSTEM ID: 22339 T.E. _____
 METER ADDRESS: 5901 MAPLE STREET
 MASTER ID: _____ T.E. _____

FIELD WIRING DIAGRAM
 TH 95 @ OAKVIEW AVE.
 IN THE CITY OF NORTH BRANCH,
 CHISAGO COUNTY

S.A.P. NO. 225-010-02 DRAWN BY: BAM CKD BY: EJA DATE: _____
 CERTIFIED BY: _____ LIC. NO. _____ DATE: _____
LICENSED PROFESSIONAL ENGINEER
 STATE PROJ. NO. _____ (T.H. 95) SHEET NO. 3 OF 3 SHEETS