

LOOP DETECTOR CHART

NUMBER	SIZE (FT)	LOCATION
D2-1, D2-2	6 X 6	180'
D4-1	6 X 6	120'
D4-2	2-6 X 6	10', 30'
D5-1	2-6 X 6	20', 50'
D5-2	2-6 X 6	5', 35'
D6-1, D6-2	6 X 6	180'

-ALL LOOP DETECTORS ARE PVC
-LOCATION: DISTANCE FROM CROSSWALK/STOP BAR IN FEET

(A)

EQUIPMENT PAD
SERVICE CABINET
SIGNAL CABINET, CONTROLLER, MASTER CONTROLLER - REPLACE EXISTING (SAME LOCATION)
MASTER CONTROLLER
4" PVC TO HH 1A:
2-12/C #14
1-4/C #14
1-3/C #14
9-2/C #14
2-3/C #20
1-6PR #19
1-1/C #6 INS. GR.
2" RSC STUBBED OUT - CAPPED BOTH ENDS
3/4" PVC STUBBED OUT - CAPPED FOR TELEPHONE LINE
2" RSC TO SERVICE CABINET
3-1/C #1/0
SERVICE CABINET TO HH 48A:
3" RSC
4-1/C #10
6-1/C #6
1-1/C #6 BARE GROUND
2-3/C #14 (LUM)
2-1/C #10 (LUM 25 & 26)
2" RSC TO HH 48
2-1/C #6
2-3/C #14 (LUM)
2-1/C #10 (LUM 25 & 26)
HH 48A TO CONTROLLER CABINET
2" RSC
1-1/C #6 BARE GROUND
2-1/C #6
CONTROLLER CABINET TO HH 48
3" RSC
3-12/C #14
1-4/C #14
2-3/C #14
2-3/C #20
3-2/C #14
1-1/C #6 INS. GR.

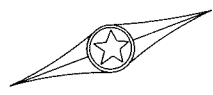

SCALE IN FEET



(5)

PA85 POLE FOUNDATION
TYPE PA85-A-25-D40-9 (DAVIT AT 350 DEG)
1-ANGLE MOUNT SIGNAL OVERHEAD AT 0'
1-ANGLE MOUNT SIGNAL AT 180 DEG
2-ANGLE MOUNT C.D. PED IND AT 90 AND 180 DEG
1-APS PB AND SIGN (LT ARROW) (PB4-1)
1-ONE WAY EVP DETECTOR AND CONFIRMATORY LIGHT (PHASE 6)
LUM-250W HPS
1-SIGN R6-1L ONE WAY
1-SIGN R6-1R ONE WAY
3" PVC TO HH 13:
2-12/C #14
1-3/C #14
1-2/C #14
1-3/C #20
1-1/C #6 INS. GR.

(1)

PEDESTAL FOUNDATION
14' PEDESTAL POLE AND BASE (13' POLE PLUS BASE)
1-STRAIGHT MOUNT SIGNAL
1-STRAIGHT MOUNT C.D. PED IND
1-APS PB AND SIGN (LT ARROW) (PB6-1)
1-SIGN R9-2a (NO PED) FACING POLE 2
EXTEND INTO HH 5:
3" PVC
1-12/C #14
1-2/C #14
1-1/C #6 INS. GR.

SIGNAL FACE CHART

FACE	R	Y	FYA	G
2-1, 2-2	○	○		○
4-1, 4-2	◀	◀		◀
5-1, 5-2	◀	◀	◀	◀
6-1, 6-2	○	○		○

-ALL SIGNAL INDICATIONS ARE 12" LED
-ALL SIGNAL HEADS ARE BLACK POLYCARBONITE WITH BACKGROUND SHIELDS

(B)

SOP-GROUND MOUNTED TRANSFORMER (BY XCEL)
SHARED EQUIPMENT PAD
SERVICE CABINET
STEP DOWN TRANSFORMER

SHARED EQUIPMENT PAD
SEE DETAIL

PLOTTED/REVISED: \$\$\$@DATE\$\$\$

DISTRICT #: \$\$\$@DISTRICT\$\$\$
PLOT NAME: \$\$\$@PLOT\$NAME\$\$\$
PATH & FILENAME: \$\$\$@PATH\$FILENAME\$\$\$

CONTROLLER PHASING, PEDESTRIAN INDICATIONS AND PUSH BUTTONS

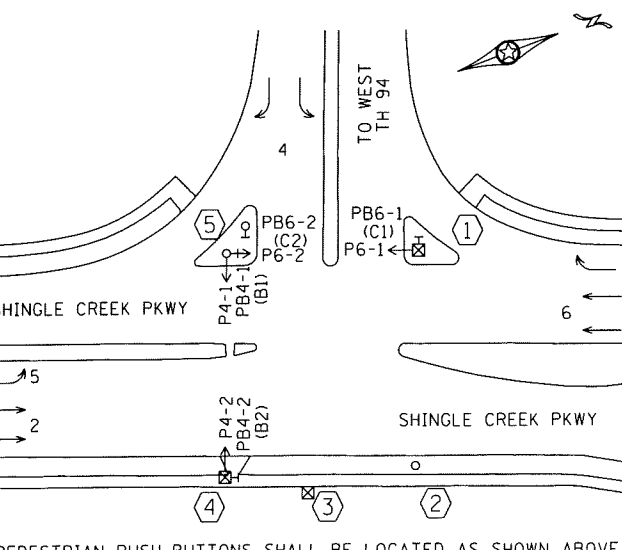

PEDESTRIAN PUSH BUTTONS SHALL BE LOCATED AS SHOWN ABOVE

(4)

PEDESTAL FOUNDATION
9' SIGNAL PEDESTAL POLE AND BASE (8' POLE PLUS BASE)
TYPE 4A
1-C.D. PED IND
1-APS PB AND SIGN (RT ARROW) (PB4-2)
EXTEND INTO HH 8:
3" PVC
1-4/C #14
1-2/C #14
1-1/C #6 INS. GR.

SIGNAL SYSTEM OPERATION

- THE SIGNAL SYSTEM FLASH MODE IS ALL RED.
- NORMAL OPERATION IS 4 PHASE, WITH PHASE(S) 5 BEING A FLASHING YELLOW ARROW BY TIME OF DAY PHASE.
- PHASES 2 AND 6 SHALL BE ON VEHICLE RECALL.

(3)

PEDESTAL FOUNDATION
14' PEDESTAL POLE AND BASE (13' POLE PLUS BASE)
1-STRAIGHT MOUNT SIGNAL
1-ONE WAY EVP DETECTOR AND CONFIRMATORY LIGHT (PHASE 4)
EXTEND INTO HH 7:
3" PVC
1-6/C #14
1-3/C #14
1-3/C #20
1-1/C #6 INS. GR.

(2)

PA90 POLE FOUNDATION
TYPE PA90-A-35-D40-9 (DAVIT AT 350 DEG)
1-ANGLE MOUNT SIGNAL OVERHEAD AT 0'
1-STRAIGHT MOUNT SIGNAL OVERHEAD AT 11'
2-ANGLE MOUNT SIGNALS AT 90 AND 180 DEG
1-ONE WAY EVP DETECTOR AND CONFIRMATORY LIGHT (PHASE 2+5)
LUM-250W HPS
1-SALVAGE AND INSTALL MAST ARM SIGN
1-SIGN R9-3a (NO PED) FACING POLE 1
1-SIGN R6-1L ONE WAY
1-SIGN R6-1R ONE WAY
3" PVC TO HH 7:
2-12/C #14
1-3/C #14
1-3/C #14 (LUM)
1-3/C #20
1-1/C #6 INS. GR.

BY	DATE	REVISIONS
EJA	4-23-12	AS-BUILT PLAN SP 2781-417

SYSTEM ID: 21303 T.E. 5178
METER ADDRESS: SHINGLE CREEK PKWY
MASTER ID: 22324 T.E.

INTERSECTION LAYOUT
TRAFFIC CONTROL SIGNAL SYSTEM
TH 94 (NORTH RAMP) AT SHINGLE CREEK PKWY
BROOKLYN CENTER, HENNEPIN CO.

S.A.P. NO. 109-109-032
DRAWN BY: BAM CKD BY: CDB DATE: 8/31/10
CERTIFIED BY: *Michael P. Selinsky* LIC. NO. 19863 DATE: 9/10/10
STATE PROJ. NO. 2781-417 (T.H. 94) SHEET NO. 6 OF 21 SHEETS

PLOTTED/REVISED: \$\$\$@DATE@\$\$\$

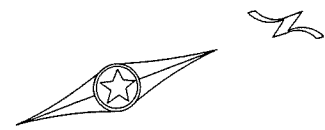

40
SCALE IN FEET

6 PEDESTAL FOUNDATION
14' PEDESTAL POLE AND BASE
(13' POLE PLUS BASE)
1-ONE WAY EVP DETECTOR (PHASE 4)
EXTEND INTO HH 16:
3" PVC
1-3/C #20

6
4 EVP

16

2" PVC
1-3/C #20

1 1/2" RSC
2-1/C #6
1-1/C #6 INS. GR.

TH 94 W.B.

15

SHINGLE CREEK PARKWAY

MATCHLINE "C"

MATCHLINE "B"

15

2" PVC
1-3/C #20

EXIT RAMP FROM W.B. TH 94

MATCHLINE "A"

12(SR)

2" PVC
1-6PR #19

26

TH 94 E.B.

1 1/2" RSC
2-1/C #6
1-1/C #6 INS. GR.

3" RSC
1-6PR #19

BY	DATE	REVISIONS
EJA	4-23-12	AS-BUILT PLAN SP 2781-417

SYSTEM ID: 21303 T.E. 5178
 METER ADDRESS: SHINGLE CREEK PKWY
 MASTER ID: 22324 T.E.

MATCHLINES
 TRAFFIC CONTROL SIGNAL SYSTEMS
 TH 94 N & S RAMPS AT SHINGLE CREEK PKWY
 BROOKLYN CENTER, HENNEPIN CO.

S.A.P. NO. 109-109-032	DRAWN BY: BAM	CKD BY: COB	DATE: 8/31/10
CERTIFIED BY: <i>Michael P. Subashy</i>	LIC. NO. 19863	DATE: 9/2/10	
STATE PROJ. NO. 2781-417 (T.H.94)		SHEET NO. 10 OF 21 SHEETS	

PLOT NAME: \$\$\$@PLOT\$NAME@\$\$\$
PATH & FILENAME: \$\$\$@PATH\$FILENAME@\$\$\$

PLOTTED/REVISED: \$\$\$@DATE@\$\$\$

DISTRICT #: \$@DISTRICT@
 PLOT NAME: \$\$@PLOT\$NAME@\$\$
 PATH & FILENAME: \$\$\$@PATH\$FILENAME@\$\$\$

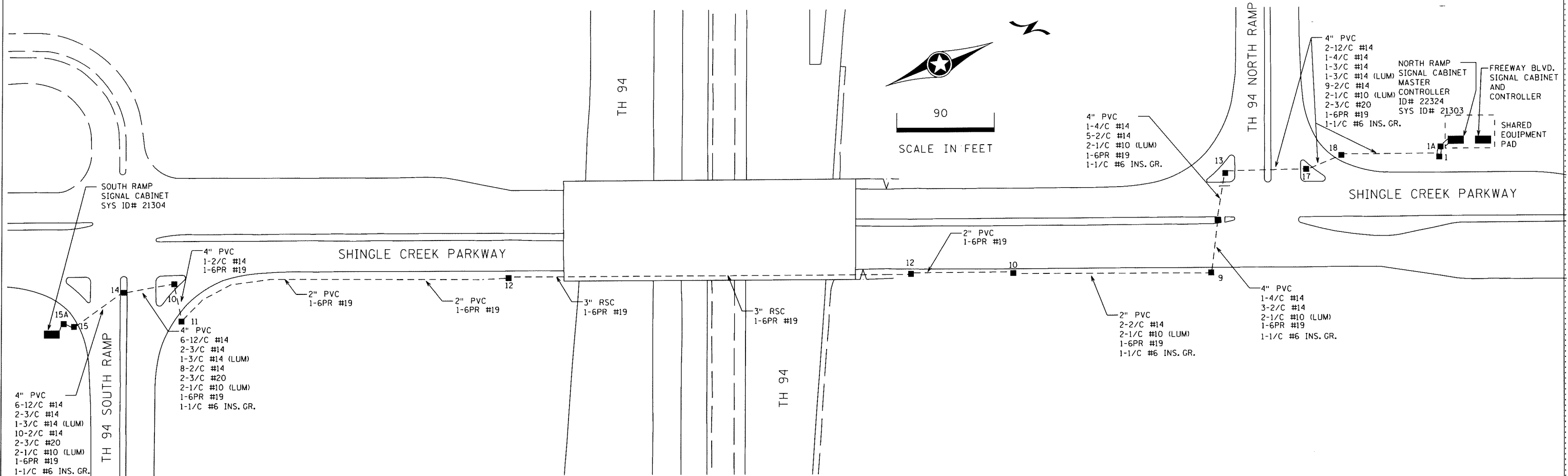

BY	DATE	REVISIONS
EJA	4-23-12	AS-BUILT PLAN SP 2781-417

SYSTEM ID: 21303,21304,21302 T.E.
 METER ADDRESS:
 MASTER ID: 22324 T.E.

INTERCONNECT LAYOUT
 TH 94 NORTH AND SOUTH RAMPS
 ON SHINGLE CREEK BLVD.
 BROOKLYN CENTER, HENNEPIN CO.

S.A.P. NO.	DRAWN BY: BAM	CKD BY: CDB	DATE: 9/1/10
CERTIFIED BY: <i>Michael P. Gubinsky</i> <small>LICENSED PROFESSIONAL ENGINEER</small>	LIC. NO. 19863	DATE: 9/2/10	
STATE PROJ. NO. 2781-417 (T.H. 94)		SHEET NO. 15 OF 21 SHEETS	

PLOTTED/REVISED: \$\$\$@DATE@\$\$\$

DISTRICT: \$\$\$@DISTRICT@\$\$
PLOT NAME: \$\$\$@PLOTNAME@\$\$
PATH & FILENAME: \$\$\$@PATHFILENAME@\$\$\$

CONTROLLER CABINET

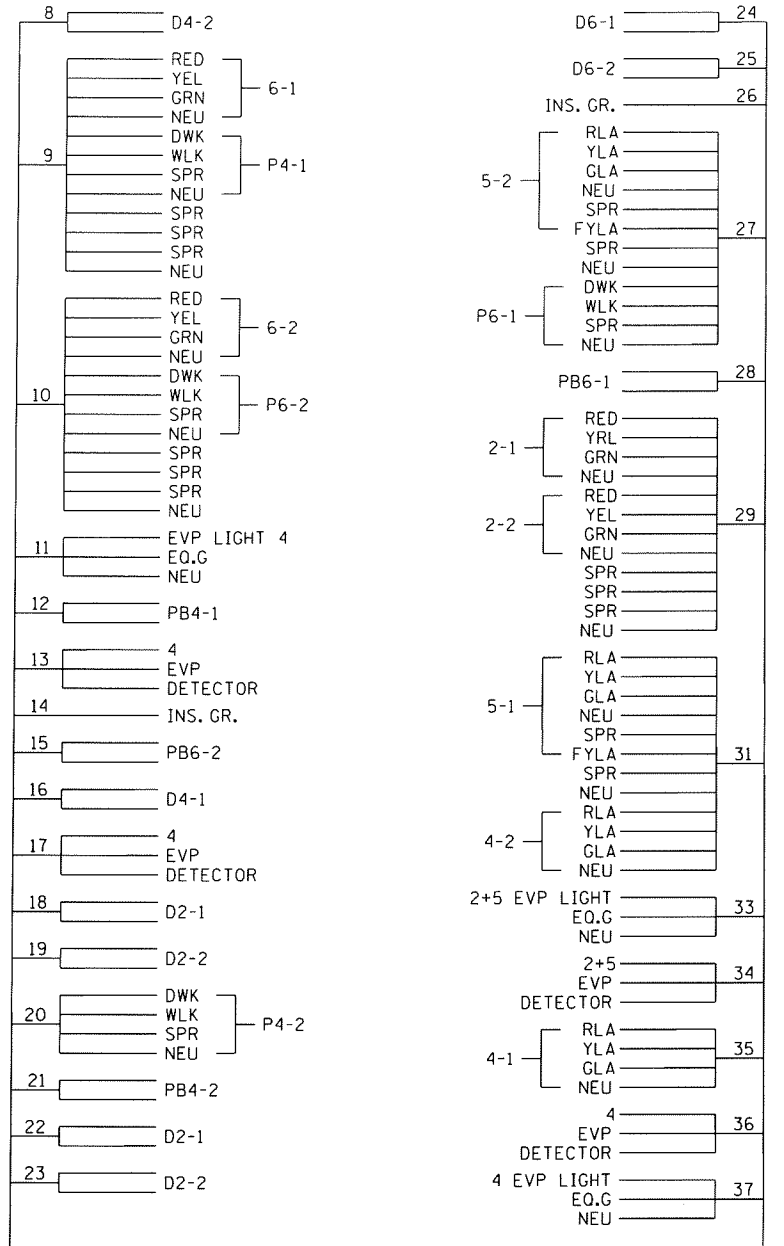
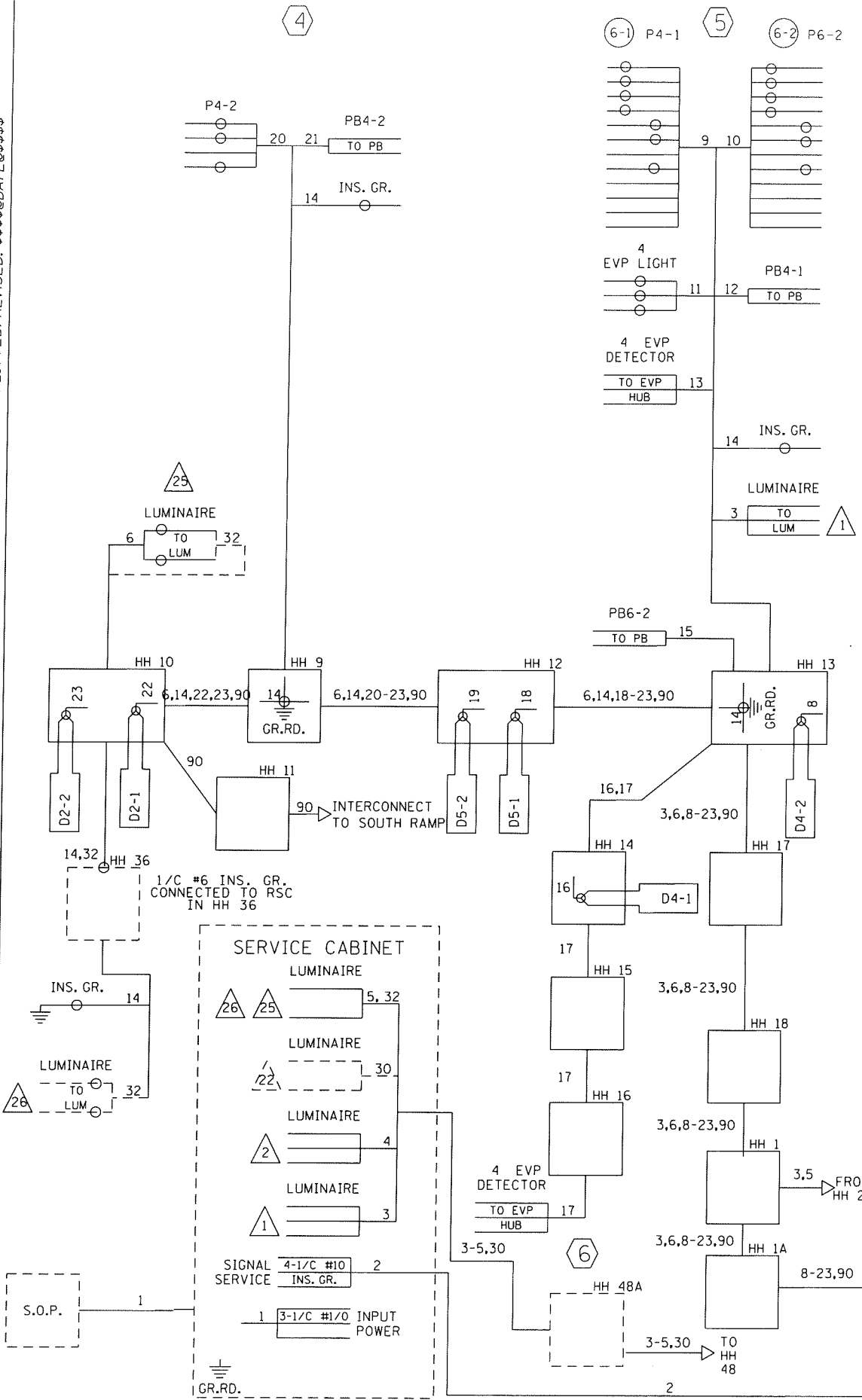

NOTES:
 1. LUMINAIRES ARE METERED.
 2. SIGNAL SYSTEM INCLUDES BATTERY-BACKUP SERVICE CABINET (NO BATTERIES).
 3. FOR CONDUCTOR COLOR CODE SEE TRAFFIC SIGNAL POLE WIRING CONNECTOR DETAIL.

MASTER CONTROLLER
ID# 22324

INTERCONNECT TO SHINGLE CREEK SOUTH RAMP 90
 INTERCONNECT TO SHINGLE CREEK PKWY AT FREEWAY BLVD 91

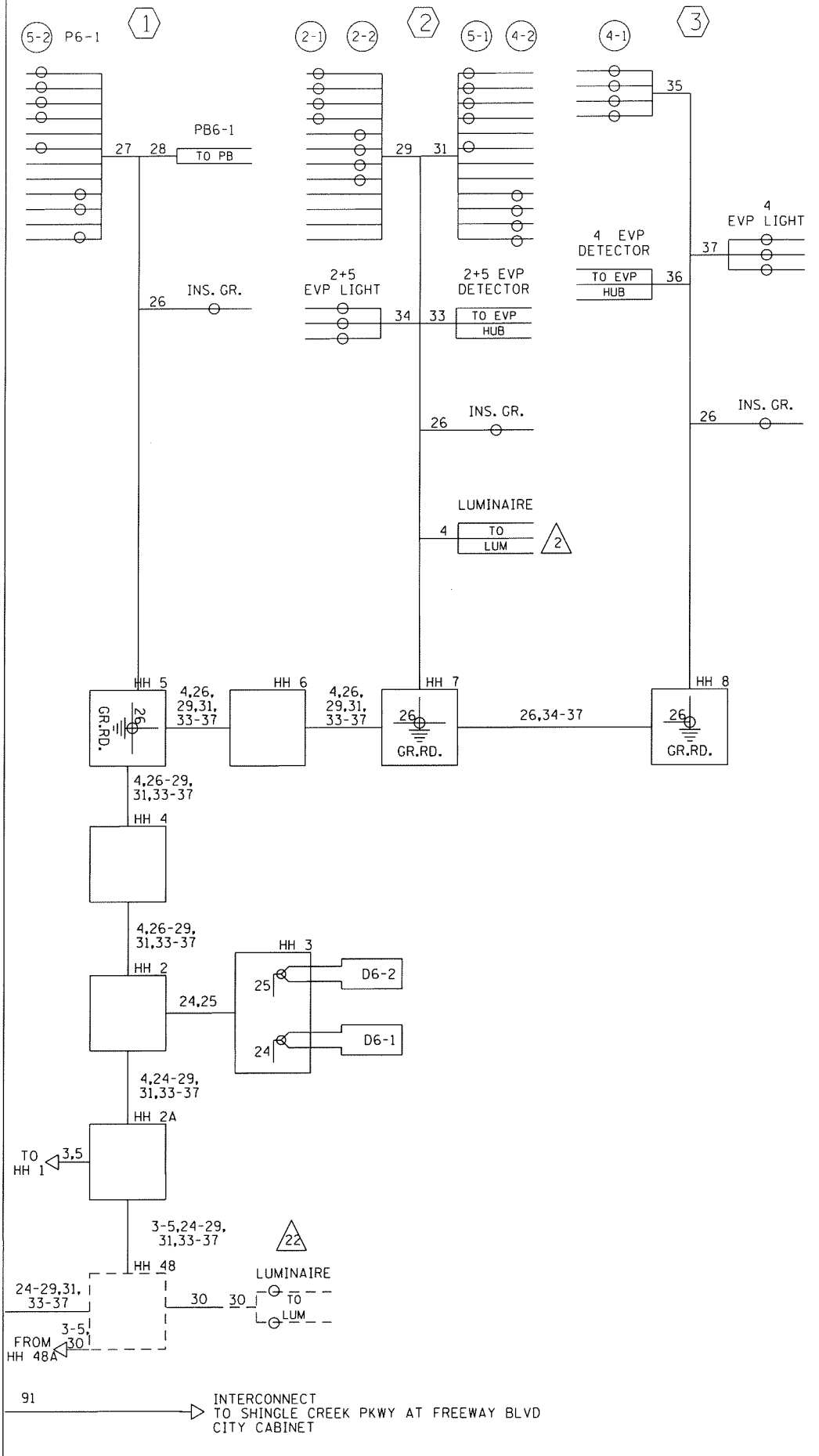

BY	DATE	REVISIONS	SYSTEM ID: 21303	T.E. 5178	S.A.P. NO. 109-109-032	DRAWN BY: BAM	CKD BY: CDB	DATE: 8/31/10
EJA	4-23-12	AS_BUILT PLAN SP 2781-417	METER ADDRESS: SHINGLE CREEK PKWY	T.H. 94 (NORTH RAMP) AT SHINGLE CREEK PKWY	CERTIFIED BY: <i>Michael P. Gubinsky</i>	LIC. NO. 19863	DATE: 9/10/10	
			MASTER ID: 22324	T.E.	STATE PROJ. NO. 2781-417 (T.H. 94)	SHEET NO. 8 OF 21 SHEETS		

FIELD WIRING DIAGRAM
 TRAFFIC CONTROL SIGNAL SYSTEM
 TH 94 (NORTH RAMP) AT SHINGLE CREEK PKWY
 BROOKLYN CENTER, HENNEPIN CO.