

PLOTTED/REVISED: 17-MAY-2023

DISTRICT #: Metro  
I/PLOT NAME: layout  
PATH & FILENAME: Projects\DM\_POS\06\0000\Traffic\Signal\2913\_138\GLEN\_RD-SINGLE\_PT-1736328\T22514\_sgl.dgn

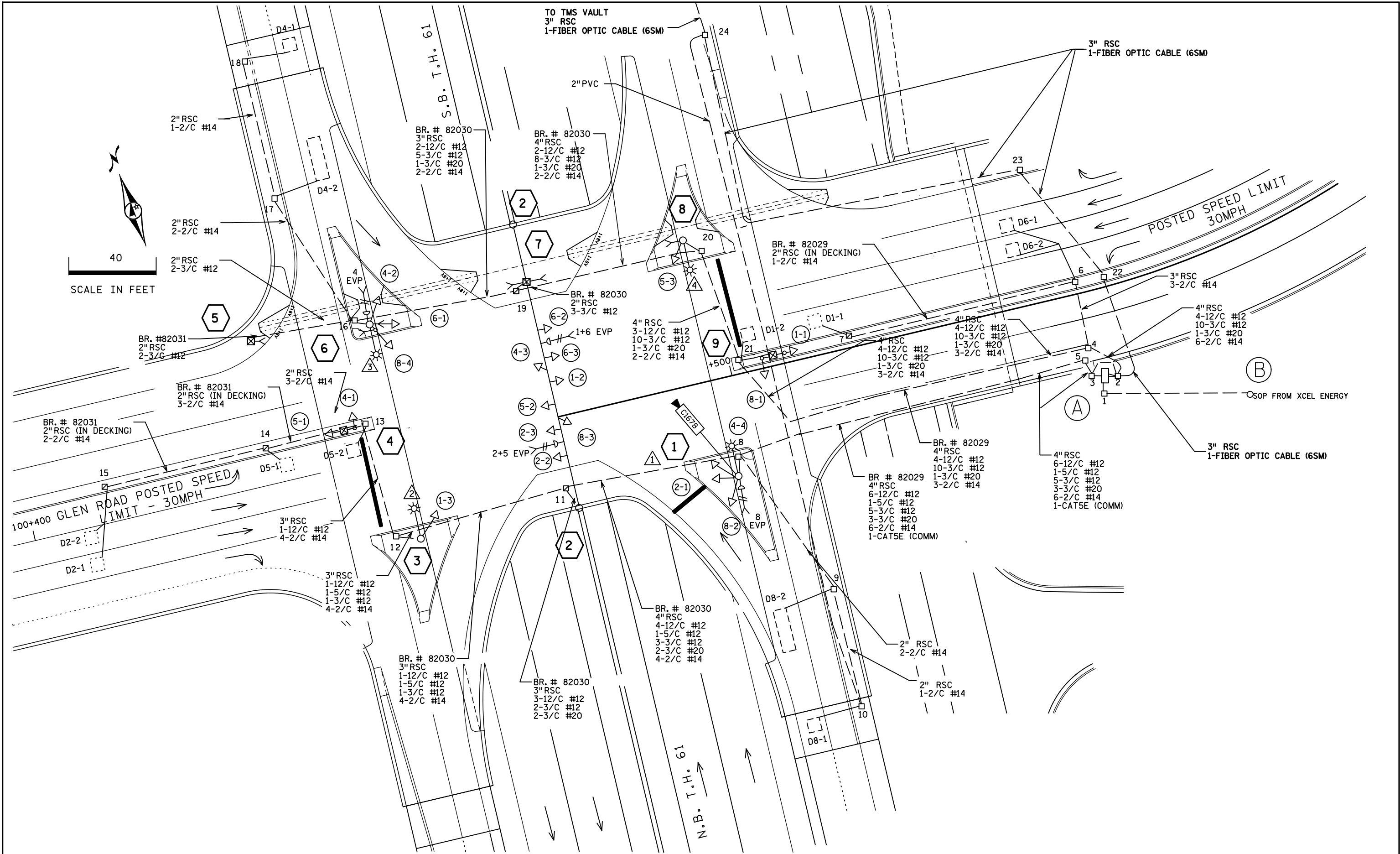

BY	DATE	REVISIONS	SYSTEM ID: 22514	T.E. 5869	S.A.P. NO.	DRAWN BY: SJK	CKD BY: EJA	DATE: 09-10-13
EJA	11-18-14	AS-BUILT OF SP 1913-75 FIBER & CAMERA	METER ADDRESS: 1570 HASTINGS AVE		CERTIFIED BY	LICENSED PROFESSIONAL ENGINEER	LIC. NO. 19863	DATE: 09-10-13
SJK	5/17/23	PTZ CAMERA UPGRADE SP 8825-890	MASTER ID:	T.E.	STATE PROJ. NO.	(T.H.61)	SHEET NO.	1 OF 4 SHEETS

**INTERSECTION LAYOUT**  
**T.H. 61/10 AT CSAH 38 (GLEN RD)**  
**IN NEWPORT, WASHINGTON COUNTY**

PLOTTED/REVISED: 17-MAY-2023

DISTRICT #: Metro  
 IPLOT NAME: pole notes  
 PATH & FILENAME: Projects\DM\_POS\06\0000\Traffic\Signals\2913\_138\GLEN\_RD-SINGLE\_PT-1736328VT22514\_sgl.dgn

(A)

EQUIPMENT PAD  
 CONTROLLER AND CABINET  
 SIGNAL SERVICE CABINET  
 4" RSC TO HH 3  
 6-12/C #12  
 1-5/C #12  
 5-3/C #12  
 3-3/C #20  
 6-2/C #14  
 1-CAT5 (COMM)

4" RSC TO HH 2  
 4-12/C #12  
 10-3/C #12  
 1-3/C #20  
 6-2/C #14

3" RSC TO TMS VAULT  
 1-FIBER OPTIC CABLE (GSM)  
 WITH FIELD TERMINATED END

2" RSC SERVICE CABINET TO CONTROLLER  
 2-1/C #6  
 1-1/C #6 INS. GRD.  
 SERVICE CABINET TO HH 2  
 2" RSC  
 4-3/C #12 (LUM)  
 SERVICE CABINET TO HH 1  
 3-1/C #2

(B)

SOP - WOOD POLE (BY XCEL POWER COMPANY)  
 2" RSC RISER, WEATHERAD AND  
 TO HH 1  
 3-1/C #2

1

PA85 POLE FOUNDATION  
 TYPE PA85-40-X6-350/CAM 400 EXTENSION AT 360 DEG  
 1-PTZ CAMERA (C1678)  
 1-LUMINAIRE-250W HPS  
 3-TYPE 10A AT 180, 270 AND 315 DEG  
 ONE WAY EVP DETECTOR AND  
 CONFIRMATORY LIGHT (PHASE 8)  
 2-R9-3A SIGN (NO PED) FACING  
 POLE 8 AND TO THE EAST  
 EXTEND INTO HH 8  
 4" RSC  
 2-12/C #12  
 1-3/C #12  
 1-3/C #20  
 1-3/C #12 (LUM)  
 1-7/16" GROUNDING BRAID  
 TO GROUND ROD IN HH 8  
 1-CAT5E (COMM)

**SIGNAL HEAD CHART**

ALL INDICATIONS ARE 12 LED

FACE	R LED	Y LED	G LED	RLTA LED	YLTA LED	GLTA LED
1-1, 1-2, 1-3				←	←	←
2-1, 2-2, 2-3	○	○	○			
4-1	○	○	○			
4-2, 4-3, 4-4				←	←	←
5-1, 5-2, 5-3				←	←	←
6-1, 6-2, 6-3	○	○	○			
8-1	○	○	○			
8-2, 8-3, 8-4				←	←	←

**PVC LOOP DETECTORS**

NUMBER	SIZE (FEET)	LOC.
D1-1	6X6	33
D1-2	6X6	0
D2-1, D2-2	6X6	120
D4-1	6X6	120
D4-2	6X15	65
D5-1	6X6	33
D5-2	6X6	0
D6-1, D6-2	6X6	120
D8-1	6X6	120
D8-2	6X15	20

5

8' PEDESTAL POLE AND BASE  
 TYPE 4A  
 1-PEDESTRAIN PUSH BUTTON AND SIGN  
 EXTEND INTO HH 16  
 3" RSC  
 2-3/C #12

8

PA85 POLE FOUNDATION  
 TYPE PA85-40-D40-9 (DAVIT AT 0)  
 TYPE 10B POLE MOUNTED AT 0  
 LUMINAIRE 250 W HPS  
 POLE MOUNTED RTMC CAMERA (ABANDONED)  
 1-PEDESTRAIN PUSH BUTTON AND SIGN  
 EXTEND INTO HH 20  
 3" RSC  
 1-12/C #12  
 1-3/C #12  
 1-3/C #12 (LUM)

2

OVERHEAD TRAFFIC SIGNAL SUPPORT  
 8 ONE WAY SIGNALS (OVERHEAD)  
 2-ONE WAY EVP DETECTOR AND LIGHT  
 (PHASE 2 & 5, 6 & 1)  
 EXTEND INTO JB 11  
 3" RSC  
 3-12/C #12  
 2-3/C #12  
 2-3/C #20

6

PA85 POLE FOUNDATION  
 TYPE PA85-40-D40-9 (DAVIT AT 0)  
 2-TYPE 10B POLE MOUNTED AT 270, 315  
 TYPE 10A POLE MOUNTED AT 180  
 ONE WAY EVP DETECTOR AND  
 CONFIRMATORY LIGHT (PHASE 4)  
 LUMINAIRE 250 W HPS  
 1-PEDESTRAIN PUSH BUTTON AND SIGN  
 EXTEND INTO HH 16  
 3" RSC  
 2-12/C #12  
 2-3/C #12  
 1-3/C #20  
 1-3/C #12 (LUM)

9

PEDESTAL FOUNDATION,  
 13' PEDESTAL POLE AND BASE  
 TYPE 6A  
 EXTEND INTO HH 21  
 3" RSC  
 1-12/C #12

3

PA85 POLE FOUNDATION  
 TYPE PA85-40-D40-9 (DAVIT AT 0)  
 TYPE 10A POLE MOUNTED AT 90  
 2-R9-3A SIGN (NO PED) FACING  
 POLE 6 AND TO THE WEST  
 LUMINAIRE 250 W HPS  
 EXTEND INTO HH 12  
 3" RSC  
 1-5/C #12  
 1-3/C #12 (LUM)

7

10' PEDESTAL POLE AND BASE  
 TYPE 4D  
 1-PEDESTRAIN PUSH BUTTON AND SIGN  
 EXTEND INTO JB 19  
 3" RSC  
 3-3/C #12

4

PEDESTAL FOUNDATION  
 13' PEDESTAL POLE AND BASE  
 TYPE 6A  
 EXTEND INTO HH 13  
 3" RSC  
 1-12/C #12

**CONTROLLER PHASING, PEDESTRIAN INDICATIONS AND PUSH BUTTONS**

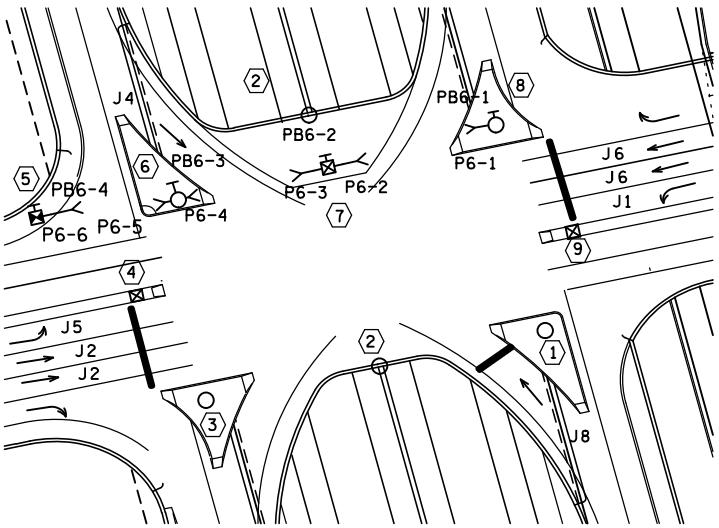

PEDESTRIAN PUSH BUTTONS SHALL BE LOCATED AS SHOWN ABOVE

**SIGNAL SYSTEM OPERATION**

- THE SIGNAL SYSTEM FLASH MODE IS ALL RED.
- NORMAL OPERATION IS 6 PHASE, WITH PHASES 1 AND 5 BEING PROTECTED LEFT TURN PHASES.

BY	DATE	REVISIONS
EJA	11-18-14	AS-BUILT OF SP 1913-75 FIBER & CAMERA
SJK	5/17/23	PTZ CAMERA UPGRADE

SYSTEM ID: 22514 T.E. 5869  
 METER ADDRESS: 1570 HASTINGS AVE  
 MASTER ID: T.E.

**CHARTS AND NOTES**  
 T.H. 61/10 AT CSAH 38 (GLEN RD)  
 IN NEWPORT, WASHINGTON COUNTY

S.A.P. NO.	DRAWN BY: SJK	CKD BY: EJA	DATE: 09-10-13
CERTIFIED BY _____	LIC. NO. 19863	DATE: 09-10-13	
STATE PROJ. NO.	(T.H. 61)	SHEET NO. 2 OF 4 SHEETS	

DISTRICT #: Metro  
 I/PLOT NAME: wire 1  
 PATH & FILENAME: Projects\DM\_POS\06\0000\Traffic\Signals\2913\_(38)\GLEN RD-SINGLE\_PT-1736328V22514\_sgl.dgn  
 PLOTTED/REVISED: 17-MAY-2023

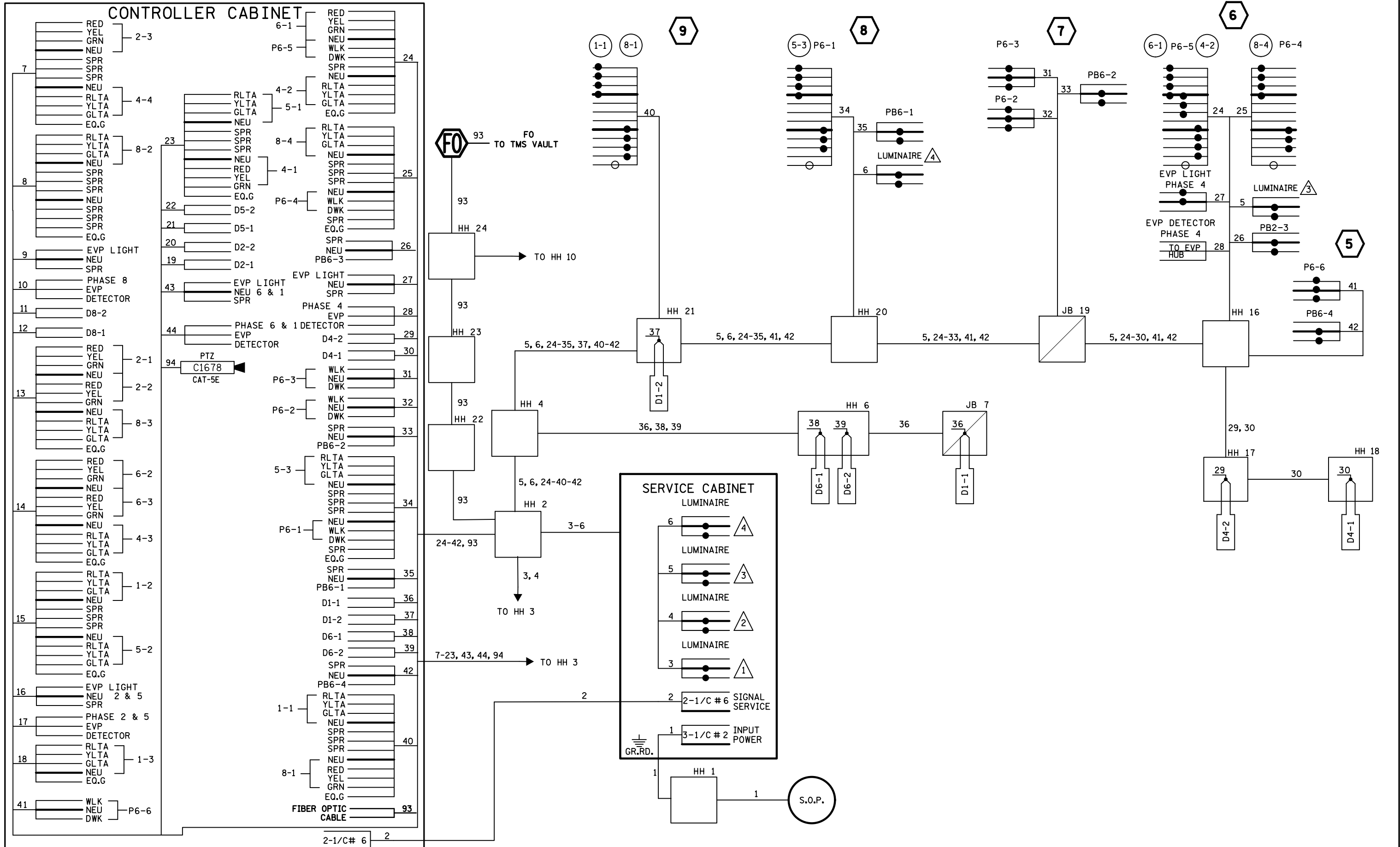

BY	DATE	REVISIONS
EJA	11-18-14	AS-BUILT OF SP 1913-75 FIBER & CAMERA
SJK	5/17/23	PTZ CAMERA UPGRADE

SYSTEM ID: 22514 T.E. 5869  
 METER ADDRESS: 1570 HASTINGS AVE  
 MASTER ID: T.E.

**FIELD WIRING DIAGRAM 1 OF 2**  
**T.H. 61/10 AT CSAH 38 (GLEN RD)**  
**IN NEWPORT, WASHINGTON COUNTY**

S.A.P. NO.	DRAWN BY: SJK	CKD BY: EJA	DATE: 09-10-13
CERTIFIED BY	LIC. NO. 19863	DATE: 09-10-13	
STATE PROJ. NO.	(T.H. 61)	SHEET NO. 3 OF 4 SHEETS	

PLOTTED/REVISED: 17-MAY-2023

PROJECTS\DM\_FOS\06\0000\Traffic\Signals\2913\_138\GLEN RD-SINGLE\_PT-1736328\T22514\_sgl.dgn

DISTRICT #: Metro  
PLOT NAME: wire 2  
PATH & FILENAME:

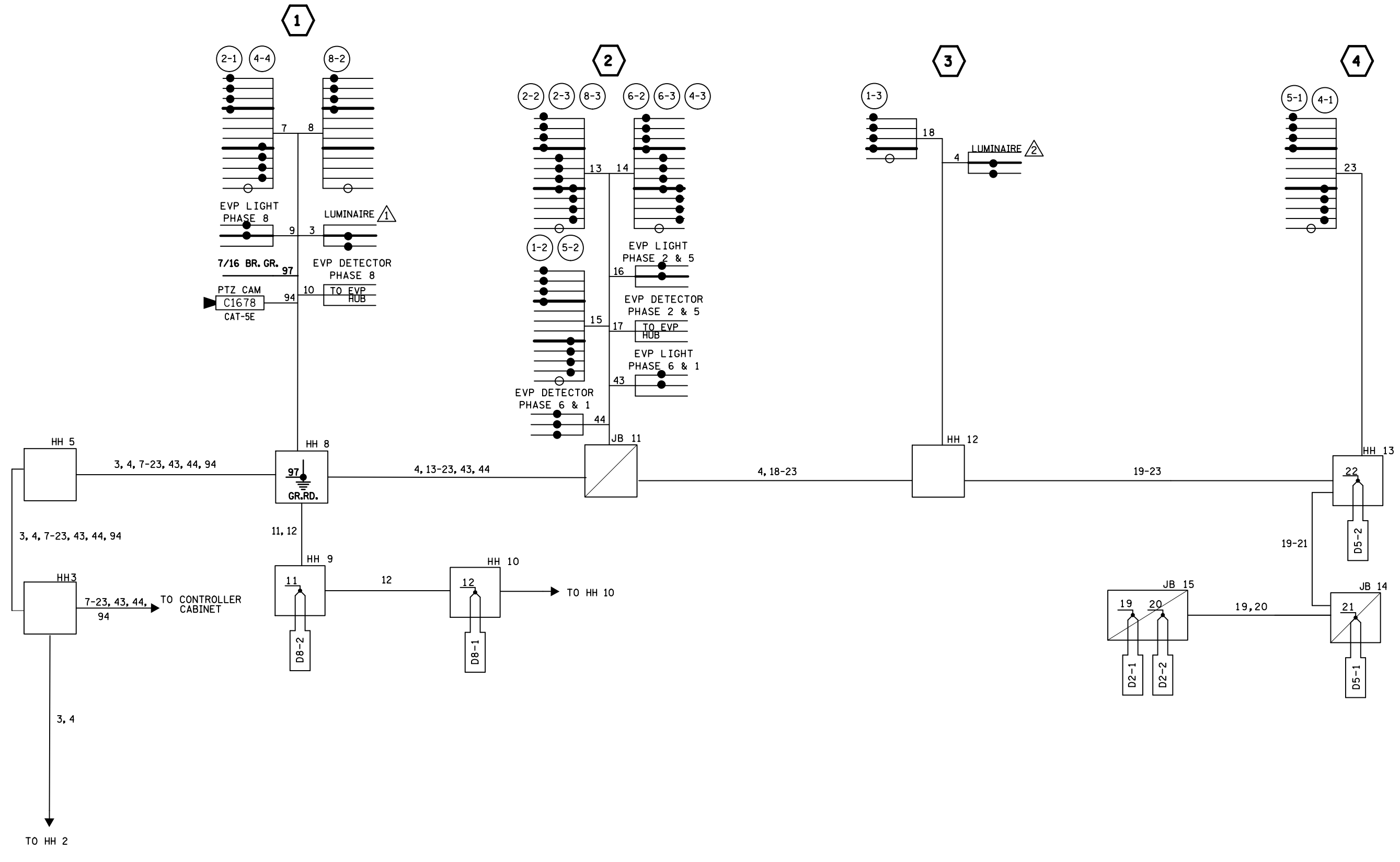

BY	DATE	REVISIONS	SYSTEM ID: 22514	T.E. 5869	S.A.P. NO.	DRAWN BY: SJK	CKD BY: EJA	DATE: 09-10-13
EJA	11-18-14	AS-BUILT OF SP 1913-75 FIBER & CAMERA	METER ADDRESS: 1570 HASTINGS AVE		CERTIFIED BY _____	LIC. NO. 19863	DATE: 09-10-13	
SJK	5/17/23	PTZ CAMERA UPGRADE	MASTER ID:	T.E.	STATE PROJ. NO. (T.H.61) SHEET NO. 4 OF 4 SHEETS			

FIELD WIRING DIAGRAM 2 OF 2  
T.H. 61/10 AT CSAH 38 (GLEN RD)  
IN NEWPORT, WASHINGTON COUNTY